

SECTION No.(s): 86100000
S.R. No.(s): 7
PERMIT No: 2019-L-491-00005
COUNTY: Broward

**DISTRICT FOUR (4) AMENDMENT NUMBER EIGHT (8) TO STATE OF FLORIDA
DEPARTMENT OF TRANSPORTATION LANDSCAPE INCLUSIVE
MEMORANDUM OF AGREEMENT**

THIS AMENDMENT Number Eight (8) to the Agreement dated February 26, 2013 made and entered into this _____ day of _____ 20____ by and between the State of Florida Department of Transportation hereinafter called the DEPARTMENT and the **CITY OF HOLLYWOOD**, a municipal subdivision of the State of Florida, hereinafter called the AGENCY.

W I T N E S S E T H

WHEREAS, the parties entered into the Landscape Inclusive Maintenance of Agreement dated, February 26, 2013 for the purpose of maintaining the landscape improvements by the AGENCY on various roads including State Road 7 (US 441); and,

WHEREAS, the DEPARTMENT and the AGENCY have agreed to add additional landscape to be installed by permit within the City of Hollywood on State Road 7 (US 441) and State road 818 (Griffin Road) in accordance with the above referenced Agreement; and,

NOW THEREFORE, for and in consideration of mutual benefits that flow each to the other, the parties covenant and agree as follows:

1. The DEPARTMENT and AGENCY shall modify the limits of the City of Hollywood Inclusive Landscape Agreement dated February 26, 2013 to include State Road 818 (Griffin Road) from M.P. 6.655 to M.P. 6.810.
2. The original Agreement dated February 26, 2013 the DEPARTMENT will allow an adjacent property owner to construct additional landscape improvements or to modify an improvement located as indicated in **Exhibit "A"**, State Road 7 (US 441) from M.P. 6.220 to M.P. 6.319 and SR 818 (Griffin Road) from M.P. 6.655 to M.P.6.810. In accordance with the plans attached as **Exhibit "B"**.
3. The AGENCY shall agree to maintain the additional landscape improvements in the Agreement described above according the **Exhibit "C"** Maintenance Plan of the original agreement and as follows:

II. SPECIFIC PROJECT SITE MAINTENANCE REQUIREMENTS AND RECOMMENDATIONS:

CRAPE MYRTLE MAINTENANCE

If pruning is necessary, use the following recommendations:

- Pruning to improve plant structure, redirect growth, or alter plant shape and appearance should occur when plants are leafless and dormant—typically December through February. Although this can be accomplished at any time, without leaves, the branching structure is clearly visible to more easily determine appropriate branches for pruning.
- Prune to remove crossing or rubbing branches.
- Prune dead, damaged, or diseased branches at the branch collar.
- Remove vigorous branches growing toward the center of the canopy.
- Severe pruning should be performed late in the dormant period. Pruning too early might stimulate new growth that could be damaged by low temperatures.
- Crape myrtles shall be pruned and shaped each February or March to promote vigorous blooming and to maintain the desired shape and size. Branches shall be individually trimmed back to wood no larger than ½" in diameter. All sucker branching, seed pods, and ball moss shall also be removed.

SYLVESTER PALM MAINTENANCE

Completely dead leaves need to be removed if they do not fall off by themselves. However, avoid removing discolored or partially dead older leaves as these are symptoms of potassium deficiency removing them removes a supplemental source of potassium for the palms growing in potassium-deficient soils (all soils in Florida are potassium deficient for palms).

FLEXI-PAVE HD2000 MAINTENANCE

Flexi-Pave HD2000 consists of 50% ¾" crumb recycled tires and 50% ¾"-½" granite chips, held together with an elastomeric polyurethane binder XP-75. Once cured, Flexi-Pave HD2000 maintains approximately 19-23% internal pore space, which gives it a pervious rating of nearly 4000 inches of water per hour (over 2500 gallons per square foot per hour). Unlike other porous paving materials, which have static internal voids and require routine vacuuming to maintain porosity, Flexi-Pave's internal pore capacity is dynamic in nature. As such, Flexi-Pave does not typically require vacuuming and is considered for the most part, "self-cleaning". Therefore, standard cleaning and maintenance recommendations are kept to a minimum and are listed below:

1. It is recommended that routine street maintenance be carried out in accordance with maintenance best practices. This will ensure continual performance of Flexi-Pave HD2000.
2. It is recommended that if Flexi-Pave HD2000 endures foliage surface debris (i.e. leaves, grass clippings, etc.) that the debris be blown off periodically. This will prevent the natural compost material from forming, accumulating and decaying within the Flexi-Pave HD2000 so as to not promote the growth of plant seeds, or weeds.

- ## FLEXI-PAVE HD2000 PROTECTION PROCEDURE

1. Cover Flexi-Pave HD2000 with poly sheeting to collect loose stone dust, sand, or other granular materials that may be dislodged during adjacent construction activities.
2. Cover Flexi-Pave HD2000 with plywood path prior to traversing it with any vehicle or piece of equipment other than a pneumatic rubber-tired passenger vehicle.
3. Cover Flexi-Pave HD2000 with plywood prior to traversing it with a vehicle with muddy tires.
4. Prior to installing concrete ballast blocks, concrete fence panel footings, or tent posts, protect Flexi-Pave HD2000 with plywood pieces directly under the areas that may become scuffed.

Except as modified by this Amendment, all terms and conditions of the original Agreement and all Amendments thereto shall remain in full force and effect.

LIST OF EXHIBITS

Exhibit A - Landscape Improvements And Maintenance Boundaries
Exhibit B - Landscape Improvement Plans

In Witness whereof, the parties hereto have executed with this Amendment effective the ____ day _____ year written and approved.

CITY OF HOLLYWOOD

STATE OF FLORIDA
DEPARTMENT OF TRANSPORTATION

By: _____
Chairperson/Mayor/City Manager

By: _____
Transportation Development Director

Attest: _____ (SEAL)
Clerk

Attest: _____ (SEAL)
Executive Secretary

Legal Review Date

Legal Review Date

Office of the General Counsel

SECTION No.(s): 86100000
S.R. No.(s): 7
PERMIT No: 2019-L-491-00005
COUNTY:

EXHIBIT A
LANDSCAPE IMPROVEMENTS
AND MAINTENANCE BOUNDARIES

- I. PERMIT LANDSCAPE MAINTENANCE LIMITS:
State Road 7 (US 441) from M.P. 6.220 to M.P. 6.319
And
State Road 818 (Griffin Road) from M.P. 6.655 to M.P. 6.810

- II. MODIFY THE INCLUSIVE LANDSCAPE MAINTENANCE AGREEMENT LIMITS TO
INCLUDE THESE LIMITS ON STATE ROAD 818 (Griffin Road)
State Road 818 (Griffin Road) from M.P. 6.655 to M.P. 6.810

*All limits of the original agreement and amendments shall apply

Please See Attached

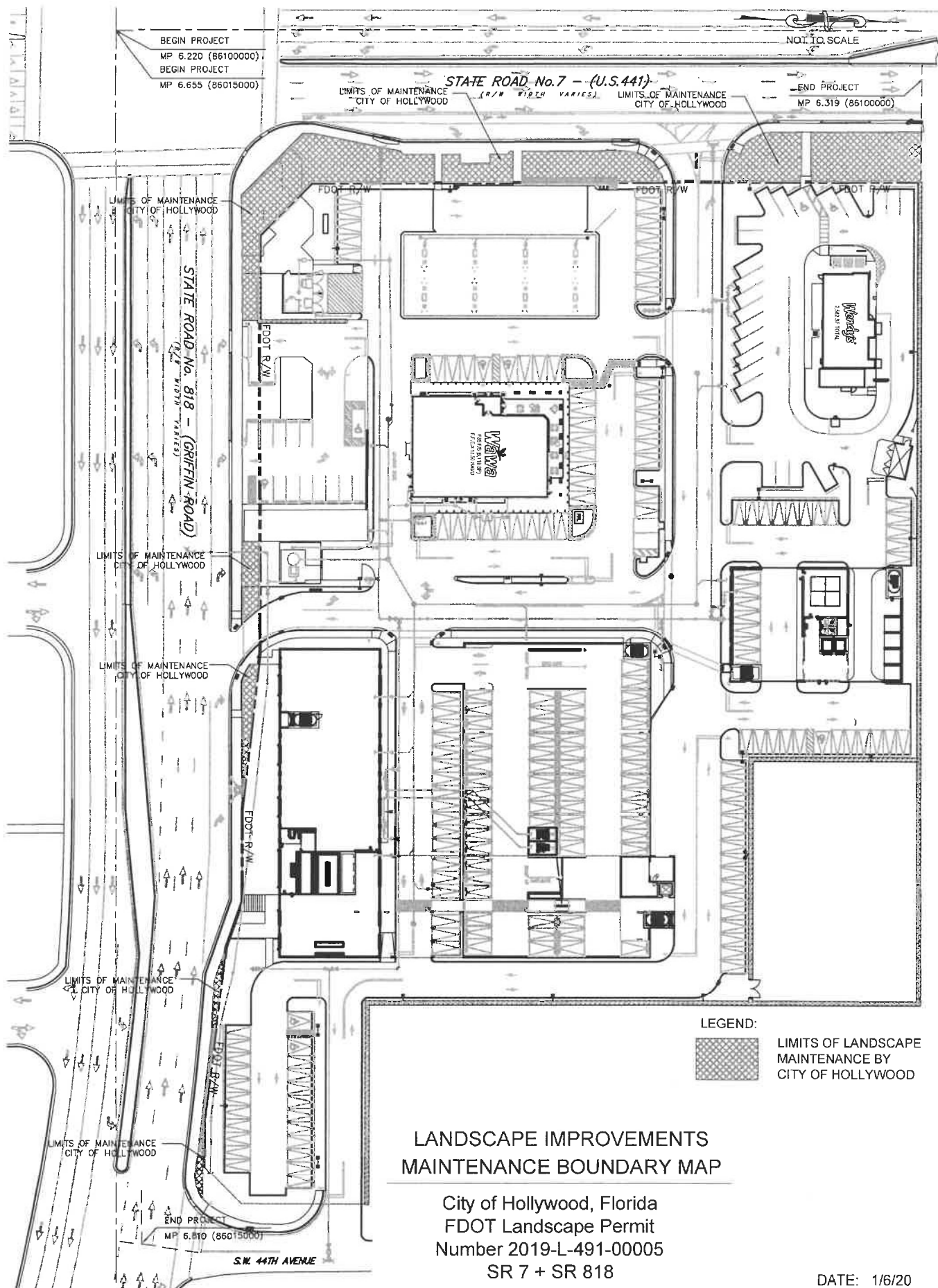

SECTION No.(s): 86100000
S.R. No.(s): 7
PERMIT No: 2019-L-491-00005
COUNTY: Broward

EXHIBIT B

LANDSCAPE IMPROVEMENT PLANS

The AGENCY agrees to install the landscape improvements in accordance with the plans and specifications attached hereto and incorporated herein.

Please see attached plans prepared by: Gregory A. Reynolds, RLA
Aloha Pacifica, LLC

Dated: December 5, 2019

Sheets LA - 1
 LA - 2
 LA - 3
 LA - 4
 LA - 5



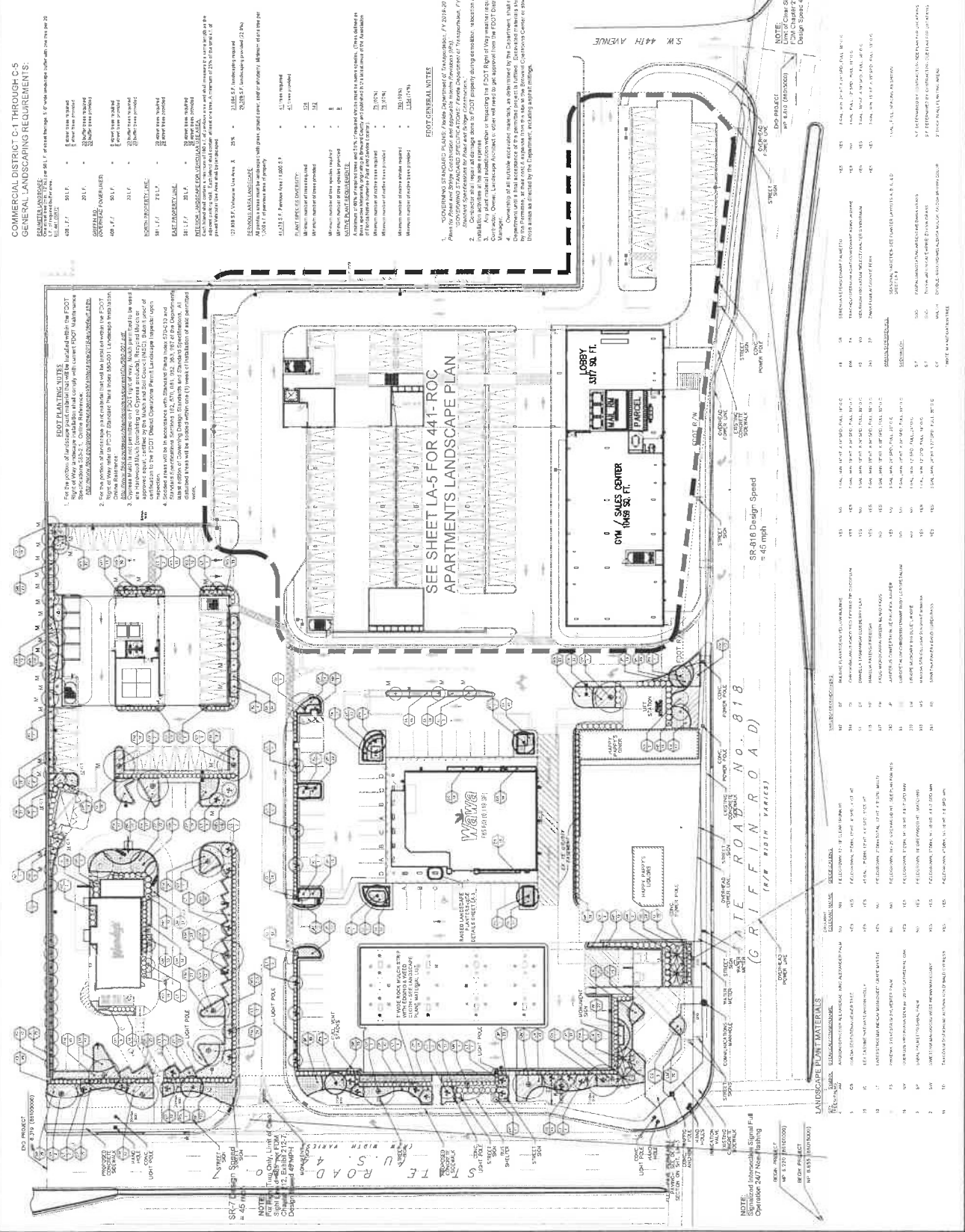



24" X 24": ALLED MOBILES PRODUCTS LLC - BOULEVARD
 24" X 24": ALLED MOBILES PRODUCTS LLC - BOULEVARD
 24" X 24": ALLED MOBILES PRODUCTS LLC - BOULEVARD
 24" X 24": ALLED MOBILES PRODUCTS LLC - BOULEVARD

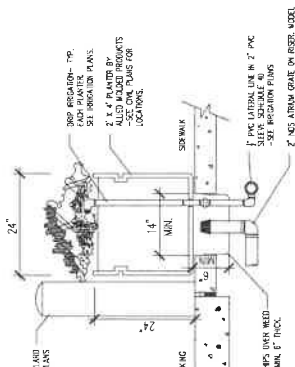

SCALE: 1/2" = 1'-0"

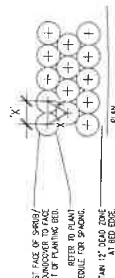
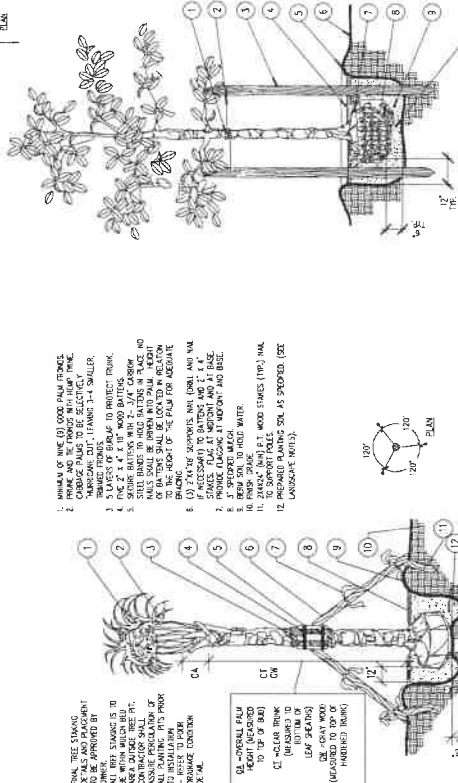

FIGURE 1. A cross-sectional diagram of a coastal dune system. The diagram shows a dune with various layers and features labeled with numbers 1 through 7. 1 points to the top of the dune, 2 to the top of the windward slope, 3 to the top of the dune, 4 to the top of the dune, 5 to the top of the dune, 6 to the top of the dune, and 7 to the top of the dune. The diagram also shows a cross-section of the dune with layers labeled 1 through 7. 1 is the top of the dune, 2 is the top of the windward slope, 3 is the top of the dune, 4 is the top of the dune, 5 is the top of the dune, 6 is the top of the dune, and 7 is the top of the dune. The diagram also shows a cross-section of the dune with layers labeled 1 through 7. 1 is the top of the dune, 2 is the top of the windward slope, 3 is the top of the dune, 4 is the top of the dune, 5 is the top of the dune, 6 is the top of the dune, and 7 is the top of the dune.

NOT TO SCALE



NOT TO SCALE



NOT TO SCALE

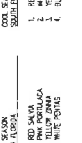
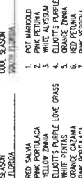
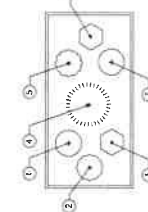

01/23/01 10:10 AM

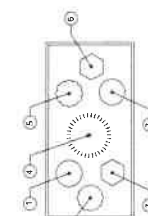

NOT TO SCALE

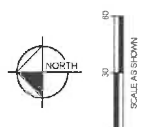

TREE DISPOSITION REQUIREMENTS

TREE LABEL	COMMON NAME	SIZE	REMARKS	REASON	DATE
001	FOUR WINGED OAK	16" DBH	75%	REMOVE	
002	BEAUTY LEAF CALOPHYLLUM	12" DBH	75%	REMOVE	
003	BEAUTY LEAF CALOPHYLLUM	8" DBH	75%	REMOVE	
004	BEAUTY LEAF CALOPHYLLUM	12" DBH	50%	REMOVE	
005	BEAUTY LEAF CALOPHYLLUM	12" DBH	50%	REMOVE	
006	BEAUTY LEAF CALOPHYLLUM	14" DBH	75%	REMOVE	
007	BEAUTY LEAF CALOPHYLLUM	8" DBH	75%	REMOVE	
008	BEAUTY LEAF CALOPHYLLUM	12" DBH	75%	REMOVE	
009	BEAUTY LEAF CALOPHYLLUM	12" DBH	50%	REMOVE	
TOTAL REPLACEMENT DBH REQUIRED: 81"					
TOTAL REPLACEMENT DBH PROVIDED: 81"					

NOTE: SEE LANDSCAPE PLAN SHEET A-1 FOR TRANSPLANTED TREE LOCATIONS

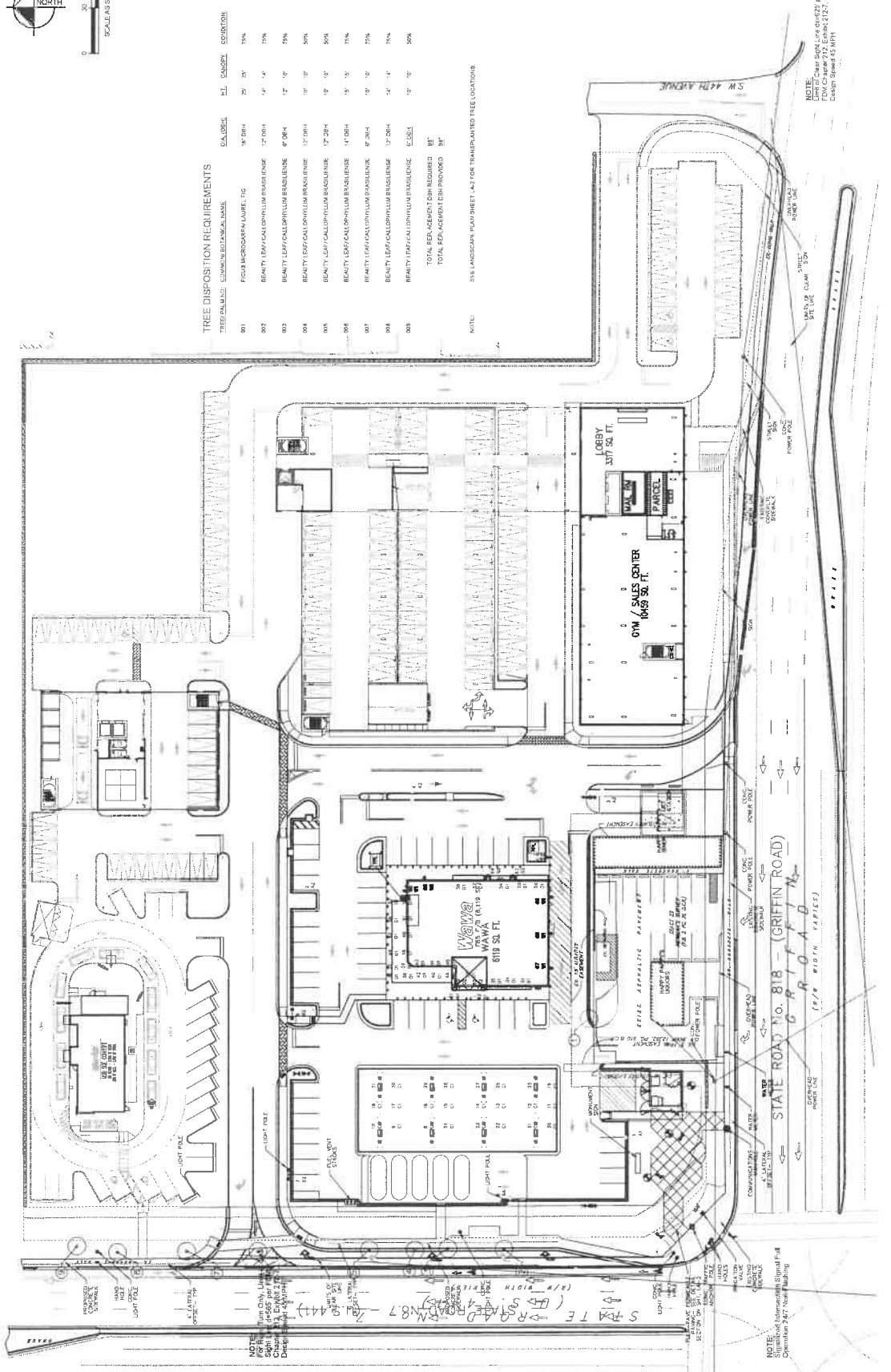

NOTE: For all trees, shrubs, and plants, the contractor shall provide and install all necessary irrigation, fertilization, and maintenance for the first year after installation. The contractor shall also provide and install all necessary mulch and stakes for all trees and shrubs.

NOTE: The contractor shall provide and install all necessary signage and wayfinding for the project. The contractor shall also provide and install all necessary lighting for the project.

TREE DISPOSITION PLAN

PARCEL A'
US 441 & GRIFFIN PLAZA

FLORIDA
HOLLYWOOD

FDOT Landscape
Permit Number
2019-L-481-00005

811
KNOW WHAT'S BELOW
BEFORE YOU DIG
www.call811.com

LA-4
SHEET NUMBER

ALPHA PACIFICA LLC
12/05/19
DATE

REVISIONS
DATE

DESIGNED BY
CHECKED BY
DATE

SCALE 1" = 30'

0 30 60

12/05/19

