

MATCH LINE SEE SHEET C14

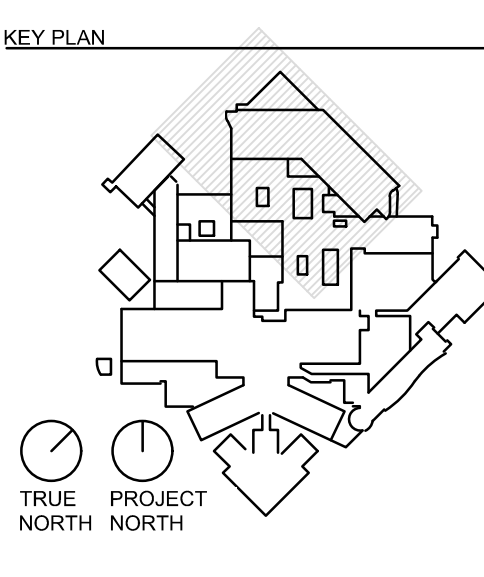

JAMES D. MESSICK, STATE OF FLORIDA,  
PROFESSIONAL ENGINEER, LICENSE NO. 70870.  
THIS ITEM HAS BEEN DIGITALLY SIGNED AND SEALED  
BY JAMES D. MESSICK ON THE DATE INDICATED HERE.  
PRINTED COPIES OF THIS DOCUMENT ARE NOT  
CONSIDERED SIGNED AND SEALED AND THE  
SIGNATURE MUST BE VERIFIED ON ANY ELECTRONIC  
COPIES.

HKS PROJECT NUMBER  
**23459.000**  
DATE  
**NOVEMBER 21, 2024**  
ISSUE  
**ISSUED FOR CONSTRUCTION**  
SHEET TITLE  
**UTILITY PLAN**

SHEET NO.  
**C13**

TITLE BLOCK VERSION: 20210820  
MODEL: P:\PROJECTS\2024\23459\HKS\EXPANSION\23459\_01\URN OR EXPANSION\ENABLING CIVIL DESIGN & LAYOUT  
DATE: 11/21/2024 10:55:59 AM TEMPLATE VERSION: 21.03.20240801

MATCH LINE SEE SHEET C16

ISSUED FOR CONSTRUCTION  
ELEVATIONS ARE IN NAVD 88

**C13** UTILITY PLAN  
1" = 20'-0"



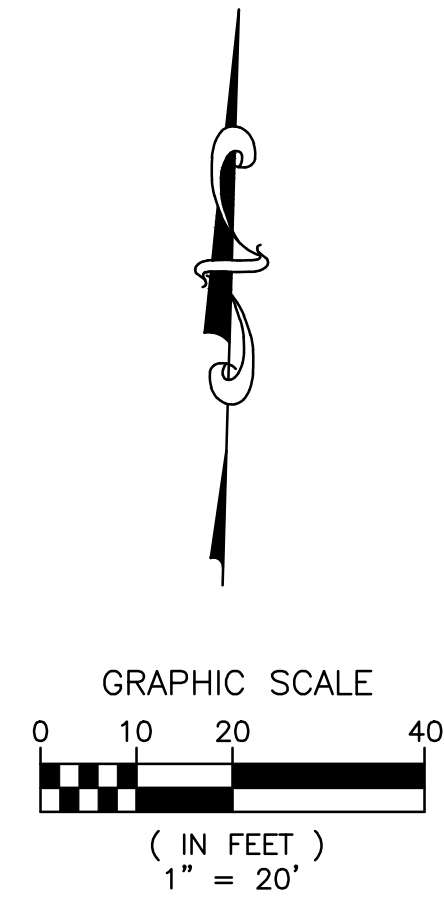

# NO PROPOSED SITE UTILITY IMPROVEMENTS THIS SHEET

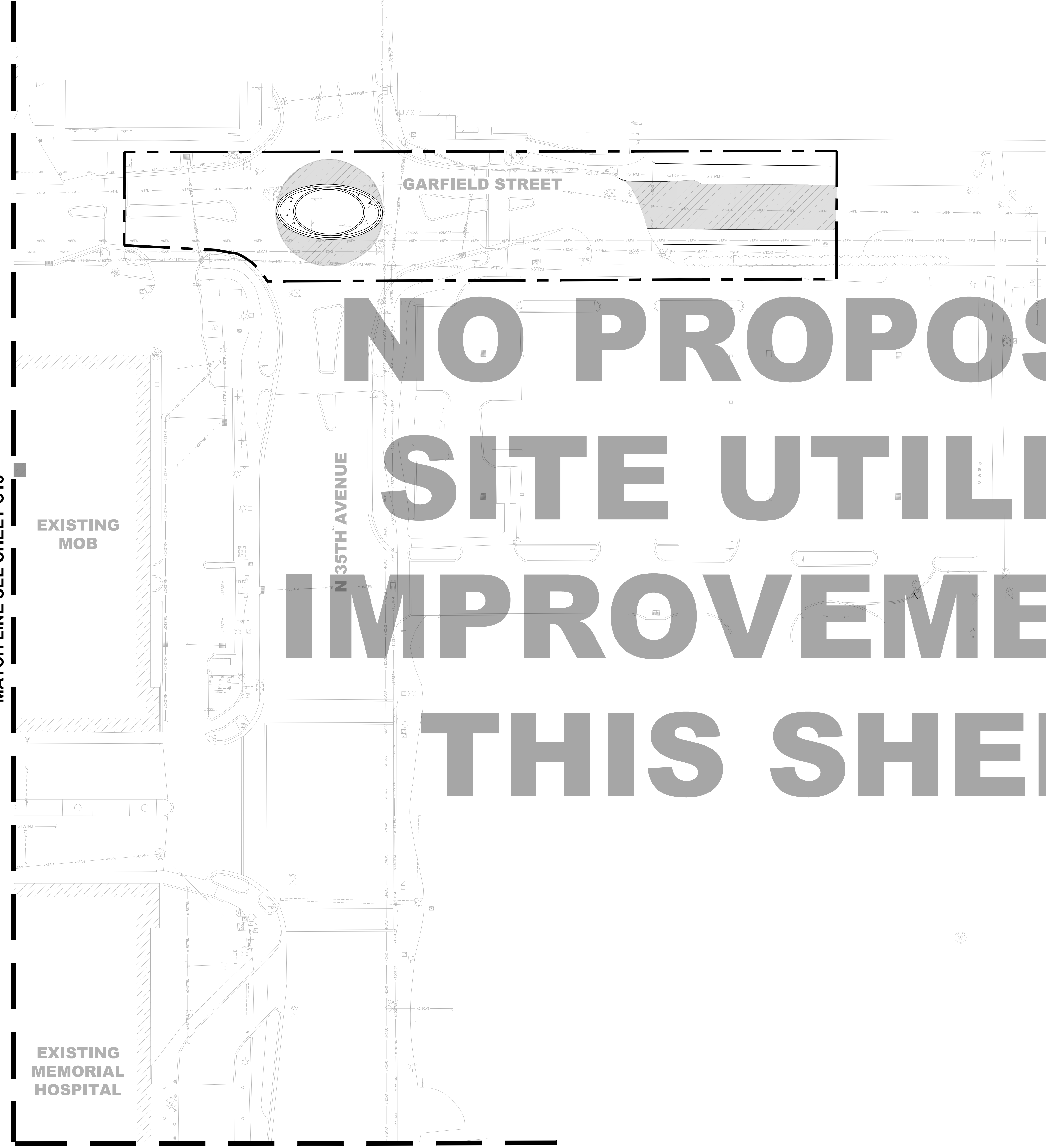

MATCH LINE SEE SHEET C13

MATCH LINE SEE SHEET C15

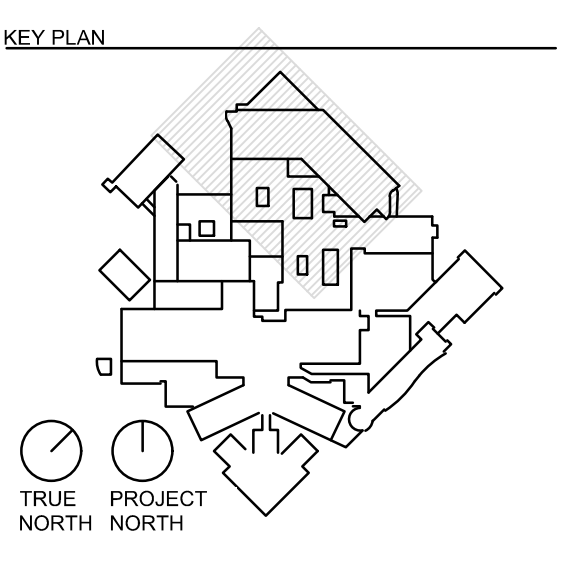

JAMES D. MESSICK, STATE OF FLORIDA,  
PROFESSIONAL ENGINEER, LICENSE NO. 70870.  
THIS ITEM HAS BEEN DIGITALLY SIGNED AND SEALED  
BY JAMES D. MESSICK ON THE DATE INDICATED HERE.  
PRINTED COPIES OF THIS DOCUMENT ARE NOT  
CONSIDERED SIGNED AND SEALED AND THE  
SIGNATURE MUST BE VERIFIED ON ANY ELECTRONIC  
COPIES.

HKS PROJECT NUMBER  
**23459.000**  
DATE  
**NOVEMBER 21, 2024**  
ISSUE  
**ISSUED FOR  
CONSTRUCTION**  
SHEET TITLE  
**UTILITY PLAN**



MATCH LINE SEE SHEET C14

EXISTING  
MEMORIAL  
HOSPITAL

# NO PROPOSED SITE UTILITY IMPROVEMENTS THIS SHEET

N 35TH AVENUE

NFA-10.2.3.2.2.1: 450 FT  
FROM ANY PORTION OF BUILDING

FIRE DEPARTMENT ACCESS ROAD  
TO BE KEPT UNOBSTRUCTED WITH  
A HEIGHT OF NOT LESS THAN 13'-6"

CITY OF HOLLYWOOD  
FIRE DEPARTMENT  
INTERNAL RADIUS = 28'-5"  
EXTERNAL RADIUS = 45'  
(TYP.)

20' FIRE DEPARTMENT ACCESS ROUTE

ISSUED FOR CONSTRUCTION  
ELEVATIONS ARE IN NAVD 88

**C15** UTILITY PLAN  
1" = 20'-0"

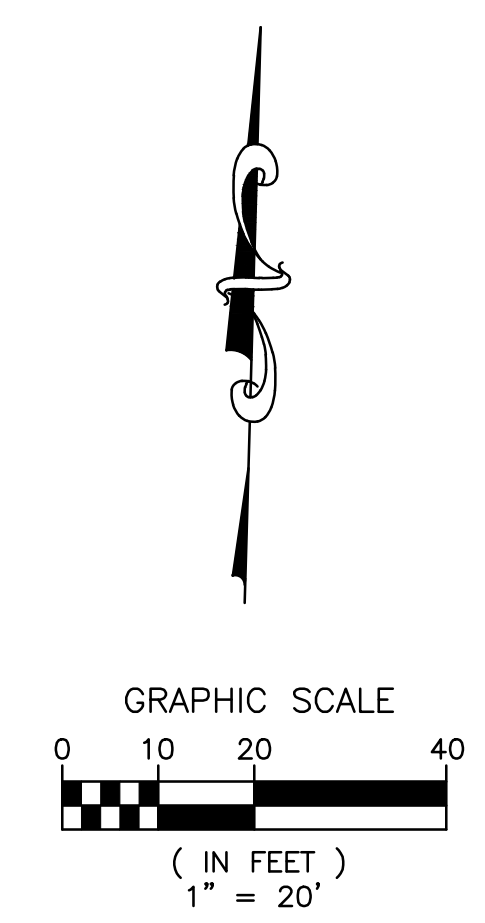

# HKS

**ARCHITECT**  
HKS ARCHITECTS, INC.  
2020 SALZEDO STREET, 4TH FLOOR  
CORAL GABLES, FL 33154

**INTERIOR DESIGNER**  
HKS ARCHITECTS  
225 EAST ROBINSON ST, SUITE #405  
ORLANDO, FL 32801

**CIVIL & LANDSCAPE**  
CALVIN GUERINO & ASSOCIATES  
1800 ELLER DRIVE, SUITE 600  
FORT LAUDERDALE, FL 33316

**STRUCTURAL ENGINEER**  
GMS STRUCTURAL ENGINEERS  
14335 COMMERCE WAY  
MIAMI LAKES, FL 33016

**MEP & FIRE PROTECTION**  
TLC ENGINEERING SOLUTIONS, INC.  
800 FAIRWAY DRIVE  
DEERFIELD BEACH, FL 33441

**TELECOM & EQUIPMENT**  
SMITH SECKMAN REID, INC.  
2995 SISCO DRIVE  
NASHVILLE, TN 37204

**OWNER**  
MEMORIAL HEALTHCARE SYSTEM  
3501 JOHNSON STREET  
HOLLYWOOD, FL 33021



KEY PLAN

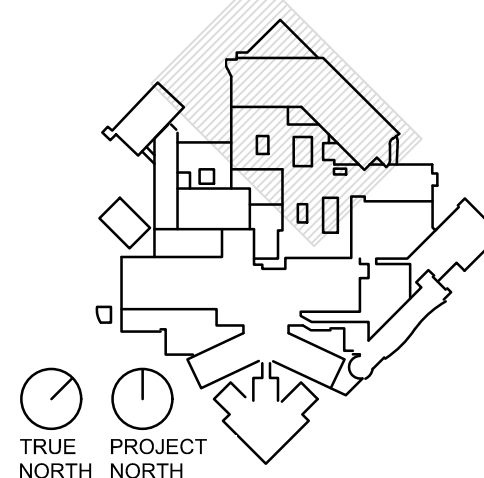

JAMES D. MESSICK, STATE OF FLORIDA,  
PROFESSIONAL ENGINEER, LICENSE NO. 70870.  
THIS ITEM HAS BEEN DIGITALLY SIGNED AND SEALED  
BY JAMES D. MESSICK ON THE DATE INDICATED HERE.  
PRINTED COPIES OF THIS DOCUMENT ARE NOT  
CONSIDERED SIGNED AND SEALED AND THE  
SIGNATURE MUST BE VERIFIED ON ANY ELECTRONIC  
COPIES.

HKS PROJECT NUMBER  
**23459.000**

DATE  
**NOVEMBER 21, 2024**

ISSUE  
**ISSUED FOR  
CONSTRUCTION**  
SHEET TITLE  
**UTILITY PLAN**

SHEET NO.

# C15

© 2023 HKS, INC.

PRINT DATE: 10/20/2023 10:52:59 AM TEMPLATE VERSION: 21.03.2020(081) MODEL: P:\PROJECTS\2023\215580.HR\10R EXPANSION\215580\_10.10R OR EXPANSION ENABLING CIVIL DESIGN & CAD\415580\DWG\ENABLING\_PACKAGE\_C15.rvt TITLE BLOCK VERSION: 2021(050)

MATCH LINE SEE SHEET C16



MATCH LINE SEE SHEET C13

HKS

ARCHITECT  
HKS ARCHITECTS, INC.  
2020 SALZEDO STREET, 4TH FLOOR  
CORAL GABLES, FL 33154

INTERIOR DESIGNER  
HKS ARCHITECTS  
225 EAST ROBINSON ST, SUITE #405  
ORLANDO, FL 32801

CIVIL & LANDSCAPE  
CALVIN GUERINO & ASSOCIATES  
1800 ELLER DRIVE, SUITE 600  
FORT LAUDERDALE, FL 33316

STRUCTURAL ENGINEER  
GMS STRUCTURAL ENGINEERS  
14335 COMMERCE WAY  
MIAMI LAKES, FL 33016



MEP & FIRE PROTECTION  
TLC ENGINEERING SOLUTIONS, INC.  
800 FAIRWAY DRIVE  
DEERFIELD BEACH, FL 33441

TELECOM & EQUIPMENT  
SMITH SECKMAN REED, INC.  
2995 SISCO DRIVE  
NASHVILLE, TN 37204

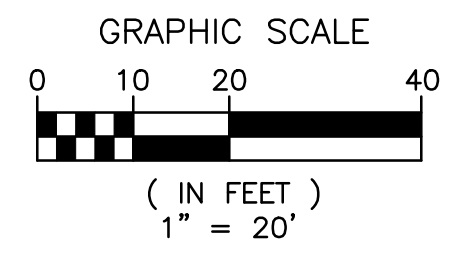
OWNER  
MEMORIAL HEALTHCARE SYSTEM  
3501 JOHNSON STREET  
HOLLYWOOD, FL 33021

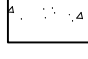
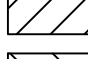
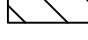

HATCHING LEGEND

-  PROPOSED DETECTABLE WARNING SURFACES
-  PROPOSED ASPHALT RESTORATION
-  PROPOSED CONCRETE SIDEWALK/CONCRETE RESTORATION
-  PROPOSED FIRE DEPARTMENT ACCESS ROUTE
-  PROPOSED TEMPORARY FIRE DEPARTMENT ACCESS ROUTE (DURING CONSTRUCTION)

**Memorial Regional Hospital**  
SURGICAL & CRITICAL CARE TOWER EXPANSION  
ENABLING PACKAGE  
3501 JOHNSON STREET, HOLLYWOOD, FL 33021

KEY PLAN

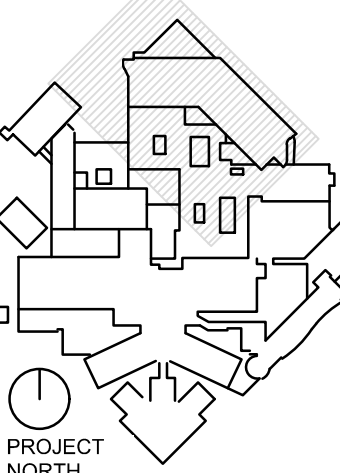

JAMES D. MESSICK, STATE OF FLORIDA,  
PROFESSIONAL ENGINEER, LICENSE NO. 70870.  
THIS ITEM HAS BEEN DIGITALLY SIGNED AND SEALED  
BY JAMES D. MESSICK ON THE DATE INDICATED HERE.  
PRINTED COPIES OF THIS DOCUMENT ARE NOT  
CONSIDERED SIGNED AND SEALED AND THE  
SIGNATURE MUST BE VERIFIED ON ANY ELECTRONIC  
COPIES.

HKS PROJECT NUMBER  
**23459.000**  
DATE  
**NOVEMBER 21, 2024**  
ISSUE  
**ISSUED FOR CONSTRUCTION**  
SHEET TITLE  
**UTILITY PLAN**

SHEET NO.  
**C16**

MATCH LINE SEE SHEET C15

EXISTING  
MEMORIAL  
HOSPITAL

N 37TH AVENUE

EXISTING PARKING  
GARAGE STRUCTURE

EXISTING  
FUEL OIL  
PUMP ROOM

PROP. UTILITY TRENCH RESTORATION  
(SEE DETAIL C-02 ON SHEET C10 FOR  
TRENCH DETAILS AND STRUCTURAL  
PLANS FOR CONCRETE SLAB-ON-GRADE  
WITH REBAR RESTORATION)

PROP. 520 L.F. FUEL PIPE (SEE MEP  
PLANS FOR CONTINUATION)

PROP. FUEL TANK  
(SEE MEP PLANS  
FOR DETAILS AND  
FINAL PIPE  
ALIGNMENT TO  
TANKS)

ISSUED FOR CONSTRUCTION  
ELEVATIONS ARE IN NAVD 88

**C16** UTILITY PLAN  
1" = 20'-0"



© 2023 HKS, INC.

TITLE BLOCK VERSION: 20230820

MODEL: P:\PROJECTS\2023\23459\_HH\EXPANSION\ENABLING CIVIL DESIGN & CONSTRUCTION\ENABLING\_PACKAGE\UTILITY\_PLAN.dwg

PRINT DATE: 10/23/2023 10:55:59 AM TEMPLATE VERSION: 21.03.202008181





TITLE BLOCK VERSION: 20110608  
 MODEL: P:\PROJECTS\2024\15580\15580.MXD FOR EXPANSION\215580\_10.DWG OR EXPANSION\ENABLING CIVIL DESIGN & CONSTRUCTION\215580\_10.DWG  
 PRINT DATE: 10/20/2024 10:52:56 AM TEMPLATE VERSION: 21.03.20201811

**FLEXIBLE PAVEMENT RESTORATION NOTES:**

- THE ABOVE DETAILS APPLY ONLY TO ASPHALT PAVEMENT RESTORATION OVER UTILITY TRENCHES CUT WITHIN CITY OF HOLLYWOOD RIGHTS-OF-WAY. FOR PAVEMENT RESTORATION WITHIN BROWARD COUNTY OR FDOT RIGHTS-OF-WAY REFER TO THE CORRESPONDING DETAILS FOR THOSE AGENCIES.
- LIMEROCK BASE MATERIAL SHALL HAVE A MINIMUM L.B.R. OF 100 AND A MINIMUM CARBONATE CONTENT OF 70%. REPLACED BASE MATERIAL OVER TRENCH SHALL BE A MINIMUM OF 12" THICK.
- LIMEROCK BASE MATERIAL SHALL BE PLACED IN 12" MAXIMUM (LOOSE MEASUREMENT) THICKNESS LAYERS WITH EACH LAYER THOROUGHLY ROLLED OR TAMPED AND COMPACTED TO 100% OF MAXIMUM DENSITY, PER AASHTO T-180, PRIOR TO THE PLACEMENT OF THE SUCCEEDING LAYERS.
- STABILIZED SUBGRADE MATERIAL SHALL BE GRANULAR AND SHALL HAVE A MINIMUM L.B.R. OF 40.
- BACKFILL SHALL BE PLACED AND COMPACTED IN ACCORDANCE WITH THE PIPE LAYING CONDITION TYPICAL SECTIONS IN DETAILS G-02 AND G-03, AND THE SPECIFICATIONS, BUT TESTING WILL BEGIN 12" ABOVE THE INSTALLED FACILITY.
- ALL EDGES AND JOINTS OF EXISTING ASPHALT PAVEMENT SHALL BE SAW CUT TO STRAIGHT LINES, PARALLEL TO OR PERPENDICULAR TO THE ROADWAY, PRIOR TO THE RESURFACING.
- RESURFACING MATERIAL SHALL BE FDOT SUPERPAVE, AND SHALL BE APPLIED A MINIMUM OF TWO INCH IN THICKNESS.
- MILL AND BUTT JOINT TO EXISTING PAVEMENT.
- IF THE TRENCH IS FILLED TEMPORARILY, IT SHALL BE COVERED WITH A 2" ASPHALTIC CONCRETE PATCH TO KEEP THE FILL MATERIAL FROM RAVELING UNTIL REPLACED WITH A PERMANENT PATCH.
- REFER TO SPECIFICATIONS FOR DETAILED PROCEDURES.
- WHERE THE UTILITY TRENCH CROSSES EXISTING ASPHALT DRIVEWAYS, THE LIMEROCK BASE THICKNESS MAY BE A MINIMUM OF 6 INCHES THICK, REGARDLESS OF THE EXTENT OF IMPACT, THE ENTIRE DRIVEWAY SURFACE BETWEEN THE EDGE OF THE ROADWAY PAVEMENT AND PROPERTY LINE OR FRONT OF SIDEWALK SHALL BE OVERLAID USING 2-INCH THICK MINIMUM ASPHALTIC CONCRETE SURFACE COURSE WHERE INDICATED ON THE PLANS OR AS DIRECTED BY THE CITY/ENGINEER.

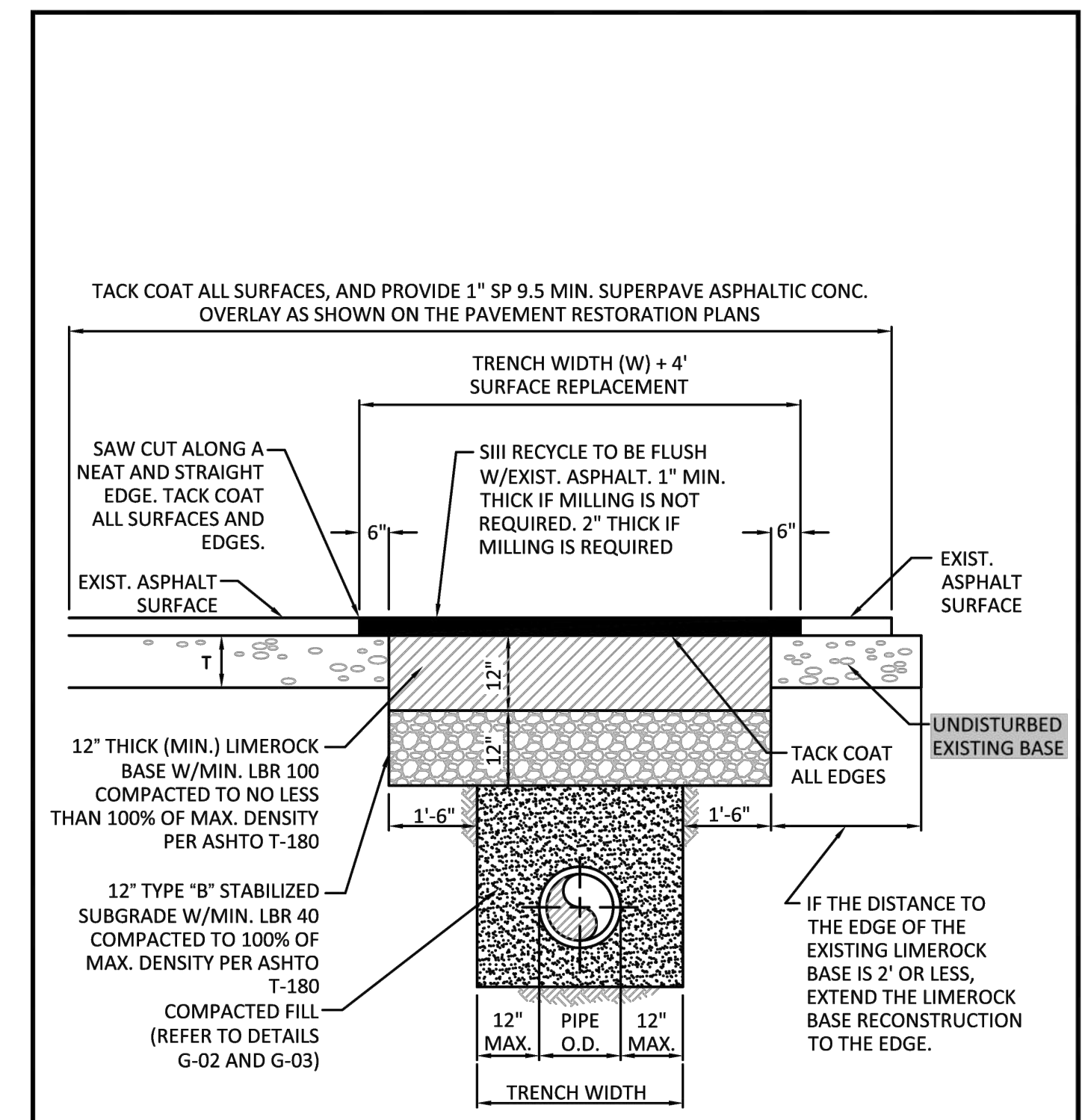
	ISSUED: 03/01/1994	DEPARTMENT OF PUBLIC UTILITIES STANDARD DETAIL	REVISED: 11/06/2017
	DRAWN: EAH	<b>FLEXIBLE PAVEMENT RESTORATION NOTES</b>	DRAWING NO. <b>G-12</b>
	APPROVED: XXX		



	ISSUED: 03/01/1994	DEPARTMENT OF PUBLIC UTILITIES STANDARD DETAIL	REVISED: 11/06/2017
	DRAWN: EAH	<b>FLEXIBLE PAVEMENT RESTORATION FOR TRENCHES CUT PERPENDICULAR AND PARALLEL TO THE ROADWAY</b>	DRAWING NO. <b>G-12.1</b>
	APPROVED: XXX		

KEY PLAN

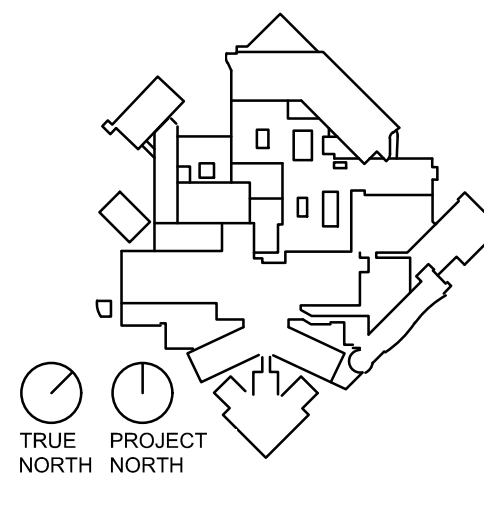

JAMES D. MESSICK, STATE OF FLORIDA, PROFESSIONAL ENGINEER, LICENSE NO. 70870.  
 THIS ITEM HAS BEEN DIGITALLY SIGNED AND SEALED BY JAMES D. MESSICK ON THE DATE INDICATED HERE.  
 PRINTED COPIES OF THIS DOCUMENT ARE NOT CONSIDERED SIGNED AND SEALED AND THE SIGNATURE MUST BE VERIFIED ON ANY ELECTRONIC COPIES.

HKS PROJECT NUMBER  
**23459.000**  
 DATE  
**NOVEMBER 21, 2024**  
 ISSUE  
**ISSUED FOR CONSTRUCTION**  
 SHEET TITLE  
**UTILITY DETAILS**

SHEET NO.

**C17**

ISSUED FOR CONSTRUCTION  
 ELEVATIONS ARE IN NAVD 88

**C17** UTILITY DETAILS  
 NOT TO SCALE



TITLE BLOCK VERSION: 20210502  
 MODEL: P:\PROJECTS\2024\15500\HOL FOR EXPANSION\215500\_10\DRN OR EXPANSION\ENABLING CIVIL DESIGN & CADD  
 11/23/2024 10:52:59 AM TEMPLATE VERSION: 21.03.2020\B01

**ARCHITECT**  
 HKS ARCHITECTS, INC.  
 2020 SALZEDO STREET, 4TH FLOOR  
 CORAL GABLES, FL 33154

**INTERIOR DESIGNER**  
 HKS ARCHITECTS  
 225 EAST ROBINSON ST, SUITE #405  
 ORLANDO, FL 32801

**CIVIL & LANDSCAPE**  
 CALVIN GUERINO & ASSOCIATES  
 1800 ELLER DRIVE, SUITE 600  
 FORT LAUDERDALE, FL 33316

**STRUCTURAL ENGINEER**  
 GMS STRUCTURAL ENGINEERS  
 14335 COMMERCE WAY  
 MIAMI LAKES, FL 33016

**MEP & FIRE PROTECTION**  
 TLC ENGINEERING SOLUTIONS, INC.  
 800 FAIRWAY DRIVE  
 DEERFIELD BEACH, FL 33441

**TELECOM & EQUIPMENT**  
 SMITH SECHMAN REID, INC.  
 2995 SISCO DRIVE  
 NASHVILLE, TN 37204

**OWNER**  
 MEMORIAL HEALTHCARE SYSTEM  
 3501 JOHNSON STREET  
 HOLLYWOOD, FL 33021

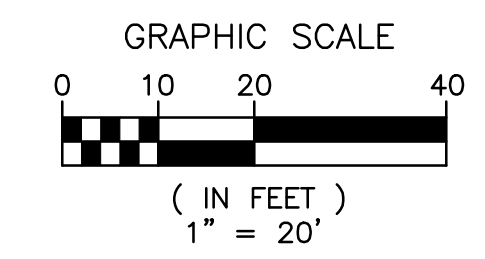

EXISTING  
 CONFERENCE  
 CENTER

GARFIELD STREET

HOSPITAL DRIVE

EXISTING PARKING  
 GARAGE STRUCTURE

EXISTING  
 MEMORIAL  
 HOSPITAL

MATCH LINE SEE SHEET C21

BCTD ASSIGNED REFERENCE NUMBER: 250123060

**C18** SIGNING AND PAVEMENT MARKING  
 PLAN  
 1" = 20'-0"

ISSUED FOR CONSTRUCTION  
 ELEVATIONS ARE IN NAVD 88

MATCH LINE SEE SHEET C19

Memorial  
 Regional Hospital  
 SURGICAL & CRITICAL CARE TOWER EXPANSION  
 ENABLING PACKAGE

3501 JOHNSON STREET, HOLLYWOOD, FL 33021

KEY PLAN

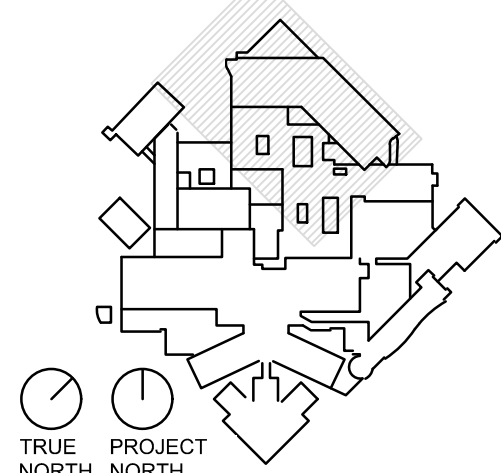

JAMES D. MESSICK, STATE OF FLORIDA,  
 PROFESSIONAL ENGINEER, LICENSE NO. 70870.  
 THIS ITEM HAS BEEN DIGITALLY SIGNED AND SEALED  
 BY JAMES D. MESSICK ON THE DATE INDICATED HERE.  
 PRINTED COPIES OF THIS DOCUMENT ARE NOT  
 CONSIDERED SIGNED AND SEALED AND THE  
 SIGNATURE MUST BE VERIFIED ON ANY ELECTRONIC  
 COPIES.

HKS PROJECT NUMBER  
**23459.000**  
 DATE  
**NOVEMBER 21, 2024**  
 ISSUE  
**ISSUED FOR  
 CONSTRUCTION**  
 SHEET TITLE  
**SIGNING AND  
 PAVEMENT MARKING  
 PLAN**  
 SHEET NO.  
**C18**







MATCH LINE SEE SHEET C19

EXISTING  
MEMORIAL  
HOSPITAL

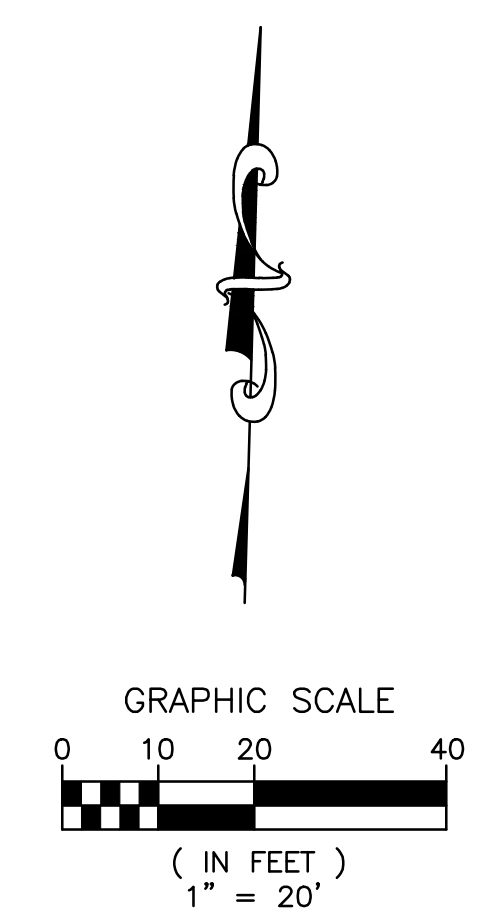

# HKS

**ARCHITECT**  
HKS ARCHITECTS, INC.  
2020 SALZEDO STREET, 4TH FLOOR  
CORAL GABLES, FL 33134

**INTERIOR DESIGNER**  
HKS ARCHITECTS  
225 EAST ROBINSON ST, SUITE #405  
ORLANDO, FL 32801

**CIVIL & LANDSCAPE**  
CALVIN GUERINO & ASSOCIATES  
1800 ELLER DRIVE, SUITE 600  
FORT LAUDERDALE, FL 33316

**STRUCTURAL ENGINEER**  
GMS STRUCTURAL ENGINEERS  
14335 COMMERCE WAY  
MIAMI LAKES, FL 33016

**MEP & FIRE PROTECTION**  
TLC ENGINEERING SOLUTIONS, INC.  
800 FAIRWAY DRIVE  
DEERFIELD BEACH, FL 33441

**TELECOM & EQUIPMENT**  
SMITH SECKMAN REID, INC.  
2995 SISCO DRIVE  
NASHVILLE, TN 37204

**OWNER**  
MEMORIAL HEALTHCARE SYSTEM  
3501 JOHNSON STREET  
HOLLYWOOD, FL 33021

**Memorial  
Regional Hospital**

**SURGICAL & CRITICAL CARE TOWER EXPANSION  
ENABLING PACKAGE**

3501 JOHNSON STREET, HOLLYWOOD, FL 33021

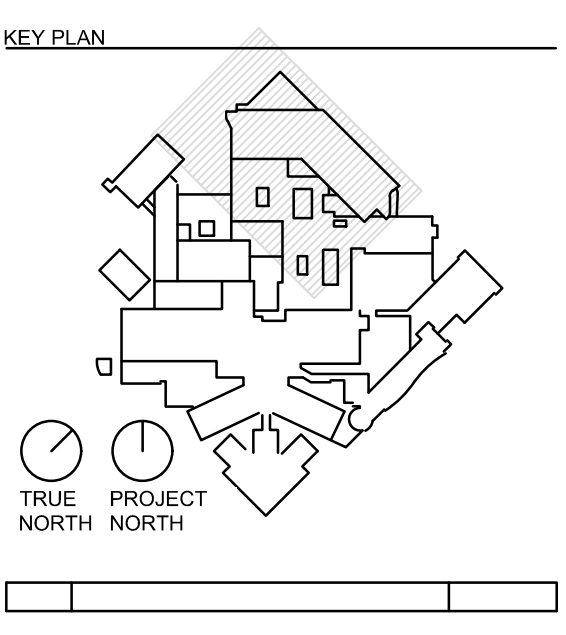

JAMES D. MESSICK, STATE OF FLORIDA,  
PROFESSIONAL ENGINEER, LICENSE NO. 70870.  
THIS ITEM HAS BEEN DIGITALLY SIGNED AND SEALED  
BY JAMES D. MESSICK ON THE DATE INDICATED HERE.  
PRINTED COPIES OF THIS DOCUMENT ARE NOT  
CONSIDERED SIGNED AND SEALED AND THE  
SIGNATURE MUST BE VERIFIED ON ANY ELECTRONIC  
COPIES.

HKS PROJECT NUMBER  
**23459.000**  
DATE  
**NOVEMBER 21, 2024**  
ISSUE  
**ISSUED FOR  
CONSTRUCTION**  
SHEET TITLE  
**SIGNING AND  
PAVEMENT MARKING  
PLAN**  
SHEET NO.  
**C20**

MATCH LINE SEE SHEET C21

PRINT DATE: 12/20/23 10:52:59 AM MODEL: P:\PROJECTS\2023\215590.HRN FOR EXPANSION\215590\_10.HRN OR EXPANSION ENABLING CIVIL DESIGN & CAD\215590\_10.DWG



**NOTES:**  
GENERAL NOTES:  
1. REFER TO WAYFINDING PLANS FOR PROPOSED SIGNAGE FOR ENABLING PHASE.

BCTD ASSIGNED REFERENCE NUMBER: 250123060

**C20** **SIGNING AND PAVEMENT MARKING PLAN**  
1" = 20'-0"

ISSUED FOR CONSTRUCTION  
ELEVATIONS ARE IN NAVD 88

© 2023 HKS, INC.



MATCH LINE SEE SHEET C18

HKS

ARCHITECT  
HKS ARCHITECTS, INC.  
2020 SALZEDO STREET, 4TH FLOOR  
CORAL GABLES, FL 33154

INTERIOR DESIGNER  
HKS ARCHITECTS  
225 EAST ROBINSON ST, SUITE #405  
ORLANDO, FL 32801

CIVIL & LANDSCAPE  
CALVIN GIORDANO & ASSOCIATES  
1800 ELLER DRIVE, SUITE 600  
FORT LAUDERDALE, FL 33316

STRUCTURAL ENGINEER  
GMS STRUCTURAL ENGINEERS  
14335 COMMERCE WAY  
MIAMI LAKES, FL 33016

MEP & FIRE PROTECTION  
TLC ENGINEERING SOLUTIONS, INC.  
800 FAIRWAY DRIVE  
DEERFIELD BEACH, FL 33441

TELECOM & EQUIPMENT  
SMITH SECKMAN REID, INC.  
2995 SISCO DRIVE  
NASHVILLE, TN 37204

OWNER  
MEMORIAL HEALTHCARE SYSTEM  
3501 JOHNSON STREET  
HOLLYWOOD, FL 33021

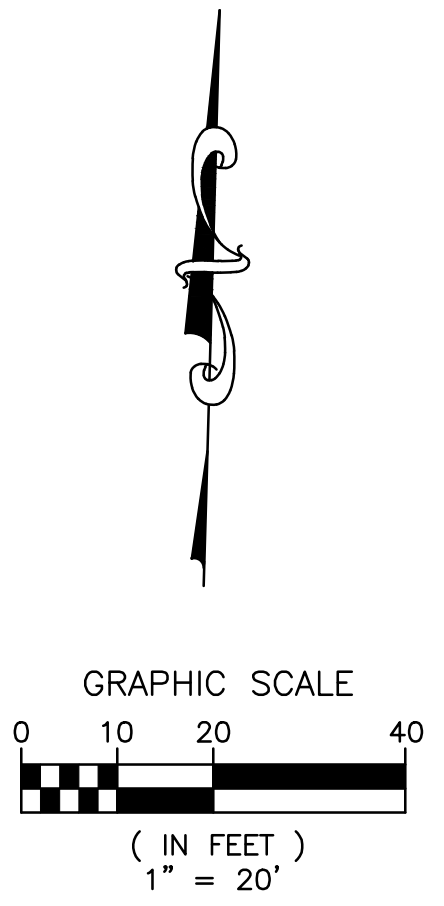

**NO PROPOSED  
STRIPING  
IMPROVEMENTS  
THIS SHEET**

EXISTING  
MEMORIAL  
HOSPITAL

MATCH LINE SEE SHEET C20

**Memorial  
Regional Hospital**  
SURGICAL & CRITICAL CARE TOWER EXPANSION  
ENABLING PACKAGE  
3501 JOHNSON STREET, HOLLYWOOD, FL 33021

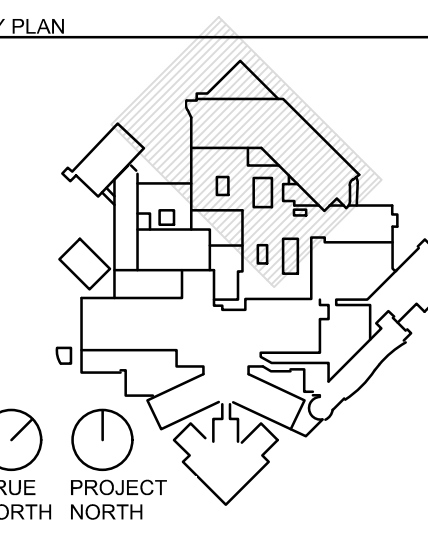

JAMES D. MESSICK, STATE OF FLORIDA,  
PROFESSIONAL ENGINEER, LICENSE NO. 70870.  
THIS ITEM HAS BEEN DIGITALLY SIGNED AND SEALED  
BY JAMES D. MESSICK ON THE DATE INDICATED HERE.  
PRINTED COPIES OF THIS DOCUMENT ARE NOT  
CONSIDERED SIGNED AND SEALED AND THE  
SIGNATURE MUST BE VERIFIED ON ANY ELECTRONIC  
COPIES.

HKS PROJECT NUMBER  
**23459.000**  
DATE  
**NOVEMBER 21, 2024**  
ISSUE  
**ISSUED FOR  
CONSTRUCTION**  
SHEET TITLE  
**SIGNING AND  
PAVEMENT MARKING  
PLAN**  
SHEET NO.

BCTED ASSIGNED REFERENCE NUMBER: 250123060

**C21** SIGNING AND PAVEMENT MARKING  
PLAN  
1" = 20'-0"

ISSUED FOR CONSTRUCTION  
ELEVATIONS ARE IN NAVD 88

© 2023 HKS, INC.

**C21**

TITLE BLOCK VERSION: 20210502  
MODEL: P:\PROJECTS\2021\715590.HKH FOR EXPANSION\215590\_10.URN OR EXPANSION ENABLING CIVIL DESIGN & LAYOUT  
PRINT DATE: 10/23/2023 10:55:59 AM TEMPLATE VERSION: 21.03.20201801



Broward County Traffic Engineering Division Communications Notes

To be placed within plan set (Revised: 10/13/2015)

The agency responsible for maintenance of the traffic signals and related equipment is Broward County Traffic Engineering Division (BCTED). All system communications equipment, cabling and related material shall comply with Broward County's latest edition of the minimum standards as expressed in the "Standards and Specifications - Communication Infrastructure" document. Please refer to (BCTED's) Communications Policies and Procedures for additional information. Broward County Traffic Engineering Division will not accept any projects that do not meet these standards and specifications. If fiber optic pull boxes already exist at an intersection, no additional fiber optic pull boxes will need to be installed. For a copy of these standards refer to the Broward County web site at [www.BROWARD.ORG/TRAFFIC](http://www.BROWARD.ORG/TRAFFIC) under publications.

If there are Copper Interconnect Cables within your project limits or within 1500 feet of your project limits, contact the Communications Manager at [tccommunications@broward.org](mailto:tccommunications@broward.org) or 954-847-2745.

If there are Fiber Optic Cables within your project limits or within 1500 feet of your project limits contact the Communications Manager at [tccommunications@broward.org](mailto:tccommunications@broward.org) or 954-847-2745.

If there are cellular communications within your project limits, contact the Communications Manager at [tccommunications@broward.org](mailto:tccommunications@broward.org) or 954-847-2745

All BCTED communications cables/conduit shall be located a minimum of 48 hours in advance.

Broward County Traffic Engineering Division  
Procedure for Notification of Communication Disruption

**Copper Interconnect Cable Notification Contact Person**  
When communications to an intersection must be disrupted by a Contractor to perform work, the Contractor shall provide two day advance notice in writing to the Broward County Traffic Engineering Division. This notification shall be conveyed via electronic mail (email) to the Traffic Signal Technician III at [tccommunications@broward.org](mailto:tccommunications@broward.org). Notification shall include contact person, telephone number, purpose, location and duration. The disruption shall last for no more than 3 consecutive business days. Where possible, the disruption shall be during off peak hours beginning at 9:00am and ending at 3:00pm.

**Fiber Optic Cable Notification Contact Person**  
When communications to an intersection must be disrupted by a Contractor to perform work, the Contractor shall provide two day advance notice in writing to the Communications Manager at [tccommunications@broward.org](mailto:tccommunications@broward.org). Notification shall be conveyed via electronic mail (email) to the Communications Manager at [tccommunications@broward.org](mailto:tccommunications@broward.org). Notification shall include contact person, telephone number, purpose, location and duration. The disruption shall last for no more than 3 consecutive business days. Where possible, the disruption shall be during off peak hours beginning at 9:00am and ending at 3:00pm.

Include the following in any notice of utility ownership or within a "Utility Owners/Contact Person" table:  
Interconnect Communications Cables - (Robert Blount) Broward County Traffic Engineering Division (BCTED) 954-847-2745

W11-2 (30"x 30") & SUPPLEMENTAL (24"x 12") SIGN ASSEMBLY

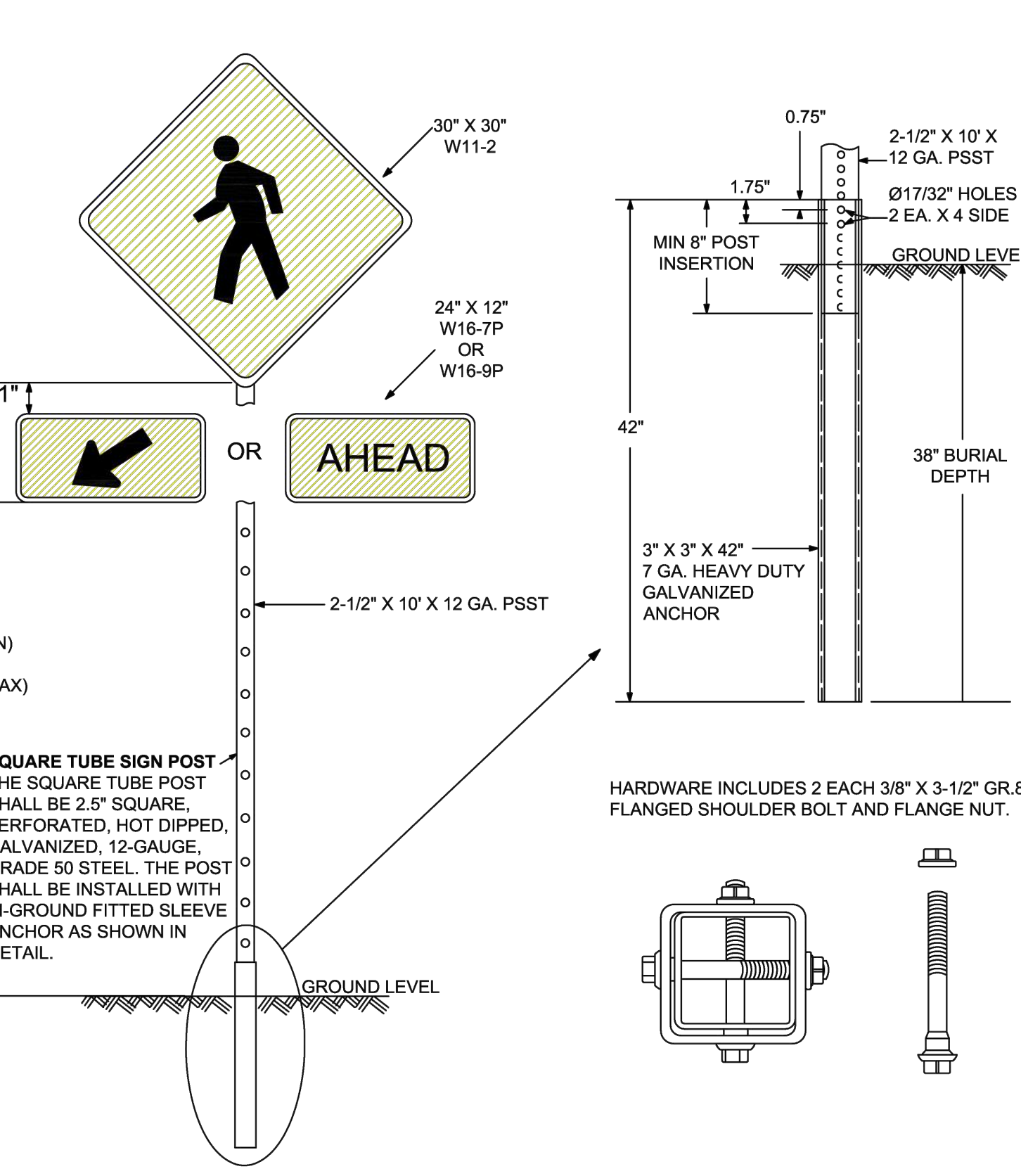

1. SCHOOL ZONE AND PEDESTRIAN SIGNS SHALL BE COMPRISED OF REFLECTIVE FLOURESCENT YELLOW-GREEN SHEETING. (SEE BCTED TECHNICAL POLICY MEMO #TPM-16-001 ON BCTED WEBSITE)  
2. NOT FOR USE WITH RECTANGULAR RAPID FLASHING BEACONS

PUBLIC WORKS DEPARTMENT  
TRAFFIC ENGINEERING DIVISION  
W11-2 (30"x 30") & SUPPLEMENTAL (24"x 12") SIGN ASSEMBLY  
REVISION: 11-15-18 SCALE: NTS  
DESIGNED BY: YVES DANJOUI, P.E.  
DRAWN BY: STEPHON RAMOUTAR  
CHECKED BY: ANDREW SEBO, P.E., PTOE  
SHEET 1 OF 1

Sign Post with 3" x 7 ga. Square Anchor

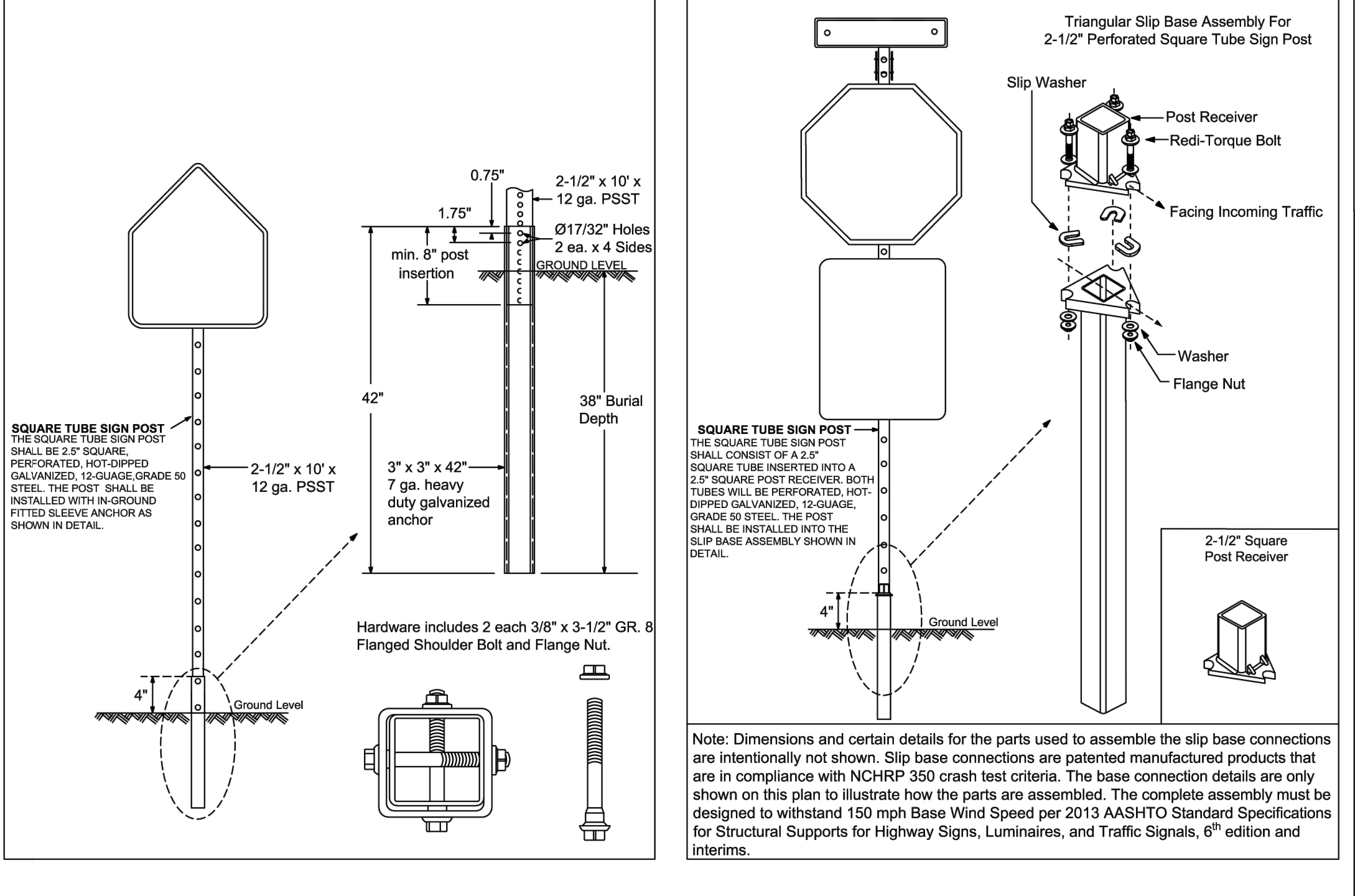

Sign Post with Triangular Slip Base

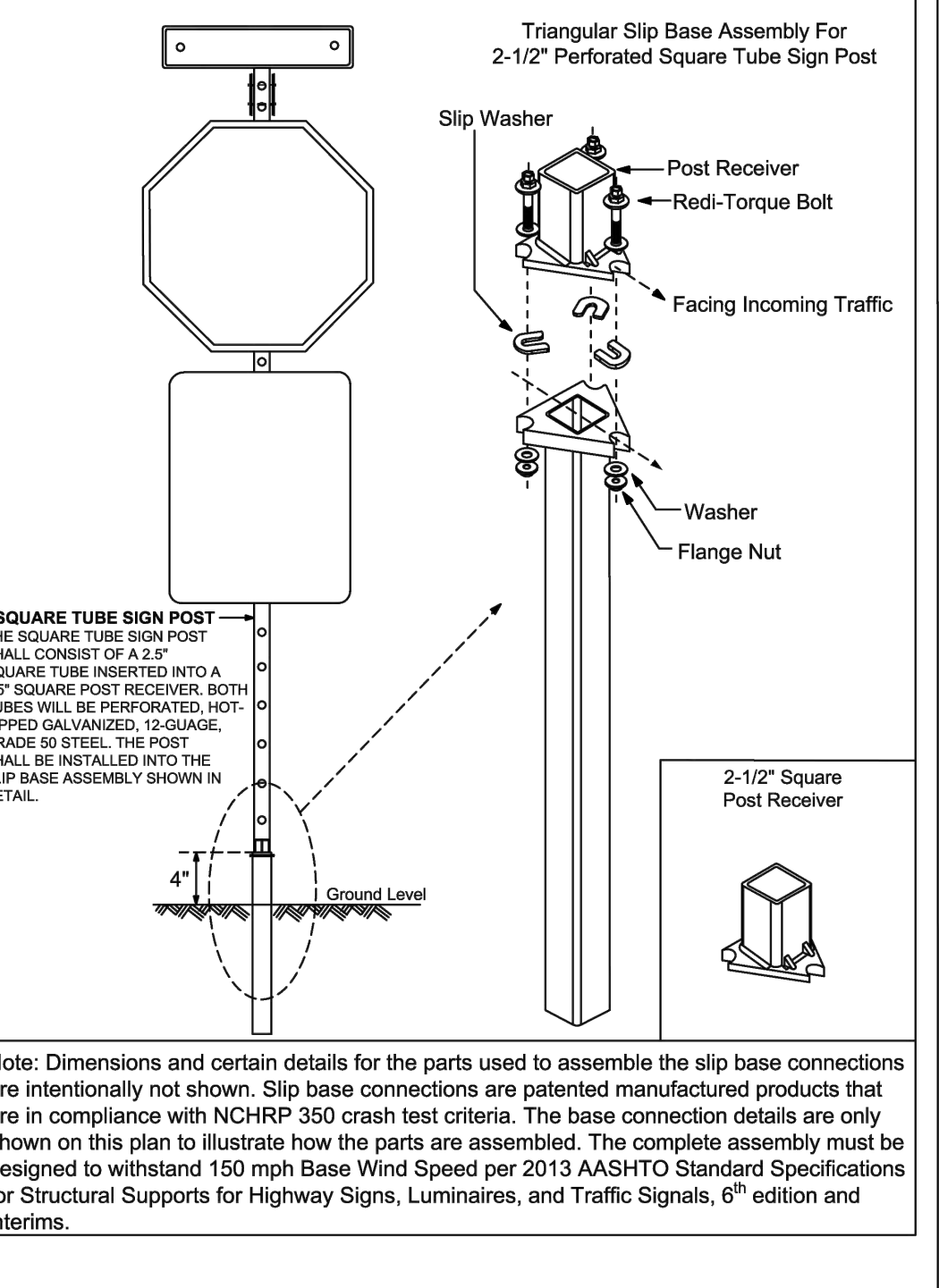

Note: Dimensions and certain details for the parts used to assemble the slip base connections are intentionally not shown. Slip base connections are patented manufactured products that are in compliance with NCHRP 350 crash test criteria. The base connection details are only shown on this plan to illustrate how the parts are assembled. The complete assembly must be designed to withstand 150 mph Base Wind Speed per 2013 AASHTO Standard Specifications for Structural Supports for Highway Signs, Luminaires, and Traffic Signals, 6<sup>th</sup> edition and interims.

PUBLIC WORKS DEPARTMENT  
TRAFFIC ENGINEERING DIVISION  
DESIGN BY: YVES DANJOUI, P.E.  
DRAWN BY: STEPHON RAMOUTAR  
CHECKED BY: ANDREW SEBO, P.E., PTOE  
SCALE: NTS  
SHEET NO. 1 OF 1

**GUIDE TO USE THIS STANDARD:**  
1. Calculate the Total Panel Area and the centroid 'C' for an individual sign or a sign cluster.  
2. Determine the height 'H' from the groundline for the individual sign or the cluster.  
3. Consult the Post Size Table and find the intersection point.  
4. Design the post and the foundation according to the required Post Size and Assembly Details.

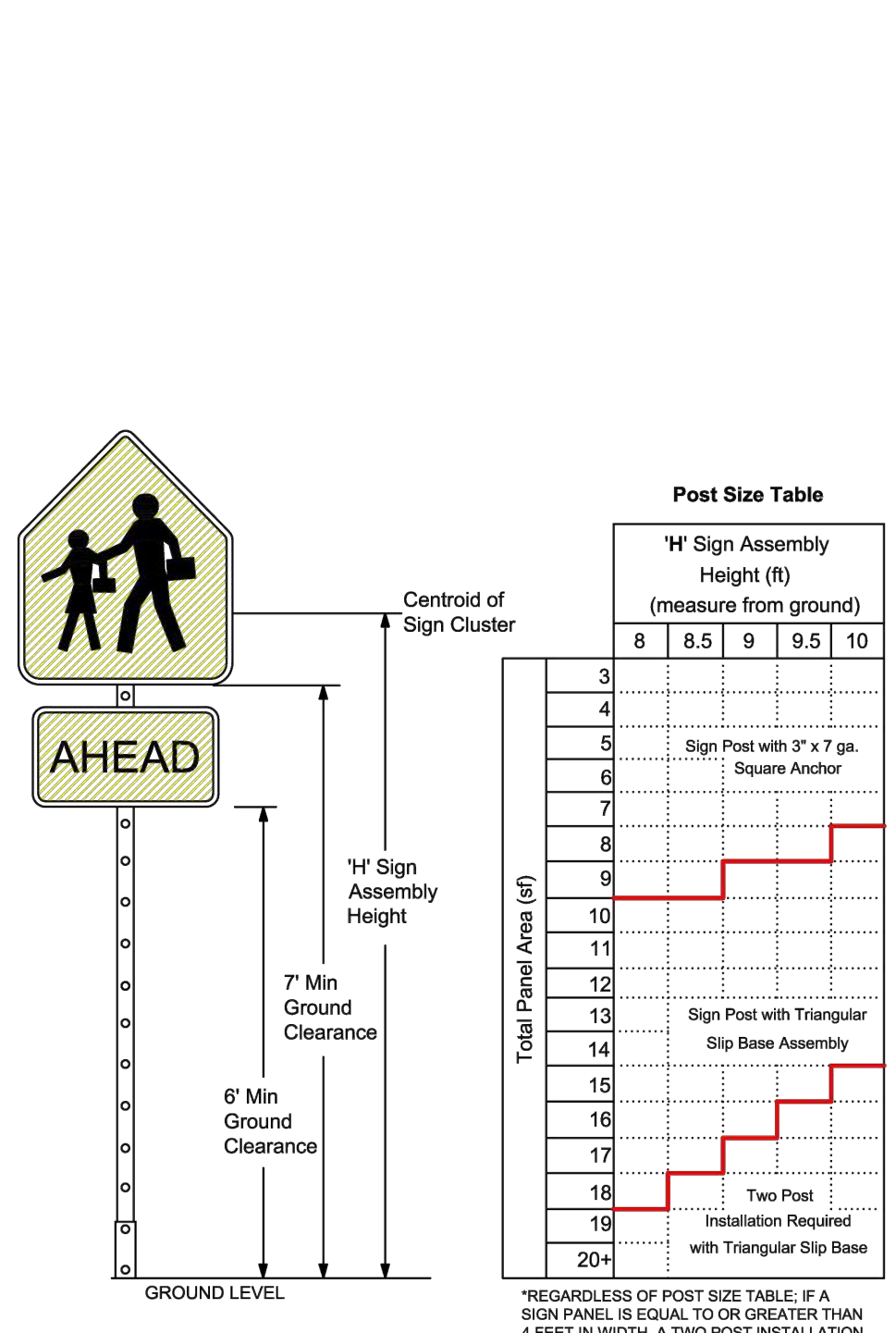

REVISIONS  
DATE DESCRIPTION  
03-21-2017 UPDATED POST SIZE  
11-24-2020 ADDED POST SIZE NOTE  
02-05-2021 UPDATED POST BASE HEIGHT



PUBLIC WORKS DEPARTMENT  
TRAFFIC ENGINEERING DIVISION  
DESIGN BY: YVES DANJOUI, P.E.  
DRAWN BY: STEPHON RAMOUTAR  
CHECKED BY: ANDREW SEBO, P.E., PTOE  
SCALE: NTS  
SHEET NO. 1 OF 1

GROUND SIGN ASSEMBLY DETAILS

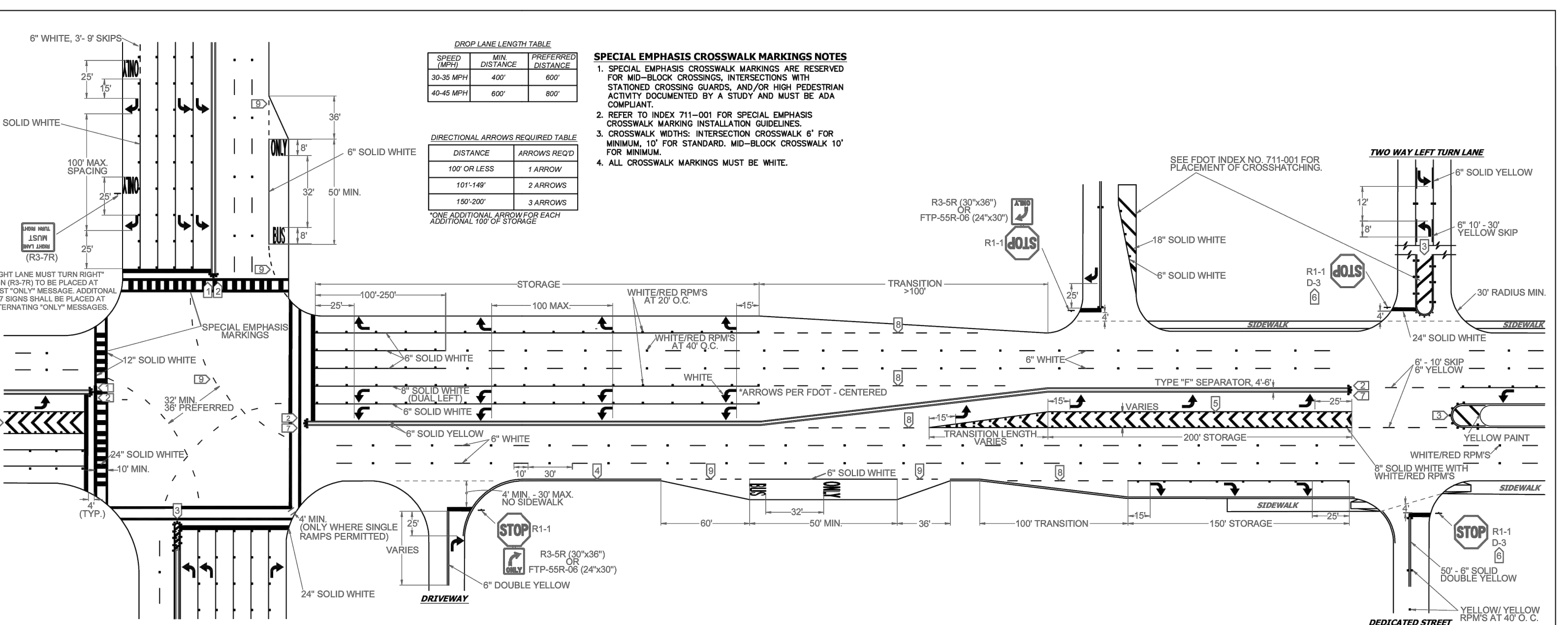

**NOTES**  
1. ALL PAVEMENT MARKINGS SHALL BE ALKYD BASED THERMOPLASTIC AND FULLY RETROREFLECTORIZED.  
2. ALL PAVEMENT MARKINGS ON PAVEMENT SYSTEMS SHALL BE 3M 36/281 SERIES TAPE OR EQUIVALENT AND APPLIED WITH PRO KIOSK/RE AS PER MANUFACTURER'S SPECIFICATIONS.  
3. ALL PAVEMENT MARKINGS AND SIGNING SHALL BE IN ACCORDANCE WITH THE "MANUAL ON UNIFORM TRAFFIC CONTROL DEVICES, SIGNS, STANDARDS, AND POST SIGN STANDARDS."  
4. SEE FOOT INDEX NO. 709-001 FOR PLACEMENT OF RPK'S (FOR BULLDOZE RPK TREATMENT, SEE LEGEND NO. 1)  
5. RPK'S SHALL BE CLASS '30' OR EQUIVALENT, APPLIED WITH EPOXY OR BITUMINOUS ADHESIVE.  
6. FOOT APPROVED SEALER SHALL BE USED WHEN APPLYING MARKINGS ON CONCRETE.  
7. FOR RPK LINE DETAILS SEE FOOT INDEX NO. 714-002.  
8. EXISTING MARKINGS SHALL BE REMOVED BY WATER BLASTING OR SAND BLASTING.  
9. ALL STOP LINES TO BE 4" BROAD CROSSWALK OR SIDEWALK.  
10. PAVEMENT MARKING REFLECTIVITY SHALL BE UNIFORM ACROSS THE ENTIRE STRIPE AND SHALL HAVE A MINIMUM REFLECTIVITY READING OF 250 MILLICANDELES FOR WHITE AND 175 MILLICANDELES FOR YELLOW.  
11. ALL PRODUCTS MUST BE ON POSTS APPROVED PRODUCTS LIST (APL)  
12. RPK'S SHALL NOT BE INSTALLED ADJACENT TO RKE LINES.  
13. OPTIONAL CROSSWALK MARKINGS SHALL BE INSTALLED AT ALL CROSS STREETS OR COUNTY ROADS THAT ARE FOUR LANES OR GREATER.

REVISIONS  
DATE DESCRIPTION  
11-24-2020 UPDATED NOTES  
04-14-2021 UPDATED NOTES  
05-06-2022 UPDATED NOTES



PUBLIC WORKS DEPARTMENT  
TRAFFIC ENGINEERING DIVISION  
DESIGN BY: CARMELO CARATTOZZOLO, P.E.  
DRAWN BY: STEPHON RAMOUTAR  
CHECKED BY: CARMELO CARATTOZZOLO, P.E.  
SCALE: NTS  
SHEET NO. 1 OF 1

PAVEMENT MARKINGS AND SIGNS DETAILS

FOR SIGN ASSEMBLIES WITH MAXIMUM 8.75 SQUARE FOOT PANEL AREA

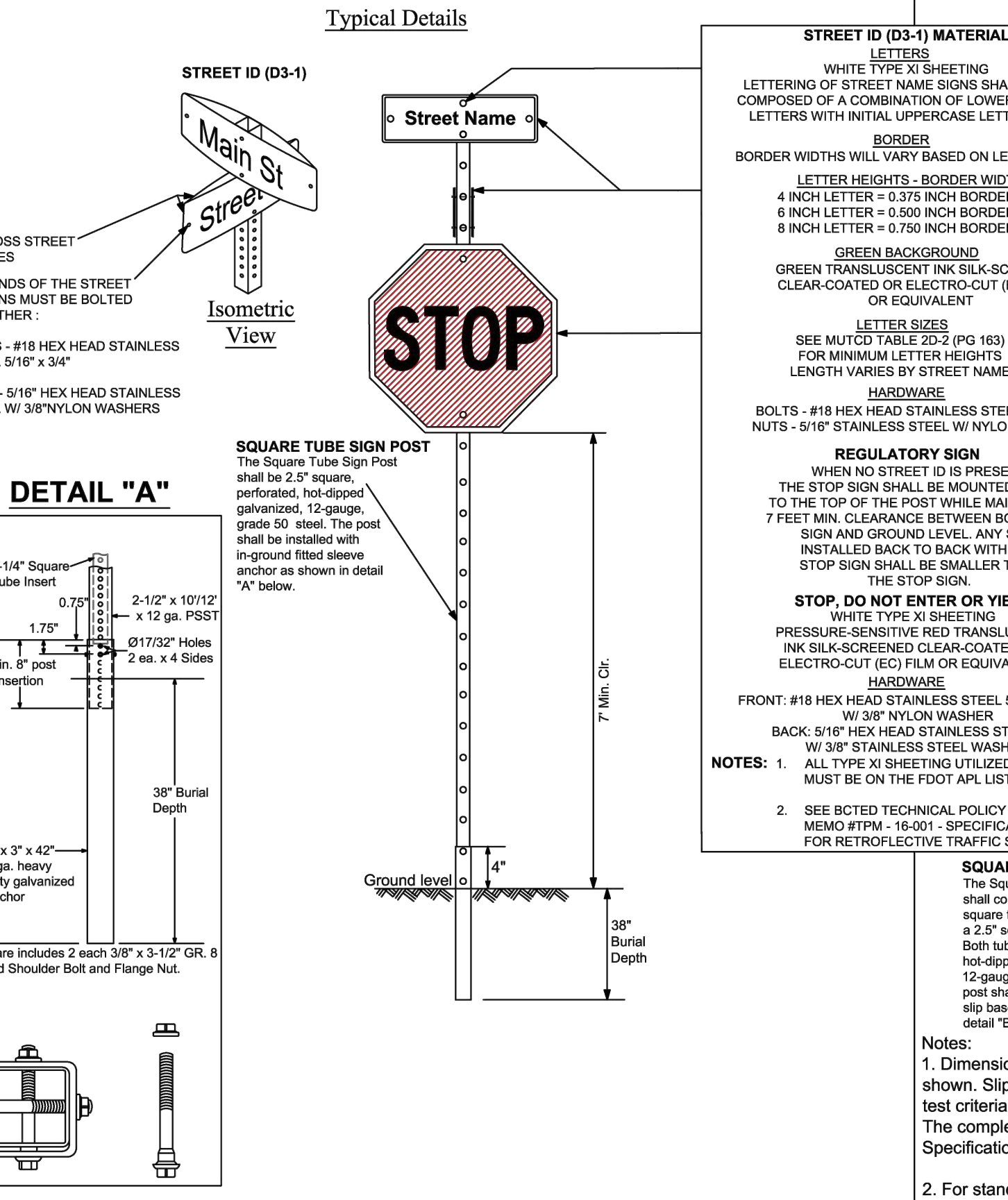

REVISIONS  
DATE DESCRIPTION  
02-28-2020 ADDED ISOMETRIC VIEW  
02-05-2021 UPDATED POST BASE HEIGHT  
06-22-2022 UPDATED SIGN POST NOTES



PUBLIC WORKS DEPARTMENT  
TRAFFIC ENGINEERING DIVISION  
DESIGN BY: CARMELO CARATTOZZOLO, P.E.  
DRAWN BY: STEPHON RAMOUTAR  
CHECKED BY: CARMELO CARATTOZZOLO, P.E.  
SCALE: NTS  
SHEET NO. 1 OF 1

FOR SIGN ASSEMBLIES WITH GREATER THAN 8.75 SQUARE FOOT PANEL AREA WITH SUPPLEMENTAL SIGN

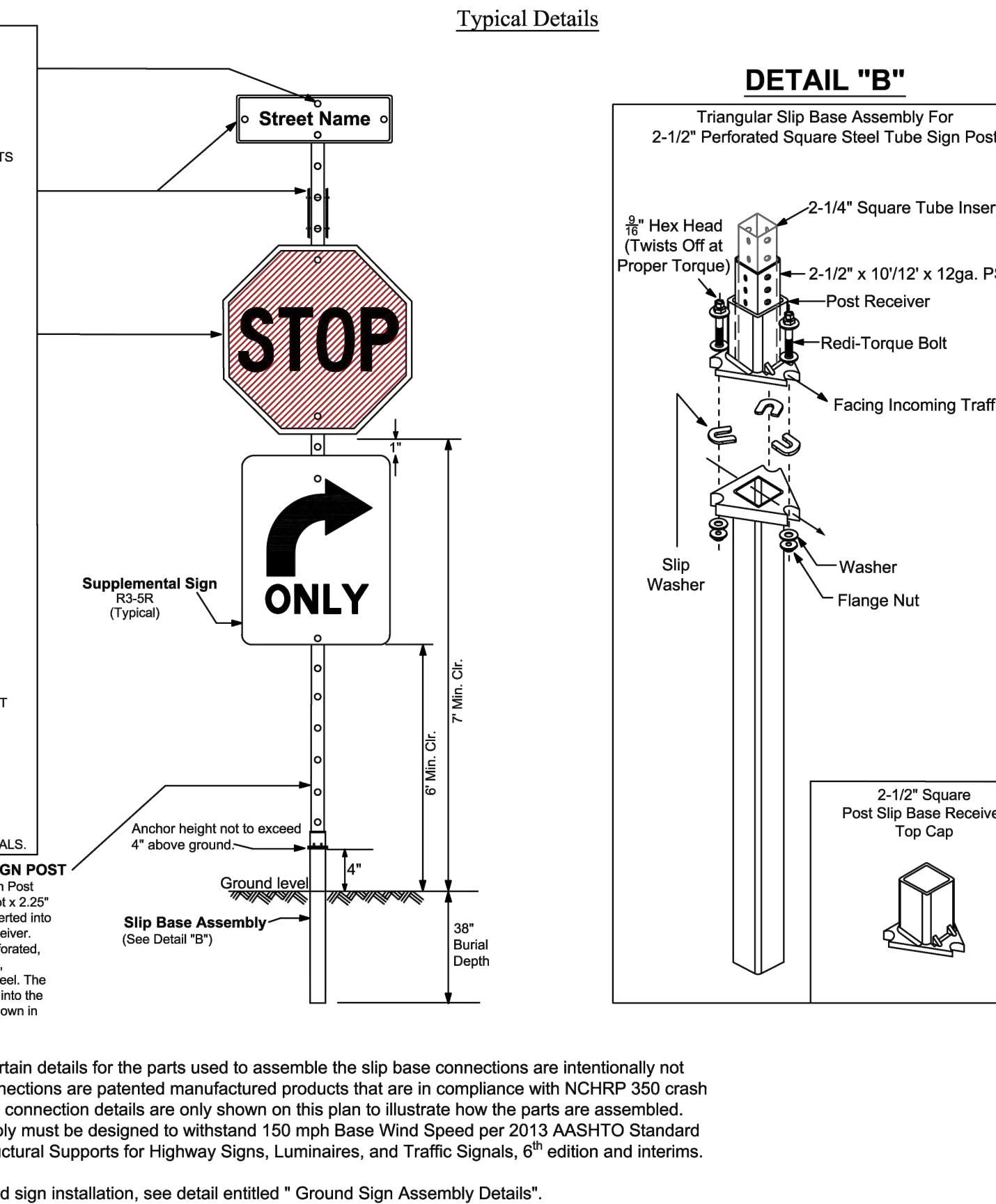

REVISIONS  
DATE DESCRIPTION  
02-28-2020 ADDED ISOMETRIC VIEW  
02-05-2021 UPDATED POST BASE HEIGHT  
06-22-2022 UPDATED SIGN POST NOTES



PUBLIC WORKS DEPARTMENT  
TRAFFIC ENGINEERING DIVISION  
DESIGN BY: CARMELO CARATTOZZOLO, P.E.  
DRAWN BY: STEPHON RAMOUTAR  
CHECKED BY: CARMELO CARATTOZZOLO, P.E.  
SCALE: NTS  
SHEET NO. 1 OF 1

STOP SIGN AND STREET IDENTIFICATION ASSEMBLY TYPICAL DETAILS

BCTED ASSIGNED REFERENCE NUMBER: 250123060

ISSUED FOR CONSTRUCTION  
ELEVATIONS ARE IN NAVD 88



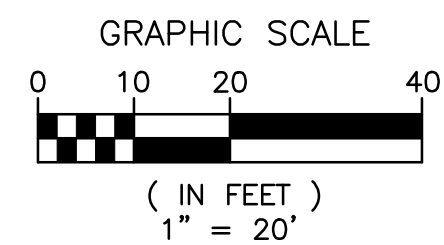

# NO PROPOSED RESTORATION ACTIVITIES THIS SHEET



EXISTING CONFERENCE CENTER

GARFIELD STREET

HOSPITAL DRIVE

N 37TH AVENUE

EXISTING PARKING GARAGE STRUCTURE

EXISTING MEMORIAL HOSPITAL

EXISTING MOB

MATCH LINE SEE SHEET C26

MATCH LINE SEE SHEET C24

ISSUED FOR CONSTRUCTION ELEVATIONS ARE IN NAVD 88

**C23** RESTORATION PLAN  
1" = 20'-0"

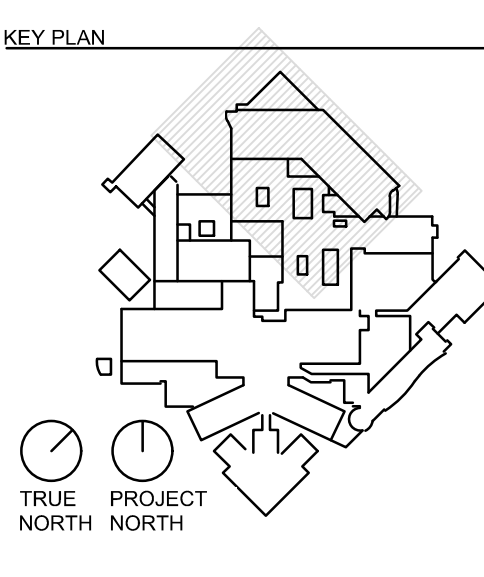

JAMES D. MESSICK, STATE OF FLORIDA, PROFESSIONAL ENGINEER, LICENSE NO. 70870.  
THIS ITEM HAS BEEN DIGITALLY SIGNED AND SEALED BY JAMES D. MESSICK ON THE DATE INDICATED HERE. PRINTED COPIES OF THIS DOCUMENT ARE NOT CONSIDERED SIGNED AND SEALED AND THE SIGNATURE MUST BE VERIFIED ON ANY ELECTRONIC COPIES.

HKS PROJECT NUMBER  
**23459.000**  
DATE  
**NOVEMBER 21, 2024**  
ISSUE  
**ISSUED FOR CONSTRUCTION**  
SHEET TITLE  
**RESTORATION PLAN**

SHEET NO.  
**C23**  
© 2023 HKS, INC.







MATCH LINE SEE SHEET C24

EXISTING  
MEMORIAL  
HOSPITAL

N 35TH AVENUE

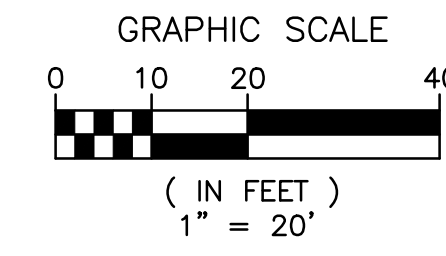

RESTORATION LEGEND

- CONCRETE TO BE RESTORED
- ASPHALT TO BE RESTORED
- PAVERS TO BE RESTORED
- EXISTING SOD TO BE RESTORED

MATCH LINE SEE SHEET C26

MODEL: P:\PROJECTS\2024\1590\1590\1590\EXPANSION\215500\_10\URB\OR EXPANSION ENABLING CIVIL DESIGN & CAD\DWG

PRINT DATE: 11/20/2024 10:52:56 AM TEMPLATE VERSION: 21.03.2020\0181

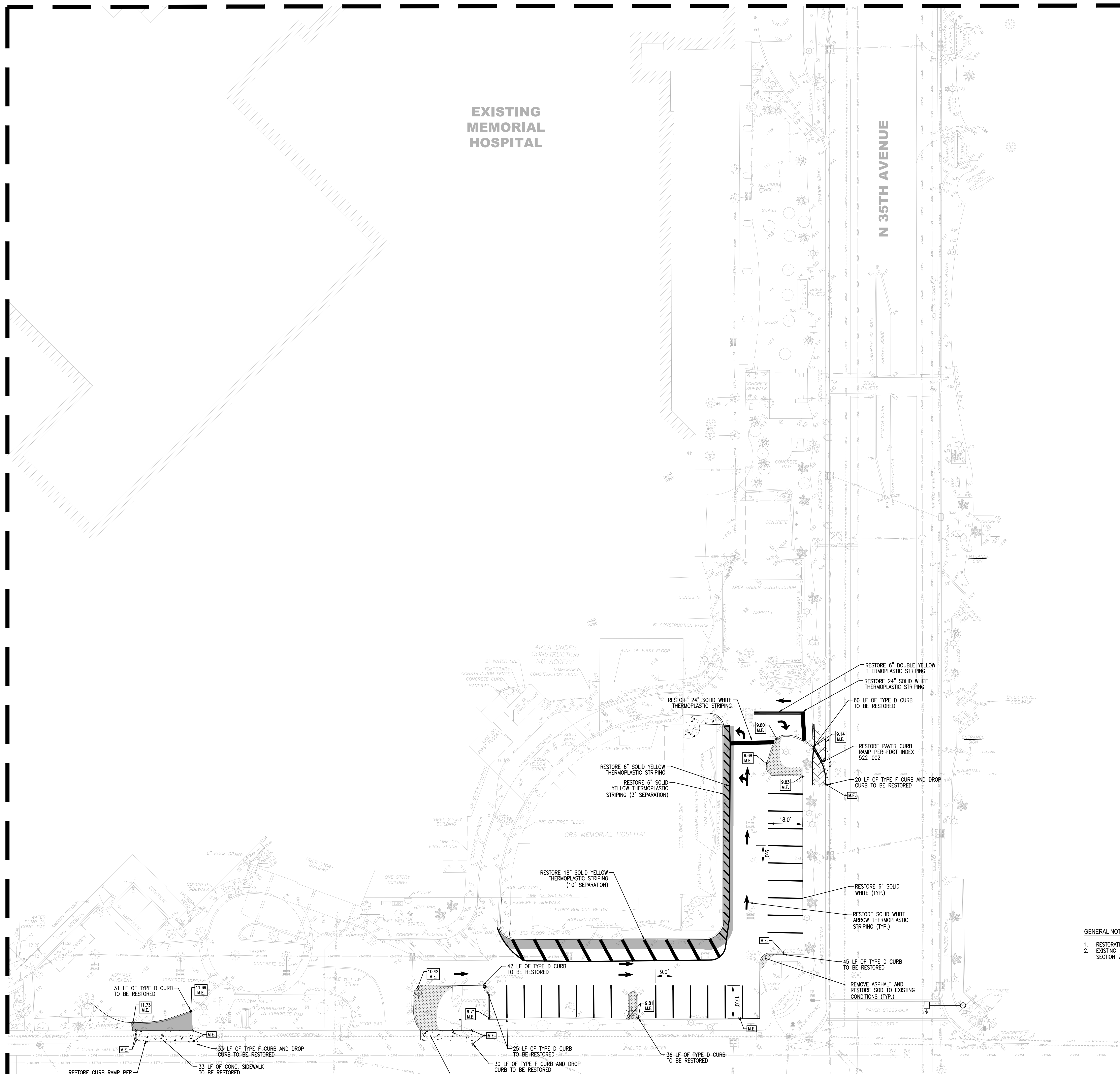

GENERAL NOTES

1. RESTORATION TO BE COMPLETED AT THE END OF THE PROJECT AFTER TOWER IS OPERATIONAL.
2. EXISTING PAVEMENT STRIPING DEMOLITION SHALL BE REMOVED PER FDOT SPECIFICATIONS SECTION 711.

ISSUED FOR CONSTRUCTION  
ELEVATIONS ARE IN NAVD 88

**C25 RESTORATION PLAN**  
1" = 20'-0"

HKS

**ARCHITECT**  
HKS ARCHITECTS, INC.  
2020 SALZEDO STREET, 4TH FLOOR  
CORAL GABLES, FL 33154

**INTERIOR DESIGNER**  
HKS ARCHITECTS  
225 EAST ROBINSON ST, SUITE #405  
ORLANDO, FL 32801

**CIVIL & LANDSCAPE**  
CALVIN GUERINO & ASSOCIATES  
1800 ELLER DRIVE, SUITE 600  
FORT LAUDERDALE, FL 33316

**STRUCTURAL ENGINEER**  
GMS STRUCTURAL ENGINEERS  
14335 COMMERCE WAY  
MIAMI LAKES, FL 33016

**MEP & FIRE PROTECTION**  
TLC ENGINEERING SOLUTIONS, INC.  
800 FAIRWAY DRIVE  
DEERFIELD BEACH, FL 33441

**TELECOM & EQUIPMENT**  
SMITH SECKMAN REID, INC.  
2995 SISCO DRIVE  
NASHVILLE, TN 37204

**OWNER**  
MEMORIAL HEALTHCARE SYSTEM  
3501 JOHNSON STREET  
HOLLYWOOD, FL 33021

**Memorial  
Regional Hospital**

**SURGICAL & CRITICAL CARE TOWER EXPANSION  
ENABLING PACKAGE**

3501 JOHNSON STREET, HOLLYWOOD, FL 33021

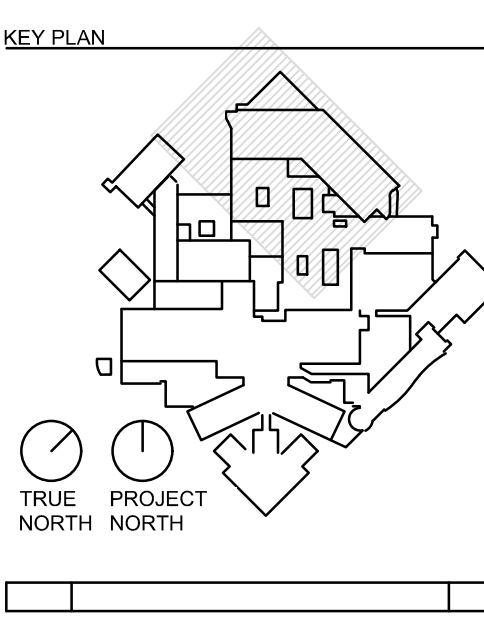

JAMES D. MESSICK, STATE OF FLORIDA,  
PROFESSIONAL ENGINEER, LICENSE NO. 70870.  
THIS ITEM HAS BEEN DIGITALLY SIGNED AND SEALED  
BY JAMES D. MESSICK ON THE DATE INDICATED HERE.  
PRINTED COPIES OF THIS DOCUMENT ARE NOT  
CONSIDERED SIGNED AND SEALED AND THE  
SIGNATURE MUST BE VERIFIED ON ANY ELECTRONIC  
COPIES.

HKS PROJECT NUMBER  
**23459.000**

DATE  
**NOVEMBER 21, 2024**

ISSUE  
**ISSUED FOR  
CONSTRUCTION**

SHEET TITLE  
**RESTORATION PLAN**

SHEET NO.  
**C25**

© 2023 HKS, INC.



MATCH LINE SEE SHEET C23

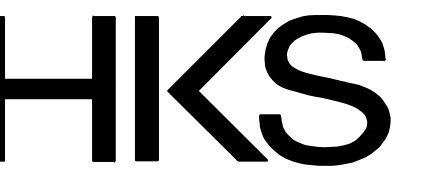

**ARCHITECT**  
HKS ARCHITECTS, INC.  
2020 SALZEDO STREET, 4TH FLOOR  
CORAL GABLES, FL 33154

**INTERIOR DESIGNER**  
HKS ARCHITECTS  
225 EAST ROBINSON ST, SUITE #405  
ORLANDO, FL 32801

**CIVIL & LANDSCAPE**  
CALVIN GUERINO & ASSOCIATES  
1800 ELLER DRIVE, SUITE 600  
FORT LAUDERDALE, FL 33316

**STRUCTURAL ENGINEER**  
GMS STRUCTURAL ENGINEERS  
14335 COMMERCE WAY  
MIAMI LAKES, FL 33016

**MEP & FIRE PROTECTION**  
TLC ENGINEERING SOLUTIONS, INC.  
800 FAIRWAY DRIVE  
DEERFIELD BEACH, FL 33441

**TELECOM & EQUIPMENT**  
SMITH SECKMAN REID, INC.  
2995 SISCO DRIVE  
NASHVILLE, TN 37204

**OWNER**  
MEMORIAL HEALTHCARE SYSTEM  
3501 JOHNSON STREET  
HOLLYWOOD, FL 33021

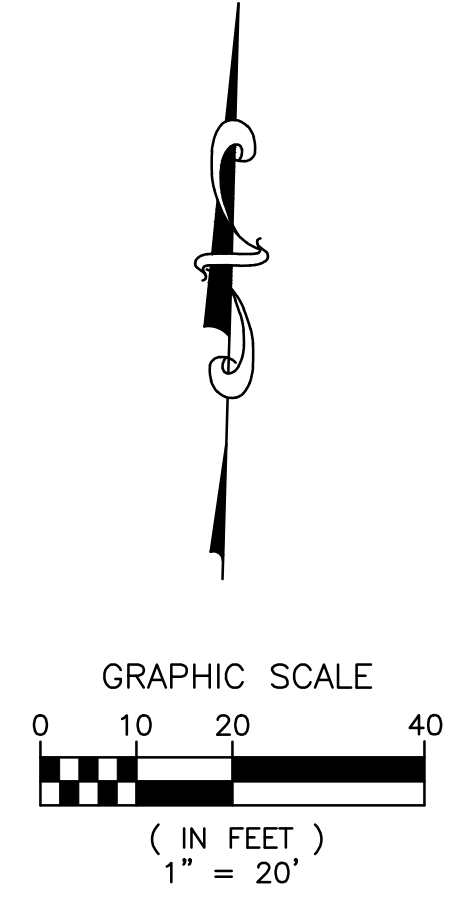

**NO PROPOSED RESTORATION ACTIVITIES THIS SHEET**

MATCH LINE SEE SHEET C25

**Memorial Regional Hospital**  
SURGICAL & CRITICAL CARE TOWER EXPANSION  
ENABLING PACKAGE  
3501 JOHNSON STREET, HOLLYWOOD, FL 33021

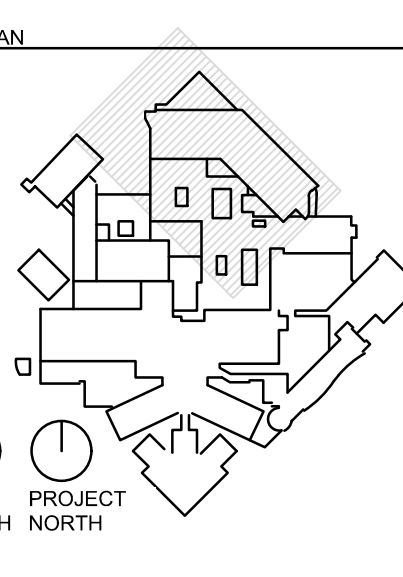

JAMES D. MESSICK, STATE OF FLORIDA, PROFESSIONAL ENGINEER, LICENSE NO. 78870.  
THIS ITEM HAS BEEN DIGITALLY SIGNED AND SEALED BY JAMES D. MESSICK ON THE DATE INDICATED HERE. PRINTED COPIES OF THIS DOCUMENT ARE NOT CONSIDERED SIGNED AND SEALED AND THE SIGNATURE MUST BE VERIFIED ON ANY ELECTRONIC COPIES.

HKS PROJECT NUMBER  
**23459.000**  
DATE  
**NOVEMBER 21, 2024**  
ISSUE  
**ISSUED FOR CONSTRUCTION**  
SHEET TITLE  
**RESTORATION PLAN**

SHEET NO.  
**C26**  
© 2023 HKS, INC.

**C26 RESTORATION PLAN**  
1" = 20'-0"  
ISSUED FOR CONSTRUCTION  
ELEVATIONS ARE IN NAVD 88



TITLE BLOCK VERSION: 20210820  
 MODEL: P:\PROJECTS\2024\23459\HKS\EXPANSION\23459\_01\DRN OR EXPANSION ENABLING CIVIL DESIGN & LANDSCAPE  
 TEMPLATE VERSION: 21.03.2020\0181  
 PRINT DATE: 15/03/2023 10:55:59 AM