

Hollywood A1A Streetscape Improvements

Roadside Planting Design – Phase 4

May 6, 2026

DRAFT

Design

Highlights

- 3'x4' Surface Planter only specified where sidewalks are 7' or wider.
- 4' passing space at back of planter
- Palms spaced to avoid conflict with lighting and other features.
- Palm locations and spacing are approved through a 2023 Design Variance
- Palm Species: Montgomery Palm and Sylvester Date Palms
- Groundcover types TBD.



Planting Method

How does it compare to the tree pit

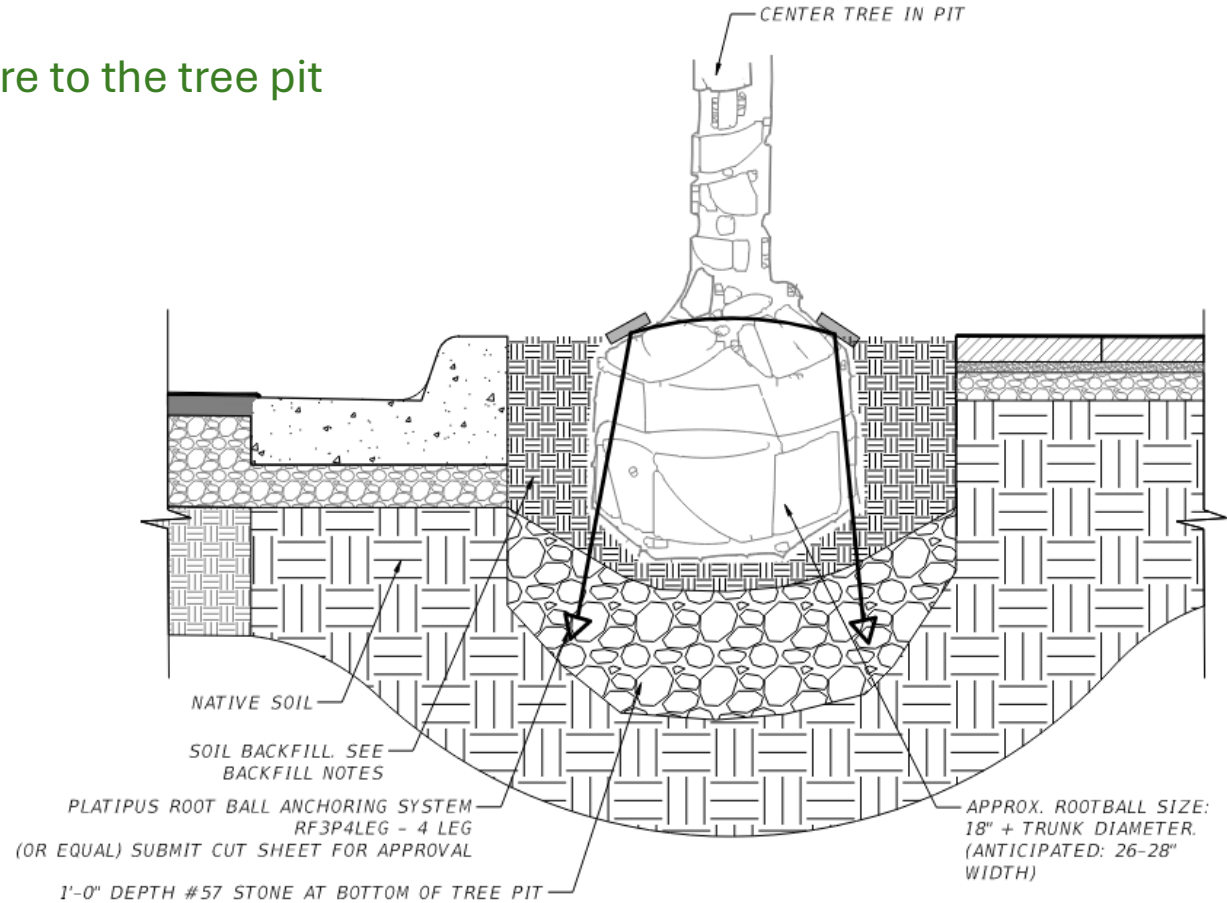

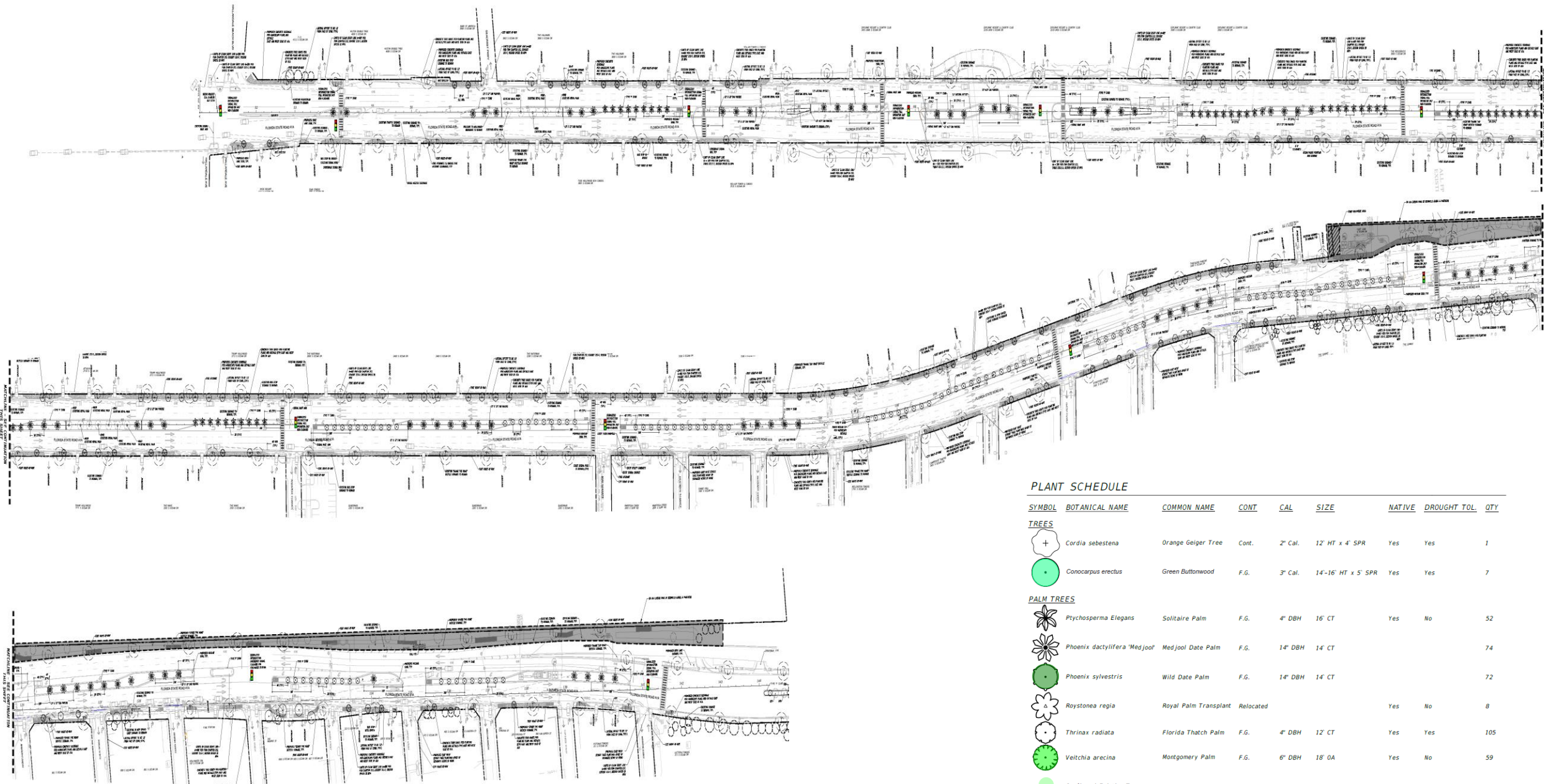

PLANT SCHEDULE

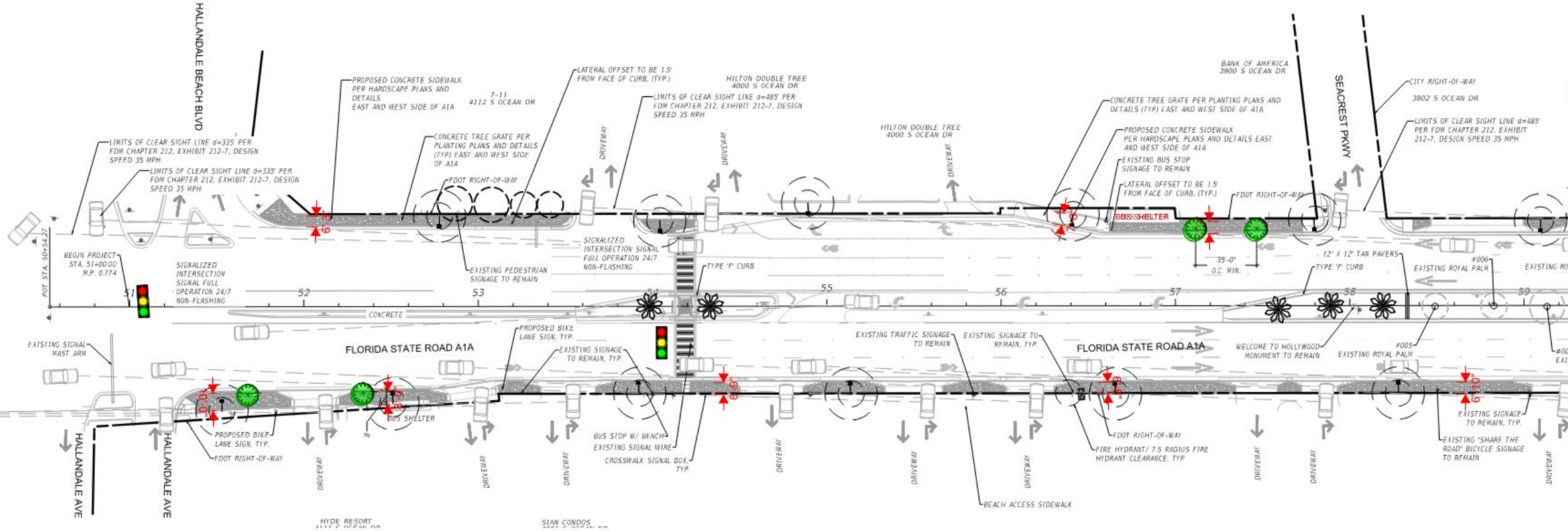

SYMBOL	BOTANICAL NAME	COMMON NAME	CONT.	CAL	SIZE	NATIVE	DROUGHT TOL.	QTY
TREES								
	<i>Cordia sebestena</i>	Orange Geiger Tree	Cont.	2" Cal.	12' HT x 4' SPR	Yes	Yes	1
	<i>Conocarpus erectus</i>	Green Buttonwood	F.G.	3" Cal.	14-16' HT x 5' SPR	Yes	Yes	7
PALM TREES								
	<i>Ptychosperma Elegans</i>	Solitaire Palm	F.G.	4" DBH	16' CT	Yes	No	52
	<i>Phoenix dactylifera</i> 'Medjool'	Medjool Date Palm	F.G.	14" DBH	14' CT			74
	<i>Phoenix sylvestris</i>	Wild Date Palm	F.G.	14" DBH	14' CT			72
	<i>Roystonea regia</i>	Royal Palm Transplant	Relocated			Yes	No	8
	<i>Thrinax radiata</i>	Florida Thatch Palm	F.G.	4" DBH	12' CT	Yes	Yes	105
	<i>Veitchia arcina</i>	Montgomery Palm	F.G.	6" DBH	18' OA	Yes	No	59
	Confirmed Existing Tree							

Roadside Planting Plans: Hallandale Beach Blvd to Seacrest Pkwy

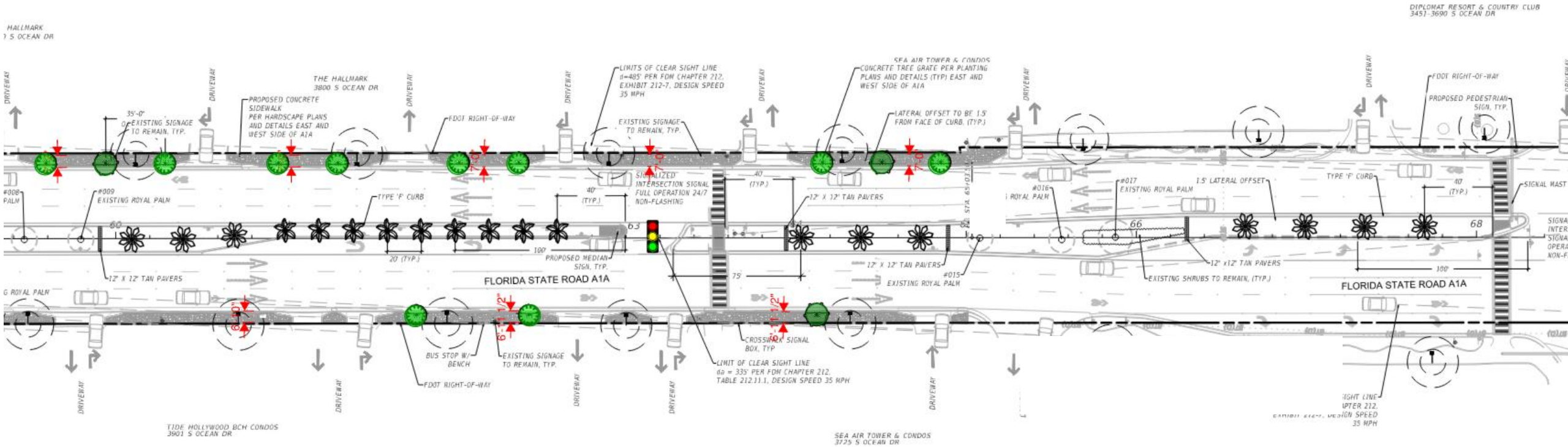

Roadside Planting Plans: Seacrest Pkwy to Diplomat Resort



SIDEWALK PLANTING LEGEND		
	Montgomery Palm	10
	Silvestris	2

Summary of Quantities

- PLANT QUANTITIES – ROADSIDE ONLY
 - Montgomery Palms:
 - Sylvester Date Palms:
 - Groundcover plants @ approx 8 per tree pit:

- PLANT QUANTITIES – MEDIANS ONLY
 - Montgomery Palms:
 - Sylvester Date Palms:
 - Groundcover plants @ approx 8 per tree pit:

Summary

- 1 Wider sidewalks in Phase IV will allow for surface planting, with at least 4' of sidewalk remaining adjacent to the planters for pedestrians. Clearance around light poles will exceed 4' in all directions in all instances.
- 2 Sidewalk elevations along Phase IV are slightly higher than the sidewalk elevations along Phase III.
- 3 As exhibited on the previous phase, the palms in the long, strip surface planter across from Oklahoma Street are performing significantly better than palms installed with tree grates, despite best efforts to address groundwater with an alternate planting detail. All Phase IV roadside palms will be installed in surface planters with groundcovers.
- 4 We believe that the roadside plantings, in surface planters, will be more successful than the palms installed in tree grates in Phase III.

Planting Methods for Replacement



1. Back in the tree grates with stone layer



2. Surface strip planting (West Side of A1A only, where possible)



3. Cover tree grate with pavers until a solution is identified

Summary