

**ATTACHMENT C**  
Public Participation



**Government**  
L A W G R O U P

W W W . G O V L A W G R O U P . C O M

Keith Poliakoff, Esq. | (954) 909-0590 office | kpoliakoff@govlawgroup.com

June 10, 2024

***VIA ELECTRONIC MAIL***

City of Hollywood  
Division of Planning & Urban Design  
Attn: Reginald White, MPA, CEP, Planning Administrator  
2600 Hollywood Boulevard, Room 315  
Hollywood, FL 33020

**Re: Community Outreach Summary – Skippers Dockside 2308 N. Ocean Drive**

Dear Mr. White:

In accordance with the City's Community Outreach Ordinance, this letter serves to confirm the summary of community outreach relating to the above captioned matter.

On May 14, 2023, we conducted a virtual meeting relating to the Skippers Dockside development. In addition to satisfying the City's mail notice requirements, we also sent formal notice to all neighborhood and civic associations. A copy of the Certification Letter, Mailing List, and Notice, has been attached hereto as Composite Exhibit "A".

The virtual meeting started promptly at 6:00 p.m. It was well attended by approximately nine participants including District Commissioner Shuham. The development team presented a PowerPoint presentation, as seen in the attached Exhibit "B". The participants were extremely excited for the proposed development, and offered their full support. There were no questions or concerns, simply appreciation for the proposed development and its relationship to the neighboring hotel.

Please do not hesitate to contact me if you have any additional questions or comments.

Sincerely,

A handwritten signature in blue ink, appearing to read 'K. Poliakoff', is written over the typed name.

Keith M. Poliakoff

200 S. Andrews Avenue, Suite 601  
Ft. Lauderdale, FL 33301



## CERTIFICATION LETTER

**City of Hollywood**

**Date:** April 26, 2024

**Applicant:** Oceanside Marina, LLC

**Legal Description:** Portions of Lots 1 through 12 of Hollywood Beach First Add Plat as recorded in Plat Book 1 Page 31 of the Public Records of Broward County, Florida.

**Address or General Location:** 2308 N. Ocean Drive

This letter certifies that the attached list of property owners within 500 feet from each property line of the subject site was prepared using the latest tax folio rolls supplied by the Broward County Property Appraisers Office as of April 16, 2024, all registered Civic Associations, City Commissioners and Planning Department.

This letter also certifies that the attached public hearing notification was sent to the persons on the list of property owners. The notice was mailed April 25, 2024.

Finally, this letter certifies that the site was posted with two public notice signs that meet the City of Hollywood notification regulations. The signs were posted April 26, 2024.

Thank You,

Christina Mathews

Sworn and subscribed before me this 26<sup>th</sup> day of April, 2024. She is personally known to me.

Signature of Notary

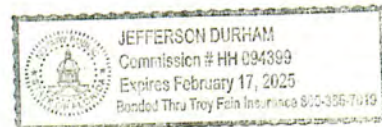

1025 Yale Drive  
Hollywood, Florida 33021  
954-920-2205  
Email: cutroplanning@yahoo.com



# **NOTICE OF PUBLIC OUTREACH MEETING**

Sponsored by: Government Law Group

Project Name: 2308 North Ocean

FOR VIRTUAL MEETING LOGIN INFORMATION:

ZOOM Link: <https://us02web.zoom.us/j/9175326492?omn=89807874635>

Meeting ID: 917 532 6492

[kpoliakoff@govlawgroup.com](mailto:kpoliakoff@govlawgroup.com)

MEETING DATE & TIME: **05/14/2024 @ 6:00 PM**

Posted: **04/26/2024** By: **Cutro**



# **NOTICE OF PUBLIC OUTREACH MEETING**

Sponsored by: Government Law Group

Project Name: 2308 North Ocean

FOR VIRTUAL MEETING LOGIN INFORMATION:

ZOOM Link: <https://us02web.zoom.us/j/9175326492?omn=89807874635>

Meeting ID: 917 532 6492

[kpoliakoff@govlawgroup.com](mailto:kpoliakoff@govlawgroup.com)

MEETING DATE & TIME: 05/14/2024 @ 6:00 PM

Posted: 04/26/2024 By: Cutro



FOLIO_NUMB	NAME	ADDRESS_LI
514201014073	BROWARD COUNTYBOARD OF COUNTY COMMISSIONERS	115 S ANDREWS AVE RM 501-RP
514201014081	TITFSOUTH BROWARD PARK DISTRICT	3900 COMMONWEALTH BLVD
514201018440	BROWARD COUNTYBOARD OF COUNTY COMMISSIONERS	115 S ANDREWS AVE RM 501-RP
514201018980	BROWARD COUNTYBOARD OF COUNTY COMMISSIONERS	115 S ANDREWS AVE RM 501-RP
514201019050	BROWARD COUNTYBOARD OF COUNTY COMMISSIONERS	115 S ANDREWS AVE RM 501-RP
514201020010	BROWARD COUNTYBOARD OF COUNTY COMMISSIONERS	115 S ANDREWS AVE RM 501-RP
514201020130	BROWARD COUNTYBOARD OF COUNTY COMMISSIONERS	115 S ANDREWS AVE RM 501-RP
514201020200	BROWARD COUNTYBOARD OF COUNTY COMMISSIONERS	115 S ANDREWS AVE RM 501-RP
514201028310	BROWARD COUNTYBOARD OF COUNTY COMMISSIONERS	115 S ANDREWS AVE RM 501-RP
514212000010	OCEANSIDE MARINA LLC	1001 E ATLANTIC AVE STE 202

514212010011	FLORIDA DEPT OF TRANSPORTATION OFFICE OF RIGHT OF WAY	3400 W COMMERCIAL BLVD
514212010012	PUBLIC LAND % CITY OF HOLLYWOOD DEPT OF COMMUNITY & ECONOMIC DEV	2600 HOLLYWOOD BLVD #206
514212010030	OCEANSIDE MARINA LLC	1001 E ATLANTIC AVE SUITE 202
514212010060	2200 N OCEAN DRIVE LLC	2200 N OCEAN DR #1-3
514212010070	MARINA LODGE RESORT LLC	2118 N OCEAN DR #1-4
514212010071	FLORIDA DEPT OF TRANSPORTATION OFFICE OF RIGHT OF WAY	3400 W COMMERCIAL BLVD
514212010100	CITY OF HOLLYWOOD DEPT OF COMMUNITY & ECONOMIC DEV	2600 HOLLYWOOD BLVD #206
514212011320	ASTRID 10 LLC	3350 SW 57 PL
514212011330	CPG309 LLC	3350 SW 57 PL
514212011340	JULIA 1 LLC	3350 SW 57 PL
514212011360	ASTRID 2 LLC	3350 SW 57 PL
514212011370	JW CPG HOLLYWOOD1 LLC	118 S FORMOSA AVE
514212011380	PELLEGRINO NACHUM LLC	3350 SW 57 PL
514212011420	JULIA 2 LLC	2115 N SURF RD #1-4
514212011430	COWETTE,PAUL J PAUL J COWETTE REV TR	813 OCEAN BLVD
514212011440	PAUL J COWETTE REV TR COWETTE,P & COWETTE,S TRSTEE	770 PONCE DE LEON BLVD 2ND FLOOR
514212011450	2RM INVESTMENTS INC	701 FEATHERWOOD DR
514212011460	RODRIGUEZ,RANDY R RODRIGUEZ,OLGA	701 FEATHERWOOD DR

514212011470	RODRIGUEZ,RANDY RRODRIGUEZ,OLGA	701 FEATHERWOOD DR
514212011500	ANDREEN,ROSARY A	345 MCKINLEY ST
514212011510	ASTRID 4 LLC	3350 SW 57 PL
514212011511	FLORIDA DEPT OF TRANSPORTATIONOFFICE OF RIGHT OF WAY	3400 W COMMERCIAL BLVD
514212011521	PARADISE JULIA TERRACE LLCYS REAL ESTATE INVESTMENTS LLC	3350 SW 57 PL
514212011530	OLIVERA,MARIA JW CPG HOLLYWOOD2 LLCPELLEGRINO NACHUM LLC	322 NEBRASKA ST
514212011550	ETAL	118 S FORMOSA AVE
514212011560	2120NSURF LLC	18516 MARBLEHEAD WAY
514212011570	TUCKER-WARDLAW INC	2210 N SURF RD
514212011600	LEVEL SIX LLC	1395 BRICKELL AVE #1380
514212011610	P & G HOLDINGS LLC	5 LIGHTHOUSE LN
514212011620	NO WORRIES INC PARADISE JULIA TERRACE LLCYS REAL ESTATE	300 MONROE ST
514212011630	INVESTMENTS LLC	3350 SW 57 PL
514212011640	HOLLYWOOD FLORIDA COMMUNITYREDEVELOPMENT AGENCY	1948 HARRISON ST
514212011641	FLORIDA DEPT OF TRANSPORTATIONOFFICE OF RIGHT OF WAY	3400 W COMMERCIAL BLVD
514212011642	FLORIDA DEPT OF TRANSPORTATIONOFFICE OF RIGHT OF WAY	3400 W COMMERCIAL BLVD
514212011690	HOLLYWOOD BEACHFRONT TOWNHOMESLLC	2300 N SURF RD
514212011700	CPG315322 LLC	104 W 40 ST #1030



514212011710	CIANFAGLIA,VINCENZO &CIANFAGLIA,ANNA	6810 ST ZOTIQUE E
514212011720	HOLLYWOOD BEACHFRONTTOWNHOMES LLC	2300 N SURF RD
514212011721	HOLLYWOOD BEACHFRONTTOWNHOMES LLC	2300 N SURF RD
514212011722	HOLLYWOOD BEACHFRONTTOWNHOMES LLC	2300 N SURF RD
514212011730	HOLLYWOOD BEACHFRONT TOWNHOMESLLC	2300 N SURF RD
514212011740	MJJ CAPITAL PARTNERS LLC	322 BUCHANAN ST PH C1
514212011750	LACI MARGO LLC	81 BAY COLONY DR
514212011770	GALICA,EWA	720 POLK ST
514212011780	OCEANSIDE MARINA LLC	1001 E ATLANTIC AVE SUITE 202
514212011790	HOLLYWOOD BEACH VACATIONHOMES LLC	4301 TAYLOR ST
514212011800	2309 NORTH OCEAN DRIVE LLC	1000 MARKET ST #300
514212011810	DPRE1 LLC	4664 NW 114 AVE #501
514212011820	LEVI GREEN HOLLYWOOD LLCMIRIAM GREEN	3350 SW 57 PL
514212011830	HOLLYWOOD LLC	326 ROOSEVELT ST
514212011840	RHODIS,VICKY	16121 RIO DEL SOL
514212011880	MESSINGER,SAMUEL RICHARD	2400 N SURF RD #1-2
514212011890	QUINNAN,STEPHEN M	230 174 ST #1514
514212011890	LAGUNA BLU INVESTMENTS LLC	321 ROOSEVELT ST
514212011900	AVILES, RICHARD H/ENANCY QUINN REV TR	300 71 ST #620
514212011910	MY BEACH CLUB LLC	
514212011920	ASSOCIATED HOLLYWOOD DEV LLC	PO BOX 611510
514212011950	318 TSTREET LLC	1000 MARKET ST #300
514212020011	PUBLIC LAND % CITY OF HOLLYWOODDEPT OF COMMUNITY & ECONOMIC DEV	2600 HOLLYWOOD BLVD #206
514212020020	HOLLYWOOD BEACH LLC	1001 E ATLANTIC AVE #202
514212020021	OCEANSIDE MARINA LLC	1001 E ATLANTIC AVE STE 202



514212020040	BELLAIR DEVELOPMENT LLC	1000 MARKET ST #300
514212020050	BELLAIR DEVELOPMENT LLC	1000 MARKET ST #300
514212020070	BELLAIR DEVELOPMENT LLC	1000 MARKET ST #300
514212020360	HOLLYWOOD BEACH LLC	1001 E ATLANTIC AVE #202
514212020361	CITY OF HOLLYWOODDEPT OF COMMUNITY & ECONOMIC DEV	2600 HOLLYWOOD BLVD #206
514212020380	WALKABOUT REALTY LLC	3709 KINGS WAY
514212020390	309 CAROLINA STREET LLC	1001 E ATLANTIC AVE STE 202
514212020410	319 CAROLINA LLC	1000 MARKET ST #300
514212020411	BELLAIR DEVELOPMENT LLC	1000 MARKET ST #300
514212020420	BELLAIR DEVELOPMENT LLC	1000 MARKET ST #300
514212020450	ALIG,JOHN A & INGEJOHN A & INGE ALIG TR	316 WILSON ST
514212020460	IMPERIAL WESTBURY INC	2600 N SURF RD
514212AA0010	YOUNGHEIM,JEFFREY M	2106 N OCEAN DR #1
514212AA0040	KURZEJEWSKI,DALE E	2106 N OCEAN DR APT 5
514212AA0050	KURZEJEWSKI,DALE	2106 N OCEAN DR APT 5
514212AA0060	MCCALL,SYLVIA ANN	2106 N OCEAN DR #6
514212AA0070	KURZEJEWSKI,DALE	2106 N OCEAN DR #5
514212AA0080	KURZEJEWSKI,DALE	2106 N OCEAN DR #5
514212AA0090	PALERMO,JAMES	2106 N OCEAN DR #9
514212AA0100	PROPERTY LIQUIDATORS INC	3715 WASHINGTON ST
514212AD0010	ALVAREZ INVESTMENT GROUP LLC	2203 N SURF RD



514212AD0020	ALVAREZ INVESTMENT GROUP LLC	2203 N SURF RD
514212AD0030	ALVAREZ INVESTMENT GROUP LLC	2203 N SURF RD
514212AE0010	RICHARD SHAPAZIAN TRSHAPAZIAN,RICHARD TRSTEE	2712 N OCEAN DR #4
514212AE0020	JF RES LLC	1520 DEWEY ST
514212AE0030	SHAPAZIAN,RICHARDRICHARD SHAPAZIAN TR	2712 N OCEAN DR APT 4
514212AF0010	GARCIA,MARC A	PO BOX 800412
514212AF0020	WALSH,STANLEY J & MARCELA Y	1537 VAN BUREN ST
514212AF0030	MORLEY,THOMAS J H/EKENNEDY,MARY B	1908 N OCEAN DR APT #5A
514212AF0040	HOLLYWOOD INTER-COASTAL LLC	3275 W HILLSBORO BLVD #110
514212AF0050	JBTL P LLC	3872 SHERIDAN ST
514212AF0060	MILOFSKY,NEIL ANEIL A MILOFSKY REV LIV TR	1908 N OCEAN DR #12A
514212AF0070	JBTL P LLC	3872 SHERIDAN ST
514212AF0080	JBTL P LLC	3872 SHERIDAN ST
514212AF0090	JBTL P LLC	3872 SHERIDAN ST
514212AF0100	FAHERTY,ELLEN LOUISE	6 STACEY MARIE DR
514212AF0110	BOWDEN,PATRICK AUGUSTUSFORCADE,SUSAN	321 MADISON ST UNIT 101B
514212AF0120	LAPKOFF,MONICA	312 INDIAN ROAD CRES
514212AF0130	HOLLYWOOD HIDEOUT LLC	18101 COLLINS AVE APT 1504
514212AF0140	LESNER,ROBERT H/EMORLEY,THOMAS	1908 N OCEAN DR #14C



514212AF0150	NOVARO,GIANA FELICIAPATINO,CHRISTOPHER	18741 NW 24 CT
514212AF0160	VALLADARES,GLADYSMONTALVO,SAMUEL JR	1908 N OCEAN DRIVE #16C
514212AH0010	TSTREET LLC% RICHARD CRITCHFIELD	1000 MARKET ST #300
514212AH0020	TSTREET LLC% RICHARD CRITCHFIELD	1000 MARKET ST #300
514212AH0030	TSTREET LLC% RICHARD CRITCHFIELD	1000 MARKET ST #300
514212AH0040	TSTREET LLC% RICHARD CRITCHFIELD	1000 MARKET ST #300
514212AH0050	TSTREET LLC% RICHARD CRITCHFIELD	1000 MARKET ST #300
514212AH0060	TSTREET LLC% RICHARD CRITCHFIELD	1000 MARKET ST #300
514212AH0070	TSTREET LLC% RICHARD CRITCHFIELD	1000 MARKET ST #300
514212AH0080	TSTREET LLC% RICHARD CRITCHFIELD	1000 MARKET ST #300
514212BG0010	CAJIGAS PROPERTIES LLC	1314 N 30 CT
514212BG0020	MIDA REAL ESTATE SOLUTIONS LLC	10639 NW 122 ST
514212BG0030	MIDDLETON,DONNA	9034 BRACELET DR
514212BG0040	GUERRA,DIUBY	9974 NW 127 TER
514212BG0050	LOPEZ,ALFREDOLOPEZ,IRMA	10853 SW 34 ST
514212BG0060	LAWRENCE,SARA	600 THREE ISLANDS BLVD APT 103
514212BG0070	GAGO CAPITAL LLC	10175 COLLINS AVAE #1406
514212BG0080	FORECLOSURE ASSETSMANAGEMENTS LLC	20533 BISCAYNE BLVD #1240
514212BM0010	TRITON II LLC	3389 SHERIDAN ST #558
514212BM0020	SLOWEY,JAMES P H/ENESMITH,DONNA	321 WILSON ST #102A
514212BM0030	SKUPNY,LAWRENCESKUPNY,KAREN B	20414 ALPHONSE LN
514212BM0040	MARTIN,ARACELYS	321 WILSON ST #105A
514212BM0050	CREZCO INC	14525 SW 43 TER
514212BM0060	SOLOMON,KATHLEEN LSOLOMON,SCOTT K	20165 BAYFILED DRIVE
514212BM0070	SIGIE LLC	1937 E 24 ST
514212BM0080	AREAS PROPERTIES GROUP LLC	8909 NW 9 PL
514212BM0090	AVILA,KAREN	321 WILSON ST #A203



514212BM0100	GRAVALLESE,GEORGEGRAVALLESE,TERESA	3 SYMPHONY RD
514212BM0110	FRIGULETTO,CHERYL A	3 OAK CREST DRIVE
514212BM0120	FRIGULETTO,CHERYL A	3 OAK CREST DRIVE
514212BM0130	STEVANOVIC,NEBOJSASTEVANOVIC,TATJANA	16530 LOWER VALLEY RIDGE DR
514212BM0140	HIGGINS,KEVINMCKENZIE,AMANDA	8691 PARLIAMENT AVE
514212BM0150	HERNANDEZ ACOSTA,YOVANYSPINEIRO,MARTHA	6340 LAKE JUNE RD
514212BM0160	AMATO,ANTHONY & ANDRIANA	45-25 172 ST
514212BM0170	MOLINARO,FRANK C &MOLINARO,KATHY S	185 MAILE RD
514212BM0180	SHUEY,WILLIAMSHUEY,DEBORAH	321 WILSON ST #304A
514212BM0190	Y2K COMMUNICATIONS OFSOUTH FLORIDA INC	11767 S DIXIE HWY #385
514212BM0200	FORE STATES LLC	7 FAIRWAYS LN
514212BM0210	GPM BEACH LLC	1 STONY BROOK ROAD
514212CA0010	RIVERA,ALBERTORIVERA,YANNIRA	19320 NW 38 CT
514212CA0020	MALLINSON,SUSAN F	1519 HAYES ST
514212CA0030	HH & I INVESTMENTS LLC	1770 W 40 ST BAY #3
514212CA0040	ERWIN,MICHELLE H/EERWIN RASBERRY,DEBRA	326 WILSON ST #104
514212CA0050	VASQUEZ MASROUA,ALEJANDRO	326 WILSON ST #105
514212CA0060	SERVAIS,RENE & SERVAIS,JANICE% WHARF TAVERN	43 CHICOPEE ST
514212CA0070	PEZ PROPERTIES LLC	5323 SW 34 WAY
514212CA0080	KENO,BRUCE &KENO,IDA	1201 SOUTH OCEAN DR UNIT 1104-N
514212CA0090	SAPOZNIK,RACHEL	1100 NE 163 ST FL 2
514212CA0100	DINITOMU LLC	4000 HOLLYWOOD BLVD #555S
514212CA0110	GUERRA,JAVIER A LUIS	9501 NW 4 ST
514212CA0120	ORTIZ,ANDRES	5540 HAWKES BLUFF AVE
514212CA0130	SAPOZNIK,RACHEL A	1100 NE 163 ST
514212CA0140	DINITOMU LLC	4000 HOLLYWOOD BLVD #555-S



514212CA0150	BLEIWEISS, JAY S H/EBLEIWEISS, HILDA	326 WILSON ST # 207
514212CA0160	PEZ PROPERTIES LLC	5323 SW 34 WAY
514212CB0010	GONZALEZ, NORMA	14101 SW 45 ST
514212CB0020	HAMPTON, JOHN & JANE	1722 BELMONT CIR SW
514212CB0030	GIORDANO, FRANK JR VINCENT J GIORDANO IRREV TR	21 LIDO BLVD
514212CB0040	DONNELLY, JAMES J & LINDA A	3706 LIBBY LN
514212CB0050	BRUNS, STEVEN JOSEPH	322 HARDING ST #B108
514212CB0060	FRITSCHI, LOIS	1239 VAN BUREN ST
514212CB0070	AZPURUA, ROLANDO RCASTANEDA, SONIA M	4 W 101 ST APT 69-A
514212CB0080	WILSON, ROBERT CWILSON, ADA R	9881 SUMMERBROOK TER APT B
514212CB0090	WANDER PROPERTY SOLUTIONS LLC	6100 OPEN RANGE TRL
514212CB0100	AMERICAN WAVE LLC	1637 WASHINGTON AVE
514212CB0110	PALM LIFE LLC	1201 S OCEAN DR STE 2111S
514212CB0120	AYRA, HARIAN	9224 221 ST
514212CB0130	WILSON, ADA RWILSON, ROBERT C	9881 SUMMERBROOK TER APT B
514212CB0140	WILSON, ADA & WILSON, ROBERT	9881 SUMMERBROOK TER APT B
514212CB0150	AVILA, JUAN CARLOS	322 HARDING ST #B206
514212CB0160	AYRA, HARIAN	9224 221 ST
514212CC0010	RUGGERI, PETER A & RUGGERI, MICHAEL F ETAL	152 HIGHLAND AVE
514212CC0020	RUGGERI, PETER A & SANDRA LRUGGERI, ANGELA T ETAL	1110 VENETIAN WAY #2A



514212CC0030	ZAFONTE,LEONARD ZGAMBELLA,VITA	231 NW 193 AVE
514212CC0040	JORDAN,RALEIGH NORMANJORDAN,NORMAN THOMAS	11903 SW 12 COURT
514212CC0050	SPOERLEIN,HELMUT F & GERLINDE	33 MUENCHHAUSENWEG
514212CC0060	HANRAHAN,MARK H/EHANRAHAN,PAMELA YNES MEZA A DE	2751 N SURF RD #C-6
514212CC0070	TRITON II LLC	3389 SHERIDAN ST STE 558
514212CC0080	TRITON II LLC	3389 SHERIDAN ST #558
514212CD0010	KALLER,JOSEPHKALLER,HOPE	3650 N 36 AVE APT 7
514212CD0020	INGE U ALIG TRALIG,J & ALIG,INGE TRSTEE	316 WILSON ST
514212CD0030	BRODIE,GERALDINE	3802 NE 207 ST APT 904
514212CD0040	TRITON II LLC	3389 SHERIDAN ST STE 558
514212CD0050	NOVORRO,JILLPURETZ,SUSAN	1227 JACKSON ST
514212CD0060	WOEHLKE,PAUL	222 N COLUMBUS DRIVE APT 1908
514212CH0010	DEVERS,WILLIAM W & GRETCHEN GDEVERS FAM LIV TR	2000 N OCEAN DR #101
514212CH0030	CLEMENT PROULX REV TRPROULX,CLEMENT CO- TRSTEE ETAL	2000 N OCEAN DR #5
514212CH0050	PROULX,CLEMENT &MOORE,ISABELLE	2000 N OCEAN DR #105
514212CH0060	CLEMENT PROULX REV TRISABELLE MOORE REV TR	2000 N OCEAN DR #105
514212CH0070	MATTON,AGATHE &PARENTEAU,PAUL EMILE	2157 TD BOUCHARD AVE
514212CJ9998	HOLLYWOOD SANDS RESORT OWNERSASSOC	2404 N SURF RD
514212NT0010	ASTRID 7 LLC	3350 SW 57 PL
514212NT0020	ASTRID 7 LLC	3350 SW 57 PL



514212NT0030	ASTRID 7 LLC	3350 SW 57 PL
514212NT0040	ASTRID 7 LLC	3350 SW 57 PL
514212NT0050	ASTRID 7 LLC	3350 SW 57 PL
514212NT0060	ASTRID 7 LLC	3350 SW 57 PL
514212NT0070	ASTRID 7 LLC	3350 SW 57 PL
514212NT0080	ASTRID 7 LLC	3350 SW 57 PL
514212NT0090	ASTRID 7 LLC	3350 SW 57 PL
514212NT0100	ASTRID 7 LLC	3350 SW 57 PL

	City of Hollywood	
	2600 Hollywood Boulevard	
Josh Levy, Mayor	Hollywood, FL 33020-4807	

	City of Hollywood	
	2600 Hollywood Boulevard	
Caryl S. Shuham, Commissioner District 1	Hollywood, FL 33020-4807	

	City of Hollywood	
	2600 Hollywood Boulevard	
Linda Hill Anderson, Commissioner District 2	Hollywood, FL 33020-4807	

	City of Hollywood	
	2600 Hollywood Boulevard	
Traci L. Callari, Commissioner District 3	Hollywood, FL 33020-4807	

	City of Hollywood	
	2600 Hollywood Boulevard	
Adam Gruber, Commissioner District 4	Hollywood, FL 33020-4807	

	City of Hollywood	
	2600 Hollywood Boulevard	
Kevin D. Biederman, Commissioner District 5	Hollywood, FL 33020-4807	

	City of Hollywood	
	2600 Hollywood Boulevard	
Idelma Quintana, Commissioner District 6	Hollywood, FL 33020-4807	
	CITY OF HOLLYWOOD	
	DEPT. OF PLANNING &	
	DEVELOPMENT SERVICES	
	PO BOX 229045	
	HOLLYWOOD FL 33022-9045	



CITY	STATE	ZIP	ZIP4	LEGAL
FORT LAUDERDALE	FL	33301	1801	HOLLYWOOD CENTRAL BEACH 4-20 BTHAT PT OF BLK 58 DESC INOR 12509/729 HOLLYWOOD CENTRAL BEACH 4-20 BBLKS 59,60,176,177,178,179,180,182,183,184,185,186,187,188,189,190,191 & 192 LESS POR BLK 59DESC'D IN OR
TALLAHASSEE	FL	32399	6575	35675/1299 & LESSPOR INCLUDED IN OR 7467/209 HOLLYWOOD CENTRAL BEACH 4-20 BLOTS 2 THRU 5,7 THRU 25,27 & 28BLK 118 &ALL BLKS 119,120 & 124 &LOTS 1 THRU 4,6 THRU 12 BLK 125& LOTS 1 THRU 10 BLK 126 &LOTS 1,3,4,5 & 10 BLK 127 &LOTS 1,3 THRU 8 BLK 128 &LOTS 1 THRU 9 BLK 129
FORT LAUDERDALE	FL	33301	1801	HOLLYWOOD CENTRAL BEACH 4-20 BLOTS 9 & 10 BLK 128
FORT LAUDERDALE	FL	33301	1801	HOLLYWOOD CENTRAL BEACH 4-20 BLOT 10 BLK 129 HOLLYWOOD CENTRAL BEACH 4-20 BLOTS 1 THRU 11 BLK 130 &LOTS 1 THRU 5,6 & 7 LESS R/W,9 &11 BLK 131 &LOTS 1,2,3,6 & 7 & 8,LESS CANALR/W,9,10 & 11 BLK 132 &LOTS 1 THRU 4,5 THRU 9,LESS R/W,10 THRU 13 BLK 133 &LOTS 1 THRU 4 & 5,6 & 7,LESSCANAL R/W,10 THRU 13 BLK 134 &LOTS 1 THRU 4,5 THRU 9,LESSCANAL R/W,10 THRU 13 BLK 135 &LOTS 1,2,4,6 THRU 9,LESS CANALR/W,11 & 12 BLK 136
FORT LAUDERDALE	FL	33301	1801	HOLLYWOOD CENTRAL BEACH 4-20 BLOT 8 LESS ST BLK 131 HOLLYWOOD CENTRAL BEACH 4-20 BLOTS 4 & 5 BLK 132, BOTH LESSR/W FOR INTRACOASTAL CANAL &LOTS 10 & 11 BLK 152
FORT LAUDERDALE	FL	33301	1801	HOLLYWOOD CENTRAL BEACH 4-20 BALL STREETS,DRIVES,BLVDS, ALLEYSWAYS, WALKS, AVES, PKWYS, HWYSLOCATED ADJ TO BLKS 61-70, BLKS103-120,124-136, LESS POR OF15' STRIP K/A BLK 58 LYING ADJTO BLK 59 12-51-42PART OF FLA E COAST CANAL DESCAS,BEG AT SW COR OF LOT 12 BLK AHOLLYWOOD BEACH FIRST ADD 1-31 BW 22.69,NW 217.21,NE 318.55,E50.47,SW 537.70 TO POB
DELRAY BEACH	FL	33483		



FORT LAUDERDALE	FL	33309	3421	SEC 12-51-42POR OF R/W(STE ROAD A-1-A)DEDICATED PER R/W MAP 12-13 B
HOLLYWOOD	FL	33020	4807	HOLLYWOOD BEACH FIRST ADD 1-31 BPOR OF R/W (STE ROAD A-1-A)DEDICATED PER SAID PLAT
DELRAY BEACH	FL	33483		HOLLYWOOD BEACH FIRST ADD 1-31 BLOTS 1 THROUGH 12,LESS E 12.82FT AS MEAS ALONG N & S LINES,THEREOF,TOG W/SOUTH 1/2 OF TAFST ABUTTING LOT 1 BLK A
HOLLYWOOD	FL	33019		HOLLYWOOD BEACH FIRST ADD 1-31 BLOTS 13 & 14, LESS E 12.81 FTTHEREOF BK "A" AND THAT POR OFFLORIDA EAST COAST CANAL 17-22ABCR DESC AS:FROM SW COR OF LOT14, BLK "A" OF HOLLYWOOD BEACHFIRST ADD 1-31 B, NLY 83.54 ALGW/L OF SAID BLK "A", W 22.71 ALGEXT OF N/L OF LOT 13, SLY 82.80,ELY 12.13 ALG EXT OF S/L OF SAIDLOT 14 TO POB
HOLLYWOOD	FL	33019		HOLLYWOOD BEACH FIRST ADD 1-31 BLOTS 15,16 & 17 LESS E 12.81 OFSAID LOTS & LESS S 38.46 OF LOT17 PER OR 3622/117 BLK A
FORT LAUDERDALE	FL	33309	3421	HOLLYWOOD BEACH FIRST ADD 1-31 BTHAT PT OF LOTS 15,16 & 17 LESSS 38.46 AS DESC IN OR 3622/117BLK A
HOLLYWOOD	FL	33020	4807	HOLLYWOOD BEACH FIRST ADD 1-31 BLOT 20 LESS E 12.81 FOR ST RDBLK A
FORT LAUDERDALE	FL	33312		HOLLYWOOD BEACH FIRST ADD 1-31 BLOTS 1 THRU 5, 21 & 22, BLK 9
FORT LAUDERDALE	FL	33312		HOLLYWOOD BEACH FIRST ADD 1-31 BLOT 6,7 BLK 9
FORT LAUDERDALE	FL	33312		HOLLYWOOD BEACH FIRST ADD 1-31 BLOTS 8 THRU 11 BLK 9
FORT LAUDERDALE	FL	33312		HOLLYWOOD BEACH FIRST ADD 1-31 BLOT 12 LESS RD R/W BLK 9
LOS ANGELES	CA	90036		HOLLYWOOD BEACH FIRST ADD 1-31 BLOT 13 THRU 15 LESS RD R/W BLK 9
FORT LAUDERDALE	FL	33312		HOLLYWOOD BEACH FIRST ADD 1-31 BLOT 16,17 BLK 9
HOLLYWOOD	FL	33019		HOLLYWOOD BEACH FIRST ADD 1-31 BLOT 1 BLK 10
HAMPTON	NH	03842	4309	HOLLYWOOD BEACH FIRST ADD 1-31 BLOT 2 BLK 10
CORAL GABLES	FL	33134		HOLLYWOOD BEACH FIRST ADD 1-31 BLOT 3,4 BLK 10
DIAMOND BAR	CA	91765		HOLLYWOOD BEACH FIRST ADD 1-31 BLOT 5,6 BLK 10
DIAMOND BAR	CA	91765		HOLLYWOOD BEACH FIRST ADD 1-31 BLOT 7 BLK 10



DIAMOND BAR	CA	91765		HOLLYWOOD BEACH FIRST ADD 1-31 BLOT 8 BLK 10 HOLLYWOOD BEACH FIRST ADD 1-31 BLOT 11 LESS RD
HOLLYWOOD	FL	33019	3438	R/W,12 LESS RDR/W BLK 10 HOLLYWOOD BEACH FIRST ADD 1-31 BLOT 13,14 & 15 BLK 10, LESS POROF SAID LOTS FOR RD R/W PER R/WMAP 12-13 B, LESS ADDITIONAL POROF LOT 14 BLK 10 FOR RD R/W PERMISC MAP 8-197 B AS SHOWN
FORT LAUDERDALE	FL	33312		
FORT LAUDERDALE	FL	33309	3421	HOLLYWOOD BEACH FIRST ADD 1-31 BPOR OF LOT 14 BLK 10 DEDICATEDFOR RD R/W PER MISC MAP 8-197 BAS SHOWN
FORT LAUDERDALE	FL	33312		HOLLYWOOD BEACH FIRST ADD 1-31 BLOT 16 BLK 10
HOLLYWOOD	FL	33019	3439	HOLLYWOOD BEACH FIRST ADD 1-31 BLOT 17 BLK 10
LOS ANGELES	CA	90036		HOLLYWOOD BEACH FIRST ADD 1-31 BLOTS 18 & 19 BLK 10
TARZANA	CA	91356		HOLLYWOOD BEACH FIRST ADD 1-31 BLOT 20 BLK 10
HOLLYWOOD	FL	33019	3517	HOLLYWOOD BEACH FIRST ADD 1-31 BLOT 1,2 BLK 11
MIAMI	FL	33131		HOLLYWOOD BEACH FIRST ADD 1-31 BLOT 5,6 BLK 11
OLD SAYBROOK	CT	06475		HOLLYWOOD BEACH FIRST ADD 1-31 BLOT 7 BLK 11
HOLLYWOOD	FL	33019		HOLLYWOOD BEACH FIRST ADD 1-31 BLOT 8 BLK 11
FORT LAUDERDALE	FL	33312		HOLLYWOOD BEACH FIRST ADD 1-31 BLOT 9 BLK 11 HOLLYWOOD BEACH FIRST ADD 1-31 BLOTS 10-15 BLK 11, LESSTHEREFROM W 12.81 FOR SR A-1-A,& LESS ADD'L R/W PER MISC MAP8-197 B, & LESS PAR NO 179.1 ASDESC IN INSTR #117459380
HOLLYWOOD	FL	33020		
FORT LAUDERDALE	FL	33309	3421	HOLLYWOOD BEACH FIRST ADD 1-31 BPOR OF LOT 11 BLK 11 DEDICATEDFOR RD R/W PER MISC MAP 8-197 BAS SHOWN HOLLYWOOD BEACH FIRST ADD 1-31 BA POR OF BLK 11 DESC AS: COMM ATSE COR OF LOT 11, BLK 11, W104.19, NLY 0.63 TO POB, CONTNLY 166.37, W 5.04, SLY 154.48,S 7.95 TO P/C, SELY ALG CUR 6.08TO POBAKA: PARCEL NO 107.1FDOT SECT 86030-2503/-MAINT.(1)SR A-1-A (OCEAN DR)
FORT LAUDERDALE	FL	33309	3421	
HOLLYWOOD	FL	33019	3518	HOLLYWOOD BEACH FIRST ADD 1-31 BLOT 16 BLK 11
NEW YORK	NY	10018		HOLLYWOOD BEACH FIRST ADD 1-31 BLOT 17 TO 19 BLK 11



*MONTREAL, QC	CA	H1M 2	Z2	HOLLYWOOD BEACH FIRST ADD 1-31 BLOT 20 BLK 11
HOLLYWOOD	FL	33019		HOLLYWOOD BEACH FIRST ADD 1-31 BE 34.05 OF LOT 1 BLK 12AKA-BLDG 1
HOLLYWOOD	FL	33019		HOLLYWOOD BEACH FIRST ADD 1-31 BW 45.95 OF LOTS 1 & 2 BLK 12AKA-BLDG 2 & 3
HOLLYWOOD	FL	33019		HOLLYWOOD BEACH FIRST ADD 1-31 BE 34.05 OF LOT 2 BLK 12AKA-BLDG 4
HOLLYWOOD	FL	33019	3518	HOLLYWOOD BEACH FIRST ADD 1-31 BLOT 3,4 BLK 12
HOLLYWOOD	FL	33019		HOLLYWOOD BEACH FIRST ADD 1-31 BLOTS 5,6,19 & 20 BLK 12
FORT LAUDERDALE	FL	33308	2001	HOLLYWOOD BEACH FIRST ADD 1-31 BLOT 7,8 BLK 12
HOLLYWOOD	FL	33019	1310	HOLLYWOOD BEACH FIRST ADD 1-31 BLOTS 9,10 BLK 12
DELRAY BEACH	FL	33483		HOLLYWOOD BEACH FIRST ADD 1-31 BLOT 11 LESS R/W BLK 12
HOLLYWOOD	FL	33021		HOLLYWOOD BEACH FIRST ADD 1-31 BLOT 12 LESS W 12.81 FOR R/WBLK 12
PORTSMOUTH	NH	03801		HOLLYWOOD BEACH FIRST ADD 1-31 BLOT 13 LESS R/W BLK 12
DORAL	FL	33178		HOLLYWOOD BEACH FIRST ADD 1-31 BLOT 14 LESS R/W BLK 12
FORT LAUDERDALE	FL	33312		HOLLYWOOD BEACH FIRST ADD 1-31 BLOT 15 BLK 12
HOLLYWOOD	FL	33019		HOLLYWOOD BEACH FIRST ADD 1-31 BLOT 16,17 BLK 12
DELRAY BEACH	FL	33446	2455	HOLLYWOOD BEACH FIRST ADD 1-31 BLOT 18 BLK 12
HOLLYWOOD	FL	33019		HOLLYWOOD BEACH FIRST ADD 1-31 BLOT 4 BLK 13
SUNNY ISLES BEACH	FL	33160		HOLLYWOOD BEACH FIRST ADD 1-31 BLOT 5,6 BLK 13
HOLLYWOOD	FL	33019	3535	HOLLYWOOD BEACH FIRST ADD 1-31 BLOT 7 BLK 13
MIAMI BEACH	FL	33141		HOLLYWOOD BEACH FIRST ADD 1-31 BLOT 8,9 BLK 13
MIAMI	FL	33261	1510	HOLLYWOOD BEACH FIRST ADD 1-31 BLOT 10,11 LESS RD R/W,12 LESSRD R/W,13 LESS RD R/W,15 BLK 13
PORTSMOUTH	NH	03801		HOLLYWOOD BEACH FIRST ADD 1-31 BLOT 18 BLK 13
HOLLYWOOD	FL	33020	4807	HOLLYWOOD BEACH SECOND ADD 4-6 BPOR OF R/W DEDICATED PER SAIDPLAT
DELRAY BEACH	FL	33483		HOLLYWOOD BEACH SECOND ADD 4-6 BLOT 1 LESS E 12.5 FOR R/W,2 LESSE 12.5 FOR R/W,3 LESS E 12.5 FORR/W,4 LESS E 12.5 FOR R/W,LOT 5LESS E 12.5 FOR R/W BLK B
DELRAY BEACH	FL	33483		HOLLYWOOD BEACH SECOND ADD 4-6 BTHAT POR OF N1/2 OF TAFT STREETABUTTING N/L OF LOT 1 BLK B



PORTSMOUTH	NH	03801		HOLLYWOOD BEACH SECOND ADD 4-6 BLOT 6 LESS RD R/W,7 LESS RD R/WBLK B
PORTSMOUTH	NH	03801		HOLLYWOOD BEACH SECOND ADD 4-6 BLOT 8 LESS R/W,9 LESS N 3.54 & LESS R/W BLK B
PORTSMOUTH	NH	03801		HOLLYWOOD BEACH SECOND ADD 4-6 BLOT 9 N 3.54 LESS R/W,10 LESSR/W,11 LESS R/W BLK B
DELRAY BEACH	FL	33483		HOLLYWOOD BEACH SECOND ADD 4-6 BBLK 1 & 15' ALLEY ADJ LOT 1 TO 4ON W/L,LOT 11,12,13,14,LESS W12.50 & LESS BEG NE COR BLK 1,W32.82,SELY & SWLY ARC DIST 16.67SW 146.26,SW 14.75,E 31.19,NLY166.07 TO POB & TOGETHER WITHPOR OF VAC TAFT,CAROLINA & SURFRD STREET ADJ TO SAID LOTS ASDESC IN ORD 38044/264 & LESS PORDESC IN OR 42959/1599
HOLLYWOOD	FL	33020	4807	HOLLYWOOD BEACH SECOND ADD 4-6 BPORTION OF TAFT STREET LYING SOF LOT 4 BLK 1 DESC AS COMM ATSW COR LOT 4,E 31.26,S 10.67 TOPOB,E 14.40,S 9.33,W 14.40,N9.33 TO POB
BOCA RATON	FL	33434	3364	HOLLYWOOD BEACH SECOND ADD 4-6 BLOT 3,4 BLK 2 & THAT POR OF VACCAROLINA ST LYING S & ADJ TO LOT4,AS DESC IN ORD 38044/264
DELRAY BEACH	FL	33483		HOLLYWOOD BEACH SECOND ADD 4-6 BLOT 5,6 E 1/2 BLK 2
PORTSMOUTH	NH	03801		HOLLYWOOD BEACH SECOND ADD 4-6 BLOT 6 W1/2,7 BLK 2
PORTSMOUTH	NH	03801		HOLLYWOOD BEACH SECOND ADD 4-6 BLOT 8 BLK 2
PORTSMOUTH	NH	03801		HOLLYWOOD BEACH SECOND ADD 4-6 BLOT 9,10 THRU 12 LESS RD R/WBLK 2
HOLLYWOOD	FL	33019	3637	HOLLYWOOD BEACH SECOND ADD 4-6 BLOT 16,17 BLK 2
HOLLYWOOD	FL	33020		HOLLYWOOD BEACH SECOND ADD 4-6 BLOT 18 BLK 2
HOLLYWOOD	FL	33019		TARA HALL CONDOUNIT 1PER CDO BK/PG: 2988/535
HOLLYWOOD	FL	33019	3500	TARA HALL CONDOUNIT 4PER CDO BK/PG: 2988/535
HOLLYWOOD	FL	33019	3500	TARA HALL CONDOUNIT 5PER CDO BK/PG: 2988/535
HOLLYWOOD	FL	33019		TARA HALL CONDOUNIT 6PER CDO BK/PG: 2988/535
HOLLYWOOD	FL	33019	3522	TARA HALL CONDOUNIT 7PER CDO BK/PG: 2988/535
HOLLYWOOD	FL	33019	3522	TARA HALL CONDOUNIT 8PER CDO BK/PG: 2988/535
HOLLYWOOD	FL	33020		TARA HALL CONDOUNIT 9PER CDO BK/PG: 2988/535
GARY	IN	46408		TARA HALL CONDOUNIT 10PER CDO BK/PG: 2988/535
HOLLYWOOD	FL	33019	3527	WINDSWEPT CLUB CONDOUNIT 1PER CDO BK/PG: 8178/668



				WINDSWEPT CLUB CONDOUNIT PH2PER CDO BK/PG:
HOLLYWOOD	FL	33019	3527	8178/668
HOLLYWOOD	FL	33019	3527	WINDSWEPT CLUB CONDOUNIT 3PER CDO BK/PG: 8178/668
				PALMIETTO TOWER CONDOUNIT 2PER CDO BK/PG:
HOLLYWOOD	FL	33019		32646/0272
				PALMIETTO TOWER CONDOUNIT 3PER CDO BK/PG:
HOLLYWOOD	FL	33020		32646/0272
				PALMIETTO TOWER CONDOUNIT 4PER CDO BK/PG:
HOLLYWOOD	FL	33019		32646/0272
				WATERWAYS CONDOBLDG A UNIT 3PER CDO BK/PG:
MIAMI	FL	33280	0412	32910/1806
				WATERWAYS CONDOBLDG A UNIT 4PER CDO BK/PG:
HOLLYWOOD	FL	33020		32910/1806
				WATERWAYS CONDOBLDG A UNIT 5PER CDO BK/PG:
HOLLYWOOD	FL	33019		32910/1806
				WATERWAYS CONDOBLDG A UNIT 6PER CDO BK/PG:
DEERFIELD BEACH	FL	33442		32910/1806
				WATERWAYS CONDOBLDG A UNIT 11PER CDO BK/PG:
HOLLYWOOD	FL	33021		32910/1806
				WATERWAYS CONDOBLDG A UNIT 12PER CDO BK/PG:
HOLLYWOOD	FL	33019		32910/1806
				WATERWAYS CONDOBLDG A UNIT 13PER CDO BK/PG:
HOLLYWOOD	FL	33021		32910/1806
				WATERWAYS CONDOBLDG B UNIT 1PER CDO BK/PG:
HOLLYWOOD	FL	33021		32910/1806
				WATERWAYS CONDOBLDG B UNIT 2PER CDO BK/PG:
HOLLYWOOD	FL	33021		32910/1806
				WATERWAYS CONDOBLDG C UNIT 7PER CDO BK/PG:
MARSHFIELD	MA	02050		32910/1806
				WATERWAYS CONDOBLDG C UNIT 8PER CDO BK/PG:
HOLLYWOOD	FL	33019		32910/1806
				WATERWAYS CONDOBLDG C UNIT 9PER CDO BK/PG:
*TORONTO ON	CA	M6P 2	G7	32910/1806
				WATERWAYS CONDOBLDG C UNIT 10PER CDO BK/PG:
SUNNY ISLES BEACH	FL	33160		32910/1806
				WATERWAYS CONDOBLDG C UNIT 14PER CDO BK/PG:
HOLLYWOOD	FL	33019		32910/1806



PEMBROKE PINES	FL	33029	WATERWAYS CONDOBLDG C UNIT 15PER CDO BK/PG: 32910/1806
			WATERWAYS CONDOBLDG C UNIT 16PER CDO BK/PG: 32910/1806
HOLLYWOOD	FL	33019	320 TAFT STREET CONDOUNIT 1PER CDO BK/PG: 9404/795
PORTSMOUTH	NH	03801	320 TAFT STREET CONDOUNIT 2PER CDO BK/PG: 9404/795
PORTSMOUTH	NH	03801	320 TAFT STREET CONDOUNIT 3PER CDO BK/PG: 9404/795
PORTSMOUTH	NH	03801	320 TAFT STREET CONDOUNIT 4PER CDO BK/PG: 9404/795
PORTSMOUTH	NH	03801	320 TAFT STREET CONDOUNIT 5PER CDO BK/PG: 9404/795
PORTSMOUTH	NH	03801	320 TAFT STREET CONDOUNIT 6PER CDO BK/PG: 9404/795
PORTSMOUTH	NH	03801	320 TAFT STREET CONDOUNIT 7PER CDO BK/PG: 9404/795
PORTSMOUTH	NH	03801	320 TAFT STREET CONDOUNIT 8PER CDO BK/PG: 9404/795
HOLLYWOOD	FL	33021	OCEAN BLUE CONDOUNIT 1PER CDO BK/PG: 12328/655
MEDLEY	FL	33178	OCEAN BLUE CONDOUNIT 2PER CDO BK/PG: 12328/655
LAKE WORTH	FL	33467	4761 OCEAN BLUE CONDOUNIT 3PER CDO BK/PG: 12328/655
HIALEAH	FL	33018	OCEAN BLUE CONDOUNIT 4PER CDO BK/PG: 12328/655
MIAMI	FL	33165	OCEAN BLUE CONDOUNIT 5PER CDO BK/PG: 12328/655
HALLANDALE BEACH	FL	33009	2842 OCEAN BLUE CONDOUNIT 6PER CDO BK/PG: 12328/655
BAL HARBOUR	FL	33154	OCEAN BLUE CONDOUNIT 7PER CDO BK/PG: 12328/655
AVENTURA	FL	33180	OCEAN BLUE CONDOUNIT 8PER CDO BK/PG: 12328/655
HOLLYWOOD	FL	33021	BEACH TERRACE RESORT CONDO AUNIT 101 BLDG APER AMCDO BK/PG: 13310/254
HOLLYWOOD	FL	33019	BEACH TERRACE RESORT CONDO AUNIT 102 BLDG APER AMCDO BK/PG: 13310/254
CLINTON TOWNSHIP	MI	48038	BEACH TERRACE RESORT CONDO AUNIT 103 BLDG APER AMCDO BK/PG: 13310/254
HOLLYWOOD	FL	33019	BEACH TERRACE RESORT CONDO AUNIT 105 BLDG APER AMCDO BK/PG: 13310/254
MIAMI	FL	33175	BEACH TERRACE RESORT CONDO AUNIT 106 BLDG APER AMCDO BK/PG: 13310/254
CLINTON TOWNSHIP	MI	48038	BEACH TERRACE RESORT CONDO AUNIT 107 BLDG APER AMCDO BK/PG: 13310/254
BROOKLYN	NY	11229	BEACH TERRACE RESORT CONDO AUNIT 201 BLDG APER AMCDO BK/PG: 13310/254
PLANTATION	FL	33324	BEACH TERRACE RESORT CONDO AUNIT 202 BLDG APER AMCDO BK/PG: 13310/254
HOLLYWOOD	FL	33019	BEACH TERRACE RESORT CONDO AUNIT 203 BLDG APER AMCDO BK/PG: 13310/254



PEABODY	MA	01960		BEACH TERRACE RESORT CONDO AUNIT 204 BLDG APER AMCDO BK/PG: 13310/254
TOMS RIVER	NJ	08753		BEACH TERRACE RESORT CONDO AUNIT 205 BLDG APER AMCDO BK/PG: 13310/254
TOMS RIVER	NJ	08753		BEACH TERRACE RESORT CONDO AUNIT 206 BLDG APER AMCDO BK/PG: 13310/254
BROOKFIELD	WI	53005		BEACH TERRACE RESORT CONDO AUNIT 207 BLDG APER AMCDO BK/PG: 13310/254
*NIAGARA FALLS ON	CA	L2G 6	P8	BEACH TERRACE RESORT CONDO AUNIT 208 BLDG APER AMCDO BK/PG: 13310/254
MIAMI LAKES	FL	33014		BEACH TERRACE RESORT CONDO AUNIT 301 BLDG APER AMCDO BK/PG: 13310/254
FLUSHING	NY	11358	3335	BEACH TERRACE RESORT CONDO AUNIT 302 BLDG APER AMCDO BK/PG: 13310/254
CARBONDALE	PA	18407		BEACH TERRACE RESORT CONDO AUNIT 303 BLDG APER AMCDO BK/PG: 13310/254
HOLLYWOOD	FL	33019		BEACH TERRACE RESORT CONDO AUNIT 304 BLDG APER AMCDO BK/PG: 13310/254
MIAMI	FL	33156		BEACH TERRACE RESORT CONDO AUNIT 305 BLDG APER AMCDO BK/PG: 13310/254
METHUEN	MA	01844		BEACH TERRACE RESORT CONDO AUNIT 306 BLDG APER AMCDO BK/PG: 13310/254
NORTH CHELMSFORD	MA	01863		BEACH TERRACE RESORT CONDO AUNIT 307 BLDG APER AMCDO BK/PG: 13310/254
MIAMI GARDENS	FL	33055		SEA CREST CONDOUNIT 101PER CDO BK/PG: 13985/708
HOLLYWOOD	FL	33020		SEA CREST CONDOUNIT 102PER CDO BK/PG: 13985/708
HIALEAH	FL	33012		SEA CREST CONDOUNIT 103PER CDO BK/PG: 13985/708
HOLLYWOOD	FL	33019		SEA CREST CONDOUNIT 104PER CDO BK/PG: 13985/708
HOLLYWOOD	FL	33019		SEA CREST CONDOUNIT 105PER CDO BK/PG: 13985/708
NEW BEDFORD	MA	02745		SEA CREST CONDOUNIT 106PER CDO BK/PG: 13985/708
FORT LAUDERDALE	FL	33312		SEA CREST CONDOUNIT 107PER CDO BK/PG: 13985/708
HOLLYWOOD	FL	33019		SEA CREST CONDOUNIT 108PER CDO BK/PG: 13985/708
N MIAMI BEACH	FL	33162	4525	SEA CREST CONDOUNIT 201PER CDO BK/PG: 13985/708
HOLLYWOOD	FL	33021		SEA CREST CONDOUNIT 202PER CDO BK/PG: 13985/708
PEMBROKE PINES	FL	33024		SEA CREST CONDOUNIT 203PER CDO BK/PG: 13985/708
DAVIE	FL	33331		SEA CREST CONDOUNIT 204PER CDO BK/PG: 13985/708
NORTH MIAMI BEACH	FL	33162		SEA CREST CONDOUNIT 205PER CDO BK/PG: 13985/708
HOLLYWOOD	FL	33021		SEA CREST CONDOUNIT 206PER CDO BK/PG: 13985/708



HOLLYWOOD	FL	33019		SEA CREST CONDOUNIT 207PER CDO BK/PG: 13985/708
FORT LAUDERDALE	FL	33312		SEA CREST CONDOUNIT 208PER CDO BK/PG: 13985/708
MIAMI	FL	33175		BEACH TERRACE RESORT CONDO BUNIT 1 BLDG BPER AMCDO BK/PG: 13110/254
VERO BEACH	FL	32968	6714	BEACH TERRACE RESORT CONDO BUNIT 2 BLDG BPER AMCDO BK/PG: 13110/254
LAKE GROVE	NY	11755		BEACH TERRACE RESORT CONDO BUNIT 3 BLDG BPER AMCDO BK/PG: 13110/254
WANTAGH	NY	11793	1419	BEACH TERRACE RESORT CONDO BUNIT 4 BLDG BPER AMCDO BK/PG: 13110/254
HOLLYWOOD	FL	33019		BEACH TERRACE RESORT CONDO BUNIT 5 BLDG B AKA B 108PER AMCDO BK/PG: 13110/254
HOLLYWOOD	FL	33019	1526	BEACH TERRACE RESORT CONDO BUNIT 6 BLDG B AKA B 107PER AMCDO BK/PG: 13110/254
NEW YORK	NY	10025	4755	BEACH TERRACE RESORT CONDO BUNIT 7 BLDG B AKA B 106PER AMCDO BK/PG: 13110/254
BOYNTON BEACH	FL	33437	6114	BEACH TERRACE RESORT CONDO BUNIT 8 BLDG B AKA B 105PER AMCDO BK/PG: 13110/254
AUSTIN	TX	78749		BEACH TERRACE RESORT CONDO BUNIT 21 BLDG BPER AMCDO BK/PG: 13110/254
MIAMI BEACH	FL	33139		BEACH TERRACE RESORT CONDO BUNIT 22 BLDG BPER AMCDO BK/PG: 13110/254
HOLLYWOOD	FL	33019		BEACH TERRACE RESORT CONDO BUNIT 23 BLDG BPER AMCDO BK/PG: 13110/254
QUEENVILLAGE	NY	11428		BEACH TERRACE RESORT CONDO BUNIT 24 BLDG BPER AMCDO BK/PG: 13110/254
BOYNTON BEACH	FL	33437	6114	BEACH TERRACE RESORT CONDO BUNIT 25 BLDG B AKA B 208PER AMCDO BK/PG: 13110/254
BOYNTON BEACH	FL	33437	6114	BEACH TERRACE RESORT CONDO BUNIT 26 BLDG B AKA B 207PER AMCDO BK/PG: 13110/254
HOLLYWOOD	FL	33019		BEACH TERRACE RESORT CONDO BUNIT 27 BLDG B AKA B 206PER AMCDO BK/PG: 13110/254
JAMAICA	NY	11429		BEACH TERRACE RESORT CONDO BUNIT 28 BLDG B AKA B 205PER AMCDO BK/PG: 13110/254
GREENFIELD	MA	01301		BEACH TERRACE RESORT CONDO CUNIT 1 BLDG CPER AMCDO BK/PG: 13110/254
MIAMI	FL	33139		BEACH TERRACE RESORT CONDO CUNIT 2 BLDG CPER AMCDO BK/PG: 13110/254



PEMBROKE PINES	FL	33029		BEACH TERRACE RESORT CONDO CUNIT 3 BLDG CPER AMCDO BK/PG: 13110/254
DAVIE	FL	33325		BEACH TERRACE RESORT CONDO CUNIT 4 BLDG CPER AMCDO BK/PG: 13110/254
*HILDESHEIM	DE	D31 1	37	BEACH TERRACE RESORT CONDO CUNIT 21 BLDG C AKA UNIT 5PER AMCDO BK/PG: 13110/254
HOLLYWOOD	FL	33019		BEACH TERRACE RESORT CONDO CUNIT 22 BLDG C AKA UNIT 6PER AMCDO BK/PG: 13110/254
HOLLYWOOD	FL	33021		BEACH TERRACE RESORT CONDO CUNIT 23 BLDG C AKA UNIT 7PER AMCDO BK/PG: 13110/254
HOLLYWOOD	FL	33021		BEACH TERRACE RESORT CONDO CUNIT 24 BLDG C AKA UNIT 8PER AMCDO BK/PG: 13110/254
HOLLYWOOD	FL	33021	2556	BEACH TERRACE RESORT CONDO DUNIT 1 BLDG DPER AMCDO BK/PG: 13110/254
HOLLYWOOD	FL	33019		BEACH TERRACE RESORT CONDO DUNIT 2 BLDG DPER AMCDO BK/PG: 13110/254
MIAMI	FL	33180	3851	BEACH TERRACE RESORT CONDO DUNIT 3 BLDG DPER AMCDO BK/PG: 13110/254
HOLLYWOOD	FL	33021		BEACH TERRACE RESORT CONDO DUNIT 4 BLDG DPER AMCDO BK/PG: 13110/254
HOLLYWOOD	FL	33019		BEACH TERRACE RESORT CONDO DUNIT 5 BLDG DPER AMCDO BK/PG: 13110/254
CHICAGO	IL	60601		BEACH TERRACE RESORT CONDO DUNIT 6 BLDG DPER AMCDO BK/PG: 13110/254
HOLLYWOOD	FL	33019		2000 NORTH OCEAN DR CONDOUNIT 101,102 & 108PER CDO BK/PG: 16701/373
HOLLYWOOD	FL	33019		2000 NORTH OCEAN DR CONDOUNIT 103PER CDO BK/PG: 16701/373
HOLLYWOOD	FL	33019	3460	2000 NORTH OCEAN DR CONDOUNIT 104 & 105PER CDO BK/PG: 16701/373
HOLLYWOOD	FL	33019		2000 NORTH OCEAN DR CONDOUNIT 106PER CDO BK/PG: 16701/373
*ST-HYACINTHE QC	CA	J2S 7	Z7	2000 NORTH OCEAN DR CONDOUNIT 107PER CDO BK/PG: 16701/373
HOLLYWOOD	FL	33019		HOLLYWOOD SANDS RESORTTIMESHARE CONDOPER CDO BK/PG: 10682/84
FORT LAUDERDALE	FL	33312		HOLLYWOOD RU-VEL CO-OPUNIT 1
FORT LAUDERDALE	FL	33312		HOLLYWOOD RU-VEL CO-OPUNIT 2



FORT LAUDERDALE	FL	33312	HOLLYWOOD RU-VEL CO-OPUNIT 3
FORT LAUDERDALE	FL	33312	HOLLYWOOD RU-VEL CO-OPUNIT 4
FORT LAUDERDALE	FL	33312	HOLLYWOOD RU-VEL CO-OPUNIT 5
FORT LAUDERDALE	FL	33312	HOLLYWOOD RU-VEL CO-OPUNIT 6
FORT LAUDERDALE	FL	33312	HOLLYWOOD RU-VEL CO-OPUNIT 7
FORT LAUDERDALE	FL	33312	HOLLYWOOD RU-VEL CO-OPUNIT 8
FORT LAUDERDALE	FL	33312	HOLLYWOOD RU-VEL CO-OPUNIT 9
FORT LAUDERDALE	FL	33312	HOLLYWOOD RU-VEL CO-OPUNIT 10



250  
125  
0  
250 Feet

MARTY KIAR  
BROWARD COUNTY PROPERTY APPRAISER  
VANTY VIDE  
BR. AWARD

2308 N Ocean Dr

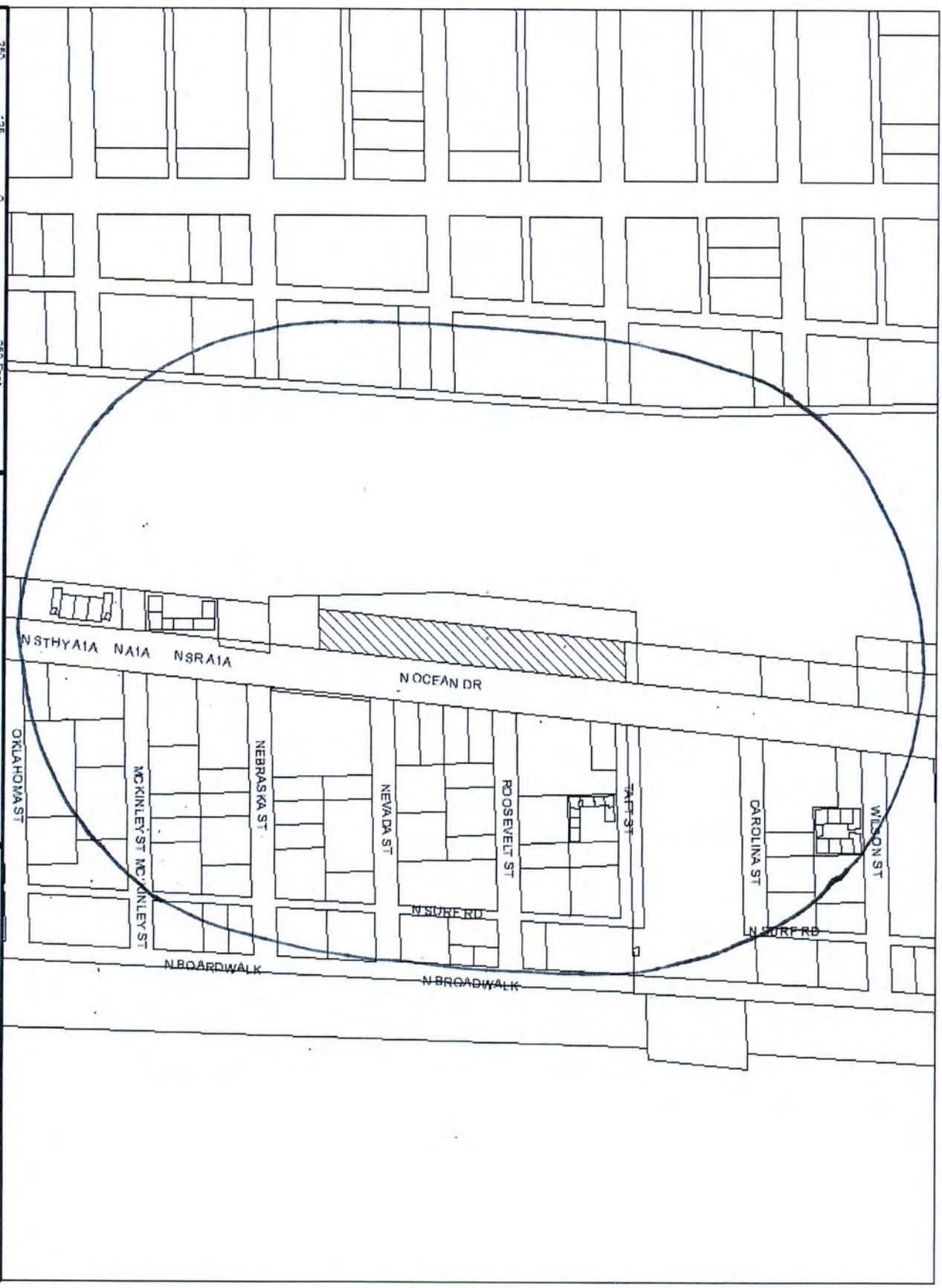



PREPARED BY AND RETURN TO:  
Richard H. Critchfield  
1001 East Atlantic Avenue  
Suite 201  
Delray Beach, Florida 33483

## **PERPETUAL PARKING EASEMENT AGREEMENT**

**THIS PARKING EASEMENT** (the “Parking Easement”) made this \_\_\_\_ day of March, 2024, granted by **HOLLYWOOD BEACH LLC**, a Florida limited liability company (“North Property Owner”), with an address at 1001 East Atlantic Avenue, Suite 202, Delray Beach, Florida 33483, in favor of **OCEANSIDE MARINA LLC**, a Florida limited liability company (“South Property Owner”).

**WHEREAS**, the South Property Owner is the owner of those parcels of real property more particularly described on Exhibit A attached hereto and by this reference made a part hereof (collectively, the “Oceanside Marina Adjacent Parcels”); and

**WHEREAS**, the North Property Owner is the owner of those parcels of real property more particularly described on Exhibit B attached hereto and by this reference made a part hereof (collectively, the “Hollywood Beach Adjacent Parcels”); and

**WHEREAS**, the North Property Owner, an affiliate of the South Property Owner, has agreed to grant the South Property Owner and its Permittees, as defined below, a perpetual non-exclusive easement to utilize those portions of the Hollywood Beach Adjacent Parcels which are designated from time to time for parking (the “Easement Area”) more particularly described as follows, to-wit:

Lots 1, 2, 3, 4 and 5, in Block B of HOLLYWOOD BEACH SECOND ADDITION, according to the Plat thereof, as recorded in Plat Book 4, Page 6, of the Public Records of Broward County, Florida, less and except the East 12.5 feet thereof, previously dedicated as additional right-of-way for North Ocean Drive (A1A).

**NOW, THEREFORE**, in consideration of the sum of Ten Dollars (\$10.00) and other good and valuable consideration, the receipt and sufficiency of which are hereby acknowledged, Grantor and Grantee hereby agree as follows:

1. **Recitals.**

The foregoing recitals are true and correct, are incorporated herein by reference,



and form an integral part of this Parking Easement.

**2. Grant of Easement.**

The North Property Owner does hereby grant the South Property Owner, its successors and assigns and its Permittees, upon the conditions hereinafter set forth, a perpetual non-exclusive easement (the "Parking Easement") to utilize the Easement Area for the parking of motor vehicles and for pedestrian and vehicular ingress and egress in connection therewith. "Permittee(s)" shall mean the members, managers, employees, agents, contractors, customers, visitors, invitees, licensees and concessionaires of the South Property Owner and their successors and assigns.

**3. Term of Parking Easement.**

The term of this Parking Easement shall be perpetual.

**4. Use Limitations.**

The South Property Owner shall use the Easement Area solely for the parking of motor vehicles and for pedestrian and vehicular ingress and egress in connection therewith and the South Property Owner shall not be entitled to utilize the Easement Area for any other use or purpose without the written approval of the North Property Owner, which approval shall not be unreasonably withheld, conditioned or delayed. The Easement Area shall in no event be blocked or closed, altered, changed or removed (the foregoing shall not be deemed to include maintenance, repairs, restriping etc. or temporary closures to effect same), unless required by applicable laws

**5. Maintenance.**

The South Property Owner shall pay to the North Property Owner for the use of the Easement Area the maintenance cost of the Easement Area.

**6. Appurtenant Easement.**

This Parking Easement is an easement appurtenant to the Oceanside Marina Adjacent Parcels and shall inure to the benefit of South Property Owner, and its successors and assigns, and shall run with the title to the Oceanside Marina Adjacent Parcels.

**7. Not Subject to liens.**

The interest of the South Property Owner in the Easement Area and the interest of the North Property Owner in the Hollywood Beach Adjacent Parcels shall not be subject to liens arising from the use of the Easement Area by the South Property Owner and/or the Permittees or the exercise by the South Property Owner and/or the Permittees of the rights granted hereunder.



The South Property Owner shall promptly cause any lien which it causes to be imposed against the Easement Area to be discharged or transferred to bond.

**8. Indemnity.**

The South Property Owner, its successors and assigns shall indemnify, defend and hold the North Property Owner harmless from and against any damages, liability, actions, claims or expenses (including reasonable attorney's fees and expenses at trial and all appellate levels) arising out of exercise of the rights granted hereby by any person whomsoever, including, without limitation, loss of life, personal injury and/or damage to property arising from or out of any occurrence in or upon the Easement Area or in connection with the use or operation of the Easement Area by the South Property Owner and/or the Permittees or exercise by the South Property Owner and/or the Permittees of the rights granted by this Parking Easement.

**9. Insurance.**

The South Property Owner shall provide, maintain and keep in full force and effect general liability insurance in an amount not less than Two Million Dollars (\$2,000,000) per occurrence, combined single limit bodily injury and property damage liability coverage, and workers' compensation covering all employees in accordance with Chapter 440 Florida Statutes. In addition, Grantee shall maintain business automobile liability at a limit of liability not less than \$1,000,000 each occurrence for all owned, non-owned and hired automobiles.

Except for workers' compensation, all insurance policies shall name the North Property Owner as additional insured. Such insurance shall be issued by an insurance company licensed to do business in the State of Florida. A certificate of insurance evidencing such insurance coverage shall be provided to the North Property Owner prior to the use of the Easement Area by the South Property Owner and such certificate shall require at least thirty (30) days prior notice of cancellation or adverse material change in coverage.

In no event shall the limits of said insurance policies be considered as limiting the liability of the South Property Owner under this Parking Easement. Furthermore, the South Property Owner shall and hereby does hold the North Property Owner harmless from any loss or damage incurred or suffered by the North Property Owner due to the failure of the South Property Owner to maintain such insurance.

**10. No Dedication**

The grant of easement contained herein is for the use and benefit of the South Property Owner, its successors, and assigns and the Permittees and is not intended and shall not be construed as a dedication to the public of any portion of the Easement Area for public use.

**11. Run with Land**



All of the benefits, burdens, covenants and agreements herein shall constitute covenants running with the land, shall be binding upon and/or shall accrue to the benefit of and be binding upon the North Property Owner and the South Property Owner and their respective successors and assigns, having or hereafter acquiring any right title or interest in or to all or any portion of the Hollywood Beach Adjacent Parcels or the Oceanside Marina Adjacent Parcels.

12. Recordation and Amendments.

This Perpetual Parking Easement Agreement shall be construed under the laws of the State of Florida. This Perpetual Parking Easement Agreement and any amendments hereto shall be recorded in the Public Records of Broward County, Florida. This Agreement may only be modified, supplemented or revised in writing signed by the parties, or their successors or assigns, and any modification shall be effective only upon recordation in the Public Records of Broward County, Florida. This Perpetual Parking Easement Agreement shall not be modified, amended or released unless approved by the City Manager or his/her designee.

13. Termination.

In the event that North Property Owner and/or the South Property Owner desire to sell or otherwise transfer title of their respective properties to a third party, both parties shall submit proper documentation, in a form acceptable to the City, evidencing that the parking requirements are satisfied through the use of alternative sites. Such documentation must be submitted and approved by the City prior to any sale or transfer of title. No use may be made of the subject properties until the required parking requirements are satisfied by the use of such replacement parking. Such documentation shall be recorded in the public records of Broward County, Florida. Upon recordation of the new parking documentation, this Perpetual Parking Easement Agreement shall be terminated and released by the City.

**12. Assignability.**

This Parking Easement is an easement appurtenant to the Hollywood Beach Adjacent Parcels and may not be transferred or assigned separately or apart from the Hollywood Beach Adjacent Parcels.

**13. Remedies.**

In the event either party fails or refuses to perform any term, covenant, or condition of this Parking Easement for which a specific remedy is not set forth in this Parking Easement, the other party shall, in addition to any other remedies provided at law or in equity, have the right of specific performance and injunctive relief.

**14. Subject to Matters of Record.**

This Parking Easement is granted without warranty or representation and subject to zoning and other governmental restrictions, matters reflected on any plat relating to the Easement Area, and all other easements, restrictions, conditions, encumbrances and other matters of record.

**15. Miscellaneous.**

This Parking Easement shall be governed by, construed and enforced in accordance with, the laws of the State of Florida. Venue in any action, suit or proceeding in connection with this Easement shall be in a state court of competent jurisdiction in Broward County, Florida. No party shall be considered the author of this Parking Easement since the parties hereto have participated in extensive negotiations and drafting and redrafting of this document so as to arrive at a final agreement. Thus, the terms of this Parking Easement shall not be strictly construed against one party as opposed to the other party based upon who drafted it. In the event that any section, paragraph, sentence, clause, or provision hereof or the application thereof to any person or circumstance, shall be determined to be unenforceable by a court of competent jurisdiction (the "Offending Provision"), then the remainder of this Parking Easement, or the application of such term, covenant or condition to persons, entities or circumstances other than those as to which it is invalid or unenforceable, shall not be affected thereby and each term, covenant and condition of this Parking Easement shall be valid and enforced to the fullest extent permitted by law; provided, however, that the parties affected by the Offending Provision shall endeavor in good faith, within sixty (60) days after the date such determination is made, to agree upon alternative provisions which shall have the same practical effect as the Offending Provision and upon any agreement being reached, the new provision shall be incorporated into and form a part of this Parking Easement. This Parking Easement contains the entire understanding and agreement of the parties with respect to the subject matter hereof. No amendment shall be effective unless the same is in writing and signed by all parties.

IN WITNESS WHEREOF, the parties have executed this Parking Easement on the date set forth hereinabove.



Signed in the presence of:

\_\_\_\_\_  
(Signature)

\_\_\_\_\_  
(Print Name of Witness)

\_\_\_\_\_  
(Signature)

\_\_\_\_\_  
(Print Name of Witness)

\_\_\_\_\_  
(Signature)

\_\_\_\_\_  
(Print Name of Witness)

\_\_\_\_\_  
(Signature)

\_\_\_\_\_  
(Print Name of Witness)

North Property Owner:

HOLLYWOOD BEACH LLC,  
a Florida limited liability company

By: \_\_\_\_\_  
Mark Walsh  
Its Manager

SOUTH PROPERTY OWNER:

OCEANSIDE MARINA LLC,  
a Florida limited liability company

By: \_\_\_\_\_  
Mark Walsh  
Its Manager

[ACKNOWLEDGMENTS APPEAR ON THE FOLLOWING PAGE]

STATE OF FLORIDA  
COUNTY OF PALM BEACH

The foregoing instrument was acknowledged before me by means of  physical presence or  online notarization, this \_\_\_\_\_ day of \_\_\_\_\_, 2024, by Mark Walsh as Manager of HOLLYWOOD BEACH LLC, a Florida limited liability company. He  is personally known to me or  has produced \_\_\_\_\_ as identification.

My Commission Expires:

(AFFIX NOTARY SEAL)

\_\_\_\_\_  
(Signature)

Name: \_\_\_\_\_  
(Legibly Printed)

Notary Public, State of \_\_\_\_\_

(Commission Number, if any)

STATE OF FLORIDA  
COUNTY OF PALM BEACH

The foregoing instrument was acknowledged before me by means of  physical presence or  online notarization, this \_\_\_\_\_ day of \_\_\_\_\_, 2024, by Mark Walsh as Manager of OCEANSIDE MARINA LLC, a Florida limited liability company. He  is personally known to me or  has produced \_\_\_\_\_ as identification.

My Commission Expires:

(AFFIX NOTARY SEAL)

\_\_\_\_\_  
(Signature)

Name: \_\_\_\_\_  
(Legibly Printed)

Notary Public, State of \_\_\_\_\_

(Commission Number, if any)



## **EXHIBIT A**

### Oceanside Marina Adjacent Parcels

Lots 1 through 12, inclusive, LESS the East 12.82 feet as measured along the North and South lines thereof, Block A, HOLLYWOOD BEACH FIRST ADDITION, according to the Plat thereof, as recorded in Plat Book 1, Page 31 of the Public Records of Broward County, Florida.

TOGETHER WITH all that part of Taft Street Right-of-Way, formerly Arkansas Street, lying West of the Right-of-Way of North Ocean Drive (also known as State Road A-1-A).

ALSO TOGETHER WITH all that part of the Florida East Coast Canal (also known as the Intracoastal Waterway), described as follows: Beginning at the Southwest corner of Lot 12, Block A, HOLLYWOOD BEACH FIRST ADDITION, according to the Plat thereof, recorded in Plat Book 1, Page 31, of the Public Records of Broward County, Florida; thence South 88° 05' 13" West, along a projection Westerly of the South Line of said Lot 12, 22.69 feet; thence North 01° 33' 26" West, 217.21 feet; thence North 05° 43' 31" East, 318.55 feet; thence North 88° 05' 13" East along a projection Westerly of the North Right-of-Way line of Taft Street, formerly Arkansas Street, 50.47 feet; thence South 05° 43' 31" West, along the West line of Lots 1 through 12, inclusive, Block A of said HOLLYWOOD BEACH FIRST ADDITION, 537.70 feet to the Point of Beginning.

ALSO TOGETHER WITH Lot 11, Block 12, HOLLYWOOD BEACH FIRST ADDITION, according to the Plat thereof, as recorded in Plat Book 1, Page 31 of the Public Records of Broward County, Florida, LESS the Right-of-Way for North Ocean Drive (also known as State Road A-1-A).

## EXHIBIT B

### Hollywood Beach Adjacent Parcels

#### PARCEL A

ALL OF LOTS 1-10, 15-20 IN BLOCK 1 OF HOLLYWOOD BEACH SECOND ADDITION, ACCORDING TO THE PLAT THEREOF RECORDED IN PLAT BOOK 4, PAGE 6 OF THE PUBLIC RECORDS OF BROWARD COUNTY, FLORIDA, TOGETHER WITH A PORTION OF LOTS 11-14, TOGETHER WITH A PORTION OF TAFT STREET, TOGETHER WITH A PORTION OF CAROLINA STREET, TOGETHER WITH A PORTION OF VACATED SURF ROAD FURTHER DESCRIBED AS FOLLOWS:

COMMENCING AT THE SOUTHWEST CORNER OF LOT 11, BLOCK 1 OF HOLLYWOOD BEACH SECOND ADDITION, ACCORDING TO THE PLAT THEREOF RECORDED IN PLAT BOOK 4, PAGE 6 OF THE PUBLIC RECORDS OF BROWARD COUNTY, FLORIDA; THENCE RUN EAST, A DISTANCE OF 12.50 FEET TO A POINT ON THE EASTERLY RIGHT OF WAY LINE OF OCEAN DRIVE FOR A POINT OF BEGINNING; THENCE RUN NORTH 07°50'00" EAST ALONG SAID EAST RIGHT OF WAY LINE, A DISTANCE OF 167.08 FEET TO THE INTERSECTION WITH THE SOUTHERLY RIGHT OF WAY LINE OF CAROLINA STREET; THENCE RUN EAST ALONG SAID SOUTH RIGHT OF WAY LINE A DISTANCE OF 328.16 FEET; THENCE RUN NORTH 05°28'26" EAST, A DISTANCE OF 20.09 FEET; THENCE RUN EAST, A DISTANCE OF 80.00 FEET TO THE EASTERLY LINE OF BLOCK 1 EXTENDED NORTHERLY; THENCE RUN SOUTH 05°28'36" WEST ALONG SAID EASTERLY LINE OF BLOCK 1 EXTENDED NORTHERLY, EAST LINE OF BLOCK 1 AND THE SOUTHERLY EXTENSION OF THE EASTERLY LINE OF BLOCK 1, A DISTANCE OF 206.46 FEET; THENCE RUN WEST, A DISTANCE OF 32.42 FEET; THENCE RUN NORTH, A DISTANCE OF 9.33 FEET; THENCE RUN NORTH 89°55'13" WEST, A DISTANCE OF 14.40 FEET; THENCE RUN SOUTH, A DISTANCE OF 9.33 FEET, THENCE RUN WEST, A DISTANCE OF 33.18 FEET; THENCE RUN NORTH 05°28'26" EAST, A DISTANCE OF 20.09 FEET TO A POINT ALONG THE NORTHERLY RIGHT OF WAY LINE OF TAFT STREET (ARKANSAS PLAT); THENCE RUN WEST ALONG SAID RIGHT OF WAY, A DISTANCE OF 335.07 FEET TO THE POINT OF BEGINNING.

#### PARCEL B

A PORTION OF LOTS 1-5 IN BLOCK B OF HOLLYWOOD BEACH SECOND ADDITION, ACCORDING TO THE PLAT THEREOF RECORDED IN PLAT BOOK 4, PAGE 6 OF THE PUBLIC RECORDS OF BROWARD COUNTY, FLORIDA, FURTHER DESCRIBED AS FOLLOWS:

COMMENCING AT THE SOUTHWEST CORNER OF LOT 11, BLOCK 1 OF HOLLYWOOD BEACH SECOND ADDITION, ACCORDING TO THE PLAT THEREOF RECORDED IN PLAT BOOK 4, PAGE 6 OF THE PUBLIC RECORDS OF BROWARD COUNTY, FLORIDA; THENCE RUN WEST, A DISTANCE OF 58.04 FEET TO A POINT



ON THE WESTERLY RIGHT OF WAY LINE OF OCEAN DRIVE AS DESCRIBED IN O.R. BOOK 3475, PAGE 918 PUBLIC RECORDS OF BROWARD COUNTY, FLORIDA FOR A POINT OF BEGINNING; THENCE CONTINUE WEST, A DISTANCE OF 67.38 FEET; THENCE RUN NORTH 07°50'00" EAST, A DISTANCE OF 207.08 FEET; THENCE RUN EAST, A DISTANCE OF 67.38 FEET TO A POINT ON THE WESTERLY RIGHT OF WAY LINE OF OCEAN DRIVE AS DESCRIBED IN O.R. BOOK 3475, PAGE 918 PUBLIC RECORDS OF BROWARD COUNTY, FLORIDA; THENCE RUN ALONG SAID RIGHT OF LINE, S 07°50'00" W, A DISTANCE OF 207.08 FEET TO THE POINT OF BEGINNING.

PARCELS A AND B BEING ALSO DESCRIBED AS FOLLOWS:

PARCEL 1

LOTS 1, 2, 3, 4 AND 5, IN BLOCK B OF HOLLYWOOD BEACH SECOND ADDITION, ACCORDING TO THE PLAT THEREOF, RECORDED IN PLAT BOOK 4, PAGE 6, OF THE PUBLIC RECORDS OF BROWARD COUNTY, FLORIDA.

LESS AND EXCEPT THE EAST 12.5 FEET THEREOF AS CONVEYED BY DEED RECORDED IN O.R. BOOK 3475, PAGE 918, PREVIOUSLY DEDICATED AS ADDITIONAL RIGHT-OF-WAY FOR NORTH OCEAN DRIVE (A-1-A).

PARCEL 2

ALL OF BLOCK 1 OF HOLLYWOOD BEACH SECOND ADDITION, ACCORDING TO THE PLAT THEREOF RECORDED IN PLAT BOOK 4, PAGE 6, OF THE PUBLIC RECORDS OF BROWARD COUNTY, FLORIDA,

LESS AND EXCEPT

A) THE WEST 12.5 FEET THEREOF AS CONVEYED BY DEED RECORDED IN O.R. BOOK 3475, PAGE 918, PREVIOUSLY DEDICATED AS ADDITIONAL RIGHT-OF-WAY FOR NORTH OCEAN DRIVE (A-1-A); AND

B) THAT CERTAIN PARCEL PREVIOUSLY DEDICATED AS THE NEW RIGHT-OF-WAY FOR SURF ROAD AND DESCRIBED AS FOLLOWS:

BEGIN AT THE NORTHEAST CORNER OF BLOCK 1, HOLLYWOOD BEACH SECOND ADDITION, ACCORDING TO THE PLAT THEREOF RECORDED IN PLAT BOOK 4, PAGE 6, OF THE PUBLIC RECORDS OF BROWARD COUNTY, FLORIDA, AND RUN WESTERLY ALONG NORTH LINE OF SAID BLOCK 1 A DISTANCE OF 33.11 FEET TO A POINT OF CUSP OF A CURVE TO THE SOUTHEAST HAVING A RADIUS OF 10 FEET AND A CENTRAL ANGLE OF 95 DEGREES 29 MINUTES 10 SECONDS; THENCE, RUN SOUTHEASTERLY ALONG SAID CURVE AN ARC DISTANCE OF 16.67 FEET TO A POINT OF TANGENCY; THENCE, RUN SOUTHWESTERLY A DISTANCE OF 145.97 FEET TO A POINT OF CURVATURE OF A CIRCULAR CURVE TO THE RIGHT HAVING A RADIUS OF 10 FEET AND A CENTRAL ANGLE OF 84 DEGREES 30 MINUTES 50 SECONDS; THENCE, RUN ALONG SAID CURVE AN ARC DISTANCE OF 14.75 FEET TO A POINT OF TANGENCY OF SAID CURVE, THE SAID POINT OF TANGENCY BEING A POINT ON THE SOUTH LINE OF SAID BLOCK 1; THENCE RUN EASTERLY

ALONG SAID SOUTH LINE OF SAID BLOCK 1 A DISTANCE OF 31.19 FEET TO THE SOUTHEAST CORNER OF SAID BLOCK 1; THENCE, RUN NORTHEASTERLY ALONG THE EAST LINE OF SAID BLOCK 1, A DISTANCE OF 166.07 FEET TO THE NORTHEAST CORNER OF SAID BLOCK 1 AND THE POINT OF BEGINNING OF THE TRACT DESCRIBED HEREIN.

PARCEL 3

A PARCEL OF LAND FORMERLY THE RIGHT-OF-WAY FOR SURF ROAD (NOW VACATED) LYING WITHIN THE BOUNDARY LINE OF BLOCK 1 OF HOLLYWOOD BEACH SECOND ADDITION, ACCORDING TO THE PLAT THEREOF, RECORDED IN PLAT BOOK 4, PAGE 6, OF THE PUBLIC RECORDS OF BROWARD COUNTY, FLORIDA DESCRIBED AS FOLLOWS:

BOUNDED ON THE EAST BY THE WESTERLY LINE OF LOTS 1 TO 4, INCLUSIVE, IN BLOCK 1; ON THE SOUTH BY THE SOUTHERLY BOUNDARY LINE OF SAID BLOCK 1; ON THE WEST BY THE EASTERLY LOT LINE OF LOTS 5 AND 20 IN SAID BLOCK 1, AND ON THE NORTH BY THE NORTHERLY BOUNDARY LINE OF SAID BLOCK 1.

PARCEL 4

A PARCEL OF LAND FORMERLY A PORTION OF TAFT STREET, CAROLINA STREET AND SURF ROAD

(NOW VACATED) LYING WITHIN AND ADJACENT TO BLOCK 1 OF HOLLYWOOD BEACH SECOND ADDITION, AND DESCRIBED IN ORDINANCE NO. 0-2001-01, RECORDED IN O.R. BOOK 31264, PAGE 599.

LESS AND EXCEPT FROM THE ABOVE DESCRIPTION OF THE PROPERTY CONVEYED BY DEED, RECORDED IN O.R. BOOK 42959, PAGE 1599.