



REP SERVICES, INC.

Experts at Play & Outdoor Spaces

Site Amenities ■ Playground Equipment ■ Safety Surfacing ■ Shade
Phone: 407.831.9658 Fax: 866.232.8532 E-mail: sales@repervices.com

Please mail POs, contracts and checks to:

Rep Services, Inc.
581 Technology Park, STE 1009
Lake Mary, FL 32746-7127

Proposed To: City of Hollywood Parks & Recreation and Cultural Arts 1405 South 28th Avenue Hollywood, FL 33022-9045	Ship To: TBD at a later date	Bill To: City of Hollywood Parks & Recreation and Cultural Arts 1405 South 28th Avenue Hollywood, FL 33022-9045
Attn: Karl Chuck	Attn:	Attn: Karl Chuck

Project No: 16574	Project Name: City of Hollywood- Montella Park (phase	Project Contact: Karl Chuck
Proposal No: 16574.02	Proposal Name: Montella Park-Opt 2	Project Location: 1231 N 69th Way Hollywood, FL 33024-5600 Project County: Broward
Proposal Date: 4/29/2019	Proposal Expires: 5/29/2019	
For Questions Contact: Jacqui Rohrborn ☎ 407-915-7860 ✉ jacqui@repervices.com		
Sales Consultant: Debbie Levine ☎ 561-353-0980 ✉ debbie@repervices.com		Opt/Rev: B/0 Printed: 5/7/2019 - JR

Vendor: Landscape Structures **Proj Drawings:** 16574-1-1 568881

Class	Part No	Qty	Description	Unit Price	Ext Price
Play Area 2-5					
Bridges & Ramps	WV164178A-001	1 EA	Boppity Bridge DB	5,670.00	5,670.00
	WV173575A-001	1 EA	Swiggly Stix Bridge DB	4,320.00	4,320.00
Climbers	WV173573A-001	1 EA	Wee Planet Climber DB	2,470.00	2,470.00
Kids In Motion	IP186490A-001	1 EA	We-saw DB Only	9,645.00	9,645.00
Motion & More Fun	WV164173A-001	1 EA	Twirly Bar DB	530.00	530.00
Signs	IP182503A-001	1 EA	Welcome Sign (LSI Provided) Ages 2-5 years Direct Bury	0.00	0.00
Slides & Gliders	WV164174A-003	1 EA	Cozy Coaster Slide w/ASTM Handrail DB w/Stairs Under Large Arch	6,025.00	6,025.00
Weevos	WV164170A-001	1 EA	Weevos 3 Arch Mainstructure DB Only	3,010.00	3,010.00
Play Area 2-5 Total:					\$31,670.00
Play Area 5-12					
Bridges & Ramps	PB111345A-001	2 EA	Bridge/Ramp Transition Bracket	275.00	550.00
Climbers	PB152907B-001	1 EA	Deck Link w/Barriers Steel end panels 2 Steps	1,855.00	1,855.00
	PB165445A-002	1 EA	Ring Tangle w/Handloop 8"Dk Diff	2,370.00	2,370.00
Decks	PB111231A-001	1 EA	Triangular Tenderdeck	720.00	720.00
	PB152911A-004	1 EA	Curved Transfer Module Left 32"Dk DB	2,160.00	2,160.00
Kids In Motion	IP173591A-001	1 EA	OmniSpin Spinner Surface Mount	7,430.00	7,430.00
Motion & More Fun	PB120818A-001	2 EA	Playstructure Seat	350.00	700.00
Overhead Events	PB142890A-004	1 EA	2"90° Horizontal Ladder DB Connected	1,725.00	1,725.00
Posts	PB111404C-001	2 EA	132"Alum Post DB	335.00	670.00
	PB111404E-001	6 EA	116"Alum Post DB	280.00	1,680.00
	PB111404F-001	2 EA	108"Alum Post DB	275.00	550.00
	PB111404G-001	1 EA	100"Alum Post DB	270.00	270.00
Sensory Play	IP214441A-001	1 EA	Rhapsody Vivo Metallophone DB	4,350.00	4,350.00
	IP214445A-001	1 EA	Rhapsody Kettle Drum DB	1,330.00	1,330.00
	IP251574A-001	1 EA	Rhapsody Vibra Chimes Pentatonic Scale DB	4,725.00	4,725.00
Signs	IP182503C-001	1 EA	Welcome Sign (LSI Provided) Ages 5-12 years Direct Bury	0.00	0.00
Slides & Gliders	PB124863D-010	1 EA	SlideWinder2 56"Dk DB 2 Right	2,650.00	2,650.00
	PB189313A-001	1 EA	Rushwinder DB Right	4,570.00	4,570.00
Swings	IP174018A-001	2 EA	Belt Seat ProGuard Chains for 8' Beam Height	115.00	230.00
	IP176038A-001	2 EA	Full Bucket Seat ProGuard Chains for 8' Beam Height	270.00	540.00
	IP177351A-001	1 EA	Molded Bucket Seat (5-12 yrs) w/Harness ProGuard Chains for 8' Beam Height	780.00	780.00
	IP218671C-001	1 EA	Molded Bucket Seat (2-5 yrs) w/Harness ProGuard Chains for 8' Beam Height	780.00	780.00
	IP221292A-001	1 EA	5" Arch Swing Frame 8' Beam Height Only	2,600.00	2,600.00

IP221293A-001	2 EA	5" Arch Swing Frame Additional Bay 8' Beam Height Only	1,590.00	3,180.00
Play Area 5-12 Total:				\$46,415.00
			Product Subtotal:	\$78,085.00
			Discount per the City of St. Petersburg Contract #650-99:	8.00% (\$6,246.80)
			Discounted Product Total:	\$71,838.20
			Signed & Sealed Engineering:	\$2,500.00
Freight: Prepaid Ship Method: Best Way FOB: Destination Weight: 5,515 lbs Freight Charge:				\$8,450.00
			Landscape Structures Total:	\$82,788.20

Vendor: LSI SkyWays **Proj Drawings:** 16574-1-1 568882

Class	Part No	Qty	Description	Unit Price	Ext Price
Shade	IP215187H-001	1 EA	SkyWays Hip 40'x40' Shade 14' Roof Height w/Rapid Release	14,290.00	14,290.00
			Product Subtotal:		\$14,290.00
			Discount per the City of St. Petersburg Contract #650-99:	6.00%	(\$857.40)
			Discounted Product Total:		\$13,432.60
			Signed & Sealed Engineering:		\$1,700.00
Freight: Prepaid Ship Method: Best Way FOB: Destination Weight: 2,590 lbs Freight Charge:					\$3,640.00
			LSI SkyWays Total:		\$18,772.60

Vendor: Foreverlawn Tampa Bay **Proj Drawings:** 16574-1-1 568933

Class	Part No	Qty	Description	Unit Price	Ext Price
Surfacing	MONTELLA PARK-PGG	5,655 EA	ForeverLawn Playground Grass Extreme at a maximum fall height of 8'.	14.75	83,411.25
			Foreverlawn Tampa Bay Total:		\$83,411.25

Vendor: RSI Installer 568976

Item	Qty	Description	Unit Price	Ext Price
PERMIT FILING	1 EA	Labor charge for Licensed Contractor to file for building permit from the appropriate jurisdiction. NOTE: Permit Fees charged by the jurisdiction will be prepaid and invoiced separately and may require a change order to your Purchase Order or Contract.	800.00	800.00
STORAGE	1 EA	Storage Container for (1) month during installation	750.00	750.00
TRASH REMOVAL	1 LT	Trash removal from jobsite	850.00	850.00
SITE WORK	5,350 SF	Prepping area for safety surfacing	1.30	6,955.00
DEMO	1 LT	Option 2 - Demolition of all existing equipment	5,920.00	5,920.00
DEMO	5,350 SF	Demolition of existing surfacing	1.00	5,350.00
INS-LSI	1 LT	Option 2 - Equipment Installation - Landscape Structures Drawing 16574-1-1, replacing all play equipment	23,630.00	23,630.00
INS-CON FT	4 EA	Install concrete footing(s) for SkyWays 40x40 Hip Shade Structure	1,015.00	4,060.00
INS-SKY	1 LT	Equipment Installation - LSI SkyWays 40x40 Hip Shade Structure	14,735.00	14,735.00
INS-CON CURB	24 LF	Installation Curb concrete w/rebar (6"x6")	26.50	636.00
			RSI Installer Total:	\$63,686.00

General Terms of Sale and Proposal Summary

Net 30	Product:	\$172,882.05
	Installation:	\$63,686.00
	Freight:	\$12,090.00
	Proposal Total:	\$248,658.05

Notes

Proposal is for **Option 2** removal of existing play equipment and replacing with new play equipment.
 City of St. Petersburg Purchasing Contract 650-99 discounts and installation: Landscape Structures 8% >\$50,000.00.
 City of St. Petersburg Purchasing Contract 650-99 discounts and installation: Landscape Structures SkyWays Shade Structure 6% Discount <\$50,000.00

Basis of Proposal

Our proposal is based upon our discussion during my visit.

Estimated project completion schedule

(This schedule starts when all needed information to direct engineering has been gathered.)
 4 Weeks: Engineering

4 Weeks+/- Permitting, finishes, etc..
 4 Weeks Longest manufacturing lead time. (Typical for scheduling.)
 1 Week Shipping
 4 Weeks Installation of equipment and surfacing
 17 Weeks TOTAL WEEKS
 Note that RSI is committed to do all it can to meet the needs of your project.

To be provided by the customer, as applicable:

- Permit Fees assessed by the Building Dept.
- Site Plan or Survey
- Soils testing
- Tree Survey

Scope of Proposal

Please note the vendor requirements itemized below.

Landscape Structures:

When placing an order, please select colors from those shown on pages 262-269 of the catalog.

Protective surfacing material must have a critical height value to meet the maximum fall height for the equipment and be accessible (ref. ASTM F3101).

SkyWays Shade by LSI:

SkyWays units are designed to meet Florida Building Code 6th Edition (2017). The high-density polyethylene fabric is flame retardant conforming to NFPA 701 and ASTM E84 per FBC 3105.3.1. Note that the fabric is to be removed by the owner should winds exceed 75MPH.

FOREVERLAWN - EXTREME:

- Site work by others. Site preparation **NOT INCLUDED** except as noted.
- Provides 8 FT fall height for fall zone.
- Product –Foreverlawn Playground Grass Extreme and all associated and required items (such as seaming tape, glue, etc).
- Installation – Performed by FOREVERLAWN of Florida, Inc. Composite nailer boards around the perimeter. #57 stone, spread and compacted. A 2" pad at Swing Area and a 1" Pad for the remainder will then be laid over the stone. The grass will then be laid over the pad, seamed and secured. A final layer of crumb rubber will be groomed in.
- Site clean up included.
- Documentation available upon request.

Installation:

Unless otherwise noted, the following items are to be **PROVIDED BY CUSTOMER** prior to installation:

- ALL Site work completed - excavation, removal and grading to proper level prior to installer arrival.
- Site security to prevent theft or vandalism of equipment.
- Water and 110 Electric.
- Underground Utilities Located and Marked prior to installation.
- Storage.
- Trash Dumpster to accommodate construction waste.
- Permitting
- Does not include soil density or concrete testing

THIS PROPOSAL DOES NOT INCLUDE PERMIT FEES ASSESSED BY THE BUILDING DEPT. Those fees will result in additional charges.

Installation Charges on this proposal are based on NO UNFORESEEN conditions in the area, above or below the surface. If unforeseen conditions arise, the installation charges will change to reflect additional costs associated with dealing with those circumstances. Examples of this include, but are not limited to: site not ready upon installer's arrival, underground utilities, or difficulties with footers due to coral rock or ground water in the holes.

The undersigned warrants that he/she is an authorized representative of the company noted and has the requisite authority to bind said company and/or principal. If any particular billing is not paid when due, all outstanding balances, regardless of prior terms, will become immediately due and owing upon demand. Interest on past due amounts will be assessed at 1 ½ % per month or the maximum interest rate permitted by applicable law, whichever is less. Should it become necessary for either party to this contract to institute legal action for enforcement of any provisions of this contract, the prevailing party shall be entitled to reimbursement for all court costs and reasonable attorney's fees incident to such legal action. The parties hereto agree that proper venue for any legal action in any way related to this contract shall be in Seminole County, FL.

Accepted By:

City of Hollywood

Company Name	Authorized By	Printed Name	Date
As Its: _____	(Title)		

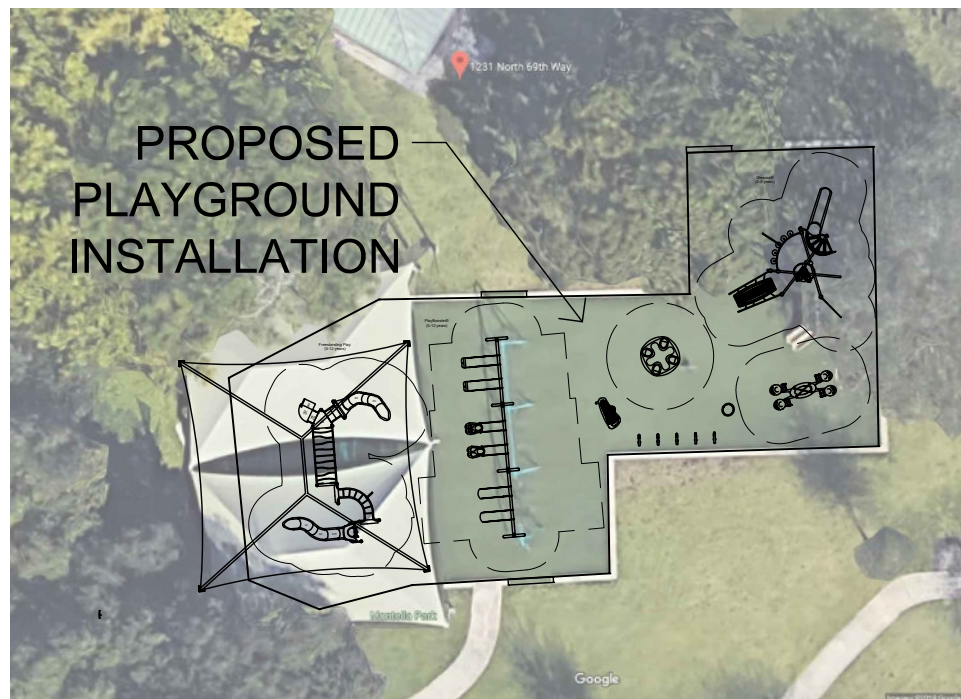

SITE LOCATION MAP

NOT TO SCALE
*SEE SHEET P-2 FOR
SITE LOCATION MAP
ENLARGEMENT

TOTAL PLAY COMPONENTS: 2-5 AGE AREA - 9
5-12 AGE AREA - 11

2-5 AGE AREA	
TOTAL ELEVATED PLAY COMPONENTS	0
TOTAL ELEVATED COMPONENTS ACCESSIBLE BY RAMP	0
TOTAL ELEVATED COMPONENTS ACCESSIBLE BY TRANSFER	0
TOTAL ACCESSIBLE GROUND LEVEL COMPONENTS SHOWN	9
TOTAL DIFFERENT TYPES OF GROUND LEVEL COMPONENTS	6

5-12 AGE AREA	
TOTAL ELEVATED PLAY COMPONENTS	2
TOTAL ELEVATED COMPONENTS ACCESSIBLE BY RAMP	0
TOTAL ELEVATED COMPONENTS ACCESSIBLE BY TRANSFER	2
TOTAL ACCESSIBLE GROUND LEVEL COMPONENTS SHOWN	6
TOTAL DIFFERENT TYPES OF GROUND LEVEL COMPONENTS	4

Playground equipment meets the requirements of FBC Accessibility Code, Table 240.2.1.2

8' LENGTH OF NEW
CONCRETE CURB,
TYP. (3),
LOCATIONS
APPROXIMATE

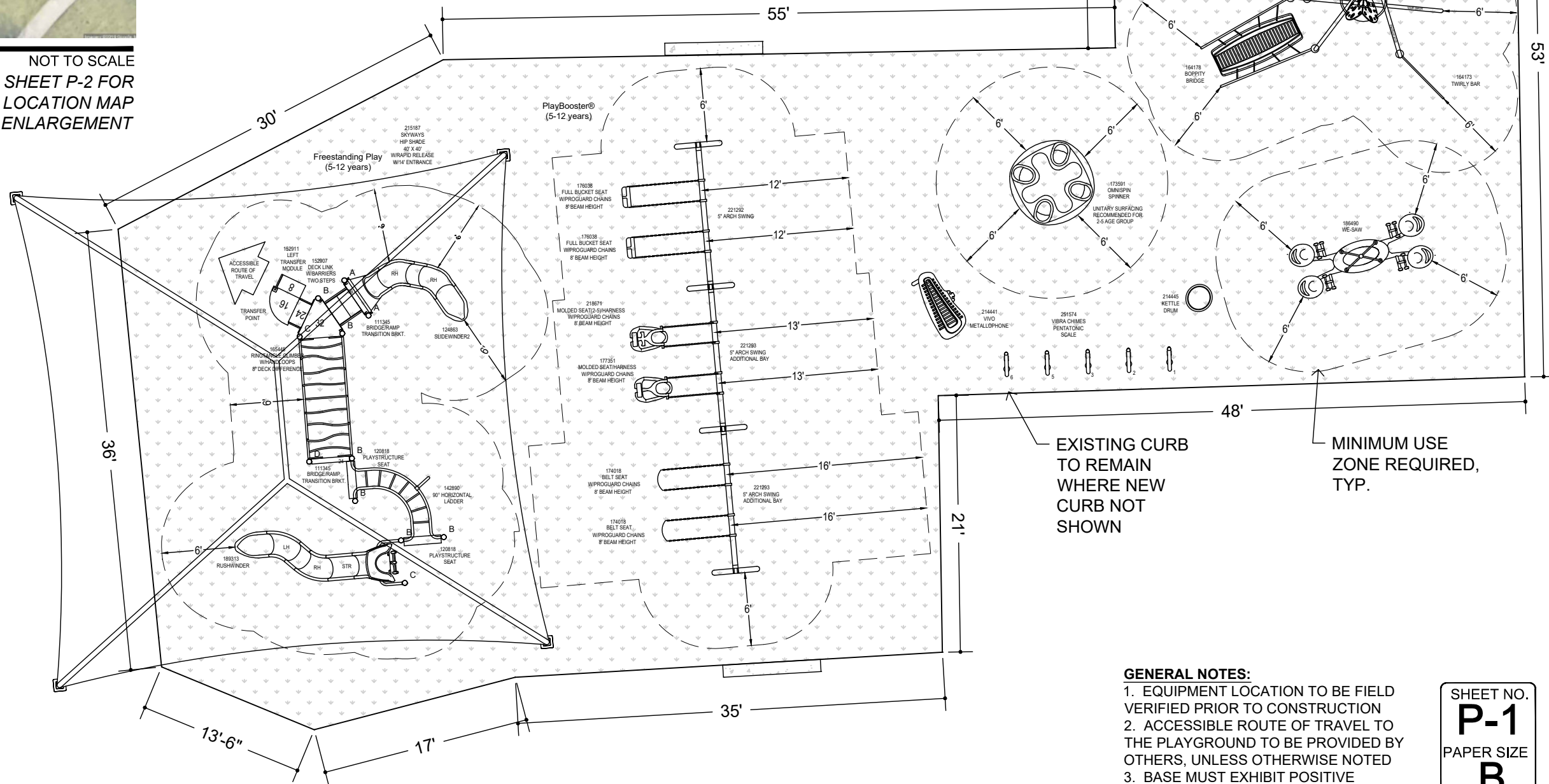

EXISTING CURB
TO REMAIN
WHERE NEW
CURB NOT
SHOWN

MINIMUM USE
ZONE REQUIRED,
TYP.

SURFACING
5350 SF
SYNTHETIC (PLAYGROUND) GRASS
8' MAXIMUM FALL HEIGHT
#57 STONE SUB-BASE

WARNING
SURFACING AND PLAYSURFACES MAY
BECOME HOT AND CAUSE BURNS. CHECK
FOR HOT SURFACES PRIOR TO PLAYING ON
THE PLAYGROUND.

QTY. POST/ARCH LENGTHS

- 2 A 132" Alum Post DB
- 6 B 116" Alum Post DB
- 2 C 108" Alum Post DB
- 1 D 100" Alum Post DB

182503
WELCOME SIGN
(LSI PROVIDED)
5-12 YEARS

WELCOME SIGN
TO BE LOCATED IN
CONSULTATION
WITH OWNER

GENERAL NOTES:
1. EQUIPMENT LOCATION TO BE FIELD
VERIFIED PRIOR TO CONSTRUCTION
2. ACCESSIBLE ROUTE OF TRAVEL TO
THE PLAYGROUND TO BE PROVIDED BY
OTHERS, UNLESS OTHERWISE NOTED
3. BASE MUST EXHIBIT POSITIVE
DRAINAGE IN ALL AREAS

NOT FOR CONSTRUCTION

SHEET NO.
P-1
PAPER SIZE
B

RSI PROJ: 16574
DRAWING: 16574-1-1

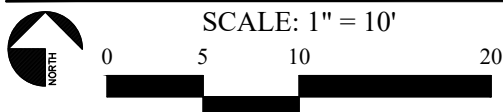

City of Hollywood- Montella Park (Phase II)

Hollywood, FL



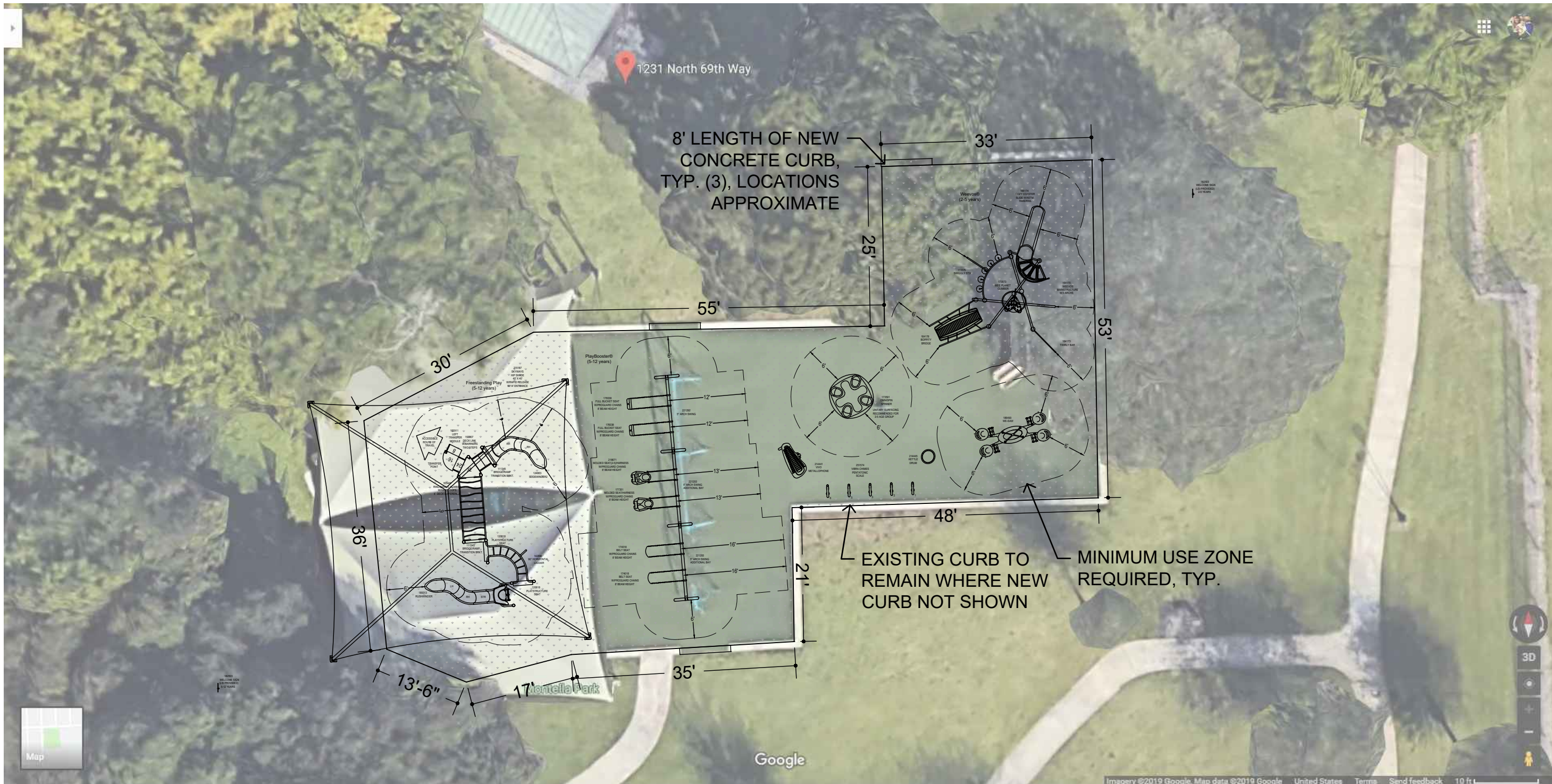

SURFACING

5350 SF
 SYNTHETIC (PLAYGROUND) GRASS
 8' MAXIMUM FALL HEIGHT
 #57 STONE SUB-BASE

GENERAL NOTES:

1. EQUIPMENT LOCATION TO BE FIELD VERIFIED PRIOR TO CONSTRUCTION
2. ACCESSIBLE ROUTE OF TRAVEL TO THE PLAYGROUND TO BE PROVIDED BY OTHERS
3. BASE MUST EXHIBIT POSITIVE DRAINAGE IN ALL AREAS

NOT FOR CONSTRUCTION

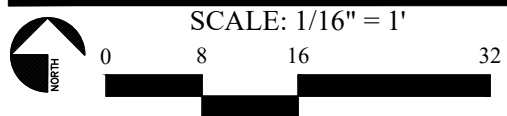

Site Location Map

City of Hollywood- Montella Park (Phase II)

Hollywood, FL

SHEET NO.
P-2
 PAPER SIZE
B

RSI PROJ: 16574
 DRAWING: 16574-1-1



City of Hollywood- Montella Park (phase II)

peacock_lagoon_sky FR shade-slate gray April 29, 2019 16574-1-1



*Custom products are shown as conceptual only. *Custom product manufacturing time for this project will be approximately 6 weeks from the time of LSI order acceptance.

©2019 Landscape Structures. All Rights Reserved.



FOR A BETTER TOMORROW
WE PLAY TODAY

shapedbyplay.com



Proudly presented by:

Debbie Levine



City of Hollywood- Montella Park (phase II)

peacock_lagoon_sky FR shade-slate gray

April 29, 2019

16574-1-1



*Custom products are shown as conceptual only. *Custom product manufacturing time for this project will be approximately 6 weeks from the time of LSI order acceptance.

©2019 Landscape Structures. All Rights Reserved.



FOR A BETTER TOMORROW
WE PLAY TODAY

shapedbyplay.com



Proudly presented by:

Debbie Levine



City of Hollywood- Montella Park (phase II)

peacock_lagoon_sky FR shade-slate gray April 29, 2019 16574-1-1



*Custom products are shown as conceptual only. *Custom product manufacturing time for this project will be approximately 6 weeks from the time of LSI order acceptance.

©2019 Landscape Structures. All Rights Reserved.



FOR A BETTER TOMORROW
WE PLAY TODAY

shapedbyplay.com



Proudly presented by:
Debbie Levine



City of Hollywood- Montella Park (phase II)

peacock_lagoon_sky FR shade-slate gray April 29, 2019 16574-1-1



*Custom products are shown as conceptual only. *Custom product manufacturing time for this project will be approximately 6 weeks from the time of LSI order acceptance.

©2019 Landscape Structures. All Rights Reserved.



FOR A BETTER TOMORROW
WE PLAY TODAY

shapedbyplay.com



Proudly presented by:
Debbie Levine



City of Hollywood- Montella Park (phase II)

peacock_lagoon_sky FR shade-slate gray April 29, 2019 16574-1-1



*Custom products are shown as conceptual only. *Custom product manufacturing time for this project will be approximately 6 weeks from the time of LSI order acceptance.

©2019 Landscape Structures. All Rights Reserved.



FOR A BETTER TOMORROW
WE PLAY TODAY

shapedbyplay.com



Proudly presented by:
Debbie Levine

