

SECTION No.(s): 86010500
S.R. No.(s): 5
PERMIT No: 2019-L-491-00015
COUNTY: Broward

**DISTRICT FOUR (4) AMENDMENT NUMBER ELEVEN (11) TO STATE OF FLORIDA
DEPARTMENT OF TRANSPORTATION LANDSCAPE INCLUSIVE
MEMORANDUM OF AGREEMENT**

THIS AMENDMENT Number Eleven (11) to the Agreement dated February 26, 2013 made and entered into this _____ day of _____ 20____ by and between the State of Florida Department of Transportation hereinafter called the DEPARTMENT and the **CITY OF HOLLYWOOD**, a municipal subdivision of the State of Florida, hereinafter called the AGENCY.

W I T N E S S E T H

WHEREAS, the parties entered into the Landscape Inclusive Maintenance of Agreement dated, February 26, 2013 for the purpose of maintaining the landscape improvements by the AGENCY on various roads including State Road 5; and,

WHEREAS, the DEPARTMENT and the AGENCY have agreed to add additional landscape to be installed by permit within the City of Hollywood on SR5/South Young Circle/ Federal Hwy US1 in accordance with the above referenced Agreement; and,

NOW THEREFORE, for and in consideration of mutual benefits that flow each to the other, the parties covenant and agree as follows:

1. The original Agreement dated February 26, 2013: The DEPARTMENT will allow an AGENCY to construct additional landscape improvements or to modify an improvement located as indicated in **Exhibit "A"**, SR5/South Young Circle/Federal Hwy US1 from SR5 (M.P. 0.128) to SR5 (M.P. 0.193), in accordance with the plans attached as **Exhibit "B"**.
2. The AGENCY shall agree to maintain the additional landscape improvements in the Agreement described above according to Section II of **Exhibit "E"** Maintenance Plan of the original agreement and as follows:

II. SPECIFIC PROJECT SITE MAINTENANCE REQUIREMENTS AND RECOMMENDATIONS:

Canopy Trees are intended to be maintained at mature height and spread.

Remove suckering growth from base and clear trunk areas of single and multi-trunked trees on a quarterly basis.

To maintain the intended appearance of all palms, apply the latest palm fertilizer recommended by the University of Florida IFAS Extension per the manufacturer's specifications.

To maintain the intended appearance of all shrubs or turf grass, apply the latest fertilizer recommended by the University of Florida IFAS Extension per the manufacturer's specifications.

Groundcover and shrub horizontal growth shall be maintained to prevent foliage from growing beyond the limits of the planting areas shown on the plan. Maintain a 4" setback from the foliage to the edge of curb, pavement, sidewalk and/or other hardscape improvements.

*Maintain the vertical height of:
Conocarpus erectus between 24" and 30", full to ground.*

Inspect groundcovers and shrubs on a monthly basis for maintaining full ground coverage.

Evaluate plant material on a monthly basis for pests, diseases, drought stress or general decline. If required, follow the integrated pest management program established by the Agency to ensure healthy plants.

Concrete pavers shall be inspected on a monthly basis for the aesthetic appearance and safety conditions. Address any issues identified by repairing or replacing those specific locations. To maintain the overall aesthetic appearance and safety of the concrete pavers they shall be cleaned on a twice-yearly basis to prevent mold, dirt, oil, and gum build up. Joints and cracks in concrete, patterned concrete or asphalt, concrete pavers, concrete curbs, expansion joints, catch basins, gutter areas, etc. shall be inspected on a monthly basis to keep those areas free of weeds.

Inspect the irrigation system performance on a monthly basis to ensure the system is providing 100% coverage, does not have sections of low pressure, heads and valves are clean and clear of debris and any damaged irrigation components (i.e., spray nozzles, spray heads, valve boxes, etc.) are repaired or replaced.

Except as modified by this Amendment, all terms and conditions of the original Agreement and all Amendments thereto shall remain in full force and effect.

LIST OF EXHIBITS

Exhibit A - Landscape Improvements and Maintenance Boundaries
Exhibit B - Landscape Improvement Plans

In Witness whereof, the parties hereto have executed with this Amendment effective the ____ day _____ year written and approved.

CITY OF HOLLYWOOD

By: _____
Chairperson/Mayor/City Manager

Attest: _____ (SEAL)
Clerk

Legal Review _____ Date _____

STATE OF FLORIDA
DEPARTMENT OF TRANSPORTATION

By: _____
Transportation Development Director

Attest: _____ (SEAL)
Executive Secretary

Legal Review _____ Date _____
_____ Office of the General Counsel

SECTION No.(s):	86010500
S.R. No.(s):	5
PERMIT No:	2019-L-491-00015
COUNTY:	Broward

EXHIBIT A

LANDSCAPE IMPROVEMENTS AND MAINTENANCE BOUNDARIES

I. INCLUSIVE LIMITS OF MAINTENANCE ON STATE ROAD 5

State Road 5 from Young Circle (North Side) MP 0.000 to
Young Circle (South Side) MP 0.248

II. PERMIT LANDSCAPE MAINTENANCE LIMITS:

SR5 (South Young Circle/Federal Hwy/US1) from SR5 (M.P. 0.128) to
SR5 (M.P. 0.193). See Attached Map.

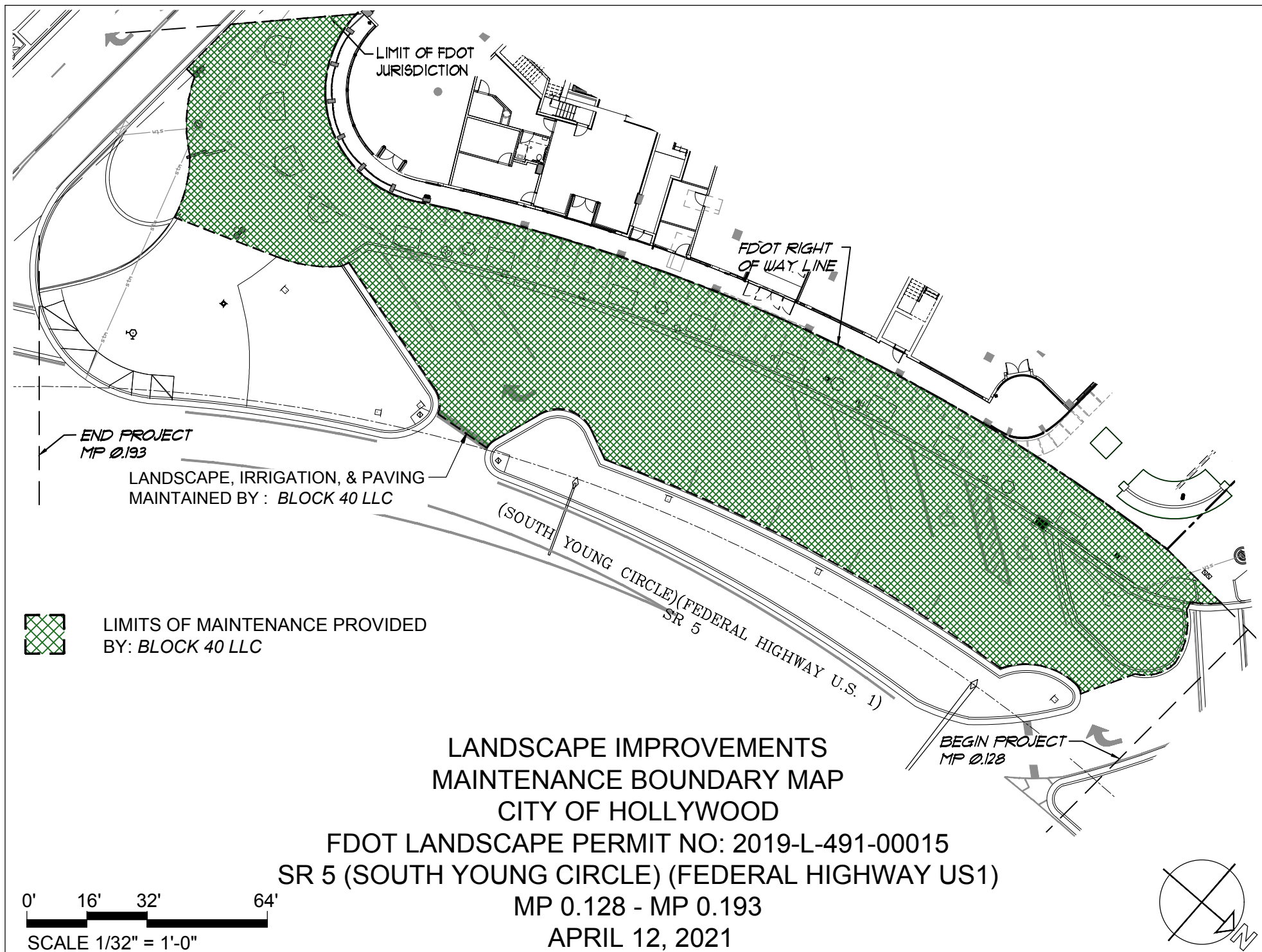

SECTION No.(s): 86010500
S.R. No.(s): 5
PERMIT No: 2019-L-491-00015
COUNTY: Broward

EXHIBIT B

LANDSCAPE IMPROVEMENT PLANS

The AGENCY agrees to install the landscape improvements in accordance with the plans and specifications attached hereto and incorporated herein.

Please see attached plans prepared by: Scott C. Heynen, RLA
Landscape Architecture and Land Planning

Dated: October 25, 2019 and
Revised 11/21/2019 and 2/18/2020

Sheets T-1
P-1
IR-1 to IR-3
L-1
LT-1

SITE SURVEY SYMBOL LEGEND

- ANCHOR
- BOLLARD
- CATCH BASIN
- CONCRETE POWER POLE
- CURB INLET
- DRAINAGE MANHOLE
- ELECTICAL JUNCTION BOX
- ELECTICAL METER
- ELECTICAL PULL BOX
- FIRE HYDRANT
- GARBAGE CAN (ROUND)
- UNKNOWN MANHOLE
- MONITORING WELL
- DECORATIVE LIGHT POLE
- GAS METER
- SANITARY SEWER MANHOLE
- DOUBLE DETECTOR CHECK VALVE
- SIGN
- LANDSCAPE LIGHTING
- TELEPHONE MANHOLE
- TRAFFIC CONTROL BOX
- TRAFFIC PULL BOX
- TRAFFIC POLE
- WATER GATE VALVE
- WATER METER
- STREET LIGHT (5 BULBS)
- PEDESTRIAN SIGNAL
- HANDICAP SPACE
- PARKING METER
- DOUBLE PARKING METER

SHEET : T-1 | SITE : EXISTING TREE DISPOSITION PLAN & SCHEDULE / NOTES, DETAILS & SPECS.

SHEET : P-1 | GROUND LEVEL 1 SITE : PLANTING PLAN

SHEET : IR-1 | LEVEL 1 NORTH : IRRIGATION PLAN

SHEET : IR-2 | LEVEL 1 SOUTH : IRRIGATION PLAN

SHEET : IR-3 | SITE : IRRIGATION SPECS., DETAILS

SHEET : L-1 | LEVEL 1 SITE : HARDSCAPE PLAN

SHEET : LT-1 | LEVEL 1 SITE : LIGHTING PLAN & SCHEDULE

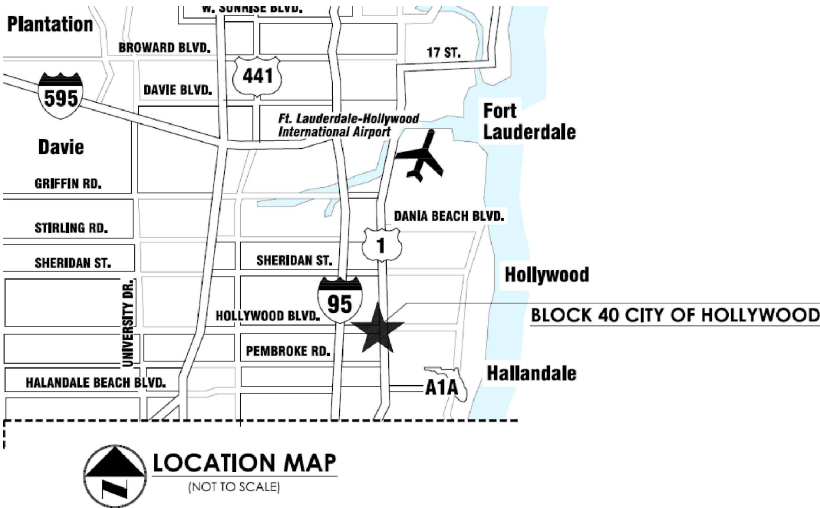

SR 5 POSTED SPEED LIMIT (Prior to entering the Circle) = 25 MPH
SR 5 : "DESIGN SPEED = 40 MPH

FDOT CURB SIDE PLANTING DETAIL (NTS)

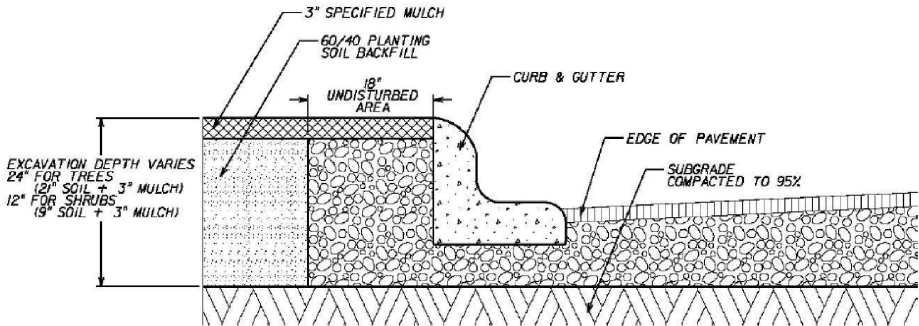

FDOT GENERAL NOTES

- "GOVERNING STANDARD PLANS: Florida Department of Transportation, FY 2019-20 Standard Plans for Road and Bridge Construction and applicable Interim Revisions (IRs)."
- "GOVERNING STANDARD SPECIFICATIONS: Florida Department of Transportation, FY 2019-20 Standard Specifications for Road and Bridge Construction."
- Contractor shall repair all damage done to the FDOT property during demolition, relocation &/or installation activities at his sole expense.
- n/a
- n/a
- "Architectural Pavers installation for sidewalks and/or driveways within the FDOT right of way shall comply with current FDOT Standard Specification 526. Online Reference: https://fdotwww.blob.core.windows.net/sitefinity/docs/default-source/programmanagement/implemented/specbooks/january2019/files/119ebook.pdf?sfvrsn=abd5f2d5_6"
- Ownership of all suitable excavated materials, as determined by the Department, shall remain in the Department until a final acceptance of the permitted project is fulfilled. Excavated materials shall be hauled by the Permittee, at their cost & expense from the site to the Broward Operations Center or stockpiled in those areas as directed by the Department, including asphalt millings.

FDOT PLANTING NOTES

- For the portion of landscape plant material that will be installed within the FDOT Right of Way, landscape installation shall comply with current applicable FDOT Maintenance Specification 580. Online Reference: <https://www.fdot.gov/programmanagement/Maintenance/2019Jan/default.shtm>
- For the portion of landscape plant material that will be installed within the FDOT Right of Way refer to the FDOT Standard Plans Index 580-001 Landscape Installation. Online Reference: https://fdotwww.blob.core.windows.net/sitefinity/docs/default-source/design/standardplans/2020/idx/580-001.pdf?sfvrsn=dc6bacf_2
- It is recommended that you verify the existing soil conditions of medians to be planted prior to finalizing your construction documents. If the existing sub-grade is compacted road base, it is recommended that you specify replacement with planting soil, as follows:
 - Contractor shall preserve a continuous band of undisturbed compacted sub-base 18" from the back of curb (See Detail below).
 - Contractor shall insure that all unsuitable soil including concrete, pavement, road base, stones over 3" diameter and all construction debris, is removed from median area to be planted and replaced with specified planting soil, e.g. 60% sand and 40% muck.
 - Areas to be planted with shrubs and/or ground covers: remove compacted soil to a depth of 12" and replace with specified planting soil. Planting soil shall come up to 4" from top of curb, reserving space for 3" compacted mulch and 1" clear from top of curb.
 - Planting pits for trees and palms: remove compacted soil within the area of each planting pit to a depth of 24" from the top of curb. Planting soil shall come up to 4" from top of curb, reserving space for 3" compacted mulch, and 1" clear from top of curb.
- Cypress Mulch is not permitted on the FDOT right of way. Mulch permitted to be used are Hardwood Mulch (containing no Cypress products), Recycled Mulch or approved equal, certified by the Mulch and Soil Council (MSC). Submit proof of certification to the FDOT District Operations Permit Landscape Inspector upon inspection.

10-25-2019 ISSUED FOR FDOT LANDSCAPE PERMIT # 2019-L-491-00015



SCOTT C. HEYNEN, RLA LLC
LANDSCAPE ARCHITECTURE AND LAND PLANNING

1627 Funston St., Hollywood, FL
PHONE 954-920-4945 quest2@comcast.net

BLOCK 40
1858 HOLLYWOOD BLVD., HOLLYWOOD, FL
FDOT : LANDSCAPE PERMIT COVER

"THE OFFICIAL RECORD OF THIS SHEET IS THE ELECTRONIC FILE DIGITALLY SIGNED AND SEALED UNDER RULE 61G1-16.005, F.A.C."

1ST REVIEW 11/21/19
NO. REVISION DATE
DATE: 25 OCT. 2019
DRAWN BY: SCH

C COPYRIGHT
SCOTT C. HEYNEN, RLA

SHEET

COVER

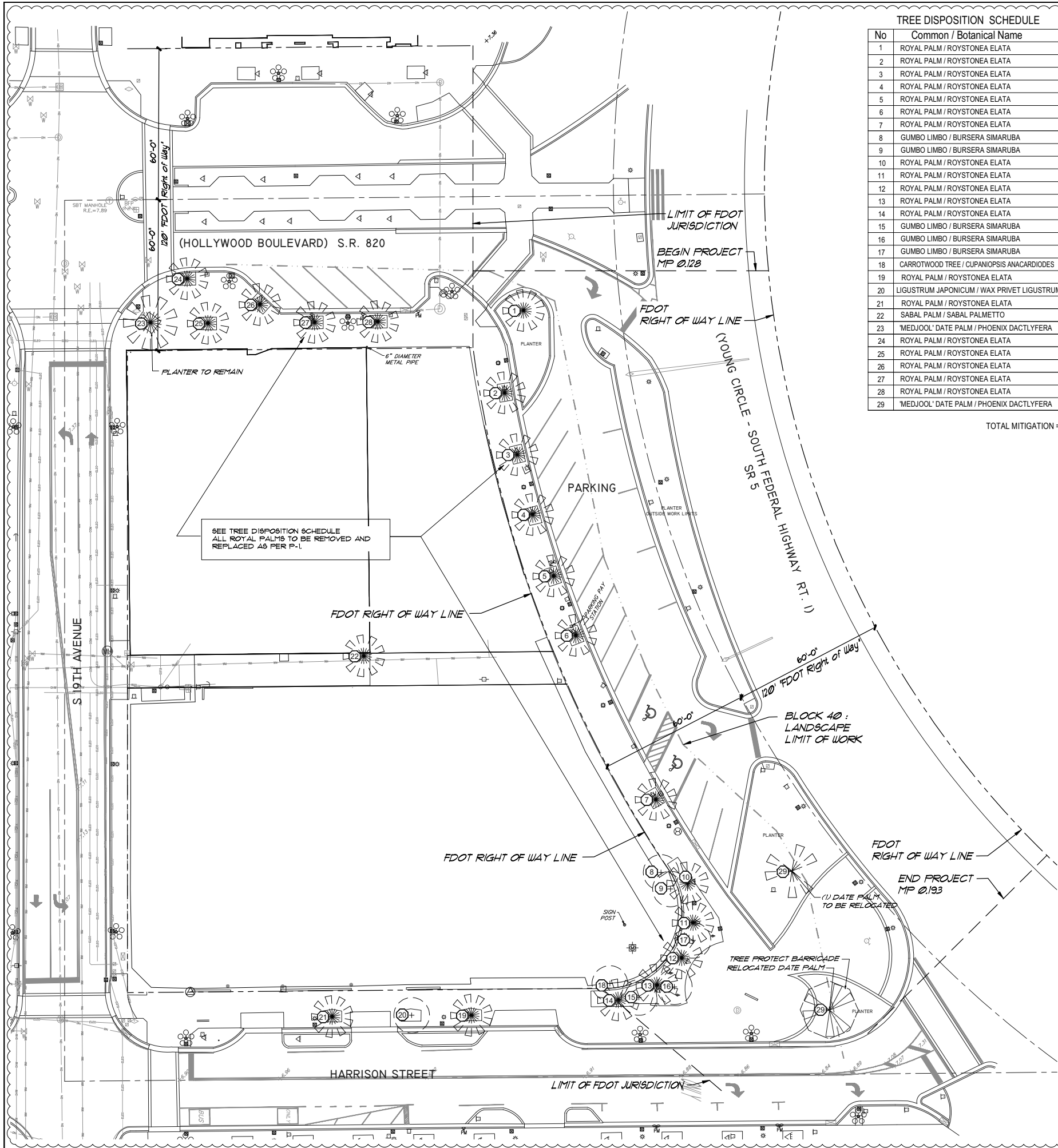

TREE DISPOSITION SCHEDULE						
No	Common / Botanical Name	Cal. / DBH"	GW or CT	Spread	Disposition	Condition #
1	ROYAL PALM / ROYSTONEA ELATA	25"	26.5'	20'	REMOVE	100
2	ROYAL PALM / ROYSTONEA ELATA	24"	31.5'	15'	REMOVE	60
3	ROYAL PALM / ROYSTONEA ELATA	17"	27.5'	15'	REMOVE	50
4	ROYAL PALM / ROYSTONEA ELATA	19"	23.5'	18'	REMOVE	60
5	ROYAL PALM / ROYSTONEA ELATA	22"	27.5'	15'	REMOVE	50
6	ROYAL PALM / ROYSTONEA ELATA	23"	23'	18'	REMOVE	70
7	ROYAL PALM / ROYSTONEA ELATA	19"	23'	18'	REMOVE	60
8	GUMBO LIMBO / BURSERIA SIMARUBA	4"	5'	12'	REMOVE	60
9	GUMBO LIMBO / BURSERIA SIMARUBA	4"	5'	14'	REMOVE	60
10	ROYAL PALM / ROYSTONEA ELATA	27"	29'	25'	REMOVE	100
11	ROYAL PALM / ROYSTONEA ELATA	27"	31'	25'	REMOVE	100
12	ROYAL PALM / ROYSTONEA ELATA	28"	28'	25'	REMOVE	90
13	ROYAL PALM / ROYSTONEA ELATA	27"	26'	26'	REMOVE	100
14	ROYAL PALM / ROYSTONEA ELATA	25"	25'	23'	REMOVE	100
15	GUMBO LIMBO / BURSERIA SIMARUBA	3"	4'	12'	REMOVE	60
16	GUMBO LIMBO / BURSERIA SIMARUBA	3"	6'	10'	REMOVE	60
17	GUMBO LIMBO / BURSERIA SIMARUBA	3"	5'	12'	REMOVE	60
18	CARROTWOOD TREE / CUPANIOPSIS ANACARDIODES	n/a	10'	12'	REMOVE	N/A
19	ROYAL PALM / ROYSTONEA ELATA	24"	22'	19'	REMOVE	80
20	LIGUSTRUM JAPONICUM / WAX PRIVET LIGUSTRUM	9" MULTI	8'	12'	REMOVE	80
21	ROYAL PALM / ROYSTONEA ELATA	26"	22'	15'	REMOVE	70
22	SABAL PALM / SABAL PALMETTO	14"	6'	12'	REMOVE	70
23	'MEDJOL' DATE PALM / PHOENIX DACTLYFERA	18"	20'	25'	REMOVE	100
24	ROYAL PALM / ROYSTONEA ELATA	16"	25'	18'	REMOVE	60
25	ROYAL PALM / ROYSTONEA ELATA	24"	26'	12'	REMOVE	20
26	ROYAL PALM / ROYSTONEA ELATA	22"	26'	12'	REMOVE	20
27	ROYAL PALM / ROYSTONEA ELATA	22"	24'	18'	REMOVE	70
28	ROYAL PALM / ROYSTONEA ELATA	23"	27'	17'	REMOVE	70
29	'MEDJOL' DATE PALM / PHOENIX DACTLYFERA	20"	16'	26'	RELOCATE	90

TOTAL MITIGATION = 21 (1/1) PALMS (MONOCOTS)
6 TREES (DICOTS) = 26" DBH

LEGEND

PALM TO REMAIN = 0

PALM TO REMOVE = 21

PALM TO RELOCATE = 1

TREE TO REMOVE = 7

TREE PROTECT BARRICADE = 1

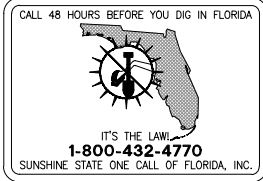

TREE PROTECTION BARRICADE
"For the Tree Protection Barricade that will be installed within the FDOT right of way refer to Standard Plans Index 110-100 Tree Protection and Preservation."

SCALE 1/16"= 1'-0"

SCOTT C. HEYNEN, RLA LLC
LANDSCAPE ARCHITECTURE AND LAND PLANNING
1627 Funston St., Hollywood, FL
PHONE 954-920-4945 scotchland@gmail.com

BLOCK 40
1858 HOLLYWOOD BLVD., HOLLYWOOD, FL
SITE EXISTING TREE DISPOSITION PLAN & SCHEDULE / NOTES, DETAILS & SPECS.

2nd REVIEW 2/18/20
1ST REVIEW 11/21/19
NO. REVISION DATE
DATE: 25 OCT. 2019
DRAWN BY: SCH
COPYRIGHT
SCOTT C. HEYNEN, RLA
SHEET
T-1

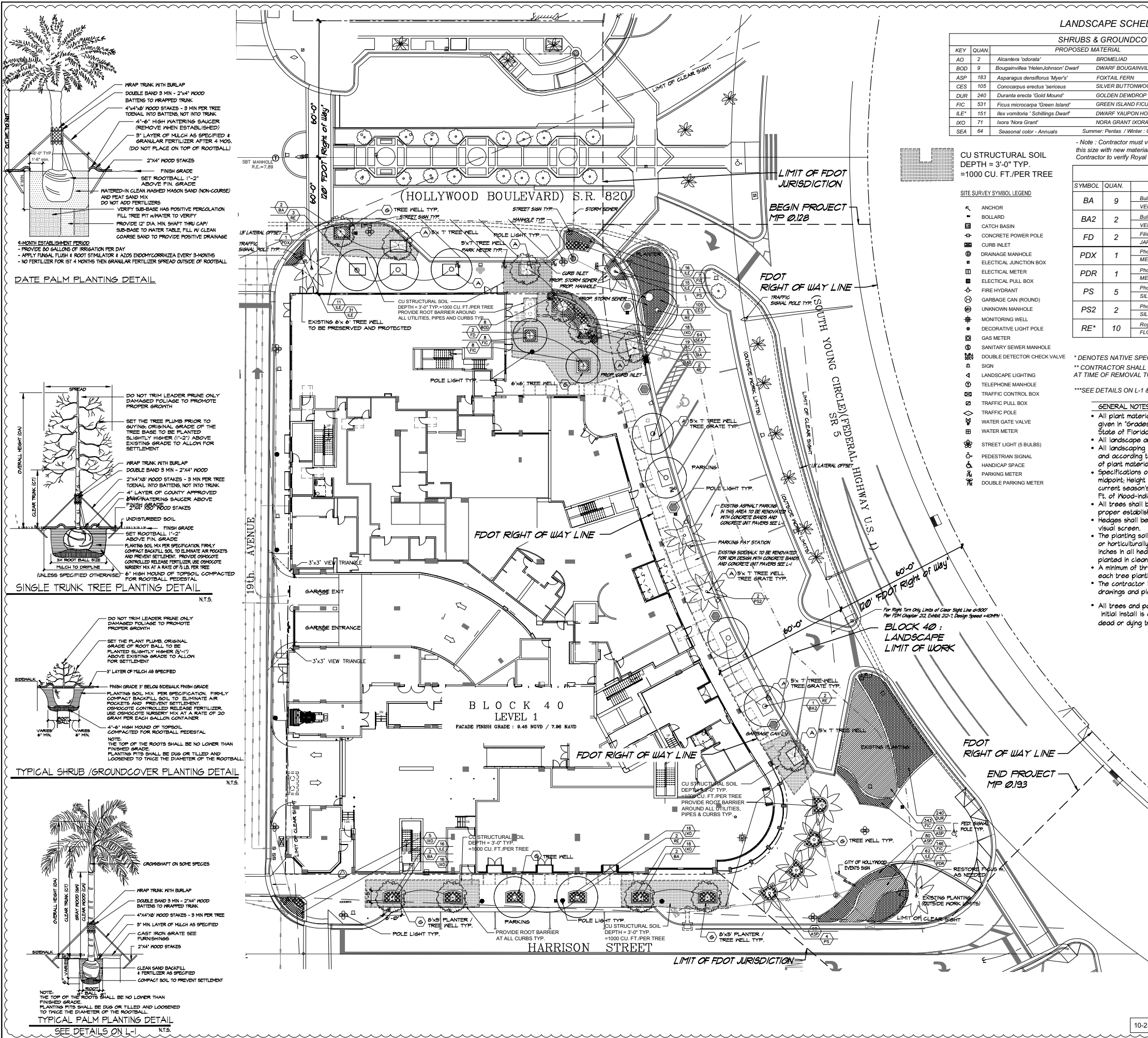

LANDSCAPE SCHEDULE			
SHRUBS & GROUNDCOVERS			
KEY	QUAN.	PROPOSED MATERIAL	DESCRIPTION / SPACING
AO	2	Alcantara 'odorata'	BROMELIAD 30" HT. x 30" SPR. / 7 GAL.
BOD	9	Bougainvillea 'Helen Johnson' Dwarf	DWARF BOUGAINVILLEA 4" HT. x 4" SPR. / 15 GAL. / FULL
ASP	183	Asparagus densiflorus 'Myer's'	FOXTAIL FERN 18" HT. x 18" SPR. / 3 GAL. / FULL / 18" O.C.
CES	105	Conocarpus erectus 'sericeus'	SILVER BUTTWOOD 18" HT. x 20" SPR. / 3 GALLONS / 24" O.C.
DUR	240	Duranta erecta 'Gold Mound'	GOLDEN DEWDROP 15" HT. x 15" SPR. / 3 GALLONS / 18" O.C.
FIC	531	Ficus microcarpa 'Green Island'	GREEN ISLAND FIGUS 15" HT. x 15" SPR. / 3 GALLONS / 18" O.C.
ILE	151	Ilex vomitoria 'Schilling's Dwarf'	DWARF YAUPOH HOLLY 18" HT. x 18" SPR. / 3 GALLONS / 24" O.C.
IXO	71	Ixora 'Nora Grant'	NORA GRANT IXORA 18" HT. x 20" SPR. / 3 GALLONS / 24" O.C.
SEA	64	Seasonal color - Annuals	Summer: Pentas / Winter: Cleome 4" POTS @ 12" O.C.

CU STRUCTURAL SOIL
DEPTH = 3'-0" TYP.
=1000 CU. FT./PER TREE

SITE SURVEY SYMBOL LEGEND

- ANCHOR
- BOLLARD
- CATCH BASIN
- CONCRETE POWER POLE
- CURB INLET
- DRAINAGE MANHOLE
- ELECTRICAL JUNCTION BOX
- ELECTRICAL METER
- ELECTRICAL PULL BOX
- FIRE HYDRANT
- GARBAGE CAN (ROUND)
- UNKNOWN MANHOLE
- MONITORING WELL
- DECORATIVE LIGHT POLE
- GAS METER
- SANITARY SEWER MANHOLE
- DOUBLE DETECTOR CHECK VALVE
- SIGN
- LANDSCAPE LIGHTING
- TELEPHONE MANHOLE
- TRAFFIC CONTROL BOX
- TRAFFIC PULL BOX
- TRAFFIC POLE
- WATER GATE VALVE
- WATER METER
- STREET LIGHT (5 BULBS)
- PEDESTRIAN SIGNAL
- HANDICAP SPACE
- PARKING METER
- DOUBLE PARKING METER

Note: Contractor must verify height and caliper of existing Royal Palm trunks before removal and match this size with new material. City Landscape Architect to approve new Royal Palms before installation, and Contractor to verify Royal & Date Palms will fit correctly into Tree Gate openings. (27" Diameter)

TREES & PALMS			
SYMBOL	QUAN.	PROPOSED MATERIAL	DESCRIPTION
BA	9	Bulnesia arborea	16" HT. X 8" SPR. X 6" C.T., 4" DBH
BA2	2	VERAWOOD	F.G.
FD	2	Bulnesia arborea	16" HT. X 8" SPR. X 6" C.T., 4" DBH
PDX	1	VERAWOOD	F.G.
PDR	1	Filicium decipiens	16" HT. X 8" SPR. X 6" C.T. 3" DBH
PS	5	Phoenix dactylifera 'Medjool'	20" C.T. TO THE NUT
PS2	2	MEDJOO DATE PALM	ELECTRICAL
RE*	10	Phoenix dactylifera 'Medjool'	'RELOCATED' 16" C.T. TO THE NUT
		MEDJOO DATE PALM	RELOCATED EXISTING - SEE T-1
		Phoenix sylvestris 'Robusta' Matched	14" C.T. MATCHED
		SILVER DATE PALM	F.G.
		Phoenix sylvestris 'Robusta' Matched	18" C.T. MATCHED
		SILVER DATE PALM	F.G.
		Roystonea elata	DETERMINED 9/11/19 SEE T-1
		FLORIDA ROYAL PALM	*27" G.W. 22"-25" CAL. MIN. F.G. 27" DBH EXISTING

* DENOTES NATIVE SPECIES
** CONTRACTOR SHALL DETERMINE GW HEIGHTS OF EXISTING PALMS AT TIME OF REMOVAL TO DETERMINE THE PROPOSED SIZES, SEE SHEET T-1
***SEE DETAILS ON L-1 & LD-1 FOR PLANTING DEPTH

- GENERAL NOTES
- All plant materials shall conform to the standards for Florida No. 1 or better as given in 'Grades and Standards for Nursery Plants', 5th Edition, 2015, State of Florida Department of Agriculture, Tallahassee, or thereto.
 - All landscape areas to be provided with a 100% automatic irrigation system.
 - All landscaping and irrigation shall be installed in a sound workmanlike manner and according to accepted and proper planting procedures with the quality of plant materials described.
 - Specifications of plant materials as follows: Spread-indicates average spread to midpoint; Height (o.a.)-indicates overall height from top of root ball to midpoint of current season's growth; C.T.-indicates clear trunk measurement to first branching; Ft. of Mould-indicates measurement on palms from top of ball to top of stalks.
 - All trees shall be properly guyed and staked at the time of planting to ensure proper establishment.
 - Hedges shall be planted and maintained so as to form a continuous, unbroken, solid visual screen.
 - The planting soil for all planting areas shall be composed of a minimum of 30% muck or horticulturally acceptable organic material. The minimum soil depth shall be NINE inches in all hedge and mass planting beds and 1/2 cu. yd. per tree. Palms to be planted in clean sand.
 - A minimum of three inches of shredded PINE BARK mulch shall be installed around each tree planting, including palm trees, and throughout hedge and shrub plantings.
 - The contractor is responsible for his own quantity count. Any discrepancy between drawings and plant list shall be considered as correct on the drawings.
 - All trees and palms will be provided with a minimum 1 year warranty period after initial install is completed. Including any maintenance and replacement of any dead or dying trees or plant material proposed as part of the landscape plan.

NOTES:
All landscape areas to receive 100% coverage with 50% overlap by an automatic irrigation system with a moisture sensor / rain gauge shut-off. Over-spray is prohibited onto the roadway or sidewalk. Irrigation shall be maintained continuously in a sound workmanlike manner.
No trees shall be planted within 5' of a water main, water service or a sanitary lateral. Provide root barrier for trees that are planted within 6' of drainage pipe.
Plant material in planters with palms, shall not be planted within the root ball zone of the palm. A clear zone around rootball shall remain undisturbed.

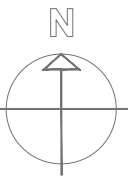

SCALE 1/16" = 1'-0"

SCOTT C. HEYENEN, RLA LLC
LANDSCAPE ARCHITECTURE AND LAND PLANNING
1627 Funston St., Hollywood, FL
PHONE 954-920-4945 Scottclan@gmail.com

BLOCK 40
1858 HOLLYWOOD BLVD., HOLLYWOOD, FL
GROUND LEVEL 1

PLANTING PLAN

1ST REVIEW 11/21/19
NO. REVISION DATE
DATE: 25 OCT. 2019
DRAWN BY: SCH

C COPYRIGHT
SCOTT C. HEYENEN, RLA
SHEET

P-1

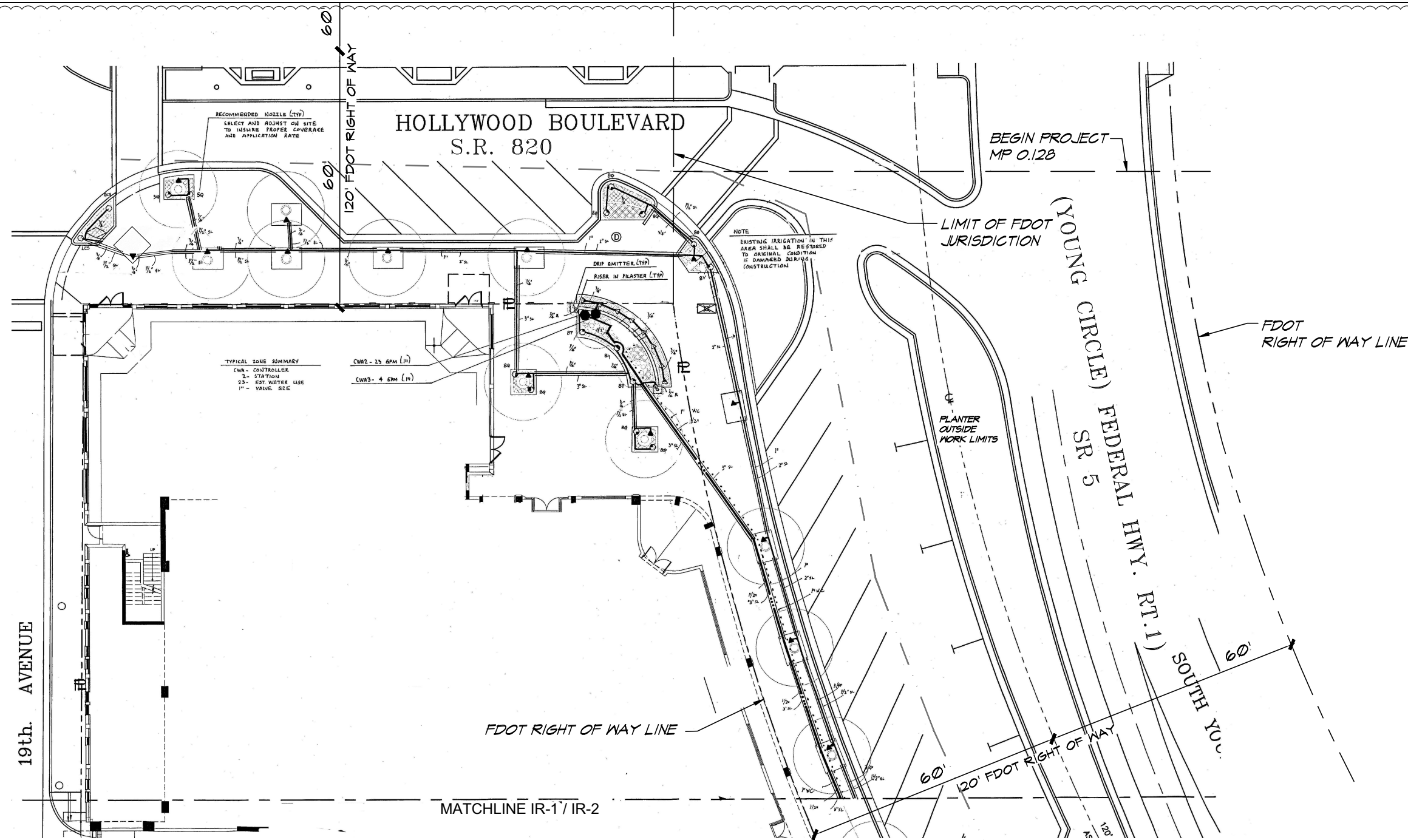

TYPICAL ZONE SUMMARY
CWA - CONTROLLER
1" - STATION
23" - EST. WATER USE
1" - VALVE SIZE

CWA2 - 23 GPM (1")
CWA3 - 4 GPM (1")

NOTE
EXISTING IRRIGATION IN THIS
AREA SHALL BE RESTORED
TO ORIGINAL CONDITION
IF DAMAGED DURING
CONSTRUCTION

BEGIN PROJECT
MP 0.128

LIMIT OF FDOT
JURISDICTION

PLANTER
OUTSIDE
WORK LIMITS

FDOT
RIGHT OF WAY LINE

FDOT RIGHT OF WAY LINE

MATCHLINE IR-1/IR-2

BLOCK 40 :
LANDSCAPE
LIMIT OF WORK

LEGEND (LEVEL 1)			
SYMBOL	MODEL NO.	DESCRIPTION	* EST. QUANTITY
▲	1404	RAIN BIRD FLOOD BUBBLER	29
▲	PA-8S-50-B	RAIN BIRD STREAM BUBBLER	02
▲	PA-8S-5-CST-B	RAIN BIRD STREAM BUBBLER	06
●	1812-PRS-5Q	RAIN BIRD 12" POP-UP SPRAY	20
●	1812-PRS-8V	RAIN BIRD 12" POP-UP SPRAY	01
●	1812-PRS-8D	RAIN BIRD 12" POP-UP SPRAY	08
●	1812-PRS-8T	RAIN BIRD 12" POP-UP SPRAY	02
●	1812-PRS-8H	RAIN BIRD 12" POP-UP SPRAY	01
●	1812-PRS-10V	RAIN BIRD 12" POP-UP SPRAY	06
●	1812-PRS-10Q	RAIN BIRD 12" POP-UP SPRAY	01
●	1812-PRS-10T	RAIN BIRD 12" POP-UP SPRAY	01
●	1812-PRS-10H	RAIN BIRD 12" POP-UP SPRAY	05
●	1812-PRS-10F	RAIN BIRD 12" POP-UP SPRAY	02
●	1812-PRS-15RCS	RAIN BIRD 12" POP-UP SPRAY	01
●	1812-PRS-15LCS	RAIN BIRD 12" POP-UP SPRAY	01
●	1812-PRS-12Q	RAIN BIRD 12" POP-UP SPRAY	01
●	1812-PRS-12T	RAIN BIRD 12" POP-UP SPRAY	02
●	100 PEB	RAIN BIRD 1" SOLENOID VALVE	03
□	ESP-4ME	RAIN BIRD AUTOMATIC CONTROLLER	01
⊕	RSD-BEX	RAIN BIRD RAIN SENSOR	01
△	765(1 1/2")	FEBCO BACKFLOW PREVENTER	01
NOT SHOWN	#14AWG	PAIGE THHN WIRE	AS REQUIRED
NOT SHOWN		SCH 40 GALVANIZED STEEL	AS REQUIRED
NOT SHOWN		SCH 40 PVC	AS REQUIRED
NOT SHOWN		MAIN LINE	
NOT SHOWN		LATERALS	
NOT SHOWN		SLEEVES	
NOT SHOWN		SPRINKLERS RISERS	
NOT SHOWN		PVC FITTINGS	
NOT SHOWN		WIRE CONDUIT	
NOT SHOWN		GATE VALVE (TO LINE SIZE)	01
NOT SHOWN		VALVE BOX	04
NOT SHOWN		GROUNDING LOCATION	01
NOT SHOWN		CITY WATER METER	01

NOTE: ABOVE QUANTITIES ARE FOR COMPARISON ONLY. CONTRACTOR
SHALL VERIFY PRIOR TO SUBMITTING BID.

ZONE SUMMARY CHART

(CONTROLLER CWA)		VALVE	SPRINKLER TYPE	VALVE SIZE	WATER DEMAND	RUN TIME	WEEKLY USAGE
STA							
1	CWA1	SPRAY	1"	27 GPM	40 MIN/WK	1,080 GAL/WK	
2	CWA2	SPRAY	1"	23 GPM	40 MIN/WK	920 GAL/WK	
3	CWA3	BUBBLER	1"	04 GPM	40 MIN/WK	160 GAL/WK	
4	SPARE						
*TO APPLY 1.0 IN/WK.						120 MIN/WK	2,160 GAL/WK

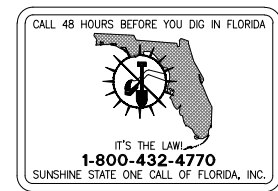

SCALE 1" = 10'-0"

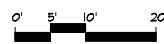

10-25-2019 ISSUED FOR FDOT LANDSCAPE PERMIT # 2019-L-491-00015



Kenneth DiDonato, P.E.
CONSULTING ENGINEER
GOLF COURSE & COMMERCIAL IRRIGATION DESIGN
2210 HOLLYWOOD BLVD., HOLLYWOOD, FLORIDA 33020
(954) 987-3333
Kenneth DiDonato
P.E. Lic. #23892

BLOCK 40
1858 HOLLYWOOD BLVD., HOLLYWOOD, FL
LEVEL 1 - NORTH
IRRIGATION PLAN & LEGEND

1ST REVIEW 11/21/19
NO. REVISION DATE
DATE: 25 OCT. 2019
DRAWN BY: SCH

C COPYRIGHT
SCOTT C. HEYENEN, RLA
SHEET

IR-1

IRRIGATION NOTES & SPECIFICATIONS

AUTOMATIC IRRIGATION SYSTEM
WATER DEMAND / ZONE
WATER SOURCE
PRESSURE REQUIRED

REFER TO PLAN
CITY WATER
50 PSI (SITE LEVEL)

GENERAL

IRRIGATION SHALL BE INSTALLED IN ACCORDANCE WITH LOCAL CODES, CONTRACT DRAWINGS, CONTRACT SPECIFICATIONS, AND APPENDIX "F" OF THE FLORIDA BUILDING CODE.

IRRIGATION DESIGN BASED ON "PLANTING PLAN" DATED MAY 2016. CONTRACTOR SHALL REFER TO THIS PLAN TO COORDINATE SPRINKLER LOCATIONS AND PIPE ROUTING WITH NEW AND EXISTING PLANT LOCATIONS.

THIS PLAN SHALL BE USED AS A GUIDE ONLY. IRRIGATION SHALL BE INSTALLED TO MATCH ON SITE CONDITIONS AND TO OVERCOME THE INHERENT INACCURACIES THAT RESULT WHEN DESIGNING FROM BASE PLANS SCALED AT 1" = 10'.

THIS SITE SHALL BE IRRIGATED WITH THREE INDEPENDENT SYSTEMS. THE WATER SOURCE FOR THE SITE SYSTEM SHALL BE A 1" CITY WATER METER. THE SOURCE FOR EACH OF THE ELEVATED DECK SYSTEMS SHALL BE A DOMESTIC WATER LINE.

BACKFLOW PREVENTION SHALL BE INSTALLED TO MEET CODE REQUIREMENTS FOR CROSS CONNECTION CONTROL. A PRESSURE VACUUM BREAKER HAS BEEN SPECIFIED PER SYSTEM. CONTRACTOR SHALL VERIFY EACH PREVENTER IS TO LOCAL CODES.

THIS IRRIGATION HAS BEEN DESIGNED AS A TYPICAL BLOCK VALVE TYPE USING NETAFIM DRIP EQUIPMENT AND RAIN BIRD SPRINKLERS. IN-LINE VALVES AND CONTROL SYSTEM. RAIN SENSORS SHALL BE INSTALLED TO CONSERVE WATER.

IRRIGATION SHALL BE INSTALLED AND MAINTAINED TO MINIMIZE UNDESIRABLE OVERTHROW ONTO PAVEMENT, SIDEWALKS, AND BUILDINGS.

CONTRACTOR SHALL VISIT THE SITE TO BECOME FAMILIAR WITH SITE CONDITIONS, AND SHALL REFER TO THE PLANS FOR ADDITIONAL INFORMATION.

TO ENSURE PROPER OPERATION, SOURCE SIZES, PRESSURES REQUIRED, VALVE SIZES, ZONE CAPACITIES, SPRINKLER AND DRIPPERLINE SPACING, PIPE AND WIRE SIZES, AND INSTALLATION NOTES AND DETAILS SHALL BE FOLLOWED AS SHOWN.

PIPING

PIPE ROUTING IS SCHEMATIC ONLY AND SHALL BE ADJUSTED FOR ON SITE CONDITIONS.

PIPE SHALL BE INSTALLED IN ACCORDANCE WITH LOCAL CODES, SECTION "F" OF THE FLORIDA BUILDING CODE, AND PIPE MANUFACTURER'S INSTRUCTIONS.

PIPE ROUTED UNDER HARDSCAPED AREAS SHALL BE SLEEVED IN SCH 40 PVC. EACH SLEEVE SHALL BE (1) BURIED TO A MINIMUM DEPTH OF 24", (2) TWO PIPE SIZES LARGER THAN CARRIER PIPE, AND (3) EXTENDED 3' BEYOND HARDSCAPED AREA ON EACH END. CONTRACTOR SHALL VERIFY THE LOCATION OF EXISTING SLEEVES.

PIPE INSTALLED ABOVE GRADE AT EACH BACKFLOW PREVENTER SHALL BE SCH 40 GALVANIZED STEEL. ALL OTHER PIPE AND FITTINGS SHALL BE SCH 40 TYPE 1120 PVC.

PIPE SIZED TO LIMIT FLOW VELOCITIES TO 5 FEET/SECOND AND TO LIMIT FRICTION LOSS IN THE PIPING NETWORK.

PIPE SHALL BE INSTALLED AT SUFFICIENT DEPTH BELOW GROUND TO PROTECT IT FROM HAZARD SUCH AS VEHICULAR TRAFFIC OR ROUTINE OCCURRENCES WHICH OCCUR IN THE NORMAL USE AND MAINTENANCE OF THE PROPERTY. DEPTHS OF COVER SHALL MEET OR EXCEED SCS CODE 430-00. REFER TO THE APPLICABLE DETAIL FOR ADDITIONAL INFORMATION.

BACKFILL SHALL BE OF SUITABLE MATERIAL, FREE OF ROCKS, STONES, AND OTHER DEBRIS THAT WOULD DAMAGE IRRIGATION SYSTEM COMPONENTS.

GATE AND BALL VALVES SHALL BE INSTALLED FOR ISOLATION. EACH VALVE SHALL BE TO LINE SIZE AND INSTALLED IN A VALVE BOX. POROUS MATERIAL SHALL BE INSTALLED PER BOX TO PROMOTE DRAINAGE.

EACH BACKFLOW PREVENTER SHALL BE INSTALLED IN ACCORDANCE WITH LOCAL CODES AND SHALL BE LOCATED TO BE CONCEALED FROM VIEW.

PIPE HUNG FROM SLAB IN THE PARKING GARAGE AT THE 8TH LEVEL AND IN THE INTERSTITIAL SPACE ON THE 20TH LEVEL SHALL BE INSTALLED IN ACCORDANCE WITH THE APPLICABLE SECTION OF THE MECHANICAL SPECIFICATIONS. ROUTING OF PIPE, WHICH IS SCHEMATIC ONLY, SHALL BE VERIFIED ON SITE. CONTRACTOR SHALL VERIFY THAT INSTALLING SCH 40 PVC IN THE GARAGE AND IN THE INTERSTITIAL SPACE IS TO LOCAL CODES.

PIPE RISERS SHALL BE INSTALLED IN ACCORDANCE WITH THE APPLICABLE SECTION OF THE MECHANICAL SPECIFICATIONS. THE LOCATION OF EACH RISER SHALL BE VERIFIED ON SITE. CONTRACTOR SHALL VERIFY THAT INSTALLING SCH 40 PVC RISERS IN THE GARAGE AND INTERSTITIAL SPACE IS TO LOCAL CODES.

EACH PUNCTURE THROUGH SLAB SHALL BE WATERPROOFED IN ACCORDANCE WITH THE APPLICABLE SECTION OF THE MECHANICAL SPECIFICATIONS.

SPRINKLERS

SPRINKLER LOCATIONS ARE SCHEMATIC ONLY AND SHALL BE ADJUSTED FOR LANDSCAPING, FENCES, SITE LIGHTING, PREVAILING WIND, MOUNDING, ETC., TO ENSURE PROPER COVERAGE WITH MINIMAL UNDESIRABLE OVERTHROW. A PRIME OBJECTIVE SHALL BE TO ELIMINATE OVERTHROW ONTO PAVEMENT, SIDEWALKS, AND THE BUILDING.

SPRAY HEADS SHALL BE RAIN BIRD 1800 SERIES, SIX INCH POP-UP TYPE SHALL BE INSTALLED IN AREAS LANDSCAPED WITH SOD AND MULCH, TWELVE INCH POP-UP TYPE SHALL BE INSTALLED IN AREAS LANDSCAPED WITH GROUND COVER AND LOW SHRUBS. SHRUB HEADS SHALL BE INSTALLED IN AREAS LANDSCAPED WITH TALL SHRUBS, AND BUBBLERS SHALL BE INSTALLED IN NARROW LANDSCAPED AREAS AND AT PALMS.

POP-UP TYPE LOCATED IN SOD, MULCH, AND GROUND COVERS SHALL BE INSTALLED ON FLEXIBLE SWING JOINTS CONSISTING OF THICKWALLED POLY PIPE AND 1/2" INSERT ELBOWS.

POP-UP TYPE LOCATED IN SHRUBS SHALL BE INSTALLED ON 1/2" SCH 40 PVC RISERS TO A HEIGHT SO SPRINKLERS ARE CONCEALED FROM VIEW EXCEPT DURING USE.

SHRUB TYPE AND BUBBLERS SHALL BE INSTALLED ON 1/2" SCH 40 PVC RISERS. SHRUB HEADS SHALL BE INSTALLED A STANDARD HEIGHT OF 6" ABOVE PLANTS EXCEPT AS NOTED AND SHALL BE INSTALLED WITHIN PLANTS TO BE CONCEALED FROM VIEW. BUBBLERS SHALL BE INSTALLED AT THE BASE OF PLANTS AND PALMS FOR LOW LEVEL WATERING. RISERS SHALL BE PAINTED FLAT BLACK TO BE LESS VISIBLE.

EACH SPRINKLER SHALL BE EQUIPPED WITH THE APPROPRIATE MPR SPRAY NOZZLE AND SHALL BE PRESSURE REGULATED TO 30 PSI.

ADJUSTMENT FEATURES OF SPRINKLERS SPECIFIED SHALL BE UTILIZED TO ENSURE PROPER COVERAGE WITH MINIMAL UNDESIRABLE OVERTHROW. LOW ANGLE, FLAT SPRAY, AND ADJUSTABLE ARC NOZZLES SHALL BE USED TO MINIMIZE OVERTHROW.

SPRINKLERS LOCATED ADJACENT TO HARDSCAPED AREAS SHALL BE INSTALLED AWAY FROM HARDSCAPED AREAS TO MINIMIZE OVERTHROW AND THE CHANCE OF DAMAGE BY VEHICLES, PEDESTRIANS, AND LAWN MAINTENANCE PERSONNEL. AS A GENERAL RULE, 6" POP-UP SPRAY HEADS SHALL BE INSTALLED IN 4" SHRUB HEADS AND 12" POP-UP SPRAY HEADS SHALL BE INSTALLED IN 12" SHRUB HEADS.

CONTROL SYSTEM

CONTROL SYSTEM SHALL BE A RAIN BIRD ESP SERIES ELECTRIC TYPE. FOR THE SITE SYSTEM, ONE 4 STATION CONTROLLER SHALL ACTIVATE 3 IN-LINE VALVES. FOR THE 8TH LEVEL, ONE 4 STATION CONTROLLER SHALL ACTIVATE 2 CONTROL ZONE KITS. FOR THE 20TH LEVEL, ONE 4 STATION CONTROLLER SHALL ACTIVATE 1 CONTROL ZONE KIT. ONE VALVE SHALL BE CONTROLLED PER STATION. A RAIN SENSOR SHALL BE INSTALLED PER CONTROLLER TO CONSERVE WATER.

CONTROLLERS SHALL BE INSTALLED IN ACCORDANCE WITH LOCAL CODES AND MANUFACTURER'S INSTRUCTIONS. PROPER GROUNDING EQUIPMENT SHALL BE PROVIDED.

CONTROLLER LOCATIONS SHALL BE APPROVED BY THE OWNER'S REPRESENTATIVE. A 110 VAC ELECTRIC SOURCE IS REQUIRED.

CONTROL LINES FROM AUTOMATIC CONTROLLERS TO IN-LINE AUTOMATIC VALVES SHALL BE #14 AWG THIN TYPE WHICH SHALL BE:

(1) INSTALLED IN ACCORDANCE WITH LOCAL CODES, (2) INSTALLED IN SCH 40 PVC WIRE CONDUIT, (3) BURIED TO A MINIMUM DEPTH OF 15", (4) COLORED CODED TO FACILITATE TROUBLESHOOTING, AND (5) SPICED MOSTLY AT VALVE LOCATIONS. SPICES SHALL BE MADE WATERPROOF USING APPROVED METHODS. SPARE WIRES SHALL BE ROUTED FROM EACH CONTROLLER IN ALL DIRECTIONS TO THE FARTHEST VALVES CONTROLLED.

WIRE CONDUIT HUNG FROM THE GARAGE SLAB AT THE EIGHT LEVEL AND IN THE INTERSTITIAL SPACE AT THE TWENTIETH LEVEL SHALL BE INSTALLED IN ACCORDANCE WITH LOCAL CODES.

AUTOMATIC VALVE AND CONTROL ZONE KIT LOCATIONS ARE SCHEMATIC ONLY AND SHALL BE ADJUSTED FOR ON SITE CONDITIONS. EACH VALVE SHALL BE INSTALLED IN A VALVE BOX. A MINIMUM OF ONE CUBIC FOOT OF GRAVEL SHALL BE PROVIDED PER BOX TO PROMOTE DRAINAGE.

EACH RAIN SENSOR SHALL BE INSTALLED IN ACCORDANCE WITH MANUFACTURER'S INSTRUCTIONS.

TIMING AND PRECIPITATION

TIMING OF EACH STATION SHALL BE SET IN THE FIELD TO MATCH LOCAL REQUIREMENTS. REFER TO ZONE SUMMARY CHARTS FOR RECOMMENDED RUN TIMES TO APPLY 1.0 INCHES/WEK.

FDOT IRRIGATION NOTES

- The irrigation system shall use the lowest quality water available which adequately and safely meets the water needs of the system. Storm water, reclaim water, or grey water irrigation shall be used whenever possible.
- The FDOT requires 24-hour emergency access to water source.
- N/A
- Contractor shall provide the FDOT District Operations Manager with a set of "As-Built" irrigation plans.
- N/A
- N/A
- N/A
- N/A
- Should the existing irrigation system not be functional for a period of time during construction, ensure that measures are taken to water the existing plant material and sod. This may include portions of the median outside the renovation area depending on how the system is zoned.
- Note that 100% coverage must be achieved in the medians where existing irrigation modifications occur.
- To ensure the entire existing irrigation system is restored to fully functional condition, the contractor and maintaining agency are to perform a pre-construction visual inspection and performance test to document the condition of the existing system. Any repairs that are required to the existing system to remain will be performed by the maintaining agency prior to construction.
- Any existing or proposed components that are damaged during construction or the warranty period will be the responsibility of the contractor. The entire system must be restored to the same condition it was in before the start of construction.

CALL 48 HOURS BEFORE YOU DIG IN FLORIDA



Kenneth DiDonato, P.E.
CONSULTING ENGINEER
GOLF COURSE & COMMERCIAL IRRIGATION DESIGN
2210 HOLLYWOOD BLVD., HOLLYWOOD, FLORIDA 33020
(954) 987-0555
P.E. Lic. #43092

BLOCK 40 CITY of HOLLYWOOD
1858 HOLLYWOOD BLVD., HOLLYWOOD, FL
LEVEL 1 - SOUTH

IRRIGATION PLAN / NOTES & SPECIFICATIONS

1ST REVIEW 11/21/19
NO. REVISION DATE
DATE: 25 OCT. 2019
DRAWN BY: SCH

COPYRIGHT
SCOTT C HEYEN RLA

IR-2

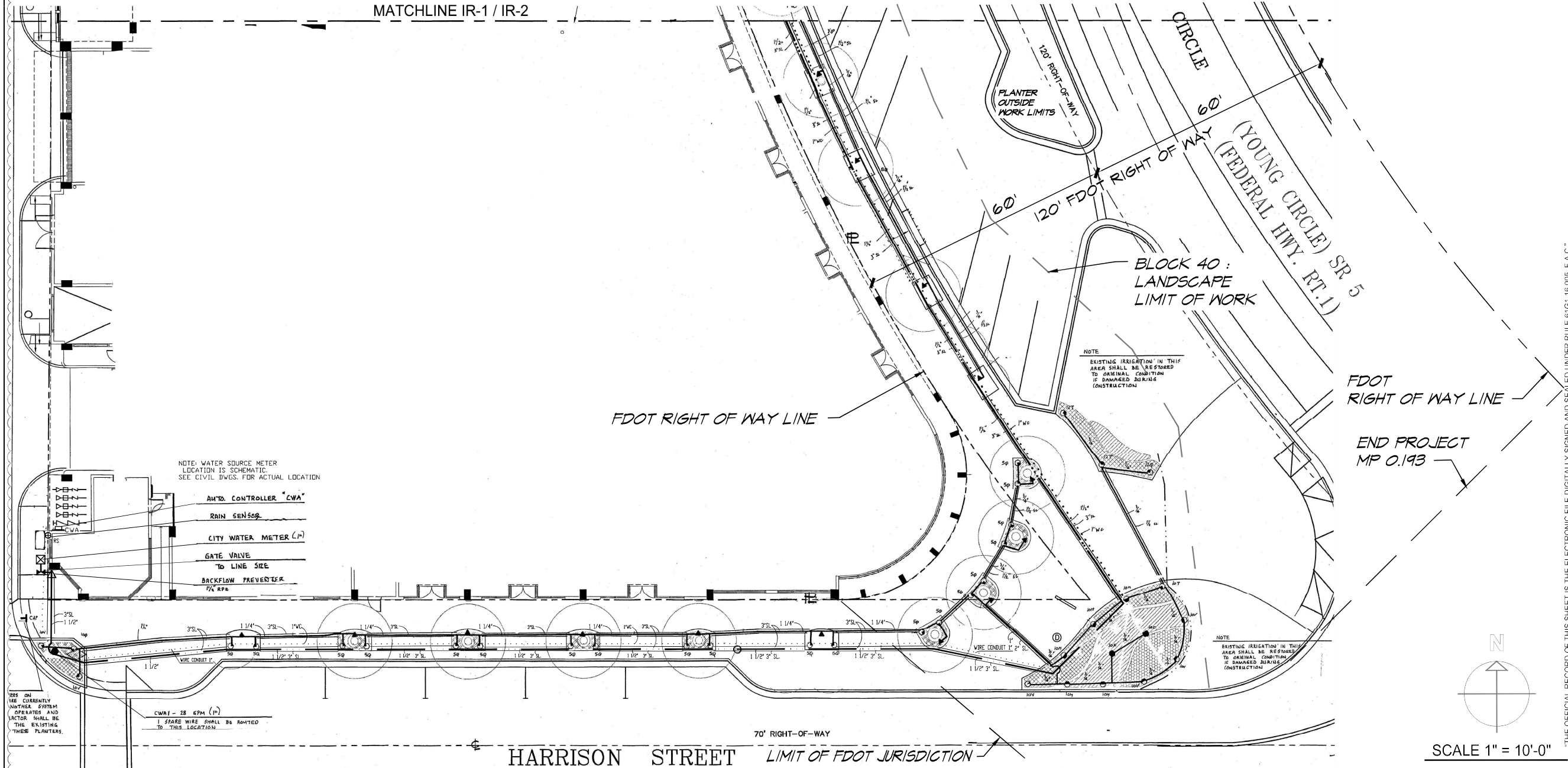

10-25-2019 ISSUED FOR FDOT LANDSCAPE PERMIT # 2019-L-491-00015

IRRIGATION NOTES & SPECIFICATIONS

AUTOMATIC IRRIGATION SYSTEM
WATER DEMAND / ZONE
WATER SOURCE
PRESSURE REQUIRED

REFER TO PLAN
CITY WATER
50 PSI (SITE LEVEL)

GENERAL

IRRIGATION SHALL BE INSTALLED IN ACCORDANCE WITH LOCAL CODES, CONTRACT DRAWINGS, CONTRACT SPECIFICATIONS, AND APPENDIX "F" OF THE FLORIDA BUILDING CODE.

IRRIGATION DESIGN BASED ON "PLANTING PLAN" DATED MAY 2016. CONTRACTOR SHALL REFER TO THIS PLAN TO COORDINATE SPRINKLER LOCATIONS AND PIPE ROUTING WITH NEW AND EXISTING PLANT LOCATIONS.

THIS PLAN SHALL BE USED AS A GUIDE ONLY. IRRIGATION SHALL BE INSTALLED TO MATCH ON SITE CONDITIONS AND TO OVERCOME THE INHERENT INACCURACIES THAT RESULT WHEN DESIGNING FROM BASE PLANS SCALED AT 1" = 10'.

THIS SITE SHALL BE IRRIGATED WITH THREE INDEPENDENT SYSTEMS. THE WATER SOURCE FOR THE SITE SYSTEM SHALL BE A 1" CITY WATER METER. THE SOURCE FOR EACH OF THE ELEVATED DECK SYSTEMS SHALL BE A DOMESTIC WATER LINE.

BACKFLOW PREVENTION SHALL BE INSTALLED TO MEET CODE REQUIREMENTS FOR CROSS CONNECTION CONTROL. A PRESSURE VACUUM BREAKER HAS BEEN SPECIFIED PER SYSTEM. CONTRACTOR SHALL VERIFY EACH PREVENTER IS TO LOCAL CODES.

THIS IRRIGATION HAS BEEN DESIGNED AS A TYPICAL BLOCK VALVE TYPE USING NETAFIM DRIP EQUIPMENT AND RAIN BIRD SPRINKLERS, IN-LINE VALVES AND CONTROL SYSTEM. RAIN SENSORS SHALL BE INSTALLED TO CONSERVE WATER.

IRRIGATION SHALL BE INSTALLED AND MAINTAINED TO MINIMIZE UNDESIRABLE OVERTHROW ONTO PAVEMENT, SIDEWALKS, AND BUILDINGS.

CONTRACTOR SHALL VISIT THE SITE TO BECOME FAMILIAR WITH SITE CONDITIONS, AND SHALL REFER TO THE PLANS FOR ADDITIONAL INFORMATION.

TO ENSURE PROPER OPERATION, SOURCE SIZES, PRESSURES REQUIRED, VALVE SIZES, ZONE CAPACITIES, SPRINKLER AND DRIPPERLINE SPACING, PIPE AND WIRE SIZES, AND INSTALLATION NOTES AND DETAILS SHALL BE FOLLOWED AS SHOWN.

PIPING

PIPE ROUTING IS SCHEMATIC ONLY AND SHALL BE ADJUSTED FOR ON SITE CONDITIONS.

PIPE SHALL BE INSTALLED IN ACCORDANCE WITH LOCAL CODES, SECTION "F" OF THE FLORIDA BUILDING CODE, AND PIPE MANUFACTURER'S INSTRUCTIONS.

PIPE ROUTED UNDER HARDSCAPED AREAS SHALL BE SLEEVED IN SCH 40 PVC. EACH SLEEVE SHALL BE: (1) BURIED TO A MINIMUM DEPTH OF 24", (2) TWO PIPE SIZES LARGER THAN CARRIER PIPE, AND (3) EXTENDED 3" BEYOND HARDSCAPED AREA ON EACH END. CONTRACTOR SHALL VERIFY THE LOCATION OF EXISTING SLEEVES.

PIPE INSTALLED ABOVE GRADE AT EACH BACKFLOW PREVENTER SHALL BE SCH 40 GALVANIZED STEEL. ALL OTHER PIPE AND FITTINGS SHALL BE SCH 40 TYPE 1120 PVC.

PIPE SIZED TO LIMIT FLOW VELOCITIES TO 5 FEET/SECOND AND TO LIMIT FRICTION LOSS IN THE PIPING NETWORK.

PIPE SHALL BE INSTALLED AT SUFFICIENT DEPTH BELOW GROUND TO PROTECT IT FROM HAZARD SUCH AS VEHICULAR TRAFFIC OR ROUTINE OCCURRENCES WHICH OCCUR IN THE NORMAL USE AND MAINTENANCE OF THE PROPERTY. DEPTHS OF COVER SHALL MEET OR EXCEED SCS CODE 430-OD. REFER TO THE APPLICABLE DETAIL FOR ADDITIONAL INFORMATION.

BACKFILL SHALL BE OF SUITABLE MATERIAL, FREE OF ROCKS, STONES, AND OTHER DEBRIS THAT WOULD DAMAGE IRRIGATION SYSTEM COMPONENTS.

GATE AND BALL VALVES SHALL BE INSTALLED FOR ISOLATION. EACH VALVE SHALL BE TO LINE SIZE AND INSTALLED IN A VALVE BOX. POROUS MATERIAL SHALL BE INSTALLED PER BOX TO PROMOTE DRAINAGE.

EACH BACKFLOW PREVENTER SHALL BE INSTALLED IN ACCORDANCE WITH LOCAL CODES AND SHALL BE LOCATED TO BE CONCEALED FROM VIEW.

PIPE HUNG FROM SLAB IN THE PARKING GARAGE AT THE 8TH LEVEL, AND IN THE INTERSTITIAL SPACE ON THE 20TH LEVEL SHALL BE INSTALLED IN ACCORDANCE WITH THE APPLICABLE SECTION OF THE MECHANICAL SPECIFICATIONS. ROUTING OF PIPE, WHICH IS SCHEMATIC ONLY, SHALL BE VERIFIED ON SITE. CONTRACTOR SHALL VERIFY THAT INSTALLING SCH 40 PVC IN THE GARAGE AND IN THE INTERSTITIAL SPACE IS TO LOCAL CODES.

PIPE RISERS SHALL BE INSTALLED IN ACCORDANCE WITH THE APPLICABLE SECTION OF THE MECHANICAL SPECIFICATIONS. THE LOCATION OF EACH RISER SHALL BE VERIFIED ON SITE. CONTRACTOR SHALL VERIFY THAT INSTALLING SCH 40 PVC RISERS IN THE GARAGE AND INTERSTITIAL SPACE IS TO LOCAL CODES.

EACH PUNCTURE THROUGH SLAB SHALL BE WATERPROOFED IN ACCORDANCE WITH THE APPLICABLE SECTION OF THE MECHANICAL SPECIFICATIONS.

SPRINKLERS

SPRINKLER LOCATIONS ARE SCHEMATIC ONLY AND SHALL BE ADJUSTED FOR LANDSCAPING, FENCES, SITE LIGHTING, PREVAILING WIND, MOUNDING, ETC., TO ENSURE PROPER COVERAGE WITH MINIMAL UNDESIRABLE OVERTHROW. A PRIME OBJECTIVE SHALL BE TO ELIMINATE OVERTHROW ONTO PAVEMENT, SIDEWALKS, AND THE BUILDING.

SPRAY HEADS SHALL BE RAIN BIRD 1800 SERIES. SIX INCH POP-UP TYPE SHALL BE INSTALLED IN AREAS LANDSCAPED WITH SOD AND MULCH, TWELVE INCH POP-UP TYPE SHALL BE INSTALLED IN AREAS LANDSCAPED WITH GRASS COVER AND LOW SHRUBS. SHRUB HEADS SHALL BE INSTALLED IN AREAS LANDSCAPED WITH TALL SHRUBS, AND BUBBLERS SHALL BE INSTALLED IN NARROW LANDSCAPED AREAS AND AT PALMS.

POP-UP TYPE LOCATED IN SOD, MULCH, AND GROUND COVERS SHALL BE INSTALLED ON FLEXIBLE SWING JOINTS CONSISTING OF THICKWALLED POLY PIPE AND 1/2" INSERT ELBOWS.

POP-UP TYPE LOCATED IN SHRUBS SHALL BE INSTALLED ON 1/2" SCH 40 PVC RISERS TO A HEIGHT SO SPRINKLERS ARE CONCEALED FROM VIEW EXCEPT DURING USE.

SHRUB TYPE AND BUBBLERS SHALL BE INSTALLED ON 1/2" SCH 40 PVC RISERS. SHRUB HEADS SHALL BE INSTALLED A STANDARD HEIGHT OF 6" ABOVE PLANTS EXCEPT AS NOTED AND SHALL BE INSTALLED WITHIN PLANTS TO BE CONCEALED FROM VIEW. BUBBLERS SHALL BE INSTALLED AT THE BASE OF PLANTS AND PALMS FOR LOW LEVEL WATERING. RISERS SHALL BE PAINTED FLAT BLACK TO BE LESS VISIBLE.

EACH SPRINKLER SHALL BE EQUIPPED WITH THE APPROPRIATE MPR SPRAY NOZZLE AND SHALL BE PRESSURE REGULATED TO 30 PSI.

ADJUSTMENT FEATURES OF SPRINKLERS SPECIFIED SHALL BE UTILIZED TO ENSURE PROPER COVERAGE WITH MINIMAL UNDESIRABLE OVERTHROW. LOW ANGLE, FLAT SPRAY, AND ADJUSTABLE ARC NOZZLES SHALL BE USED TO MINIMIZE OVERTHROW.

SPRINKLERS LOCATED ADJACENT TO HARDSCAPED AREAS SHALL BE INSTALLED AWAY FROM HARDSCAPED AREAS TO MINIMIZE OVERTHROW AND THE CHANCE OF DAMAGE BY VEHICLES, PEDESTRIANS, AND LAWN MAINTENANCE PERSONNEL. AS A GENERAL RULE, 6" POP-UP SPRAY HEADS SHALL BE INSTALLED IN 4" SHRUB HEADS AND 12" POP-UP SPRAY HEADS SHALL BE INSTALLED IN 12" SHRUB HEADS.

DRIP IRRIGATION

DRIP IRRIGATION SHALL BE INSTALLED TO IRRIGATE ALL PLANTED AREAS ON THE EIGHT AND TWENTIETH LEVELS.

DRIP IRRIGATION SHALL CONSIST OF TECHLINE NETAFIM DRIPPERLINE, FLUSH VALVES, SOIL STAPLES AND ACCESSORIES.

DRIP PIPE WITH EMITTERS 12" ON-CENTER WHICH DELIVER 0.9 GPH SHALL BE INSTALLED IN ROWS SPACED A MAXIMUM OF 24 INCHES ON-CENTER IN AREAS LANDSCAPED WITH GROUND COVERS AND SHRUBS.

DRIP EQUIPMENT SHALL BE INSTALLED IN ACCORDANCE WITH MANUFACTURER'S INSTRUCTIONS AND UNDER THE SUPERVISION OF THE LANDSCAPE ARCHITECT.

LINE FLUSH VALVES SHALL BE INSTALLED AS RECOMMENDED BY THE MANUFACTURER FOR ROUTINE MAINTENANCE.

DRIP IRRIGATION SHALL BE CONTROLLED VIA RAIN BIRD CONTROL ZONE KITS. EACH UNIT SHALL BE INSTALLED IN A VALVE BOX SIZED TO ACCOMMODATE THE UNIT.

QUANTITIES OF TECHLINE INDICATED ON THE PLAN ARE VERY APPROXIMATE. CONTRACTOR SHALL SUBMIT A PER FOOT UNIT PRICE TO INSTALL TECHLINE. SO ADDITIONS AND DELETIONS TO THE CONTRACT MAY BE MADE AT A PRE-DETERMINED PRICE.

DRIP EMITTERS SHALL BE INSTALLED IN THE DRIPPERLINE NETWORK FOR POTS AND SELECTED PALMS TO INCREASE WATER APPLICATION AT THESE LOCATIONS.

CONTROL SYSTEM

CONTROL SYSTEM SHALL BE A RAIN BIRD ESP SERIES ELECTRIC TYPE. FOR THE SITE SYSTEM, ONE 4 STATION CONTROLLER SHALL ACTIVATE 3 IN-LINE VALVES. FOR THE EIGHT LEVEL, ONE 4 STATION CONTROLLER SHALL ACTIVATE 2 CONTROL ZONE KITS. FOR THE 20TH LEVEL, ONE 4 STATION CONTROLLER SHALL ACTIVATE 1 CONTROL ZONE KIT. ONE VALVE SHALL BE CONTROLLED PER STATION. A RAIN SENSOR SHALL BE INSTALLED PER CONTROLLER TO CONSERVE WATER.

CONTROLLERS SHALL BE INSTALLED IN ACCORDANCE WITH LOCAL CODES AND MANUFACTURER'S INSTRUCTIONS. PROPER GROUNDING EQUIPMENT SHALL BE PROVIDED.

CONTROLLER LOCATIONS SHALL BE APPROVED BY THE OWNER'S REPRESENTATIVE. A 110 VAC ELECTRIC SOURCE IS REQUIRED.

CONTROL LINES FROM AUTOMATIC CONTROLLERS TO IN-LINE AUTOMATIC VALVES SHALL BE #14 AWG THIN TYPE WHICH SHALL BE:

(1) INSTALLED IN ACCORDANCE WITH LOCAL CODES, (2) INSTALLED IN SCH 40 PVC WIRE CONDUIT, (3) BURIED TO A MINIMUM DEPTH OF 18", (4) COLORED CODED TO FACILITATE TROUBLESHOOTING, AND (5) SPLICED MOSTLY AT VALVE LOCATIONS. SPLICES SHALL BE MADE WATERPROOF USING APPROVED METHODS. SPARE WIRES SHALL BE ROUTED FROM EACH CONTROLLER IN ALL DIRECTIONS TO THE FARTHEST VALVES CONTROLLED.

WIRE CONDUIT HUNG FROM THE GARAGE SLAB AT THE EIGHT LEVEL AND IN THE INTERSTITIAL SPACE AT THE TWENTIETH LEVEL SHALL BE INSTALLED IN ACCORDANCE WITH LOCAL CODES.

AUTOMATIC VALVE AND CONTROL ZONE KIT LOCATIONS ARE SCHEMATIC ONLY AND SHALL BE ADJUSTED FOR ON SITE CONDITIONS. EACH VALVE SHALL BE INSTALLED IN A VALVE BOX. A MINIMUM OF ONE CUBIC FOOT OF GRAVEL SHALL BE PROVIDED PER BOX TO PROMOTE DRAINAGE.

EACH RAIN SENSOR SHALL BE INSTALLED IN ACCORDANCE WITH MANUFACTURER'S INSTRUCTIONS.

TIMING AND PRECIPITATION

TIMING OF EACH STATION SHALL BE SET IN THE FIELD TO MATCH LOCAL REQUIREMENTS. REFER TO ZONE SUMMARY CHARTS FOR RECOMMENDED RUN TIMES TO APPLY 1.0 INCHES/WEK.

NOTE: ABOVE GRADE PUMP SUCTION PIPE SHALL BE SCH40 GALVANIZED STEEL WITH GALVANIZED ROLL GROOVE FITTINGS.

* OPTIONAL FEATURES ARE INCLUDED IF MARKED WITH AN "X"
--- MASTER VALVE CONNECTED TO IRRIGATION CONTROLLER MV CIRCUIT, NORMALLY CLOSED
--- WITH BYPASS SWITCH ON CONTROL PANEL.
--- IRRIGATION CONTROLLER STATIONS, RAIN SENSOR ON 8" POLE.
X PRESSURE TANK FOR PRESSURE DEMAND SYSTEMS

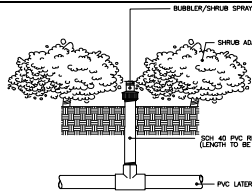

SPRINKLER DETAIL (NTS)

BUBBLER/SHRUB SPRAY
INSTALLED AT THE BASE OF
PLANTS FOR LOW LEVEL
WATERING

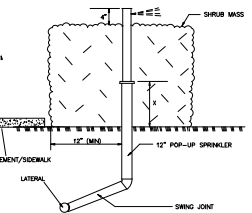

SPRINKLER DETAIL (NTS)

12" POP-UP INSTALLED ON PVC
SWING JOINT LOCATED IN PLANT
MASS MAINTAINED TO A MAXIMUM
HEIGHT OF 18"

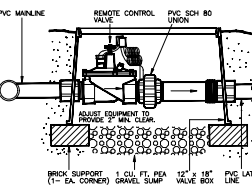

REMOTE CONTROL VALVE DETAIL

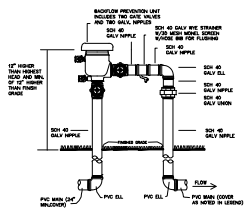

PRESSURE VACUUM BREAKER

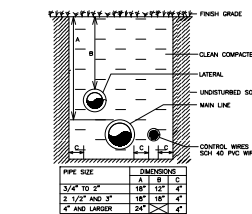

TRENCHING DETAIL (NTS)

NON-TRAFFIC AREAS

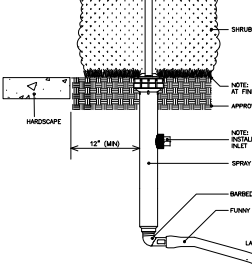

SPRINKLER DETAIL (NTS)

12" POP-UP SPRAY ON POLY PIPE SWING
JOINT LOCATED IN PLANTS MAINTAINED TO
A MAXIMUM HEIGHT OF 8"

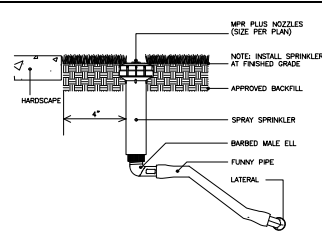

SPRINKLER DETAIL (NTS)
POP-UP SPRAY ON POLY
PIPE SWING JOINT LOCATED
IN SOD OR MULCH

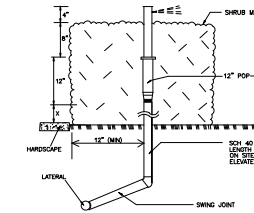

SPRINKLER DETAIL (NTS)

12" POP-UP ON PVC SWING
JOINT WITH RISER LOCATED IN
PLANT MASS MAINTAINED TO A
MINIMUM HEIGHT OF 24"

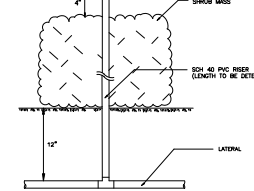

SPRINKLER DETAIL (NTS)

SHRUB SPRAY ON RISER
INTERIOR LOCATION IN
PLANT MASS.

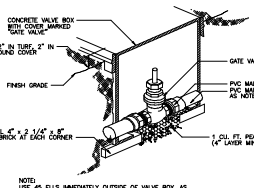

GATE VALVE DETAIL

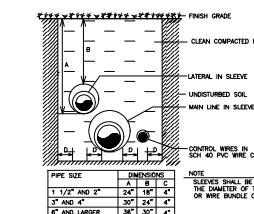

TRENCHING DETAIL (NTS)

VEHICULAR TRAFFIC AREAS

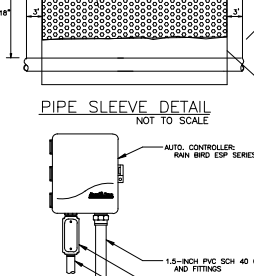

PIPE SLEEVE DETAIL

ESP AUTOMATIC CONTROLLER
NOT TO SCALE

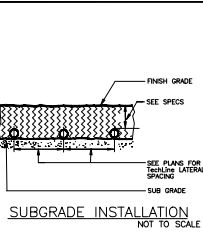

SUBGRADE INSTALLATION

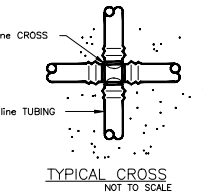

TYPICAL CROSS

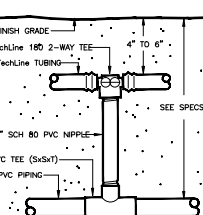

START CONNECTION WITH PVC RISER

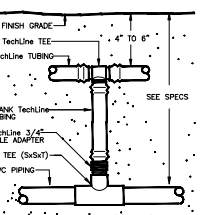

START CONNECTION PVC TO TEE

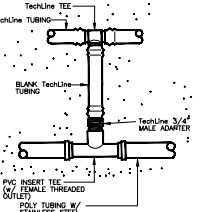

START CONNECTION POLY TO TEE

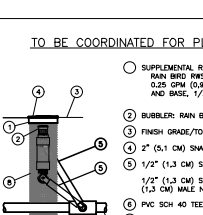

START CONNECTION POLY TO ELL

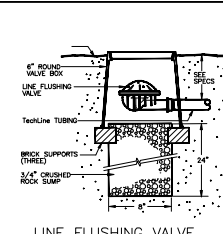

LINE FLUSHING VALVE PLUMBED TO TECHLINE

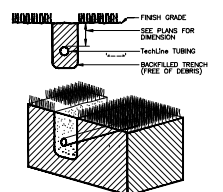

TRENCHING DETAIL

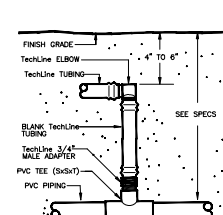

START CONNECTION PVC TO ELBOW

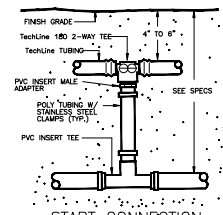

START CONNECTION POLY TO TECHLINE

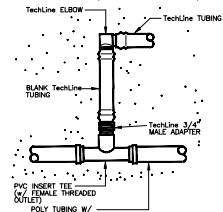

START CONNECTION POLY TO ELL



Kenneth DiDonato, P.E.
CONSULTING ENGINEER
GOLF COURSE & COMMERCIAL IRRIGATION DESIGN
2010 HOLLYWOOD BLVD., HOLLYWOOD, FLORIDA 33020
(954) 927-2555

IRRIGATION SPECS., DETAILS

BLOCK 40
1858 HOLLYWOOD BLVD., HOLLYWOOD, FL

SITE

1ST REVIEW 11/21/19
NO. REVISION DATE
DATE: 25 OCT. 2019
DRAWN BY: SCH

C COPYRIGHT 2019
SCOTT C. HEYEN, RLA

IR-3

THE OFFICIAL RECORD OF THIS SHEET IS THE ELECTRONIC FILE DIGITALLY SIGNED AND SEALED UNDER RULE 61G1-16.005, F.A.C.*

10-25-2019 ISSUED FOR FDOT LANDSCAPE PERMIT # 2019-L-491-00015



SCOTT C. HEYENEN, RLA LLC
LANDSCAPE ARCHITECTURE AND LAND PLANNING

1627 Funtun St., Hollywood, FL
PHONE 954-920-4945 scottcland@gmail.com

HARDSCAPE PLAN

BLOCK 40 1858 HOLLYWOOD BLVD., HOLLYWOOD, FL

LEVEL 1 SITE

1ST REVIEW 11/21/19
NO. REVISION DATE
DATE: 25 OCT. 2019
DRAWN BY: SCH

©COPYRIGHT
SCOTT C. HEYENEN, RLA

SHEET

L-1

THE OFFICIAL RECORD OF THIS SHEET IS THE ELECTRONIC FILE DIGITALLY SIGNED AND SEALED UNDER RULE 61G1-16.005, F.A.C.

HARDSCAPE MATERIALS

SITE LEVEL

- 1 4"x8"x2 3/8" PAV. HERRINGBONE PATTERN, COLOR MIX SLATE
 - 2 PROVIDE 3" THICK PAVERS • ALL VEHICULAR CROSSWALK AREAS TYP
 - 3 4"x8"x2 3/8" PAV. NOT TUMBLD, UPSIDE DOWN, 4" WIDE BAND, COLOR MIX GRANITE
 - 3A 2 3/4"x 12"x 6" WAUSAU GRANITE PAV. HERRINGBONE PATTERN
ALIGN W/CL. OF FIELD • 45 DEGREE, RANDOM MIX OF COLORS 25% OF GTX-10 / GTX-20
GTX-30 & GTX-120.
 - 3B 2 3/4"x 12"x 6" WAUSAU GRANITE PAV. RUNNING BOND PATTERN
RANDOM MIX OF COLORS 25% OF GTX-10 / GTX-20
GTX-30 & GTX-120.
 - 4 CITY STANDARD 2 3/8" PAV. PATTERN AS SHOWN, UNI-DECOR STYLE AND COLOR MIX; BENT CREEK
 - 4B 4"x 8"x 2 3/8" PAV. 4" BAND, COLOR MIX; BENT CREEK
 - 5 4"x8"x2 3/8" PAV. NOT TUMBLD, UPSIDE DOWN, 8" WIDE BAND, COLOR MIX; BENT CREEK
TO MATCH EXISTING CITY PAV.
 - 6A 12"x 12"x 2" GRANITE PAVERS BY WAUSAU, PATTERN AS SHOWN, COLOR MIX GTX 10
 - 6B 12"x 12"x 2" GRANITE PAVERS BY WAUSAU, PATTERN AS SHOWN, COLOR MIX GTX 30
 - 7 8"x12" WIDE CONC. BAND w/EXPANSION JOINTS @10' O.C. MIN. 4AT EACH INTERSECTION &
CORNER - SEE LAYOUT DETAIL SHEET L-1 - BRUSH FINISH & 3/8" TOOLED EDGE
 - 14A DRIVEWAY CONCRETE BAND PER CIVIL
 - 8 4" CONC. SLAB w/LIGHT BROOM FINISH WITH GREEN TILE
AND TOOLED JOINT (MATCH EXISTING CITY PAVING)
 - 9 12"x12"x3 3/8" PAV. STACKED PATTERN, COLOR MIX GRANITE
 - 10 4"x 8"x 2 3/8" PAVERS, NOT TUMBLD, (UPSIDE DOWN),
4" WIDE BANDS @ 3'-4" O.C. EA. WAY COLOR MIX SLATE
 - 11 4"x 8"x 2 3/8" PAVERS, NOT TUMBLD, RUNNING BOND, 2" WIDE
ADA COMPLIANT DETECTABLE WARNING (TRUNCATED DOPES) COLOR CHARCOAL
 - 12 4" CONC. SLAB w/BRUSH FINISH, w/ 6" x 6" 18 WUM OVER 6" COMPACTED BASE
AND TOOLED JOINT (MATCH EXISTING CITY PAVING)
- PAVERS EQUAL TO BELGARD (OLDCASTLE) • WAUSAU TILE (TECTURA DESIGNS)
UNI-DECOR PAVERS EQUAL TO BELGARD (OLDCASTLE)

HARDSCAPE PERMIT NOTES

All hardscape / pavers damaged as a result of proposed construction
shall be replaced per City of Hollywood requirements and coordinated
with the City of Hollywood

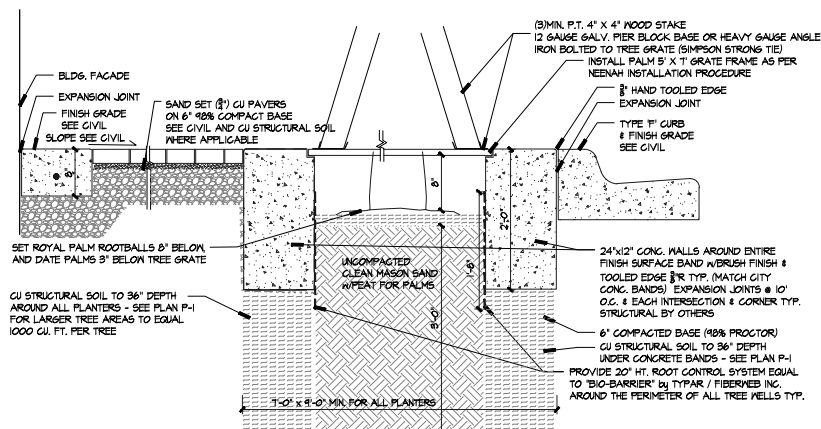

(1) SIDEWALK PAVING & PALM PLANTER WITH GRATE SECTION

SCALE: 1"=1'-0"

NOTES:

1. SEE CIVIL ENGINEERS DWGS. FOR SIDEWALK GRADING



(7) EXPANSION JOINT TYP. LAYOUT DETAIL

SCALE: 1/8"=1'-0"



SCALE 1/16" = 1'-0"

0' 8' 16' 32'

10-25-2019 ISSUED FOR FDOT LANDSCAPE PERMIT # 2019-L-491-00015

SITE FURNISHING

- (A) TREE WELLS / PLANTERS TO BE FINISHED WITH PERMEABLE WALKABLE SURFACE
KBI FLEXIPAVE - POROUS PAVING, TROUPEL FINISH BLENDED TO CONCRETE BAND, SEE DETAIL L-1
AS DIRECTED / REQUIRED BY CITY LANDSCAPE ARCHITECT AND CRA.
- (B) ROYAL / DATE PALM PLANTERS ON CIRCLE - TREE GRATE 5'X1' WITH (21") OPENING,
EXISTING TO BE REUSED & REFINISHED - IRON GRATE BY NEEHAH FOUNDRY CO.
BLOCK 40 OWNER SHALL PROCURE & STORE ALL TREE GRATES UNTIL REINSTALLATION
- (D) TRASH RECEPTACLE TO MATCH EXISTING (OR REUSED & REFINISHED EXISTING)
EQUAL TO VICTOR STANLEY 15-42 w/BLACK POWDER COAT FINISH AND GALV. STEEL LINER
- (E) POLE LIGHT TRASH RECEPTACLE TO MATCH EXISTING (OR REUSED & REFINISHED EXISTING)
- (F) DIRECTIONAL SIGN - EXISTING CITY OF HOLLYWOOD SIGN TO BE RELOCATED
EXISTING TRAFFIC SIGNAL TO REMAIN
- (G) TREE WELL (FINISH GRADE TO BE 2" BELOW PAVING)

GENERAL NOTES:

1. CONTRACTOR SHALL OBTAIN AND COMPLY WITH ALL APPLICABLE CODES
AND CONSTRUCTION STANDARDS DEVELOPED AND USED BY THE CITY OF HOLLYWOOD, AND F.D.O.T.
2. THE CONTRACTOR SHALL FOLLOW THE STANDARDS IN ACCORDANCE WITH THE
EXISTING STREETSCAPE DESIGN STANDARDS / GUIDELINES.
3. CONTRACTOR SHALL ACQUIRE ALL FURNISHINGS AND LIGHTING IN WORK LIMITS FOR
BLOCK 40 OWNER TO STORE / PRESERVE AND RE-INSTALL.

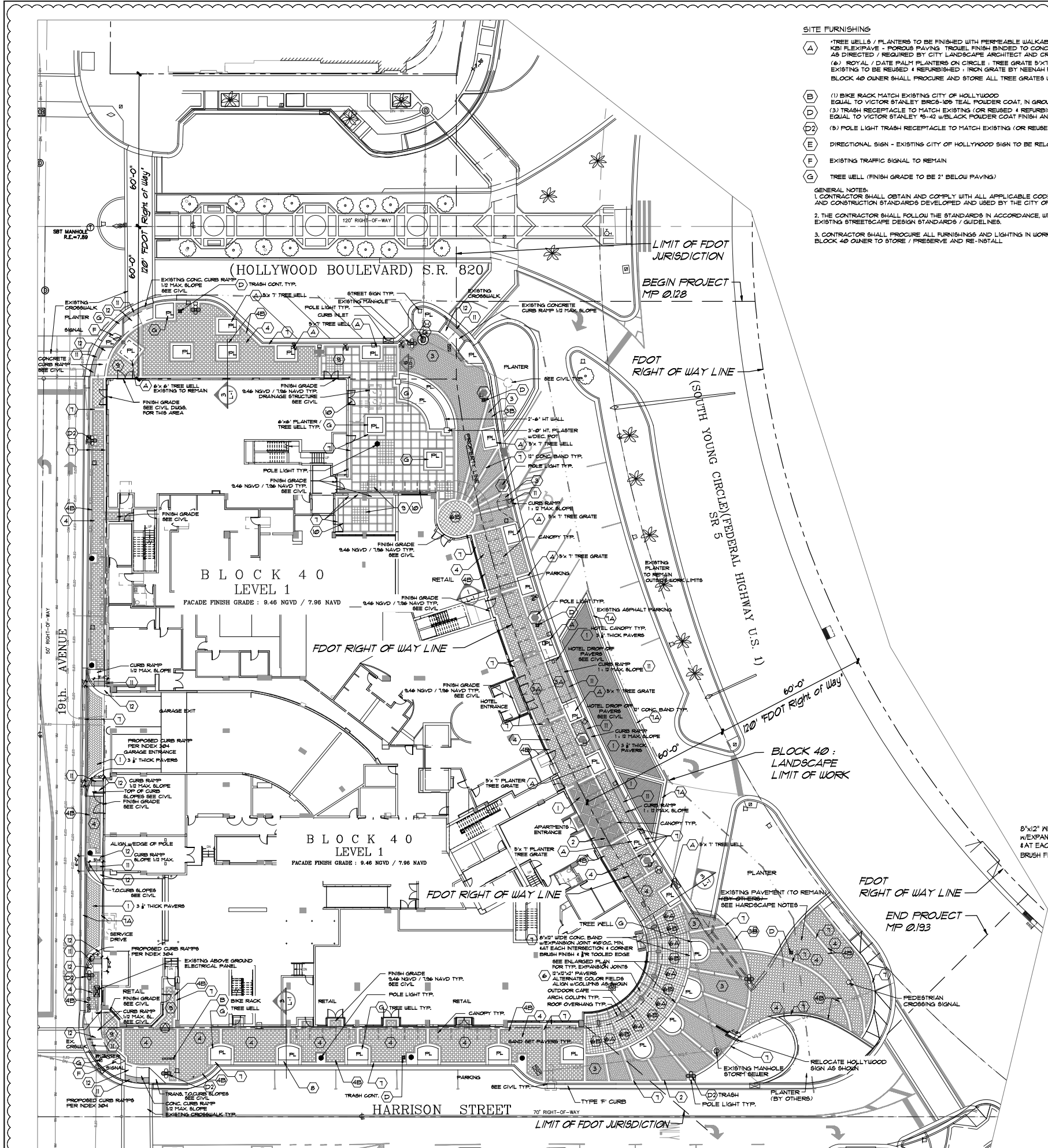



SCOTT C. HEYNEN, RLA LLC
LANDSCAPE ARCHITECTURE AND LAND PLANNING
1627 Funston St., Hollywood, FL
PHONE 954-558-8795 scotthland@gmail.com

BLOCK 40
1858 HOLLYWOOD BLVD., HOLLYWOOD, FL
LIGHTING PLAN & SCHEDULE

BLOCK 40
1858 HOLLYWOOD BLVD., HOLLYWOOD, FL
LEVEL 1 - SITE

1ST REVIEW 11/21/19
NO. REVISION DATE
DATE: 25 OCT. 2019
DRAWN BY: SCH
COPYRIGHT
SCOTT C. HEYNEN, RLA
SHEET

LT-1

THE OFFICIAL RECORD OF THIS SHEET IS THE ELECTRONIC FILE DIGITALLY SIGNED AND SEALED UNDER RULE 61G1-16.005, F.A.C.

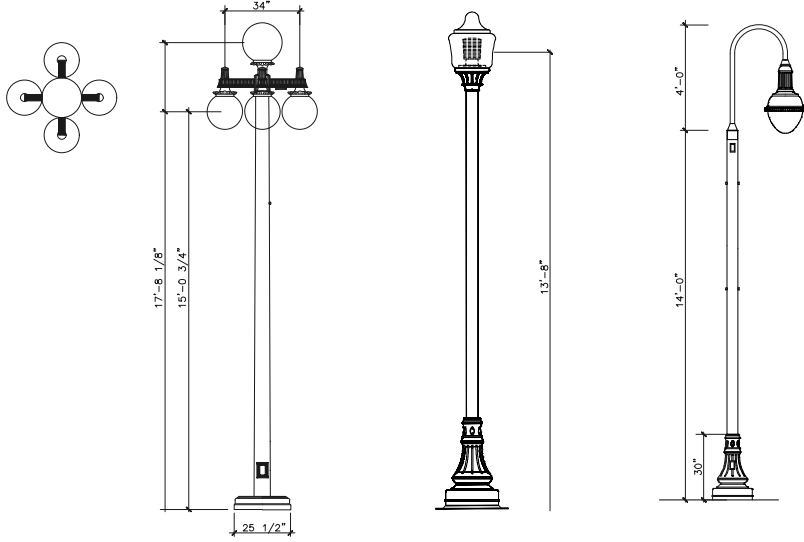
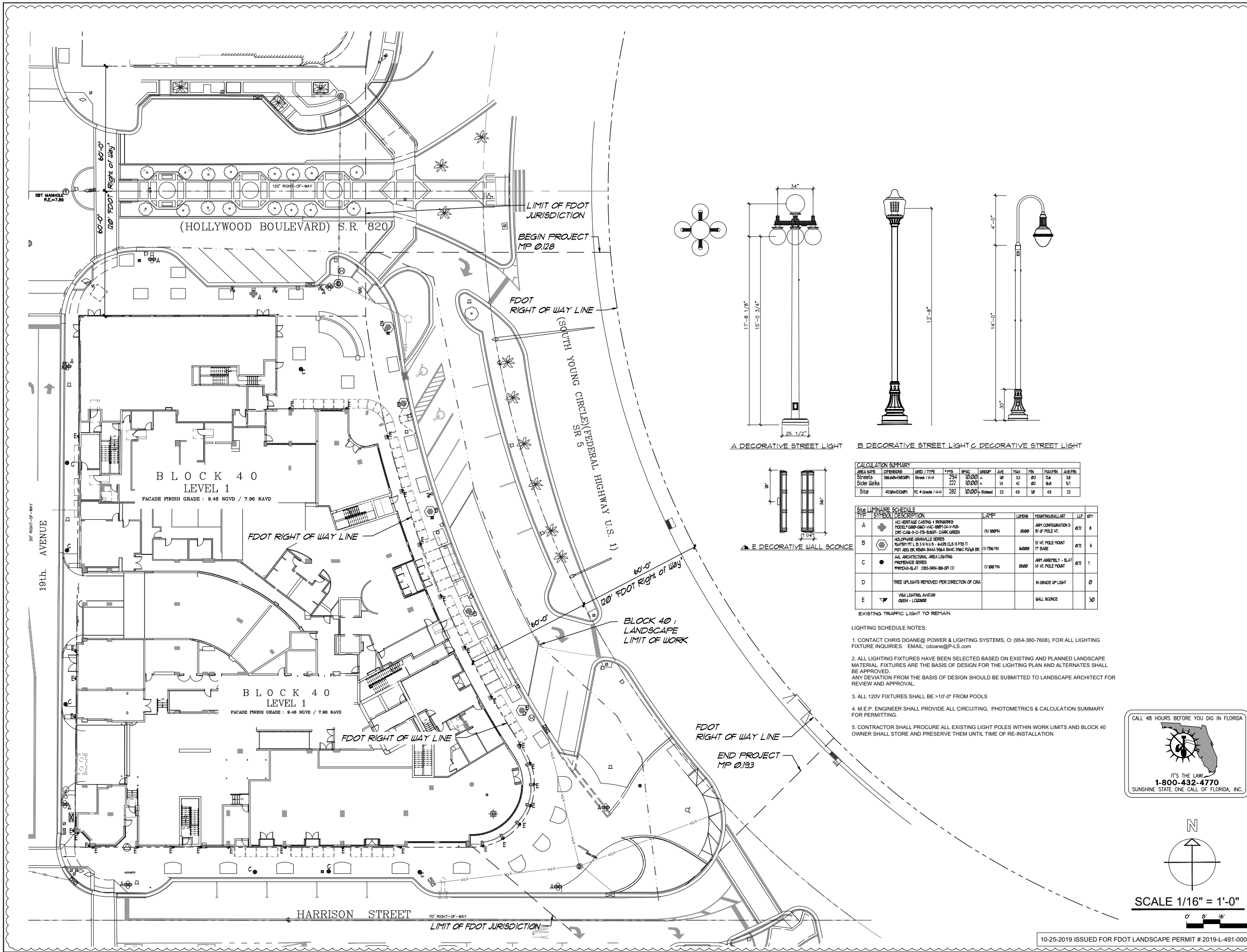

A DECORATIVE STREET LIGHT B DECORATIVE STREET LIGHT C DECORATIVE STREET LIGHT

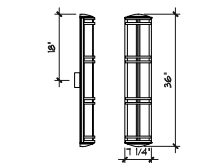

E DECORATIVE WALL SCONCE

CALCULATION SUMMARY											
AREA NAME	DIMENSIONS	GRID / TYPE	FPS	SPAC	GROUP	AVE	MAX	MIN	MAX/MIN	AVERAGE	
Streets	386.60x100.00	Street / 14H	234	10.00	A	10	33	03	0.6	3.8	
Side Walks			222	10.00	A	14	41	02	16.8	8.7	
Site	423.60x133.00	PC = Grade / 14H	282	10.00	SideWalk	22	45	10	4.5	22	

SITE LUMINAIRE SCHEDULE					
ITEM	SYMBOL	DESCRIPTION	LAMP	LUMENS	YOUNTING/BALLAST
A	+	HG HERITAGE CASTING 4 IRONWORKS MODEL GRD-GRD-VAC-0007-24-V-FUS- DRY-CLIP-2-0-15-800PH DARK GREEN HOLLYHURST GRASSVILLE SERIES 15'X15'X11' L B 3 IN N U 8 - 8430R CLS 15 FIB IT POT ARS BK REGR. 5444 596A 594C 594C 594C BK PROMINENCE SERIES	(5) 100W PH	8500	ARM CONFIGURATION 5 3' 0" POLE HT.
B	+	ALL ARCHITECTURAL AREA LIGHTING PROMINENCE SERIES PROMINENCE SLAT DES-5904-180-GR (2)	(1) 150W PH	16000	15' HT. POLE POINT 17' BASE
C	+	ALL ARCHITECTURAL AREA LIGHTING PROMINENCE SERIES PROMINENCE SLAT DES-5904-180-GR (2)	(1) 150W PH	16000	ARM ASSEMBLY - SLAT 14' HT. POLE POINT
D	+	TREE UPLIGHTS REMOVED PER DIRECTION OF CRA			N GRADE UP LIGHT
E	+	VISA LIGHTING AVATAR CLUB4 - L02800			WALL SCONCE

- EXISTING TRAFFIC LIGHT TO REMAIN
- LIGHTING SCHEDULE NOTES:
- CONTACT CHRIS DOANE@ POWER & LIGHTING SYSTEMS, O; (954-360-7608), FOR ALL LIGHTING FIXTURE INQUIRIES. EMAIL: cdoane@P-LS.com
 - ALL LIGHTING FIXTURES HAVE BEEN SELECTED BASED ON EXISTING AND PLANNED LANDSCAPE MATERIAL. FIXTURES ARE THE BASIS OF DESIGN FOR THE LIGHTING PLAN AND ALTERNATES SHALL BE APPROVED. ANY DEVIATION FROM THE BASIS OF DESIGN SHOULD BE SUBMITTED TO LANDSCAPE ARCHITECT FOR REVIEW AND APPROVAL.
 - ALL 120V FIXTURES SHALL BE >10'-0" FROM POOLS
 - M.E.P. ENGINEER SHALL PROVIDE ALL CIRCUITING, PHOTOMETRICS & CALCULATION SUMMARY FOR PERMITTING.
 - CONTRACTOR SHALL PROCURE ALL EXISTING LIGHT POLES WITHIN WORK LIMITS AND BLOCK 40 OWNER SHALL STORE AND PRESERVE THEM UNTIL TIME OF RE-INSTALLATION

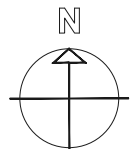
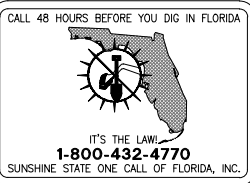

SCALE 1/16" = 1'-0"

10-25-2019 ISSUED FOR FDOT LANDSCAPE PERMIT # 2019-L-491-00015