



## Company Profile

Prepared for:

**City of Hollywood**

2600 Hollywood Blv  
Hollywood, FL 33020

Project Name:

**RFP-174-24-GJ**

**Citywide Gateway and neighborhood Signage**

Date:

**04/16/2024**

---

4100 N Powerline Rd Suite L-2  
Pompano Beach, FL 33073

90 Newark Pompton Turnpike  
Wayne, NJ 07470

[www.bergensign.com](http://www.bergensign.com)

(954) 957-9961

[richw@bergensign.com](mailto:richw@bergensign.com)

Company Representative  
Rich Walker



# Table of Contents

## **2 | Table of Contents**

## **3 | EXECUTIVE SUMMARY**

## **9 | QUALIFICATION AND EXPERIENCE**

## **30 | PROPOSED SCHEDULE**

## **31 | SIMILAR PROJECT EXPERIENCE**

## **39 | NOTICE TO VENDORS**

## **43 | REQUIRED FORMS**

## **51 | PRICE PROPOSALS**

---

## EXECUTIVE SUMMARY

---

Bergen Sign Company  
4100 N. POWERLINE RD. SUITE L2  
POMPANO BEACH, FL 33073  
(954) 957-9961  
[rmurphy@bergensign.com](mailto:rmurphy@bergensign.com)

11/06/2023

City of Hollywood  
2600 Hollywood Blvd #303  
Hollywood, FL 33020

Re: **RFP-174-24-GJ- Citywide Gateway and neighborhood Signage**

To Whom It May Concern,

We are pleased to submit for your consideration this explanation of understanding for RFP-174-24-GJ- Citywide Gateway and neighborhood Signage

Bergen Sign Company has been a full service sign company since 1918. We take pride in our exceptional level of customer service, professionalism and quality, often going the extra mile to create the ideal sign system for our clients. Throughout the years, Bergen Sign Company has managed to adapt to an ever-changing economic and social environment. Today, we are able to fulfill all of our clients' signage needs, ranging from interior room ADA signs to corporate identification on a large exterior scale. At Bergen Sign Company, we know that quality customer service, product design and manufacturing will ensure a long-lasting and successful professional relationship. We have over 100 years of quality experience to back our promises and products, and would be honored to add your city to our ever-growing portfolio.

At BSC, we know the concerns of our customers and work diligently to achieve those goals with on time delivery and efficient budgetary constraints. Over 100 years in the sign industry have allotted us with the experience necessary to understand our clients' individual needs and develop processes to efficiently meet those needs. We have perfected our fabrication and installation processes in order to create signage of the highest standard in a time frame which meets our clients needs. We have had the opportunity to work on thousands of versatile projects over the years, including several citywide wayfinding projects. We are a local business based in Pompano Beach and are CBE certified by Broward county.

BSC maintains a 20,000 sqft warehouse in Pompano Beach equipped with the latest machinery and tools for routing, printing, and general sign assembly. Unlike most sign companies we have a state of the art, fully licensed, dedicated bay where we paint our signs. Bergen also maintains a 15,000 sqft warehouse in Wayne, NJ.

# EXECUTIVE SUMMARY - QUALIFICATION AND EXPERIENCE

<b>SIGN VENDOR PROFILE</b>	Bergen Sign Company
1. Company name and address (home office)	Bergen Sign Company: 4100 N. Powerline Rd. Suite L2 Pompano Beach, FL 33073 Ph: (954) 957-9961
1a. AKA	BSC Sign: 4100 N. Powerline Rd. Suite L2 Pompano Beach, FL 33073 Ph: (954) 957-9961
(primary contact information)	Rich Walker
2. Ownership (public/private)	Private
3. Yrs in business	102, Established: 1918 - Incorporated in 1994
4. Number of employees	29
5. Annual sales	6,000,000.00
<b>Manufacturing Plants</b>	
1. Location and Square footage	Pompano Beach, FL 20,000 sqft
2. Location and Square footage	Wayne, NJ 15,000 sqft
3. Location and Square footage	
4. Location and Square footage	
<b>2A. Mfg capabilities by plant (yes or no) - Plant Location</b>	Wayne, NJ
Embossed sign faces	yes
Distortion silk screening	yes
Cloud signs	yes
Channel letters	yes
LED Signage	yes
High rise and flex face	yes
Neon signs	yes
Fabric awnings	yes
Metal canopies and metal awnings	yes
exterior menuboard	yes
<b>2B. Mfg capabilities by plant (yes or no) - Plant Location</b>	Pompano Beach, FL
Embossed sign faces	yes
Distortion silk screening	yes
Cloud signs	yes
Channel letters	yes
LED Signage	yes
High rise and flex face	yes
Neon signs	yes
Fabric awnings	yes
Metal canopies and metal awnings	yes
exterior menuboard	yes
<b>2C. Mfg capabilities by plant (yes or no) - Plant Location</b>	
1. Embossed sign faces	
2. Distortion silk screening	
3. Cloud signs	
4. Channel letters	
LED Signage	
5. High rise and flex face	
6. Neon signs	
7. Fabric awnings	
8. Metal canopies and metal awnings	
9. Exterior menuboard	
(add additional plants if necessary)	



# EXECUTIVE SUMMARY - QUALIFICATION AND EXPERIENCE

<b>Warranty Information</b>	
Standard warranty info (may be sent as a separate attachment)	2 years Exception to be made per bid terms
<b>Engineering and design resources</b>	
1. In house engineering/design equipment	yes
2. Engineering staff resources	yes
3. Design staff resources	yes
<b>Project management capabilities</b>	
1. Staff resources dedicated to total project management (site survey to installation)	yes
2. Staff resources dedicated to national accounts	yes
3. Are nat acct personnel dedicated to nat acct only?	no
4. On line project/site management capabilities	yes
5. On line product catalog available for nat accounts ?	yes
<b>Installation</b>	
1. Nationwide installation capabilities	yes
2. Ability to provide national installation pricing	yes
3. National install projects completed in last 3 Yrs.	Aeropostale, Phillip VanHeusen
Number of locations	55, 10
Number of states	30, Puerto Rico, Mexico and Canada
<b>Current National Account references</b>	
(Including annual volume - if you do not feel free to give out this information - let us know the annual volume for your largest single customer)	Aeropotale 600,000
<b>Liability Coverage (list current limits of liability ins cov)</b>	
<b>Financial Information Available</b>	
(Indicate or attach appropriate financial data)	

---

## *EXECUTIVE SUMMARY - OUR PROCEDURES*

---

### OUR PROCEDURES

Upon the award of a project we have a meeting between our estimator, who has familiarized themselves with the project through the bid process, project manager, graphic designer, production manager, foreman, and COO. The estimator will pass on the information obtained to the project team so they can make an informed decision on how to proceed with the job. Ideally we would first like to set up a meeting with the client either by phone, video, or in person, depending on the project, then dispatch our survey team to take field measurements, photos, and gather any pertinent information necessary for the completion of the project. Being a local company we have an advantage; that is the ability make multiple trips, as necessary, without affecting our overhead. After our field team compiles all the necessary information, we then have another team meeting to go over said information. This meeting will also include our permit expert as they will then research the city/county sign code to access what is allowed. This particular meeting is focused on clearly relaying all information to our designer as the next step will be shop drawings. The shop drawing process is so critical, as it is the foundation from which the project will be build on. This is why we have daily check ins. To elevate any chance of mis-communication these daily check ins will be modified to include only key personal in our Pompano Beach Location, and will consist of our Senior Graphic Designer Margie Cardedas, Our Production Manager Jesus Duran, and our COO Richard Walker. After shop drawings are approved by the client the next step is to engineer and permit all required signage. As the permit approval process can take some time, we use this time to prepare everything needed for fabrication. This includes another team meeting to clearly communicate any changes that may have occurred since the last meeting, ordering material, matching project colors, and creating work orders. Once the city approves our drawings we can officially start fabrication. The fabrication process is overseen be our COO who, at this point knows everything about the project. Since we are located so close to the locations we have the unique opportunity to start installation early if needed.

### COORDINATION AND COMMUNICATION

Our team will be available to discuss the project at the clients convenience. You will receive project updated at a level you are comfortable with. They can be via email or phone and can range from bi-weekly to daily if you choose. These meetings can be done in person, via video conference, or phone, depending on the clients discretion and availability. We strive to create beautiful signage while offering quality communication and service to our clients.

---

## EXECUTIVE SUMMARY - ORGANIZATIONAL STRUCTURE

---

### ORGANIZATIONAL STRUCTURE

It is the Policy of the BSC that all projects be planned and implemented with the highest regard for quality. Implementation should be based on an effective QMS with defined quality goals and objectives; specified quality-related activities and indicators; assigned responsibilities for ensuring that the activities are conducted and that quality-related objectives are met.

BSC and its Consultants and Contractors shall be organized in such a manner that quality is achieved and maintained by those who have responsibility for the performance of the work. Quality achievement is verified by persons or organizations not directly responsible for the performance of the work.

The Production Manager or designated individuals, e.g., Consultants, and assigned Inspectors, shall be responsible for verifying compliance with this QMSP. The composition of the management structure for each Consultant and Contractor performing work for BSC shall be the responsibility of that organization. The management structure shall be project/task-specific and comply with BSC requirements, as described herein.

1.4.4 Consultants and Contractors shall prepare project- or task-specific QMPs which shall comply with and be traceable to BSC's QMSP.

The organization's quality staff performing verification functions shall report to a level of management that provides sufficient authority and organizational freedom to assure that appropriate action is taken to resolve conditions that may adversely affect the quality. For construction contracts within the rail corridor, in amounts of ten million dollars and above; or, twenty million dollars and above if outside the rail corridor; a QMP Manager shall be at the project site on a full-time basis throughout the duration of the contract and shall have no responsibilities other than those required by this QMSP. Depending on the nature and complexity of the work to be performed under the contract and/or for instances of nonconforming work, BSC's COO may require the Contractor's QMP Manager to be at the project site on a full-time basis for contracts in amounts less than ten or twenty million dollars, respectively. The adequacy and effectiveness of QMS programs shall be regularly and formally assessed by the management of the organizations implementing the quality programs and by BSC. Assessments shall be at least annually, if not otherwise specified.

The BSC Organizational Chart shows the reporting relationships of BSC Directors and of the Production Manager. The Organizational Chart shows the reporting relationships of Department staff. The responsibilities for quality and interrelationships of the staff are delineated in each section of this QMSP. Each BSC staff member has responsibility for overseeing the quality of a Consultant's and Contractor's work, as applicable and managing the quality of his/her own work in accordance with this QMSP and other BSC Policies, Plans, and Procedures specific to his/her department. In some instances, this oversight function may also be performed by Consultants to the BSC. The BSC COO is the principal advocate for improvements to service, safety, customer satisfaction, and operations. In this role, the COO is the champion for continuous quality improvement and for all BSC Quality Assurance activities. The COO is committed to developing, implementing and maintaining a formal QMSP that ensures the highest standards of performance, safety, and reliability, and that it is understood, implemented and updated. Under the COO's direction, there will be agenda items for quality-related discussions in the Senior Managers meetings at least twice a year. These quality-related discussions will serve as the Management Review of BSC's QMS.

---

## *EXECUTIVE SUMMARY - ORGANIZATIONAL STRUCTURE*

---

The Production Manager, who reports to the COO is responsible for the administration of the QMSP. These activities shall include, but are not limited to:

- Assuring that the QMSP is established, implemented, maintained, and promulgated.
- Prepare semi-annual reports that discuss the adequacy and implementation of the QMSP.
- Providing reviews on contracts during design, award, and contract/ project execution to ensure inclusion of quality standards and requirements.
- Evaluating of supplier performance levels and quality capabilities through the surveillance, inspection, and auditing of quality systems.
- Providing QMSP training to appropriate BSC staff, Consultants and Contractors who perform activities that affect the quality of BSC projects.
- Monitoring and evaluating quality program implementation, adequacy, and effectiveness through quality surveillance and quality Compliance reviews.
- Assuring that the QMSP is available to all employees via the BSC intranet.

Under the Production Manager supervision, other BSC personnel and QA Contractors and Consultants may be assigned to assist in enforcing established controls to ensure compliance to this QMSP, federal, state and local quality standards, codes, regulations, rules and/or specifications. These individuals shall utilize technical expertise along with established quality criteria to evaluate the design, construction, maintenance, procurement and fabrication activities in order to implement and maintain a comprehensive and functional quality assurance and quality management plan.

---

## QUALIFICATION OF EXPERIENCE - KEY STAFF

---

### CONTACT



(973) 742-7755 x 210



toms@bergensign.com



Wayne, NJ



www.bergensign.com

### EDUCATION

#### RUTGERS UNIVERSITY

B.S. Administration of Justice  
1991-1995

Dedicated Time: 3%

### THOMAS SCHNEIDER: PRESIDENT & CEO

Thomas Schneider is responsible for national sales and business development. He is a Rutgers Graduate and has been involved in the sign industry for over 35 years. In 1994, Tom became president when he and his partner purchased the company. Tom heads the sales department and is responsible for initial customer contacts, follow up, creative design, business development, and long-term marketing expansion.

### EXPERIENCE

BERGEN SIGN COMPANY, 1995 - PRES  
President & CEO

### PROJECT REFERENCES

American Dream Mall - All Signage  
UBS  
NJ Transit  
Valeant  
Valley National BankWawa  
Columbia Bank  
The Mall at Short Hills  
Spencer Savings Bank  
Metropolitan Center

### CONTACT



(973) 742-7755 x 100



richw@bergensign.com



Pompano Beach, FL



www.bergensign.com

### EDUCATION

#### RUTGERS UNIVERSITY

B.S. Administration of Justice  
1991-1995

Dedicated Time: 2%

### RICHARD WALKER: COO

Rich is Rutgers graduate and has been in the sign industry for over 25 years. He is responsible for overseeing and taking care of scheduling, estimating, purchasing, monetary transactions, and all operations. Rich is also in charge of the production and deals directly with our project managers, sales staff, and department supervisors.

### EXPERIENCE

BERGEN SIGN COMPANY, 1995 - PRES  
COO

### PROJECT REFERENCES

FSU - DLT Civic Center  
Brandsmart USA  
Yankees Stadium  
FAU  
Madison Square Garden  
Rowan UniversityAeropostale  
St. Joseph's Medical Center  
Ashley Furniture  
PSEG  
SUEZ  
Albuquerque Convention Center

---

## QUALIFICATION OF EXPERIENCE - KEY STAFF

---

### CONTACT

---

 (973) 742-7755 x 204  
 kpressler@bergensign.com  
 Wayne, NJ  
 www.bergensign.com

### EDUCATION

---

Union County College  
AMA Certification, Human Resources  
2009-2010

University of Phoenix  
Bachelor of Science, Business Management,  
2009-2012

### ACCOLADES

---

National Notary Association

Human Resource Management

---

Dedicated Time: 10%

### KYRA PRESSLER: INSTALLATION & OPERATIONS MANAGER

---

Seasoned, results-oriented Operational Management Professional with extensive experience in building and retaining exceptional teams. Well-versed in all aspects of staffing, project management, contract negotiation and training. Proven ability to partner with management to develop and maintain policies and procedures from scratch, contain costs and maximize profits. Demonstrated ability to delegate work and manage all operational functions for both small and large organizations. Exceptional skills include leadership, management, organizational development and process improvements.

### EXPERIENCE

---

BERGEN SIGN COMPANY, 2014 - PRESENT  
Installation & Operations Manager

- Organize, plan, and manage resources to complete large scale projects on time and within budget parameters.
- Oversee the project schedule, allocation of personnel, materials, and equipment.
- Project execution, construction, monitoring and completion.
- Labor and resource management.
- Support information flow, management and client reporting, business processes, and organizational planning.
- Maintain productive and positive relationships with customer base, general contractors and vendors.

AMERICAN SIGN AND BILLBOARD, 2010-2014  
Operations and Business Development

- Improve the operational systems, processes and policies in support of organizations mission; specifically, support better management reporting, information flow and management, business process and organizational planning.
- Play a significant role in long-term planning, including an initiative geared toward operational excellence.
- Oversee overall financial management, planning, systems and controls. Develop, maintain and monitor all accounting systems and procedures capturing all billings and receipts and for the recording of all revenue transactions, recommend and implement improvements to systems. Increase revenue while reducing expenditures.

### PROJECT REFERENCES

---

Metlife Stadium  
Brandsmart USA  
Simon Properties  
Johnny Rockets

Tiffany & Co  
Brunswick Square  
Aldi  
Big Lots!



---

## QUALIFICATION OF EXPERIENCE - KEY STAFF

---

### CONTACT



(973) 742-7755 x 113



rmurphy@bergensign.com



Pompano Beach, FL



www.bergensign.com

### EDUCATION

KEAN UNIVERSITY  
B.F.A. GRAPHIC DESIGN  
2010-2014

Dedicated Time: 5%

### RYAN MURPHY: PROJECT MANAGER

Ryan attended Kean University where he studied Graphic design. Being interested in the fabrication side of design he found himself working for Bergen Sign in 2015, and quickly demonstrated the ability to manage multiple projects simultaneously and efficiently. With extensive knowledge pertaining to ADA compliant and interior signage, Ryan has been a great help to over the past 7 years and responsibilities include Project Management, Estimating, Interior sign design, and ADA compliant conversion.

### EXPERIENCE

BERGEN SIGN COMPANY, 2015 - PRESENT  
Project Manager

### PROJECT REFERENCES

Fedex

Allegro Senior Living

JFK Medical Center

Camden Tower

NFI

21 South Street

Miami Dade College

YMCA

### CONTACT



(973) 742-7755



Wayne, NJ



www.bergensign.com

Dedicated Time: 10%

### ROBERT RYAN: SHOP FOREMAN

Bobby has been building signs for over 40 years. He previously owned his own company and has now been working at Bergen Sign for the last 10 years. His knowledge is endless and his creativity and manufacturing abilities make Bobby the natural leader of our shop.

### PROJECT REFERENCES

FSU - DLT Civic Center

Brandsmart USA

Yankees Stadium

FAU

Madison Square Garden

Aeropostale

St. Joseph's Medical Center

Ashley Furniture

PSEG

SUEZ

### CONTACT



(973) 742-7755



Wayne, NJ



www.bergensign.com

Dedicated Time: 10%

### ALEX DELEON: INSTALLATION FOREMAN

Having worked over 25 years in the sign business there is no one with more skill and ability than Alex. He has worked at Bergen Sign for the last 15 years and lends his expertise and experience to our installations to ensure they are completed not only to our customer's satisfaction but safely.

### PROJECT REFERENCES

American Dream Mall - All Signage

UBS

NJ Transit

Valeant

Wawa

Columbia Bank

The Mall at Short Hills

Spemcer Savings Bank

---

*QUALIFICATION OF EXPERIENCE - PROJECT REFERENCES*

---

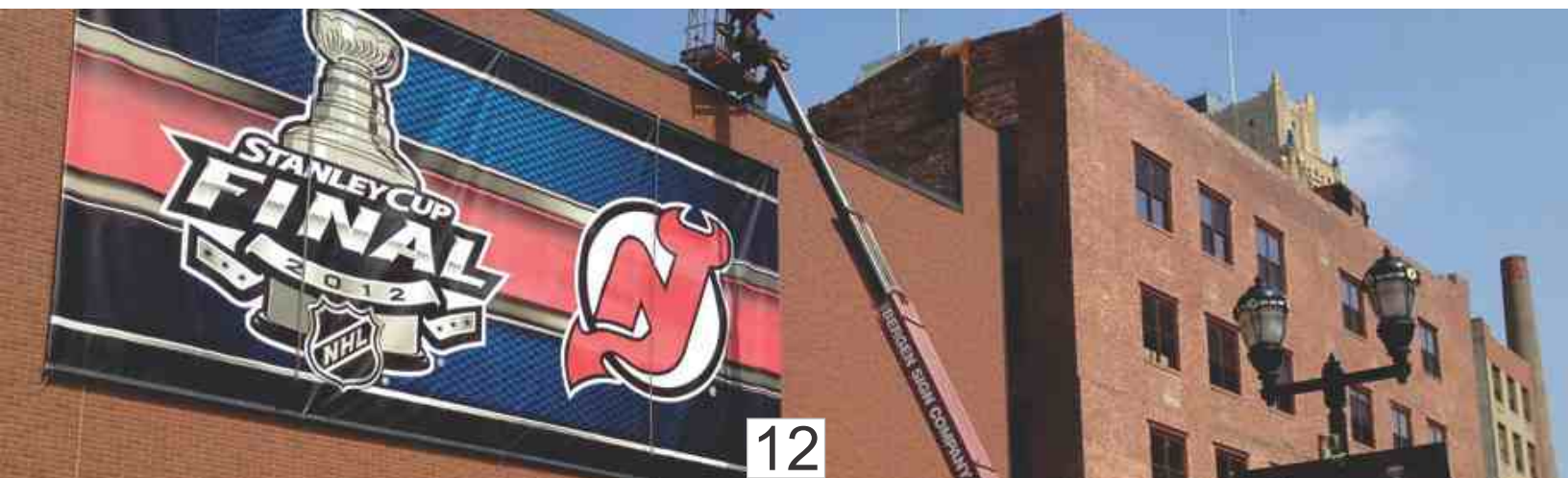



# Metlife Stadium

## Project Value

**\$1,000,000**

## Project Location

**East Rutherford, NJ**

## Project Date

**Ongoing**

## Project Duration

**5 Years**

# METLIFE - DRAWING EXAMPLE

## BUD LIGHT - METLIFE STADIUM

These designs are the original works of Bergen Sign Company, Inc. and are intended for your personal use in connection with the project we are working on for you. They are not to be copied, reproduced or exhibited to anyone outside your organization without the express written consent of Bergen Sign Company, Inc.

### LOADING DOCK AREA SIGNAGE INTERIOR CONCESSION SIGNAGE A



INTERNALLY ILLUMINATED SINGLE SIDED CABINET SIGN  
FEATURING A 0.75" ACRYLIC PUSH THRU LETTERING

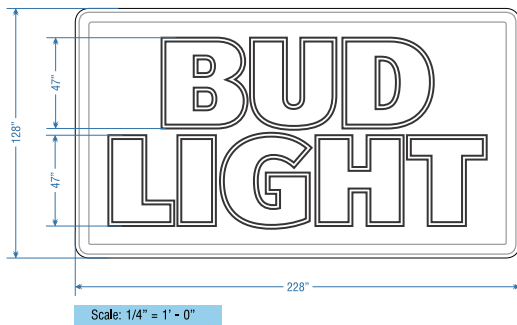

#### SCOPE OF WORK INCLUDE:

Remove existing sign and patch and paint as necessary to match blue PMS 293.  
Bud Light letters and Racetrack (outline of logo) to be 0.75" push thru acrylic copy.  
Background panel of sign is non illuminated.  
Final appearance of sign should mimic an old fashioned neon sign as it glows white.

#### COLOR REFERENCE

LIGHT BLUE  
PMS 2193C  
CMYK: 100C 12M 0Y 0K

MEDIUM BLUE  
PMS 293C  
CMYK: 100C, 65M, 8K

WHITE  
SATIN



Picture not into scale just for positioning

Proposed installation location

## BERGEN SIGN COMPANY

161 East Railway Avenue,  
Paterson, NJ 07503  
973.742.7755 Fax: 742.0598

4100 North Powerline Road Suite L-2  
Pompano Beach, FL 33073  
954.957.9961 Fax: 954.957.9014  
[www.bergenesign.com](http://www.bergenesign.com)

#### Work Order:

Client  
**BUD LIGHT  
METLIFE STADIUM**

Project Address  
1 MetLife Stadium Drive,  
East Rutherford, NJ 07073

Customer Approval

Signature

Approval Date

NOTE TO CUSTOMER: Please be sure that all the information on this drawing is correct. Your product will be manufactured based on the above drawings. No revision after fabrication has commenced will be made to the customer. If there are any questions as to color size or placement, please call the store to clarify them. You are entitled to two (2) revision free of charge, additional revisions will be charged as a 100 dollar labor charge. Due to the different personnel parts orders & other materials, please allow for our normal lead times.

ALL ELECTRIC SIGNS ARE  
UL LISTED AND LABELED

Engineer Information:

Engineer Seal

ENGINEER COMMENT:  
Design, Fabrication & Construction Shall  
Confirm To State & City Codes

Drawing By: Margie  
Bud Light - MetLife Stadium

Date: 04/11/2016

Sheet: 15

## BUD LIGHT - METLIFE STADIUM

These designs are the original works of Bergen Sign Company, Inc. and are intended for your personal use in connection with the project we are working on for you. They are not to be copied, reproduced or exhibited to anyone outside your organization without the express written consent of Bergen Sign Company, Inc.

### INTERIOR CONCESSION SIGNAGE A

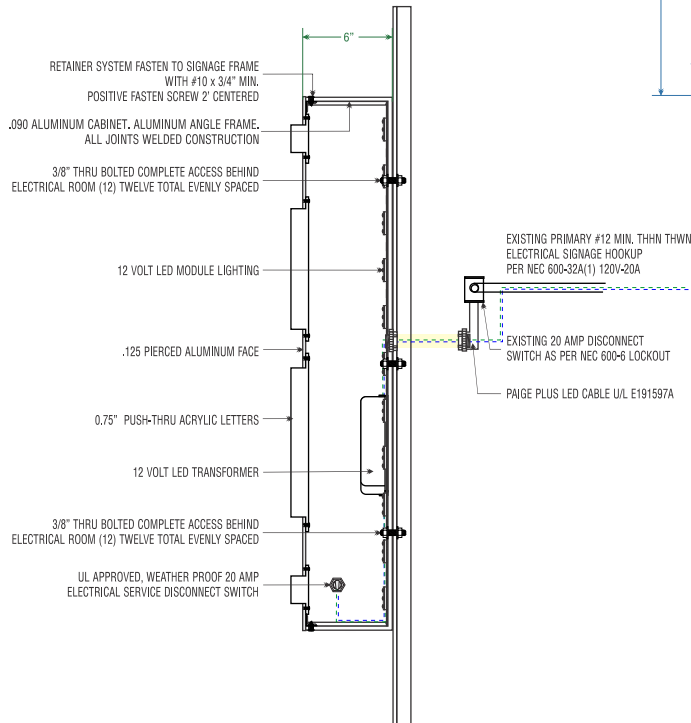

INTERNALLY ILLUMINATED SINGLE SIDED CABINET SIGN  
FEATURING A 0.75" ACRYLIC PUSH THRU LETTERING

## BERGEN SIGN COMPANY

161 East Railway Avenue,  
Paterson, NJ 07503  
973.742.7755 Fax: 742.0598

4100 North Powerline Road Suite L-2  
Pompano Beach, FL 33073  
954.957.9961 Fax: 954.957.9014  
[www.bergenesign.com](http://www.bergenesign.com)

#### Work Order:

Client  
**BUD LIGHT  
METLIFE STADIUM**

Project Address  
1 MetLife Stadium Drive,  
East Rutherford, NJ 07073

Customer Approval

Signature

Approval Date

NOTE TO CUSTOMER: Please be sure that all the information on this drawing is correct. Your product will be manufactured based on the above drawings. No revision after fabrication has commenced will be made to the customer. If there are any questions as to color size or placement, please call the store to clarify them. You are entitled to two (2) revision free of charge, additional revisions will be charged as a 100 dollar labor charge. Due to the different personnel parts orders & other materials, please allow for our normal lead times.

ALL ELECTRIC SIGNS ARE  
UL LISTED AND LABELED

Engineer Information:

Engineer Seal

ENGINEER COMMENT:  
Design, Fabrication & Construction Shall  
Confirm To State & City Codes

Drawing By: Margie  
Bud Light - MetLife Stadium

Date: 04/11/2016

Sheet: 16

## METLIFE - COMPLETION PHOTOS

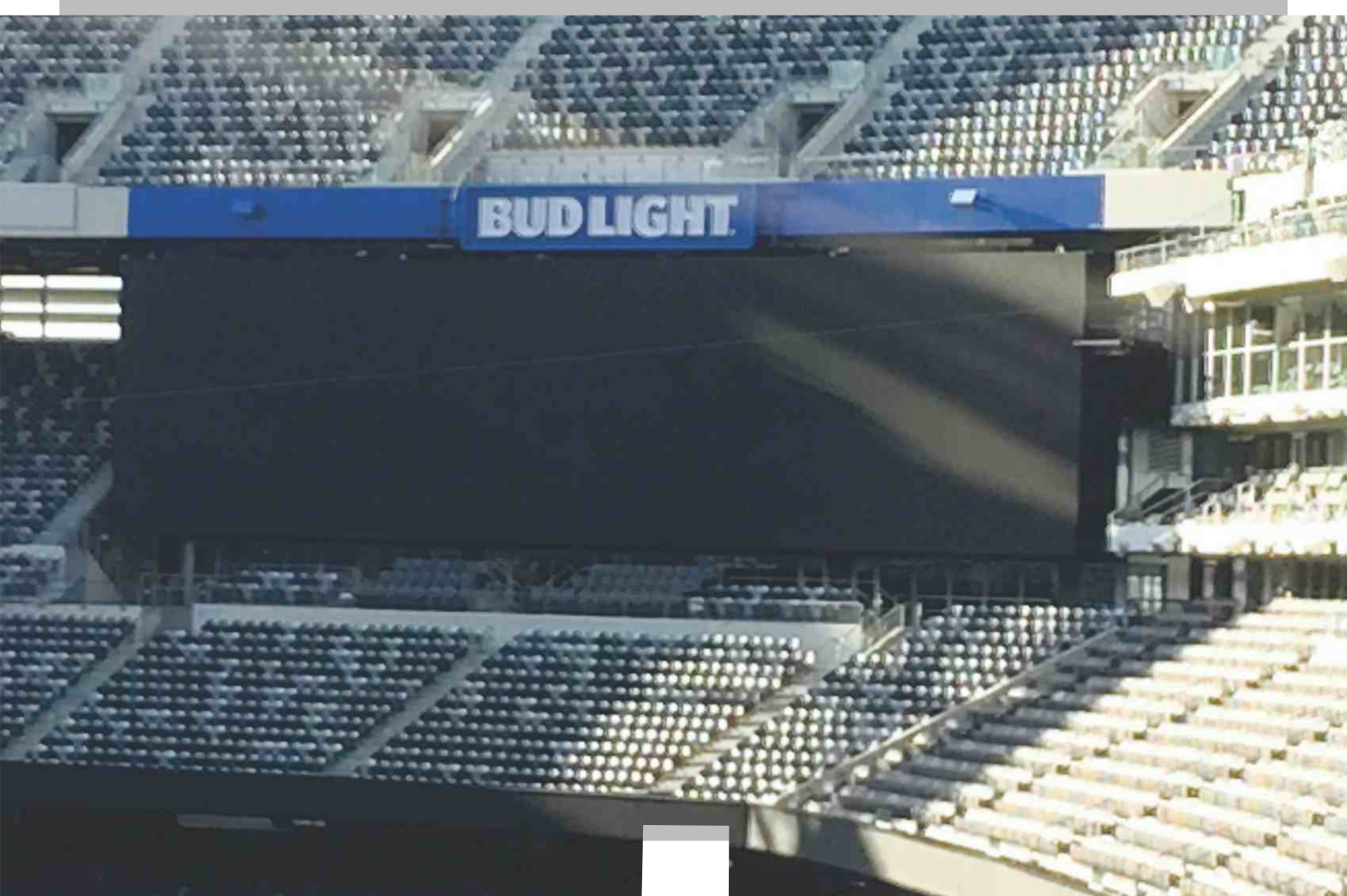



# METLIFE - COMPLETION PHOTOS

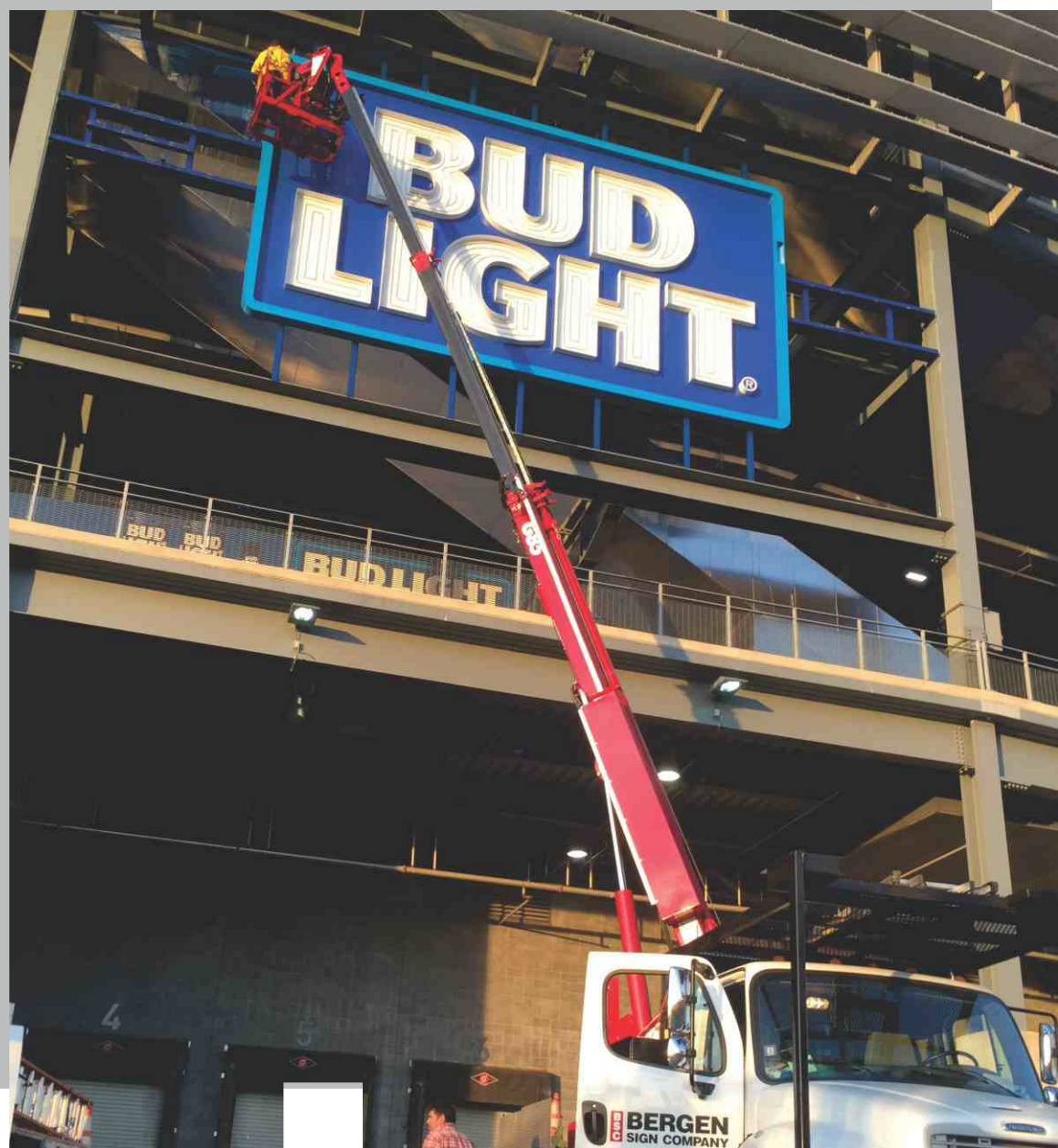
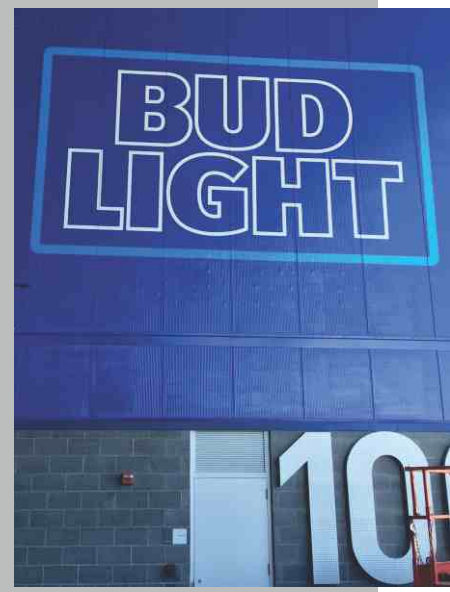

# Florida State University

## Project Value

**\$350,000**

## Project Location

**Tallahassee, FL**

## Project Date

**August, 2017**

## Project Duration

**6 Months**

# FSU - DRAWING EXAMPLE

## DOAK CAMPBELL STADIUM - SOUTH END ZONE - FSU

These designs are the original works of Bergen Sign Company, Inc. and are intended for your personal use in connection with the project we are working on for you. They are not to be copied, reproduced or exhibited to anyone outside your organization without the express written consent of Bergen Sign Company, Inc.

### SOUTH END ZONE - VIDEO DISPLAY HEADER SIGNAGE

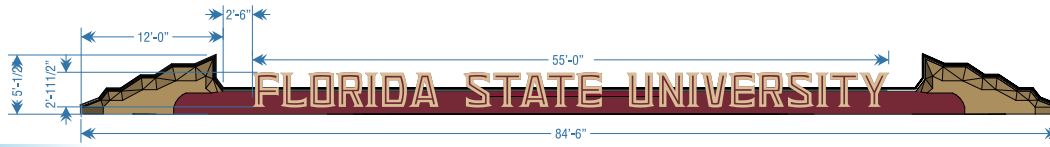

Scale: 1/8" = 1' - 0"

# FLORIDA STATE UNIVERSITY

INDIVIDUALLY ILLUMINATED PLEX FACE CHANNEL LETTERS

# FLORIDA STATE UNIVERSITY

Scale: 3/16" = 1' - 0"

55'-0"

Square footage: 1952.5

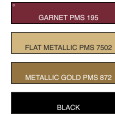

Face: Beige PMS 7502  
Returns: Black semigloss  
Trim cap: Black  
LEDs: White  
Letter Height: 35.5"  
Letter depth: 8"  
Letter Style: Logotype  
Proposed Sq. ft: 1952.5

## BERGEN SIGN COMPANY

161 East Railway Avenue,  
Paterson, NJ 07503  
973.742.7755 Fax: 973.742.0598

4100 North Powerline Road Suite L-2  
Pompano Beach, FL 33073  
954.957.9961 Fax: 954.957.9014  
[www.bergensign.com](http://www.bergensign.com)

Work Order:

Client  
**DOAK CAMPBELL STADIUM**  
FLORIDA STATE UNIVERSITY

Project Address  
1 Champions Way,  
Tallahassee, FL 32304

Customer Approval

Signature

Approval Date

NOTE TO CUSTOMER: Please be sure that all the information on this drawing is correct. Your project will be constructed based on the information provided. Any revisions after fabrication will be charged to the customer. If there are any changes to the design, please contact us immediately. We are not responsible for any errors or omissions. We are not responsible for any damage to the project or any other materials. Please contact us for more information.

ALL ELECTRIC SIGNS ARE UL LISTED AND LABELED

Engineer Information:

Engineer Seal

### ENGINEER COMMENT:

Design, Fabrication & Construction Shall Conform to State & City Codes

Drawing By: Margie

Doak C. S. - South Endzone

Date: 09/22/2016

Sheet: 05

## DOAK CAMPBELL STADIUM - SOUTH END ZONE - FSU

These designs are the original works of Bergen Sign Company, Inc. and are intended for your personal use in connection with the project we are working on for you. They are not to be copied, reproduced or exhibited to anyone outside your organization without the express written consent of Bergen Sign Company, Inc.

### SOUTH END ZONE - VIDEO DISPLAY HEADER SIGNAGE

#### CHANNEL LETTERS STRUCTURAL DETAIL

#### INDIVIDUALLY ILLUMINATED PLEX FACE CHANNEL LETTERS

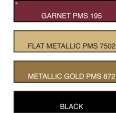

Face: Beige PMS 7502  
Returns: Black semigloss  
Trim cap: Black  
LEDs: White  
Letter Height: 56"  
Letter depth: 8"  
Letter Style: Logotype  
Proposed Sq. ft: 416.11

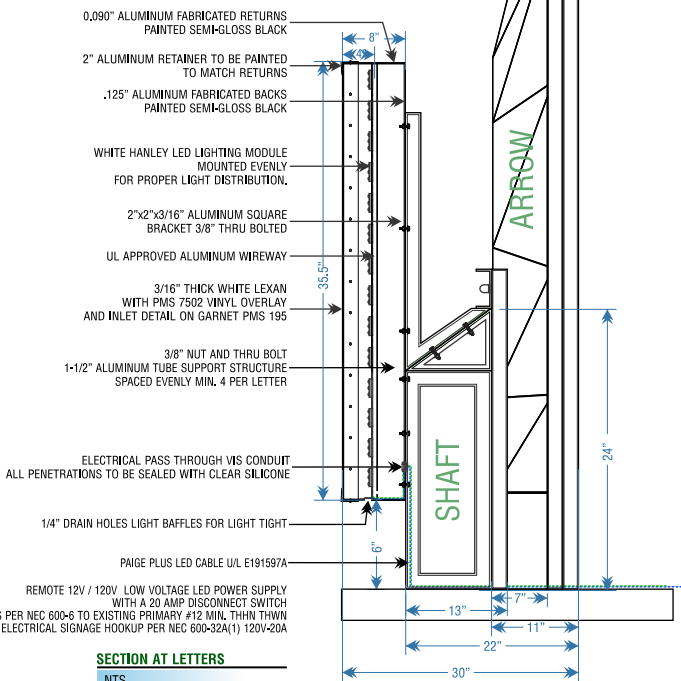

#### SECTION AT LETTERS

NTS

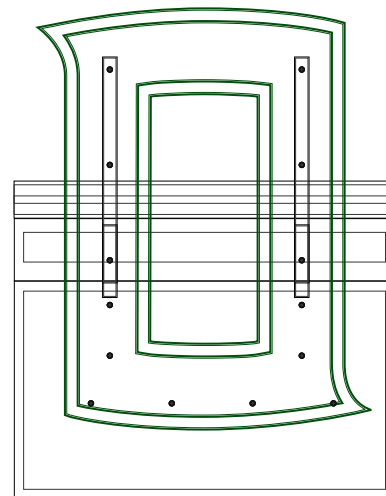

#### FRONT VIEW AT LETTERS

Scale: 1-1/2" = 1' - 0"

## BERGEN SIGN COMPANY

161 East Railway Avenue,  
Paterson, NJ 07503  
973.742.7755 Fax: 973.742.0598

4100 North Powerline Road Suite L-2  
Pompano Beach, FL 33073  
954.957.9961 Fax: 954.957.9014  
[www.bergensign.com](http://www.bergensign.com)

Work Order:

Client  
**DOAK CAMPBELL STADIUM**  
FLORIDA STATE UNIVERSITY

Project Address  
1 Champions Way,  
Tallahassee, FL 32304

Customer Approval

Signature

Approval Date

NOTE TO CUSTOMER: Please be sure that all the information on this drawing is correct. Your project will be constructed based on the information provided. Any revisions after fabrication will be charged to the customer. If there are any changes to the design, please contact us immediately. We are not responsible for any errors or omissions. We are not responsible for any damage to the project or any other materials. Please contact us for more information.

ALL ELECTRIC SIGNS ARE UL LISTED AND LABELED

Engineer Information:

Engineer Seal

### ENGINEER COMMENT:

Design, Fabrication & Construction Shall Conform to State & City Codes

Drawing By: Margie

Doak C. S. - South Endzone

Date: 09/22/2016

Sheet: 06



## FSU - COMPLETION PHOTOS



# FSU - COMPLETION PHOTOS





# Columbia Bank

## Project Value

**\$1,000,000**

## Project Location

**NJ**

## Project Date

**January, 2018**

## Project Duration

**6 Months**



## COLUMBIA BANK - COMPLETION PHOTOS



This tax is levied for the privilege of doing business within Broward County and is non-regulatory in nature. You must meet all County and/or Municipality planning and zoning requirements. This Business Tax Receipt must be transferred when the business is sold, business name has changed or you have moved the business location. This receipt does not indicate that the business is legal or that it is in compliance with State or local laws and regulations.



# QUALIFICATION AND EXPERIENCE - ES LICENSE



Ron DeSantis, Governor

Melanie S. Griffin, Secretary



## STATE OF FLORIDA DEPARTMENT OF BUSINESS AND PROFESSIONAL REGULATION

### ELECTRICAL CONTRACTORS' LICENSING BOARD

THE SPECIALTY ELECTRICAL CONTRACTOR HEREIN IS CERTIFIED UNDER THE  
PROVISIONS OF CHAPTER 489, FLORIDA STATUTES

AS A SIGN ELECTRICAL SPECIALIST

**WALKER, RICHARD W**

BERGEN SIGN COMPANY, INC.  
4100 N POWERLINE RD L2  
POMPANO BEACH FL 33073

**LICENSE NUMBER: ES12001528**

**EXPIRATION DATE: AUGUST 31, 2024**

Always verify licenses online at [MyFloridaLicense.com](http://MyFloridaLicense.com)



Do not alter this document in any form.

This is your license. It is unlawful for anyone other than the licensee to use this document.

---

# QUALIFICATION AND EXPERIENCE - SUNBIZ

---



[Department of State](#) / [Division of Corporations](#) / [Search Records](#) / [Search by Entity Name](#) /

## Detail by Entity Name

Foreign Profit Corporation

BERGEN SIGN COMPANY, INC.

### Filing Information

**Document Number** F14000003555

**FEI/EIN Number** 22-3358637

**Date Filed** 08/21/2014

**State** NJ

**Status** ACTIVE

### Principal Address

90 Newark Pompton Turnpike  
Wayne, NJ 07470

Changed: 01/14/2020

### Mailing Address

90 Newark Pompton Turnpike  
Wayne, NJ 07470

Changed: 01/14/2020

### Registered Agent Name & Address

Walker, Richard  
4100 N. POWERLINE RD.  
STE. L-2  
POMPANO BEACH, FL 33073

Name Changed: 01/12/2018

### Officer/Director Detail

#### **Name & Address**

Title P

SCHNEIDER, THOMAS  
90 Newark Pompton Turnpike  
Wayne, NJ 07470

Title S

---

# QUALIFICATION AND EXPERIENCE - SUNBIZ

---

WALKER, RICHARD  
4100 N Powerline Rd  
L-2  
Pompano Beach, FL 33073

## Annual Reports

Report Year	Filed Date
2022	01/24/2022
2023	01/03/2023
2024	01/23/2024

## Document Images

<a href="#">01/23/2024 – ANNUAL REPORT</a>	<a href="#">View image in PDF format</a>
<a href="#">01/03/2023 – ANNUAL REPORT</a>	<a href="#">View image in PDF format</a>
<a href="#">01/24/2022 – ANNUAL REPORT</a>	<a href="#">View image in PDF format</a>
<a href="#">01/11/2021 – ANNUAL REPORT</a>	<a href="#">View image in PDF format</a>
<a href="#">01/14/2020 – ANNUAL REPORT</a>	<a href="#">View image in PDF format</a>
<a href="#">02/08/2019 – ANNUAL REPORT</a>	<a href="#">View image in PDF format</a>
<a href="#">01/12/2018 – ANNUAL REPORT</a>	<a href="#">View image in PDF format</a>
<a href="#">01/16/2017 – ANNUAL REPORT</a>	<a href="#">View image in PDF format</a>
<a href="#">03/08/2016 – ANNUAL REPORT</a>	<a href="#">View image in PDF format</a>
<a href="#">03/18/2015 – ANNUAL REPORT</a>	<a href="#">View image in PDF format</a>
<a href="#">08/21/2014 – Foreign Profit</a>	<a href="#">View image in PDF format</a>

# QUALIFICATION AND EXPERIENCE - CBE BROWARD



Governmental Center Annex

115 S. Andrews Avenue, Room A680 • Fort Lauderdale, Florida 33301 • 954-357-6400 • FAX 954-357-5674 • TTY 954-357-5664

## Office of Economic and Small Business Development

*This Certificate is Awarded to:*

**BERGEN SIGN COMPANY, INC.**

As set forth in the Broward County Business Opportunity Act of 2012, the certification requirements have been met for:

County Business Enterprise  
Anniversary Date: June 5<sup>th</sup>

A blue ink signature of an authorized representative, written over a horizontal line.

Authorized Representative

The Office of Economic and Small Business Development must be notified within 30 days of any material changes in the business which may affect ownership and control. Failure to do so may result in the revocation of this certificate and/or imposition of other sanctions.

A Service of the Broward County Board of County Commissioners  
[www.broward.org/smallbusiness](http://www.broward.org/smallbusiness)



# QUALIFICATION AND EXPERIENCE - W9

<b>Form W-9</b> (Rev. November 2017) Department of the Treasury Internal Revenue Service	<b>Request for Taxpayer Identification Number and Certification</b>		<b>Give Form to the requester. Do not send to the IRS.</b>
	▶ Go to <a href="http://www.irs.gov/FormW9">www.irs.gov/FormW9</a> for instructions and the latest information.		
Print or type. See Specific Instructions on page 3.	<b>1</b> Name (as shown on your income tax return). Name is required on this line; do not leave this line blank. Bergen Sign Company		
	<b>2</b> Business name/disregarded entity name, if different from above		
	<b>3</b> Check appropriate box for federal tax classification of the person whose name is entered on line 1. Check only one of the following seven boxes. <input type="checkbox"/> Individual/sole proprietor or single-member LLC <input type="checkbox"/> Limited liability company. Enter the tax classification (C=C corporation, S=S corporation, P=Partnership) ▶ <b>Note:</b> Check the appropriate box in the line above for the tax classification of the single-member owner. Do not check LLC if the LLC is classified as a single-member LLC that is disregarded from the owner unless the owner of the LLC is another LLC that is not disregarded from the owner for U.S. federal tax purposes. Otherwise, a single-member LLC that is disregarded from the owner should check the appropriate box for the tax classification of its owner. <input type="checkbox"/> Other (see instructions) ▶		<b>4</b> Exemptions (codes apply only to certain entities, not individuals; see instructions on page 3): Exempt payee code (if any) _____ Exemption from FATCA reporting code (if any) _____ <small>(Applies to accounts maintained outside the U.S.)</small>
	<b>5</b> Address (number, street, and apt. or suite no.) See instructions. 90 Newark Pompton Turnpike		Requester's name and address (optional)
	<b>6</b> City, state, and ZIP code Wayne Nj 07470		
	<b>7</b> List account number(s) here (optional)		

<b>Part I Taxpayer Identification Number (TIN)</b> Enter your TIN in the appropriate box. The TIN provided must match the name given on line 1 to avoid backup withholding. For individuals, this is generally your social security number (SSN). However, for a resident alien, sole proprietor, or disregarded entity, see the instructions for Part I, later. For other entities, it is your employer identification number (EIN). If you do not have a number, see <i>How to get a TIN</i> , later. <b>Note:</b> If the account is in more than one name, see the instructions for line 1. Also see <i>What Name and Number To Give the Requester</i> for guidelines on whose number to enter.	<b>Social security number</b> [ ][ ]-[ ][ ]-[ ][ ][ ][ ][ ][ ][ ] or <b>Employer identification number</b> 2 2 - 3 3 5 8 6 3 7
--	--

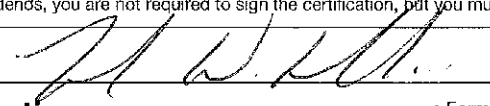
<b>Part II Certification</b> Under penalties of perjury, I certify that: 1. The number shown on this form is my correct taxpayer identification number (or I am waiting for a number to be issued to me); and 2. I am not subject to backup withholding because: (a) I am exempt from backup withholding, or (b) I have not been notified by the Internal Revenue Service (IRS) that I am subject to backup withholding as a result of a failure to report all interest or dividends, or (c) the IRS has notified me that I am no longer subject to backup withholding; and 3. I am a U.S. citizen or other U.S. person (defined below); and 4. The FATCA code(s) entered on this form (if any) indicating that I am exempt from FATCA reporting is correct. <b>Certification instructions.</b> You must cross out item 2 above if you have been notified by the IRS that you are currently subject to backup withholding because you have failed to report all interest and dividends on your tax return. For real estate transactions, item 2 does not apply. For mortgage interest paid, acquisition or abandonment of secured property, cancellation of debt, contributions to an individual retirement arrangement (IRA), and generally, payments other than interest and dividends, you are not required to sign the certification, but you must provide your correct TIN. See the instructions for Part II, later.	
<b>Sign Here</b> Signature of U.S. person ▶ 	Date ▶ _____

## General Instructions

Section references are to the Internal Revenue Code unless otherwise noted.

**Future developments.** For the latest information about developments related to Form W-9 and its instructions, such as legislation enacted after they were published, go to [www.irs.gov/FormW9](http://www.irs.gov/FormW9).

## Purpose of Form

An individual or entity (Form W-9 requester) who is required to file an information return with the IRS must obtain your correct taxpayer identification number (TIN) which may be your social security number (SSN), individual taxpayer identification number (ITIN), adoption taxpayer identification number (ATIN), or employer identification number (EIN), to report on an information return the amount paid to you, or other amount reportable on an information return. Examples of information returns include, but are not limited to, the following.

- Form 1099-INT (interest earned or paid)

- Form 1099-DIV (dividends, including those from stocks or mutual funds)
- Form 1099-MISC (various types of income, prizes, awards, or gross proceeds)
- Form 1099-B (stock or mutual fund sales and certain other transactions by brokers)
- Form 1099-S (proceeds from real estate transactions)
- Form 1099-K (merchant card and third party network transactions)
- Form 1098 (home mortgage interest), 1098-E (student loan interest), 1098-T (tuition)
- Form 1099-C (canceled debt)
- Form 1099-A (acquisition or abandonment of secured property)

Use Form W-9 only if you are a U.S. person (including a resident alien), to provide your correct TIN.

If you do not return Form W-9 to the requester with a TIN, you might be subject to backup withholding. See What is backup withholding, later.

---

*PROPOSED SCHEDULE*

---

# Hollywood Wayfinding

# Bergen Sign Company

## Project start:

## Display week:

Task	Assigned To	Progress	Start	End
Planning & design				
Shop Drawings	Margie Evans	0%	TBD	TBD
Engineering	John Orlando	0%	TBD	TBD
Permitting				
Permits	Regina	0%	TBD	TBD
Fabrication				
Fabricate Structure	Bobby Ryan	0%	TBD	TBD
Paint Prep	Vinny/Charles	0%	TBD	TBD
Paint Signage	Jose	0%	TBD	TBD
Vinyl/GraphicS	Angelo Ponce	0%	TBD	TBD
Installation				
Repairs	Gokce Aslan	0%	TBD	TBD
Removals	Hayden Cook	0%	TBD	TBD
New Installation	Jens Martensso	0%	TBD	TBD
Inspections				
Inspections	Gokce Aslan	0%	TBD	TBD

[illegible]



BERGEN SIGN COMPANY, INC.  
ESTIMATING DEPARTMENT  
4100 N. POWERLINE RD., SUITE L2  
POMPANO BEACH. FL 33073

---

## *SIMILAR PROJECT EXPERIENCE*

---

---

## *SIMILAR WORK: EXAMPLE #1*

---

# **BRIC**

## **Project Value**

**\$700,000**

## **Project Location**

**Boca, FL**

## **Project Date**

**Feburary, 2023**

## **Project Duration**

**6 Months**

## **Description**

**New Signage**

## **Contact**

Contact Name: Handiurso

Email Address: [hgursoy@cpgcre.com](mailto:hgursoy@cpgcre.com)

## **Project Duration**

**6 Months**

---

## SIMILAR WORK: EXAMPLE #1

---

# BRIC





## SIMILAR WORK: EXAMPLE #1

# BRIC

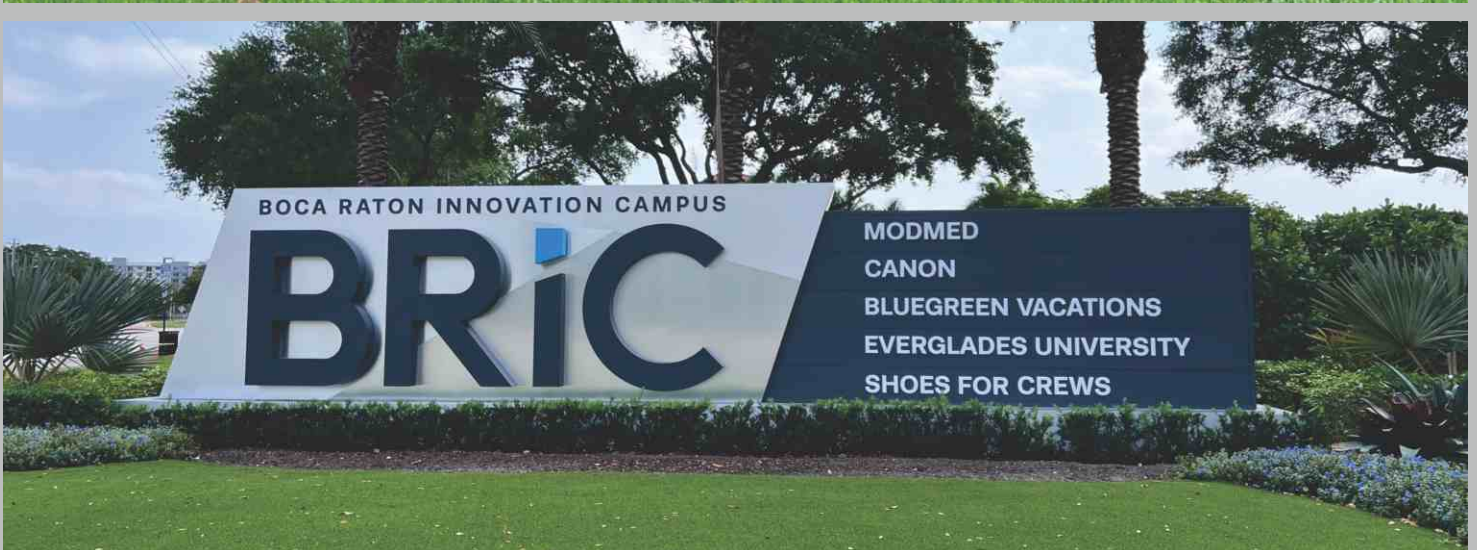

---

*SIMILAR WORK: EXAMPLE #2*

---

# Rutgers University

## Project Value

**\$800,000**

## Project Location

**New Brunswick, NJ**

## Project Date

**June, 2016**

## Project Duration

**6 Months**



## SIMILAR WORK: EXAMPLE #2





## SIMILAR WORK: EXAMPLE #3





## SIMILAR WORK: EXAMPLE #4





---

## CLIENT REFERENCE LIST

---

### Reference - #1

Customer Name: Aeropostale  
Street Address: 125 Chubb Avenue 5th Floor  
City, State, Zip: Lyndhurst, NJ 07071  
Contact Name: Rob Ruscher  
Email Address: [rruscher@aeropostale.com](mailto:rruscher@aeropostale.com)  
Phone/Cell: 201-508-5562  
Contract Dates: Ongoing  
Contract Dates: Ongoing  
- National sign change, we worked hard to meet some tight deadlines and this shows our ability to work with the demands of our clients.

### Reference - #3

Customer Name: Columbia Bank  
Street Address: 19-01 Route 208 North  
City, State, Zip: Fairlawn, NJ 07410  
Contact Name: Drew Yocum  
Email Address: [dyocum@columbiabankonline.com](mailto:dyocum@columbiabankonline.com)  
Phone/Cell: (551) 201-2575  
Contract Dates: Ongoing  
- National sign change, once again we worked hard to meet some tight deadlines and this shows our ability to work with the demands of our clients.

### Reference - #5

Customer Name: MetLife Stadium  
Street Address: 102 Route 120  
City, State, Zip: East Rutherford, NJ 07073  
Contact Name: Matt Duggan  
Email Address: [mdugan@metlifestadium.com](mailto:mdugan@metlifestadium.com)  
Phone/Cell: 201-559-1606  
Contract Dates: Ongoing  
- We have worked with Metlife Stadium for a long time and continue to deliver quality signage.

### Reference - #2

Customer Name: Suez  
Street Address: 461 From Road – Suite 400  
City, State, Zip: Paramus, NJ 07646  
Contact Name: Dawn Stephans  
Email Address: [Dawn.Stephans@suez-na.com](mailto:Dawn.Stephans@suez-na.com)  
Phone/Cell: 201 767 2809  
Contract Dates: Ongoing  
- We had the opportunity to fabricate and install a variety of signage, across the nation, including wayfinding.

### Reference - #4

Customer Name: Whiting Turner  
Street Address: 1140 Route 22 East, Suite 301  
City, State, Zip: Bridgewater, NJ 08807  
Contact Name: Kyle Freeburg  
Email Address: [kfreeburg@tcco.com](mailto:kfreeburg@tcco.com)  
Phone/Cell: 321.689.4101  
Contract Dates: 6/2016-10/2016  
- We worked on a number of different projects for the General Contractor Whiting Turner. The relationship we've built and will continue to build shows our ability to satisfy the needs of out clients..

## VENDOR REFERENCE FORM

City of Hollywood Solicitation #: RFP-174-24-GJ  
 Reference for: Bergen Sign Company

Organization/Firm Name providing reference: CP GROUP - BOCA RATON INNOVATION CAMPUS

Organization/Firm Contact Title:  
 Name: Hamdi Gursoy  
 Email: hgursoy@cpgrpcre.com Phone: 561-362-3474  
 Name of Referenced Project: Various Projects Contract No: \_\_\_\_\_  
 Date Services were provided: 1/1/2021 to Present Project Amount: 1,000,000.00 +  
 Referenced Vendor's role in Project: ☒ Prime Vendor ☐ Subcontractor/  
 Subconsultant  
 Would you use the Vendor again? ☒ Yes ☐ No. Please specify in additional comments

Description of services provided by Vendor (provide additional sheet if necessary):

Various sign work for wayfinding projects throughout the Boca Raton Innovation Campus

Please rate your experience with the Vendor	Need Improvement	Satisfactory	Excellent	Not Applicable
<b>Vendor's Quality of Service</b>				
a. Responsive	<input type="checkbox"/>	<input type="checkbox"/>	<input checked="" type="checkbox"/>	<input type="checkbox"/>
b. Accuracy	<input type="checkbox"/>	<input type="checkbox"/>	<input checked="" type="checkbox"/>	<input type="checkbox"/>
c. Deliverables	<input type="checkbox"/>	<input type="checkbox"/>	<input checked="" type="checkbox"/>	<input type="checkbox"/>
<b>Vendor's Organization:</b>				
a. Staff expertise	<input type="checkbox"/>	<input type="checkbox"/>	<input checked="" type="checkbox"/>	<input type="checkbox"/>
b. Professionalism	<input type="checkbox"/>	<input type="checkbox"/>	<input checked="" type="checkbox"/>	<input type="checkbox"/>
c. Staff turnover	<input type="checkbox"/>	<input type="checkbox"/>	<input checked="" type="checkbox"/>	<input type="checkbox"/>
<b>Timeliness/Cost Control of:</b>				
a. Project	<input type="checkbox"/>	<input type="checkbox"/>	<input checked="" type="checkbox"/>	<input type="checkbox"/>
b. Deliverables	<input type="checkbox"/>	<input type="checkbox"/>	<input checked="" type="checkbox"/>	<input type="checkbox"/>

Additional Comments (provide additional sheet if necessary):

Was very happy to work with Bergen Signs with our multiple sign projects in the last 2+ years.  
Will not hesitate to hire Bergen for our future projects.

**\*\*\*\*THIS SECTION FOR CITY USE ONLY\*\*\*\***

Verified via:	Email:	<input type="checkbox"/>	Verbal:	<input type="checkbox"/>	Mail:	<input type="checkbox"/>
Verified by:	Name:				Title:	
	Department:				Date:	

## VENDOR REFERENCE FORM

City of Hollywood Solicitation #: RFP-174-24-GJ  
 Reference for: Bergen Sign Company

Organization/Firm Name providing reference: Planet Fitness  
 Organization/Firm Contact Name: Marcus Pelle Title: \_\_\_\_\_  
 Email: Marcus.pelle@grandfitness.com Phone: (305) 766 3155  
 Name of Referenced Project: Various Projects Contract No: \_\_\_\_\_  
 Date Services were provided: 1/1/2022 to Present Project Amount: 200,000.00 +  
 Referenced Vendor's role in Project: ☒ Prime Vendor ☐ Subcontractor/  
 Subconsultant  
 Would you use the Vendor again? ☒ Yes ☐ No. Please specify in additional comments

Description of services provided by Vendor (provide additional sheet if necessary):  
Various sign work for new and existing store

Please rate your experience with the Vendor	Need Improvement	Satisfactory	Excellent	Not Applicable
<b>Vendor's Quality of Service</b>				
a. Responsive	<input type="checkbox"/>	<input type="checkbox"/>	<input checked="" type="checkbox"/>	<input type="checkbox"/>
b. Accuracy	<input type="checkbox"/>	<input type="checkbox"/>	<input checked="" type="checkbox"/>	<input type="checkbox"/>
c. Deliverables	<input type="checkbox"/>	<input type="checkbox"/>	<input checked="" type="checkbox"/>	<input type="checkbox"/>
<b>Vendor's Organization:</b>				
a. Staff expertise	<input type="checkbox"/>	<input type="checkbox"/>	<input checked="" type="checkbox"/>	<input type="checkbox"/>
b. Professionalism	<input type="checkbox"/>	<input type="checkbox"/>	<input checked="" type="checkbox"/>	<input type="checkbox"/>
c. Staff turnover	<input type="checkbox"/>	<input type="checkbox"/>	<input checked="" type="checkbox"/>	<input type="checkbox"/>
<b>Timeliness/Cost Control of:</b>				
a. Project	<input type="checkbox"/>	<input type="checkbox"/>	<input checked="" type="checkbox"/>	<input type="checkbox"/>
b. Deliverables	<input type="checkbox"/>	<input type="checkbox"/>	<input checked="" type="checkbox"/>	<input type="checkbox"/>

Additional Comments (provide additional sheet if necessary):  
Their quality of work and commitment to service really makes any work we do on our signage so much easier and gives us peace of mind.

****THIS SECTION FOR CITY USE ONLY****					
Verified via:	Email:	<input type="checkbox"/>	Verbal:	<input type="checkbox"/>	Mail: <input type="checkbox"/>
Verified by:	Name:				Title:
	Department:				Date:



## VENDOR REFERENCE FORM

City of Hollywood Solicitation #: BFP-174-24-65  
 Reference for: Bergen Sign Company

Organization/Firm Name providing reference: Aeropostale

Organization/Firm Contact Name: Rob Roscher Title: \_\_\_\_\_  
 Email: rruscher@aeropostale.com Phone: 201 308-5502  
 Name of Referenced Project: National change Contract No: \_\_\_\_\_  
 Date Services were provided: ongoing Project Amount: \$1,500,000.00

Referenced Vendor's role in Project: ☒ Prime Vendor ☐ Subcontractor/  
 Would you use the Vendor again? ☒ Yes ☐ Subconsultant  
☐ No. Please specify in additional comments

Description of services provided by Vendor (provide additional sheet if necessary):  
National sign change

Please rate your experience with the Vendor	Need Improvement	Satisfactory	Excellent	Not Applicable
<b>Vendor's Quality of Service</b>				
a. Responsive	<input type="checkbox"/>	<input type="checkbox"/>	<input checked="" type="checkbox"/>	<input type="checkbox"/>
b. Accuracy	<input type="checkbox"/>	<input type="checkbox"/>	<input checked="" type="checkbox"/>	<input type="checkbox"/>
c. Deliverables	<input type="checkbox"/>	<input type="checkbox"/>	<input checked="" type="checkbox"/>	<input type="checkbox"/>
<b>Vendor's Organization:</b>				
a. Staff expertise	<input type="checkbox"/>	<input type="checkbox"/>	<input checked="" type="checkbox"/>	<input type="checkbox"/>
b. Professionalism	<input type="checkbox"/>	<input type="checkbox"/>	<input checked="" type="checkbox"/>	<input type="checkbox"/>
c. Staff turnover	<input type="checkbox"/>	<input type="checkbox"/>	<input checked="" type="checkbox"/>	<input type="checkbox"/>
<b>Timeliness/Cost Control of:</b>				
a. Project	<input type="checkbox"/>	<input type="checkbox"/>	<input checked="" type="checkbox"/>	<input type="checkbox"/>
b. Deliverables	<input type="checkbox"/>	<input type="checkbox"/>	<input checked="" type="checkbox"/>	<input type="checkbox"/>

Additional Comments (provide additional sheet if necessary):

****THIS SECTION FOR CITY USE ONLY****					
Verified via:	Email: <input type="checkbox"/>	Verbal: <input type="checkbox"/>	Mail: <input type="checkbox"/>		
Verified by:	Name:			Title:	
	Department:			Date:	

## 8. SUBMITTAL REQUIREMENTS QUESTIONNAIRE

The responsibility for submitting a bid/proposal on or before the time and date is solely and strictly the responsibility of the bidder/proposer, the City will in no way be responsible for delays caused by technical difficulty or caused by any other occurrence. No part of a bid/proposal can be submitted via FAX or via direct Email to the City. No variation in price or conditions shall be permitted based upon a claim of ignorance.

### 8.1. Respondent Submittal\*

Please upload your COMPLETE response, including any and all required forms listed in the solicitation and the corresponding attachments. Please exclude uploading any CONFIDENTIAL / PROPRIETARY information here.

\*Response required

### 8.2. Please upload any CONFIDENTIAL / PROPRIETARY information here (as applicable).

### 8.3. Required Forms and Acknowledgements

#### 8.3.1. Vendor Reference Form\*

Please download the below documents, complete, and upload.

Provide a minimum of three (3) client references for the services cited as related experience using Vendor Reference Form.

- [Vendor Reference Form.pdf](#)

\*Response required

#### 8.3.2. Location of Office\*

Please enter your firm's location from City Hall

\*Response required

#### 8.3.3. Hold Harmless and Indemnity Clause \*

I, an authorized representative, the contractor, shall indemnify, defend and hold harmless the City of Hollywood, its elected and appointed officials, employees and agents for any and all suits, actions, legal or administrative proceedings, claims, damage, liabilities, interest, attorney' s fees, costs of any kind whether arising prior to the start of activities or following the completion or acceptance and in any manner directly or indirectly caused, occasioned or contributed to in whole or in part by reason of any act, error or omission, fault or negligence whether active or passive by the contractor, or anyone acting under its direction, control, or on its behalf in connection with or incident to its performance of the contract.

☒ Please confirm

\*Response required

#### 8.3.4. *Non-Collusion Statement\**

I, being first duly sworn, depose that:

- A. He/she is an authorized representative of the Company, the Proposer that has submitted the attached Proposal.
- B. He/she has been fully informed regarding the preparation and contents of the attached Proposal and of all pertinent circumstances regarding such Proposal;
- C. Such Proposal is genuine and is not a collusion or sham Proposal;
- D. Neither the said Proposer nor any of its officers, partners, owners, agents, representatives, employees or parties in interest, including this affiant has in any way colluded, conspired, connived or agreed, directly or indirectly with any other Proposer, firm or person to submit a collusive or sham Proposal in connection with the contractor for which the attached Proposal has been submitted or to refrain from bidding in connection with such contract, or has in any manner, directly or indirectly, sought by agreement or collusion or communication or conference with any other Proposer, firm or person to fix the price or prices, profit or cost element of the Proposal price or the Proposal price of any other Proposer, or to secure an advantage against the City of Hollywood or any person interested in the proposed Contract; and
- E. The price or prices quoted in the attached Proposal are fair and proper and are not tainted by any collusion, conspiracy, connivance or unlawful agreement on the part of the Proposer or any of its agents, representatives, owners, employees, or parties in interest, including this affiant.

☒ Please confirm

\*Response required

#### 8.3.5. *Certifications Regarding Debarment, Suspension and Other Responsibility Matters\**

The applicant certifies that it and its principals:

Are not presently debarred, suspended, proposed for debarment, declared ineligible, sentenced to a denial of Federal benefits by a State or Federal court, or voluntarily excluded from covered transactions by any Federal department or agency;

Have not within a three-year period preceding this application been convicted of or had a civil judgment rendered against them for commission of fraud or a criminal offense in connection with obtaining, attempting to obtain, or performing a public (Federal, State, or local) transaction or contract under a public transaction, violation of Federal or State antitrust statutes or commission of embezzlement, theft, forgery, bribery, falsification or destruction of records, making false statements, or receiving stolen property;

Are not presently indicted for or otherwise criminally or civilly charged by a governmental entity (Federal, State, or local) with commission of any of the offenses enumerated in paragraph (b) of this certification; and

Have not within a three-year period preceding this application had one or more public transactions (Federal, State, or local) terminated for cause or default.

☒ Please confirm

\*Response required

#### 8.3.6. *Drug-Free Workplace Program\**

- A. IDENTICAL TIE PROPOSALS - Preference shall be given to businesses with drug-free workplace programs. Whenever two or more bids which are equal with respect to price, quality, and service are received by the State or by any political subdivision for the procurement of commodities or contractual services, a bid received from a business that certifies that it has implemented a drug-free workplace program shall be given preference in the award process. Established procedures for processing tie proposals will be followed if none of the tied vendors have a drug-free workplace program. In order to have a drug-free workplace program, a business shall:
1. Publish a statement notifying employees that the unlawful manufacture, distribution, dispensing, possession, or use of a controlled substance is prohibited in the workplace and specifying the actions that will be taken against employees for violations of such prohibition.
  2. Inform employees about the dangers of drug abuse in the workplace, the business's policy of maintaining a drug-free workplace, any available drug counseling, rehabilitation, and employee assistance programs, and the penalties that may be imposed upon employees for drug abuse violations.
  3. Give each employee engaged in providing the commodities or contractual services that are under bid a copy of the statement specified in subsection (1).
  4. In the statement specified in subsection (1), notify the employee that, as a condition of working on the commodities or contractual services that are under bid, the employee will abide by the terms of the statement and will notify the employer of any conviction of, or plea of guilty or nolo contendere to, any violation of chapter 893 or of any controlled substance law of the United States or any state, for a violation occurring in the workplace no later than five (5) days after such conviction.
  5. Impose a sanction on, or require the satisfactory participation in a drug abuse assistance or rehabilitation program (if such is available in the employee's community) by, any employee who is so convicted.
  6. Make a good faith effort to continue to maintain a drug-free workplace through implementation of these requirements.

**As the person authorized to sign the statement, I certify that this firm complies fully with the above requirements.**



☒ Please confirm

\*Response required

#### **8.3.7. *Solicitation, Giving, and Acceptance of Gifts Policy\****

Florida Statute 112.313 prohibits the solicitation or acceptance of Gifts. "No Public officer, employee of an agency, local government attorney, or candidate for nomination or election shall solicit or accept anything of value to the recipient, including a gift, loan, reward, promise of future employment, favor, or service, based upon any understanding that the vote, official action, or judgment of the public officer, employee, local government attorney, or candidate would be influenced thereby." The term "public officer" includes "any person elected or appointed to hold office in any agency, including any person serving on an advisory body."

The City of Hollywood/Hollywood CRA policy prohibits all public officers, elected or appointed, all employees, and their families from accepting any gifts of any value, either directly or indirectly, from any contractor, vendor, consultant, or business with whom the City/CRA does business.

The State of Florida definition of "gifts" includes the following:

- Real property or its use,
- Tangible or intangible personal property, or its use,
- A preferential rate or terms on a debt, loan, goods, or services,
- Forgiveness of indebtedness,
- Transportation, lodging, or parking,
- Food or beverage,
- Membership dues,
- Entrance fees, admission fees, or tickets to events, performances, or facilities,
- Plants, flowers or floral arrangements
- Services provided by persons pursuant to a professional license or certificate.
- Other personal services for which a fee is normally charged by the person providing the services.
- Any other similar service or thing having an attributable value not already provided for in this section.

Any contractor, vendor, consultant, or business found to have given a gift to a public officer or employee, or his/her family, will be subject to dismissal or revocation of contract.

As the person authorized to sign the statement, I certify that this firm will comply fully with this policy.

☒ Please confirm

\*Response required

**8.3.8. Proof of Sunbiz Registration\***

Enter company FEIN to be verified in Sunbiz

\*Response required

**8.4. ACKNOWLEDGMENT AND SIGNATURE PAGE\***

**8.4.1. If Corporation - Date Incorporated/Organized:\*** 1994

\*Response required

**8.4.2. State Incorporated/Organized:\*** New Jersey

\*Response required

**8.4.3. Remittance Address\*** 90 Newark Pompton Turnpike 4100 N Powerline Rd Suite L-2  
Wayne, NJ 07470 Pompano Beach, FL 33073

\*Response required

**8.4.4. Bidder/Proposer's Authorized Representative's Typed Full Name\***

\*Response required Ryan Murphy

**8.4.5. IT IS HEREBY CERTIFIED AND AFFIRMED THAT THE BIDDER/PROPOSER CERTIFIES ACCEPTANCE OF THE TERMS, CONDITIONS, SPECIFICATIONS, ATTACHMENTS AND ANY ADDENDA. THE BIDDER/PROPOSER SHALL ACCEPT ANY AWARDS MADE AS A RESULT OF THIS SOLICITATION. BIDDER/PROPOSER FURTHER AGREES THAT PRICES QUOTED WILL REMAIN FIXED FOR THE PERIOD OF TIME STATED IN THE SOLICITATION.\***

☒ Please confirm

\*Response required

**8.4.6. THE EXECUTION OF THIS FORM CONSTITUTES THE UNEQUIVOCAL OFFER OF BIDDER/PROPOSER TO BE BOUND BY THE TERMS OF ITS PROPOSAL. FAILURE TO SIGN THIS SOLICITATION WHERE INDICATED BY AN AUTHORIZED REPRESENTATIVE SHALL RENDER THE BID/PROPOSAL NON-RESPONSIVE. THE CITY MAY, HOWEVER, IN ITS SOLE DISCRETION, ACCEPT ANY BID/PROPOSAL THAT INCLUDES AN EXECUTED DOCUMENT WHICH UNEQUIVOCALLY BINDS THE BIDDER/PROPOSER TO THE TERMS OF ITS OFFER.\***

☒ Please confirm

\*Response required

**8.5. SWORN STATEMENT PURSUANT TO SECTION 287.133 (3) (a) FLORIDA STATUTES ON PUBLIC ENTITY CRIMES\***

**8.5.1. This form statement is submitted to the City of Hollywood by:\***

(Print individual's name and title) (Print name of entity submitting sworn statement)

Ryan Murphy, Estimating

Bergen Sign Company

\*Response required

**8.5.2. Sworn Statement Continuation:\*** 4100 N Powerline Rd Suite L-2  
Enter business address: Pompano Beach, FL 33073

\*Response required

**8.5.3. Sworn Statement Continuation:\*** 22-3358637  
Enter Federal Employer Identification Number (FEIN) is:

If the entity has no FEIN, include the Social Security Number of the individual signing this sworn statement.

\*Response required

**8.5.4. Sworn Statement Continuation:\***  
I understand that “convicted” or “conviction” as defined in Paragraph 287.133(1)(b), Florida Statutes, means a finding of guilt or a conviction of a public entity crime, with or without an adjudication of guilt, in an federal or state trial court of record relating to charges brought by indictment or information after July 1, 1989, as a result of a jury verdict, nonjury trial, or entry of a plea of guilty or nolo contendere.

☒ Please confirm

\*Response required

**8.5.5. Sworn Statement Continuation:\***  
I understand that “Affiliate,” as defined in paragraph 287.133(1)(a), Florida Statutes, means:

1. A predecessor or successor of a person convicted of a public entity crime, or
2. An entity under the control of any natural person who is active in the management of the entity and who has been convicted of a public entity crime. The term “affiliate” includes those officers, directors, executives, partners, shareholders, employees, members, and agents who are active in the management of an affiliate. The ownership by one person of shares constituting a controlling interest in another person, or a pooling of equipment or income among persons when not for fair market value under an arm’s length agreement, shall be a prima facie case that one person controls another person. A person who knowingly enters into a joint venture with a person who has been convicted of a public entity crime in Florida during the preceding 36 months shall be considered an affiliate.

☒ Please confirm

\*Response required

**8.5.6. Sworn Statement Continuation:\***

I understand that "person," as defined in Paragraph 287.133(1)(e), Florida Statutes, means any natural person or any entity organized under the laws of any state or of the United States with the legal power to enter into a binding contract and which bids or applies to bid on contracts let by a public entity, or which otherwise transacts or applies to transact business with a public entity.

The term "person" includes those officers, executives, partners, shareholders, employees, members, and agents who are active in management of an entity

☒ Please confirm

\*Response required

**8.5.7. Sworn Statement Continuation:\***

Based on information and belief, the statement which I have marked below is true in relation to the entity submitting this sworn statement. (Please indicate which statement applies.)

Division of Administrative Hearings, determined that it was not in the public interest to place the entity submitting this sworn statement on the convicted vendor list. (attach a copy of the Final Order).

*Select all that apply*

☒ Neither the entity submitting sworn statement, nor any of its officers, director, executives, partners, shareholders, employees, members, or agents who are active in the management of the entity, nor any affiliate of the entity has been charged with and convicted of a public entity crime subsequent to July 1, 1989.

☐ The entity submitting this sworn statement, or one or more of its officers, directors, executives, partners, shareholders, employees, members, or agents who are active in the management of the entity, or an affiliate of the entity, or an affiliate of the entity has been charged with and convicted of a public entity crime subsequent to July 1, 1989.

☐ The entity submitting this sworn statement, or one or more of its officers, directors, executives, partners, shareholders, employees, members, or agents who are active in the management of the entity, or an affiliate of the entity has been charged with and convicted of a public entity crime, but the Final Order entered by the Hearing Officer in a subsequent proceeding before a Hearing Officer of the State of the State of Florida,

\*Response required

**8.5.8. Sworn Statement Confirmation\***

I UNDERSTAND THAT THE SUBMISSION OF THIS FORM TO THE CONTRACTING OFFICER FOR THE PUBLIC ENTITY IDENTIFIED IN PARAGRAPH 1 (ONE) ABOVE IS FOR THAT PUBLIC

ENTITY ONLY AND THAT THIS FORM IS VALID THROUGH DECEMBER 31 OF THE CALENDAR

YEAR IN WHICH IT IS FILED. I ALSO UNDERSTAND THAT I AM REQUIRED TO INFORM THAT



PUBLIC ENTITY PRIOR TO ENTERING INTO A CONTRACT IN EXCESS OF THE THRESHOLD

AMOUNT PROVIDED IN SECTION 287.017 FLORIDA STATUTES FOR A CATEGORY TWO OF

ANY CHANGE IN THE INFORMATION CONTAINED IN THIS FORM.

☒ Please confirm

\*Response required

### 8.6. Local Vendor Preference

An additional 5 points will be awarded to Respondent's proposal that meet the following criteria for Local Vendor Preference:

As outlined in the City of Hollywood Code of Ordinances, a Local Hollywood Vendor shall mean a business entity that has maintained a permanent place of business with full-time employees within the City limits for **a minimum of one year** prior to the date of issuance of a bid or proposal solicitation. The permanent place of business must be the primary place of business of the entity and may not be a post office box or a personal residence. The business must actually distribute goods, supplies, materials, equipment or services from the permanent place of business. The business must have a current local business tax receipt from the City and must not be publicly traded.

**Note: This solicitation is open to all qualified Vendors. Meeting Local Vendor Preference is Optional.**

#### 8.6.1. *Does the Vendor meet the bonus criteria for Local Vendor Preference?\**

Vendors will need to provide documentation to claim this preference.

☐ Yes

☒ No

\*Response required

#### 8.6.2. *Local Vendor Preference - Local Business Tax Receipt*

Local preference in the form of 5 points will be assigned to each firm identified as a Local Hollywood Vendor.

The business must have a current local business tax receipt from the City and must not be publicly traded.

Please upload Local Business Tax Receipt

## City Signage

Type	Sign Type	Unit Price	Count	Total Price
Monument	** Sign Type A Shroud (shroud only)	21200	1	\$ 21,200.00
Monument	** Sign Type A New	23470	1	\$ 23,470.00
Monument	** Sign Type B Shroud (shroud only)	12500	1	\$ 12,500.00
Monument	** Sign Type B New	13860	1	\$ 13,860.00
Pole Sign	** Sign Type D Plaque Only	1670	1	\$ 1,670.00
Pole Sign	** Sign Type D New Pole	2595	1	\$ 2,595.00
Monument	Sign Type D (Additional Alternate)	12750	10	\$ 127,500.00
Monument	** Sign Type E Shroud (shroud only)	3705	1	\$ 3,705.00
Monument	** Sign Type E New	3705	1	\$ 3,705.00
Monument	** Sign Type F Shroud (shroud only)	4860	1	\$ 4,860.00
Monument	** Sign Type F New	6220	1	\$ 6,220.00
Plaque	Sign Type J	725	6	\$ 4,350.00
Wayfinding	Sign Type U – Overhead Wayfinding	5215	5	\$ 26,075.00
Destination	Sign Type W – Wayfinding Post	2885	3	\$ 8,655.00
	Engineering	5000	1	\$ 5,000.00
	Surveys of sign locations	1500	1	\$ 1,500.00
	*** Structural Remediation of total Signs Above	1500	1	\$ 1,500.00
	<b>TOTAL</b>			<b>\$ 268,365.00</b>

<b>Additional Alternate:</b> Provide price to add vandalism proof coating to signage on a SF basis	<b>\$ 6.00</b>
--	----------------

### NOTES:

\* Signage Contractor to refer to attached signage spreadsheet, Kimley Horn Structural assessment, and site visits to determine number of sign's that are to be retrofitted with shroud or new. Please include in bid tab above "count".

\*\* Refer to the Kimley Horn structural analysis for conditional rating as a reference only. Structural integrity and workability will be the sole responsibility of the Signage Contractor based on analysis and Signage Contractor's individual site visit, a report will be generated by the Signage Contractor of the existing signs determined to be in good condition which will remain and have a shroud installed. Signs found not in suitable condition by Signage Contractor should be noted on the report for final determination by City/CRA and Signage Contractor.

\*\*\* This line item depicts the cost above and beyond actual signage shroud. As an example only (Stucco replacement and paint of signage base)

## Beach CRA Signage

Type	Sign Type	Unit Price	Count	Total Price
Gateway	TYP. Beach Gateway (New)	6870	3	\$ 20,610.00
Gateway	Dania Beach Blvd Gateway (New)	27000	1	\$ 27,000.00
Wayfinding	TYP. Post Mounted Wayfinding Directional (New)	2625	8	\$ 21,000.00
Destination	TYP. Destination Sign (NEW)	7500	4	\$ 30,000.00
	Engineering	2000	1	\$ 2,000.00
	Surveys of sign locations	850	1	\$ 850.00
	Structural Remediation of total Signs Above	1500	1	\$ 1,500.00
	<b>Total</b>			<b>\$ 102,960.00</b>

<b>Additional Alternate:</b> Provide price to add vandalism proof coating to signage on a SF basis	<b>\$ 6.00</b>
--	----------------

## Downtown CRA Signage

Type	Sign Type	Unit Price	Count	Total Price
Neighborhood	Neighborhood Shroud type signs (Retrofitting)	6000	9	\$ 54,000.00
Neighborhood	Neighborhood Signs along the FEC Corridor (New)	6220	2	\$ 12,440.00
Gateway	Hollywood Blvd Gateway (New)	27000	1	\$ 27,000.00
Wayfinding	TYP. Post Mounted Wayfinding Directional (Retrofitting)	2625	8	\$ 21,000.00
Wayfinding	TYP. Overhead Mounted Wayfinding Directional (Retrofitting)	14900	3	\$ 44,700.00
	Engineering	1700	1	\$ 1,700.00
	Surveys of sign locations	995	1	\$ 995.00
	Structural Remediation of total Signs Above	1500	1	\$ 1,500.00
	<b>Total</b>			<b>\$ 163,335.00</b>

<b>Additional Alternate:</b> Provide price to add vandalism proof coating to signage on a SF basis	<b>\$ 6.00</b>
--	----------------

## Aggregate Bid Total

<b>Project Overall Bid Price</b>	<b>\$ 534,660.00</b>
----------------------------------	----------------------

Address:	Hollywood, FL				Total:		\$	334,850.00
Sign Type A								
Sign #	Qty:	MFG Price	Install Price	Unit Price	Total Price	Recommendation	Description	
A1	1	\$ 13,995.00	\$ 4,900.00	\$ 18,895.00	\$ 18,895.00	Repair	Finish failure exposing reinforcing foam and fiber mesh,should be replaced	
A2	1	\$ 13,995.00	\$ 9,475.00	\$ 23,470.00	\$ 23,470.00	Replace	No existing sign, new install with footer & raised 16'-6" x 1'-6" concrete base	
A3	1	\$ 13,995.00	\$ 490.00	\$ 14,485.00	\$ 14,485.00	Repair	Finish failure exposing reinforcing foam and fiber mesh,should be replaced	
A4	1	\$ 13,995.00	\$ 600.00	\$ 14,595.00	\$ 14,595.00	Repair	Damaged Base	
A5	1	\$ 13,995.00	\$ 5,000.00	\$ 18,995.00	\$ 18,995.00	Replace	Remove sign, base to remain, New sign type A	
A6	1	\$ 13,995.00	\$ 9,475.00		\$ 23,470.00	New	New sign type A	
				Total:	\$ 113,910.00			

Sign Type B								
Sign #	Qty:	MFG Price	Install Price	Unit Price	Total Price	Recommendation	Description	
B1	1	\$ 8,960.00	\$ 4,900.00	\$ 13,860.00	\$ 13,860.00	Replace	Remove sign, base to remain, New sign type B	
B2	1	\$ 8,960.00	\$ 4,900.00	\$ 13,860.00	\$ 13,860.00	Replace	Remove sign, base to remain, New sign type B	
B3	1	\$ 8,960.00	\$ 4,900.00	\$ 13,860.00	\$ 13,860.00	Repair	Remove sign, base to remain, New sign type B	
B4	1	\$ 495.00	\$ 850.00	\$ 1,345.00	\$ 1,345.00	Repair	Damaged Base	
B5	1	\$ 495.00	\$ 850.00	\$ 1,345.00	\$ 1,345.00	Replace	Remove sign, base to remain	
B6	1	\$ 8,960.00	\$ 4,900.00	\$ 13,860.00	\$ 13,860.00	Replace	Remove sign, base to remain, New sign type B	
				Total:	\$ 58,130.00			

Sign Type C							
Sign #	Qty:	MFG Price	Install Price	Unit Price	Total Price	Recommendation	Description
C1	1	\$ 490.00	\$ 1,050.00	\$ 1,540.00	\$ 1,540.00	Repair	Fix sepearaion at base
C2	1	\$ 490.00	\$ 1,050.00	\$ 1,540.00	\$ 1,540.00	Repair	Repair minor crack in stucco
C3	1	\$ 6,900.00	\$ 3,850.00	\$ 10,750.00	\$ 10,750.00	Repair	Repair would be temprary, recommend new
C4	1	\$ 1,995.00	\$ 1,250.00	\$ 3,245.00	\$ 3,245.00	Replace	Replace sign face, clean & repaint frame and posts as required
				Total:	\$ 17,075.00		

Sign Type D							
Sign #	Qty:	MFG Price	Install Price	Unit Price	Total Price	Recommendation	Description
D1	1	\$ 225.00	\$ 450.00	\$ 675.00	\$ 675.00	Repair	Clean rust & repaint pole
D2	1	\$ 1,995.00	\$ 600.00	\$ 2,595.00	\$ 2,595.00	New	MFG & Install New Sign
D3	1	\$ 25.00	\$ 20.00	\$ 45.00	\$ 45.00	Repair	Replace missing mounting hardware
D4	1	\$ 75.00	\$ 295.00	\$ 370.00	\$ 370.00	Repair	Repair panel seperation & clean concrete base
D5	1	\$ 350.00	\$ 450.00	\$ 800.00	\$ 800.00	Repair	Repair panel seperation, clean and repaint post
D6	1	\$ 1,175.00	\$ 495.00	\$ 1,670.00	\$ 1,670.00	Replace	Replace top panel, clean and repaint post
D7	1	\$ 225.00	\$ 450.00	\$ 675.00	\$ 675.00	Repair	Clean rust & repaint pole
D8	1	\$ 1,995.00	\$ 600.00	\$ 2,595.00	\$ 2,595.00	New	MFG & Install New Sign
D9	1	\$ 1,175.00	\$ 495.00	\$ 1,670.00	\$ 1,670.00	Replace	Replace top panel, clean and repaint post
D10	1	\$ 1,995.00	\$ 600.00	\$ 2,595.00	\$ 2,595.00	Replace	Remove sign, base to remain, New sign type D
D11	1	\$ 1,995.00	\$ 600.00	\$ 2,595.00	\$ 2,595.00	Replace	Clean rust & repaint pole
Total:				\$ 16,285.00			

Sign Type E								
Sign #	Qty:	MFG Price	Install Price	Unit Price	Total Price	Recommendation	Description	
E1	1	\$ 100.00	\$ 290.00	\$ 390.00	\$ 390.00	Repair	Repair Staining and cracking	
E2	1	\$ 2,720.00	\$ 985.00	\$ 3,705.00	\$ 3,705.00	Repair	Replace sign face, base to remain - powerwash/paint	
E3	1	\$ 2,720.00	\$ 985.00	\$ 3,705.00	\$ 3,705.00	New	New Sign	
E4	1	\$ 2,720.00	\$ 985.00	\$ 3,705.00	\$ 3,705.00	Repair	Replace sign face, base to remain - powerwash/paint	
E5	1	\$ 75.00	\$ 200.00	\$ 275.00	\$ 275.00	Repair	Repair damage & paint at corner	
E6	1	\$ 75.00	\$ 200.00	\$ 275.00	\$ 275.00	Repair	Repair damage & paint at corner	
E7	1	\$ -	\$ -	\$ -	\$ -	N/A	No Action	
E8	1	\$ -	\$ -	\$ -	\$ -	N/A	No Action	
E9	1	\$ 2,720.00	\$ 985.00	\$ 3,705.00	\$ 3,705.00	Repair	Replace sign face, base to remain - powerwash/paint	
E10	1	\$ 2,720.00	\$ 985.00	\$ 3,705.00	\$ 3,705.00	Replace	Replace sign face, base to remain - powerwash/paint, resecrete	
E11	1	\$ 2,720.00	\$ 985.00	\$ 3,705.00	\$ 3,705.00	Repair	Replace sign face, base to remain - powerwash/paint	
E12	1	\$ 150.00	\$ 150.00	\$ 300.00	\$ 300.00	Repair	Replace missing tile at base	
E13	1	\$ 2,720.00	\$ 985.00	\$ 3,705.00	\$ 3,705.00	Repair	Replace sign face, base to remain - powerwash/paint	
E14	1	\$ 2,720.00	\$ 985.00	\$ 3,705.00	\$ 3,705.00	Repair	Replace sign face, base to remain - powerwash/paint	
E15	1	\$ 375.00	\$ 600.00	\$ 975.00	\$ 975.00	Repair	Repair Staining and cracking, Replace missing tile at base, replace faded logo	
E16	1	\$ 2,720.00	\$ 985.00	\$ 3,705.00	\$ 3,705.00	Repair	Replace sign face, base to remain - powerwash/paint	
E17	1	\$ 2,720.00	\$ 985.00	\$ 3,705.00	\$ 3,705.00	Replace	Replace sign face, base to remain - powerwash/paint	
E18	1	\$ 2,720.00	\$ 985.00	\$ 3,705.00	\$ 3,705.00	Repair	Replace sign face, base to remain - powerwash/paint	
E19	1	\$ 75.00	\$ 200.00	\$ 275.00	\$ 275.00	Repair	Repair damage & paint at base	
E20	1	\$ 2,720.00	\$ 985.00	\$ 3,705.00	\$ 3,705.00	Replace	Replace sign face, base to remain - powerwash/paint	
E21	1	\$ 75.00	\$ 275.00	\$ 350.00	\$ 350.00	Repair	Repair base and clean sign	
E22	1	\$ 2,720.00	\$ 985.00	\$ 3,705.00	\$ 3,705.00	Replace	Replace sign face, base to remain - powerwash/paint	
E23	1	\$ 2,720.00	\$ 985.00	\$ 3,705.00	\$ 3,705.00	Repair	Replace sign face, base to remain - powerwash/paint	
E24	1	\$ 2,720.00	\$ 985.00	\$ 3,705.00	\$ 3,705.00	Replace	Replace sign face, base to remain - powerwash/paint	
E25	1	\$ 120.00	\$ 690.00	\$ 810.00	\$ 810.00	Replace	Repair damage & paint at base	
Total:				\$ 59,225.00				

We will gladly secure permits for you at an additional cost if required. Production begins when permits and customer approvals are in hand and we have received a 50% deposit. Acceptance of this proposal is subject to all Bergen Sign standard terms and conditions.

Permits, license fees, surveys, architect's or engineers' sealed plans, appearances at governments meetings and other expenses required to obtain permits and make other filings shall be additional to this proposal and shall be payable to Bergen Sign Company as they are incurred.  
In the event of a breach of this agreement for non-payment of any amount set forth herein, and if this account is placed in the hands of an attorney or collection agency for collection of any amount(s) owed pursuant to or under this agreement, it is hereby agreed that the amount due shall include an additional sum equal to 25% of the total of all unpaid sums, including interest and/or service charges incurred and/or added, and as representing attorney's fees and/or collection fees, plus all collection costs incurred.

ACCEPTED BY:

DATE:

It is agreed that interest and/or service charges on all past due amounts shall be billed, and shall be payable, at the rate of 1 1/2% per month (18% annually).  
In the event of a breach of this agreement for non-payment of any amount set forth herein, and if this account is placed in the hands of an attorney or collection agency for collection of any amount(s) owed pursuant to or under this agreement, it is hereby agreed that the amount due shall include an additional sum equal to 25% of the total of all unpaid sums, including interest and/or service charges incurred and/or added, and as representing attorney's fees and/or collection fees, plus all collection costs incurred.

**A Full Service Nationwide Sign Company since 1918**



Quotation #: 0019195

Date: 2/7/2024

Customer: City of Hollywood

Job Name: Hollywood Wayfinding GOB

Quoted By: Ryan

Address:	Hollywood, FL	Total:	\$ 334,850.00
----------	---------------	--------	---------------

**Sign Type F**

Sign #	Qty:	MFG Price	Install Price	Unit Price	Total Price	Recommendation	Description
F1	1	\$ 100.00	\$ 325.00	\$ 425.00	\$ 425.00	Repair	Repair Staining and cracking
F2	1	\$ 2,250.00	\$ 600.00	\$ 2,850.00	\$ 2,850.00	Repair	Replace face panel, powerwash and repaint
F3	1	\$ 75.00	\$ 195.00	\$ 270.00	\$ 270.00	Repair	Repaint fading areas
F4	1	\$ 100.00	\$ 325.00	\$ 425.00	\$ 425.00	Repair	Repair Staining and cracking
F5	1	\$ 100.00	\$ 325.00	\$ 425.00	\$ 425.00	Repair	Repair Staining and cracking
F6	1	\$ 2,250.00	\$ 600.00	\$ 2,850.00	\$ 2,850.00	Repair	Replace face panel, powerwash and repaint
F7	1	\$ 3,970.00	\$ 890.00	\$ 4,860.00	\$ 4,860.00	Repair	Replace face panel, powerwash and repaint
F8	1	\$ 130.00	\$ 310.00	\$ 440.00	\$ 440.00	Repair	Repair Staining and cracking
F9	1	\$ 3,970.00	\$ 890.00	\$ 4,860.00	\$ 4,860.00	Repair	New sign type F to be sleeved over existing sign
F10	1	\$ 3,970.00	\$ 890.00	\$ 4,860.00	\$ 4,860.00	Replace	New sign type F to be sleeved over existing sign
				<b>Total:</b>	<b>\$ 22,265.00</b>		

**Sign Type H1**

Sign #	Qty:	MFG Price	Install Price	Unit Price	Total Price	Recommendation	Description
H1	1	\$ 180.00	\$ 200.00	\$ 380.00	\$ 380.00	Repair	Replace Missing Tiles
				<b>Total:</b>	<b>\$ 380.00</b>		

**Sign Type H**

Sign #	Qty:	MFG Price	Install Price	Unit Price	Total Price	Recommendation	Description
J	6	\$ 125.00	\$ 600.00	\$ 725.00	\$ 4,350.00	Repair	Pressure wash and touch up
				<b>Total:</b>	<b>\$ 4,350.00</b>		

**Sign Type U**

Sign #	Qty:	MFG Price	Install Price	Unit Price	Total Price	Recommendation	Description
U1	1	\$ 3,975.00	\$ 1,240.00	\$ 5,215.00	\$ 5,215.00	Repair	Clean rust, repaint pole, replace top panel
U2	1	\$ 3,975.00	\$ 1,240.00	\$ 5,215.00	\$ 5,215.00	Repair	Clean rust, repaint pole, replace top panel
U3	1	\$ 3,975.00	\$ 1,240.00	\$ 5,215.00	\$ 5,215.00	Repair	Clean rust, repaint pole, replace top panel
U4	1	\$ 3,975.00	\$ 1,240.00	\$ 5,215.00	\$ 5,215.00	Repair	Clean rust, repaint pole, replace top panel
U5	1	\$ 3,975.00	\$ 1,240.00	\$ 5,215.00	\$ 5,215.00	Repair	Clean rust, repaint pole, replace top panel
				<b>Total:</b>	<b>\$ 26,075.00</b>		

**Sign Type W**

Sign #	Qty:	MFG Price	Install Price	Unit Price	Total Price	Recommendation	Description
W1	1	\$ 1,995.00	\$ 890.00	\$ 2,885.00	\$ 2,885.00	Repair	Clean rust, repaint pole, replace top panel
W2	1	\$ 3,995.00	\$ 890.00	\$ 4,885.00	\$ 4,885.00	Repair	Clean rust, repaint pole, replace top panel
W3	1	\$ 1,995.00	\$ 890.00	\$ 2,885.00	\$ 2,885.00	Repair	Clean rust, repaint pole, replace top panel
				<b>Total:</b>	<b>\$ 10,655.00</b>		

**Signage**

Sign #	Qty:	MFG Price	Install Price	Unit Price	Total Price	Recommendation	Description
Engineering	1	\$ 5,000.00	\$ -	\$ 5,000.00	\$ 5,000.00		Engineering
Survey	1	\$ -	\$ 1,500.00	\$ 1,500.00	\$ 1,500.00		Survey
Remediation	1	\$ -	\$ -	\$ -	\$ -		Structural Remediation of total Signs Above
				<b>Total:</b>	<b>\$ 6,500.00</b>		

We will gladly secure permits for you at an additional cost if required. Production begins when permits and customer approvals are in hand and we have received a 50% deposit. Acceptance of this proposal is subject to all Bergen Sign standard terms and conditions.

Permits, license fees, surveys, architect's or engineers' sealed plans, appearances at governments meetings and other expenses required to obtain permits and make other filings shall be additional to this proposal and shall be payable to Bergen Sign Company as they are incurred.  
All time clocks, photocell, disconnected switches, circuit breakers and adequate primary wiring of the proper voltage and ampacity for the display(s) at the location specified by Bergen Sign Company and electrical hook-up shall be furnished and installed by the buyer unless otherwise specified in this proposal.

**ACCEPTED BY:****DATE:**

It is agreed that interest and/or service charges on all past due amounts shall be billed, and shall be payable, at the rate of 1 1/2% per month (18% annually).  
In the event of a breach of this agreement for non-payment of any amount set forth herein, and if this account is placed in the hands of an attorney or collection agency for collection of any amount(s) owed pursuant to or under this agreement, it is hereby agreed that the amount due shall include an additional sum equal to 25% of the total of all unpaid sums, including interest and/or service charges incurred and/or added, and as representing attorney's fees and/or collection fees, plus all collection costs incurred.

***A Full Service Nationwide Sign Company since 1918***





Quotation #: 0019195

Date: 2/7/2024

Customer: City of Hollywood

Job Name: Hollywood Wayfinding CRA

Quoted By: Ryan

Address:	Hollywood, FL				Total:		\$	28,415.00
Sign Type M								
Sign #	Qty:	MFG Price	Install Price	Unit Price	Total Price	Recommendation	Description	
M1	1	\$ 90.00	\$ 295.00	\$ 385.00	\$ 385.00	Repair	Repair chips and cracks	
M2		\$ -	\$ -	\$ -	\$ -	N/A	No Action	
M3		\$ 90.00	\$ 295.00	\$ 385.00	\$ -	N/A	No Action	
M4	1	\$ -	\$ 375.00	\$ 375.00	\$ 375.00	Repair	Powerwash sign	
M5	1	\$ 190.00	\$ 450.00	\$ 640.00	\$ 640.00	Repair	Repair chips and cracks	
M6	1	\$ -	\$ 230.00	\$ 230.00	\$ 230.00	Repair	Clean base of sign	
				Total:	\$ 1,630.00			

Sign Type T							
Sign #	Qty:	MFG Price	Install Price	Unit Price	Total Price	Recommendation	Description
T1	1	\$ 120.00	\$ 190.00	\$ 310.00	\$ 310.00	Repair	Paint column
Total:					\$ 310.00		

Sign Type W							
Sign #	Qty:	MFG Price	Install Price	Unit Price	Total Price	Recommendation	Description
W4	1	\$ 1,735.00	\$ 890.00	\$ 2,625.00	\$ 2,625.00	Repair	Clean rust, paint post, replace panel
W5	1	\$ 1,735.00	\$ 890.00	\$ 2,625.00	\$ 2,625.00	Repair	Clean rust, paint post, replace panel
W6	1	\$ 1,735.00	\$ 890.00	\$ 2,625.00	\$ 2,625.00	Repair	Clean rust, paint post, replace panel
W7	1	\$ 1,735.00	\$ 890.00	\$ 2,625.00	\$ 2,625.00	Repair	Clean rust, paint post, replace panel
W8	1	\$ 1,735.00	\$ 890.00	\$ 2,625.00	\$ 2,625.00	Repair	Clean rust, paint post, replace panel
W9	1	\$ 1,735.00	\$ 890.00	\$ 2,625.00	\$ 2,625.00	Repair	Clean rust, paint post, replace panel
W10	1	\$ 1,735.00	\$ 890.00	\$ 2,625.00	\$ 2,625.00	Repair	Clean rust, paint post, replace panel
W11	1	\$ 1,735.00	\$ 890.00	\$ 2,625.00	\$ 2,625.00	Repair	Clean rust, paint post, replace panel
W12	1	\$ 1,735.00	\$ 890.00	\$ 2,625.00	\$ 2,625.00	Repair	Clean rust, paint post, replace panel
Total:					\$ 23,625.00		

Signage							
Sign #	Qty:	MFG Price	Install Price	Unit Price	Total Price	Recommendation	Description
Engineering	1	\$ 2,000.00	\$ -	\$ 2,000.00	\$ 2,000.00		Engineering
Survey	1	\$ -	\$ 850.00	\$ 850.00	\$ 850.00		Survey
Remediation	1	\$ -	\$ -	\$ -	\$ -		Structural Remediation of total Signs Above
Total:					\$ 2,850.00		

We will gladly secure permits for you at an additional cost if required. Production begins when permits and customer approvals are in hand and we have received a 50% deposit. Acceptance of this proposal is subject to all Bergen Sign standard terms and conditions.

Permits, license fees, surveys, architect's or engineers' sealed plans, appearances at governments meetings and other expenses required to obtain permits and make other filings shall be additional to this proposal and shall be payable to Bergen Sign Company as they are incurred.  
All time clocks, photocell, disconnected switches, circuit breakers and adequate primary wiring of the proper voltage and ampacity for the display(s) at the location specified by Bergen Sign Company and electrical hook-up shall be furnished and installed by the buyer unless otherwise specified in this proposal.

**ACCEPTED BY:****DATE:**

It is agreed that interest and/or service charges on all past due amounts shall be billed, and shall be payable, at the rate of 1 1/2% per month (18% annually).  
In the event of a breach of this agreement for non-payment of any amount set forth herein, and if this account is placed in the hands of an attorney or collection agency for collection of any amount(s) owed pursuant to or under this agreement, it is hereby agreed that the amount due shall include an additional sum equal to 25% of the total of all unpaid sums, including interest and/or service charges incurred and/or added, and as representing attorney's fees and/or collection fees, plus all collection costs incurred.

***A Full Service Nationwide Sign Company since 1918***



Quotation #: 0019195

Date: 2/7/2024

Customer: City of Hollywood

Job Name: Hollywood Wayfinding CRA Downtown

Quoted By: Ryan

Address:		Hollywood, FL				Total: \$		89,395.00	
Sign Type N									
Sign #	Qty:	MFG Price	Install Price	Unit Price	Total Price	Recommendation	Description		
N1	1	\$ 90.00	\$ 295.00	\$ 385.00	\$ 385.00	Repair	Repair chips and cracks		
N2		\$ -	\$ -	\$ -	\$ -	N/A	No Action		
N3		\$ -	\$ -	\$ -	\$ -	N/A	No Action		
N4	1	\$ -	\$ 275.00	\$ 275.00	\$ 275.00	Repair	Powerwash sign		
N5	1	\$ 125.00	\$ 350.00	\$ 475.00	\$ 475.00	Repair	Repair chips and cracks		
N6	1	\$ -	\$ 230.00	\$ 230.00	\$ 230.00	Repair	Clean base of sign		
N7	1	\$ 2,720.00	\$ 3,500.00	\$ 6,220.00	\$ 6,220.00	New	New Sign		
N8	1	\$ 2,720.00	\$ 3,500.00	\$ 6,220.00	\$ 6,220.00	New	New Sign		
N9	1	\$ 2,720.00	\$ 3,500.00	\$ 6,220.00	\$ 6,220.00	New	New Sign		
N10	1	\$ 2,720.00	\$ 3,500.00	\$ 6,220.00	\$ 6,220.00	New	New Sign		
N11	1	\$ 2,720.00	\$ 3,500.00	\$ 6,220.00	\$ 6,220.00	New	New Sign		
				Total:	\$ 32,465.00				

Sign Type W							
Sign #	Qty:	MFG Price	Install Price	Unit Price	Total Price	Recommendation	Description
W1	1	\$ 1,735.00	\$ 890.00	\$ 2,625.00	\$ 2,625.00	Repair	Clean rust, paint post, replace panel
W2	1	\$ 1,735.00	\$ 890.00	\$ 2,625.00	\$ 2,625.00	Repair	Clean rust, paint post, replace panel
W3	1	\$ 1,735.00	\$ 890.00	\$ 2,625.00	\$ 2,625.00	Repair	Clean rust, paint post, replace panel
W4	1	\$ 1,735.00	\$ 890.00	\$ 2,625.00	\$ 2,625.00	Repair	Clean rust, paint post, replace panel
W5	1	\$ 1,735.00	\$ 890.00	\$ 2,625.00	\$ 2,625.00	Repair	Clean rust, paint post, replace panel
W6	1	\$ 1,735.00	\$ 890.00	\$ 2,625.00	\$ 2,625.00	Repair	Clean rust, paint post, replace panel
W7	1	\$ 1,735.00	\$ 890.00	\$ 2,625.00	\$ 2,625.00	Repair	Clean rust, paint post, replace panel
W8	1	\$ 1,735.00	\$ 890.00	\$ 2,625.00	\$ 2,625.00	Repair	Clean rust, paint post, replace panel
W9	1	\$ 1,735.00	\$ 890.00	\$ 2,625.00	\$ 2,625.00	Repair	Clean rust, paint post, replace panel
W10	1	\$ 1,735.00	\$ 890.00	\$ 2,625.00	\$ 2,625.00	Repair	Clean rust, paint post, replace panel
W11	1	\$ 1,735.00	\$ 890.00	\$ 2,625.00	\$ 2,625.00	Repair	Clean rust, paint post, replace panel
				Total:	\$ 28,875.00		

Sign Type G							
Sign #	Qty:	MFG Price	Install Price	Unit Price	Total Price	Recommendation	Description
G1	1	\$ 19,995.00	\$ 5,365.00	\$ 25,360.00	\$ 25,360.00	New	New Sign
				Total:	\$ 25,360.00		

Signage							
Sign #	Qty:	MFG Price	Install Price	Unit Price	Total Price	Recommendation	Description
Engineering	1	\$ 1,700.00	\$ -	\$ 1,700.00	\$ 1,700.00		Engineering
Survey	1	\$ -	\$ 995.00	\$ 995.00	\$ 995.00		Survey
Remediation	1	\$ -	\$ -	\$ -	\$ -		Structural Remediation of total Signs Above
Total:				\$ 2,695.00			

We will gladly secure permits for you at an additional cost if required. Production begins when permits and customer approvals are in hand and we have received a 50% deposit. Acceptance of this proposal is subject to all Bergen Sign standard terms and conditions.

Permits, license fees, surveys, architect's or engineers' sealed plans, appearances at governments meetings and other expenses required to obtain permits and make other filings shall be additional to this proposal and shall be payable to Bergen Sign Company as they are incurred.  
All time clocks, photocell, disconnected switches, circuit breakers and adequate primary wiring of the proper voltage and ampacity for the display(s) at the location specified by Bergen Sign Company and electrical hook-up shall be furnished and installed by the buyer unless otherwise specified in this proposal.

ACCEPTED BY:

DATE:

It is agreed that interest and/or service charges on all past due amounts shall be billed, and shall be payable, at the rate of 1 1/2% per month (18% annually).  
In the event of a breach of this agreement for non-payment of any amount set forth herein, and if this account is placed in the hands of an attorney or collection agency for collection of any amount(s) owed pursuant to or under this agreement, it is hereby agreed that the amount due shall include an additional sum equal to 25% of the total of all unpaid sums, including interest and/or service charges incurred and/or added, and as representing attorney's fees and/or collection fees, plus all collection costs incurred.

***A Full Service Nationwide Sign Company since 1918***