

ACCEPTABLE FILL MATERIALS: STORMTECH SC-310 CHAMBER SYSTEMS

MATERIAL LOCATION	DESCRIPTION	AASHTO MATERIAL CLASSIFICATIONS	COMPACTION / DENSITY REQUIREMENT
D	FINAL FILL: FILL MATERIAL FOR LAYER 'D' STARTS FROM THE TOP OF THE 'C' LAYER TO THE BOTTOM OF FLEXIBLE PAVEMENT OR UNPAVED FINISHED GRADE ABOVE. NOTE THAT PAVEMENT SUBBASE MAY BE PART OF THE 'D' LAYER.	3.25	PREPARE PER SITE DESIGN ENGINEER'S PLANS. PAVED INSTALLATIONS MAY HAVE STRINGENT MATERIAL AND PREPARATION REQUIREMENTS.
C	INITIAL FILL: FILL MATERIAL FOR LAYER 'C' STARTS FROM THE TOP OF THE EMBEDMENT STONE ('B' LAYER) TO 18" (450 mm) ABOVE THE TOP OF THE CHAMBER. NOTE THAT PAVEMENT SUBBASE MAY BE A PART OF THE 'C' LAYER.	AASHTO M145 ¹ A-1, A-2-4, A-3 OR AASHTO M43 ¹ 3, 357, 4, 467, 5, 56, 57, 6, 67, 68, 7, 78, 8, 89, 9, 10	BEGIN COMPACTIONS AFTER 12" (300 mm) OF MATERIAL OVER THE CHAMBERS IS REACHED. COMPACT ADDITIONAL LAYERS IN 6" (150 mm) MAX LIFTS TO A MIN. 95% PROCTOR DENSITY FOR WELL GRADED MATERIAL AND 95% RELATIVE DENSITY FOR PROCESSED AGGREGATE MATERIALS. ROLLER GROSS VEHICLE WEIGHT NOT TO EXCEED 12,000 lbs (53 kN). DYNAMIC FORCE NOT TO EXCEED 20,000 lbs (89 kN).
B	EMBEDMENT STONE: FILL SURROUNDING THE CHAMBERS FROM THE FOUNDATION STONE ('A' LAYER) TO THE 'C' LAYER ABOVE.	AASHTO M43 ¹ 3, 357, 4, 467, 5, 56, 57	NO COMPACTION REQUIRED.
A	FOUNDATION STONE: FILL BELOW CHAMBERS FROM THE SUBGRADE UP TO THE FOOT (BOTTOM) OF THE CHAMBER.	AASHTO M43 ¹ 3, 357, 4, 467, 5, 56, 57	PLATE COMPACT OR ROLL TO ACHIEVE A FLAT SURFACE. ^{2,3}

PLEASE NOTE:

- THE LISTED AASHTO DESIGNATIONS ARE FOR GRADATIONS ONLY. THE STONE MUST ALSO BE CLEAN, CRUSHED, ANGULAR. FOR EXAMPLE, A SPECIFICATION FOR #4 STONE WOULD STATE: "CLEAN, CRUSHED, ANGULAR NO. 4 (AASHTO M43) STONE".
- STORMTECH COMPACTION REQUIREMENTS ARE MET FOR 'A' LOCATION MATERIALS WHEN PLACED AND COMPACTED IN 6" (150 mm) (MAX) LIFTS USING TWO FULL COVERAGES WITH A VIBRATORY COMPACTOR.
- WHERE INFILTRATION SURFACES MAY BE COMPROMISED BY COMPACTION, FOR STANDARD DESIGN LOAD CONDITIONS, A FLAT SURFACE MAY BE ACHIEVED BY RAKING OR DRAGGING WITHOUT COMPACTION EQUIPMENT. FOR SPECIAL LOAD DESIGNS, CONTACT STORMTECH FOR COMPACTION REQUIREMENTS.
- ONCE LAYER 'C' IS PLACED, ANY SOIL/MATERIAL CAN BE PLACED IN LAYER 'D' UP TO THE FINISHED GRADE. MOST PAVEMENT SUBBASE SOILS CAN BE USED TO REPLACE THE MATERIAL REQUIREMENTS OF LAYER 'C' OR 'D' AT THE SITE DESIGN ENGINEER'S DISCRETION.
- WHERE RECYCLED CONCRETE AGGREGATE IS USED IN LAYERS 'A' OR 'B' THE MATERIAL SHOULD ALSO MEET THE ACCEPTABILITY CRITERIA OUTLINED IN TECHNICAL NOTE 6.20 "RECYCLED CONCRETE STRUCTURAL BACKFILL".

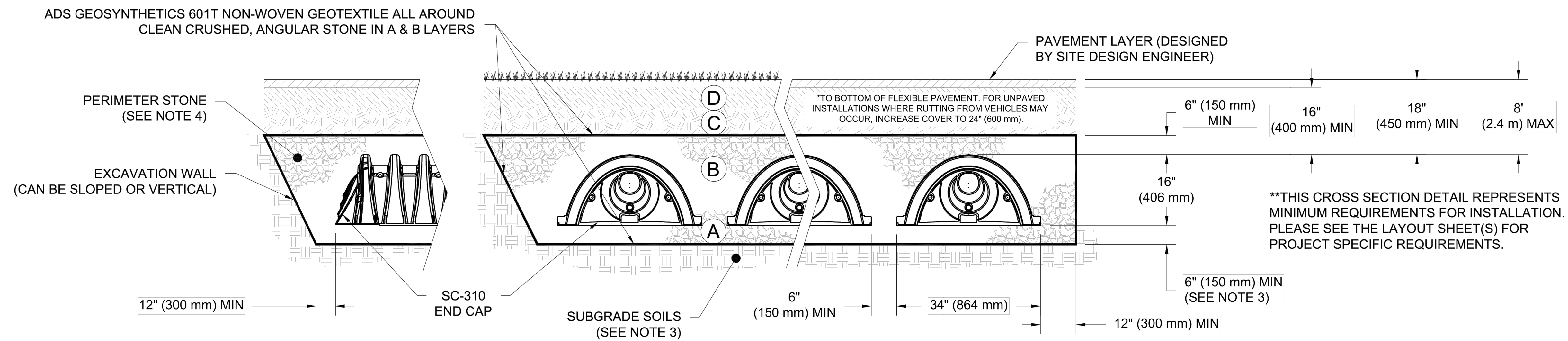

NOTES:

- CHAMBERS SHALL MEET THE REQUIREMENTS OF ASTM F2922 (POLETHYLENE) OR ASTM F2418 (POLYPROPYLENE), "STANDARD SPECIFICATION FOR CORRUGATED WALL STORMWATER COLLECTION CHAMBERS".
- SC-310 CHAMBERS SHALL BE DESIGNED IN ACCORDANCE WITH ASTM F2787 "STANDARD PRACTICE FOR STRUCTURAL DESIGN OF THERMOPLASTIC CORRUGATED WALL STORMWATER COLLECTION CHAMBERS".
- THE SITE DESIGN ENGINEER IS RESPONSIBLE FOR ASSESSING THE BEARING RESISTANCE (ALLOWABLE BEARING CAPACITY) OF THE SUBGRADE SOILS AND THE DEPTH OF FOUNDATION STONE WITH CONSIDERATION FOR THE RANGE OF EXPECTED SOIL MOISTURE CONDITIONS. REFERENCE STORMTECH DESIGN MANUAL FOR BEARING CAPACITY GUIDANCE.
- PERIMETER STONE MUST BE EXTENDED HORIZONTALLY TO THE EXCAVATION WALL FOR BOTH VERTICAL AND SLOPED EXCAVATION WALLS.
- REQUIREMENTS FOR HANDLING AND INSTALLATION:
 - TO MAINTAIN THE WIDTH OF CHAMBERS DURING SHIPPING AND HANDLING, CHAMBERS SHALL HAVE INTEGRAL, INTERLOCKING STACKING LUGS.
 - TO ENSURE A SECURE JOINT DURING INSTALLATION AND BACKFILL, THE HEIGHT OF THE CHAMBER JOINT SHALL NOT BE LESS THAN 2".
 - TO ENSURE THE INTEGRITY OF THE ARCH SHAPE DURING INSTALLATION, a) THE ARCH STIFFNESS CONSTANT AS DEFINED IN SECTION 6.2.8 OF ASTM F2922 SHALL BE GREATER THAN OR EQUAL TO 400 LBS/FT%. AND b) TO RESIST CHAMBER DEFORMATION DURING INSTALLATION AT ELEVATED TEMPERATURES (ABOVE 73° F / 23° C), CHAMBERS SHALL BE PRODUCED FROM REFLECTIVE GOLD OR YELLOW COLORS.

OAKWOOD SOUTH RETAIL SHOPPING CENTER
 HOLLYWOOD, FL
 DATE: 07/02/24
 DRAWN: MPV
 PROJECT #: S420513
 CHECKED: ---

REVISED SYSTEM LAYOUTS	INCREASED VOLUME	DESCRIPTION
08/30/24	DHC	
08/28/24	DHC	
	DRWN	CHKD
	DATE	

StormTech®
 Chamber System
 1-800-821-6710 | WWW.STORMTECH.COM

4640 TRUEEMAN BLVD
 HILLIARD, OH 43026
ADS

THIS DRAWING HAS BEEN PREPARED BASED ON INFORMATION PROVIDED TO ADS BY STORMTECH UNDER THE DIRECTION OF THE PROJECT'S ENGINEER OF RECORD (TEOR) OR OTHER PROJECT REPRESENTATIVE. THIS DRAWING IS NOT INTENDED FOR USE IN BIDDING OR CONSTRUCTION WITHOUT THE TEOR'S PRIOR APPROVAL. EOR SHALL REVIEW THIS DRAWING PRIOR TO BIDDING AND/OR CONSTRUCTION. IT IS THE ULTIMATE RESPONSIBILITY OF THE EOR TO ENSURE THAT THE PRODUCT(S) DEPICTED AND ALL ASSOCIATED DETAILS MEET ALL APPLICABLE LAWS, REGULATIONS, AND PROJECT REQUIREMENTS.

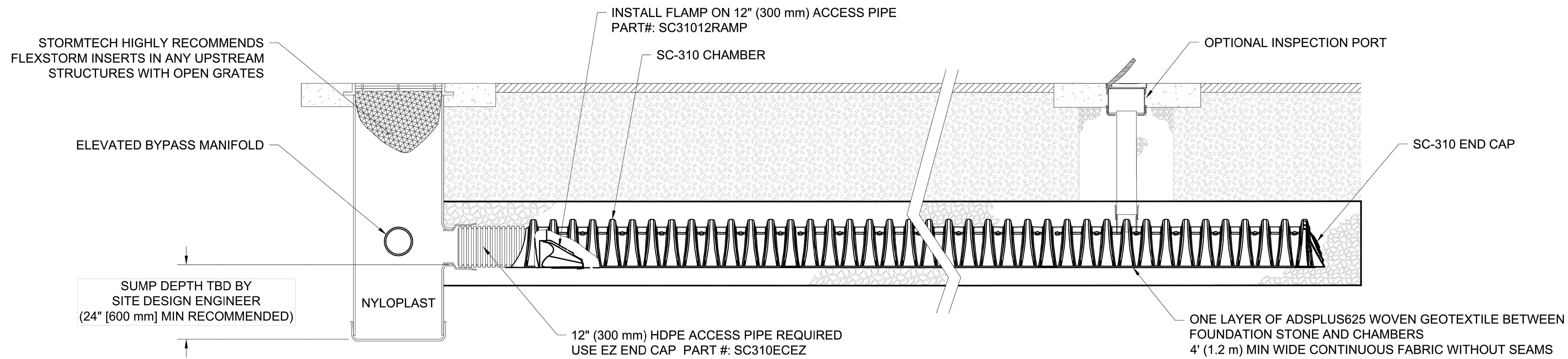

SC-310 ISOLATOR ROW PLUS DETAIL
NTS

INSPECTION & MAINTENANCE

- STEP 1) INSPECT ISOLATOR ROW PLUS FOR SEDIMENT
- A. INSPECTION PORTS (IF PRESENT)
 - A.1. REMOVE/OPEN LID ON NYLOPLAST INLINE DRAIN
 - A.2. REMOVE AND CLEAN FLEXSTORM FILTER IF INSTALLED
 - A.3. USING A FLASHLIGHT AND STADIA ROD, MEASURE DEPTH OF SEDIMENT AND RECORD ON MAINTENANCE LOG
 - A.4. LOWER A CAMERA INTO ISOLATOR ROW PLUS FOR VISUAL INSPECTION OF SEDIMENT LEVELS (OPTIONAL)
 - A.5. IF SEDIMENT IS AT, OR ABOVE, 3" (80 mm) PROCEED TO STEP 2. IF NOT, PROCEED TO STEP 3.
 - B. ALL ISOLATOR PLUS ROWS
 - B.1. REMOVE COVER FROM STRUCTURE AT UPSTREAM END OF ISOLATOR ROW PLUS
 - B.2. USING A FLASHLIGHT, INSPECT DOWN THE ISOLATOR ROW PLUS THROUGH OUTLET PIPE
 - i) MIRRORS ON POLES OR CAMERAS MAY BE USED TO AVOID A CONFINED SPACE ENTRY
 - ii) FOLLOW OSHA REGULATIONS FOR CONFINED SPACE ENTRY IF ENTERING MANHOLE
 - B.3. IF SEDIMENT IS AT, OR ABOVE, 3" (80 mm) PROCEED TO STEP 2. IF NOT, PROCEED TO STEP 3.
- STEP 2) CLEAN OUT ISOLATOR ROW PLUS USING THE JETVAC PROCESS
- A. A FIXED CULVERT CLEANING NOZZLE WITH REAR FACING SPREAD OF 45" (1.1 m) OR MORE IS PREFERRED
 - B. APPLY MULTIPLE PASSES OF JETVAC UNTIL BACKFLUSH WATER IS CLEAN
 - C. VACUUM STRUCTURE SUMP AS REQUIRED
- STEP 3) REPLACE ALL COVERS, GRATES, FILTERS, AND LIDS; RECORD OBSERVATIONS AND ACTIONS.
- STEP 4) INSPECT AND CLEAN BASINS AND MANHOLES UPSTREAM OF THE STORMTECH SYSTEM.

NOTES

1. INSPECT EVERY 6 MONTHS DURING THE FIRST YEAR OF OPERATION. ADJUST THE INSPECTION INTERVAL BASED ON PREVIOUS OBSERVATIONS OF SEDIMENT ACCUMULATION AND HIGH WATER ELEVATIONS.
2. CONDUCT JETTING AND VACTORING ANNUALLY OR WHEN INSPECTION SHOWS THAT MAINTENANCE IS NECESSARY.

	StormTech® Chamber System 1-800-821-6710 WWW.STORMTECH.COM	OAKWOOD SOUTH RETAIL SHOPPING CENTER HOLLYWOOD, FL DATE: 07/02/24 DRAWN: MPV PROJECT #: S420513 CHECKED: ---
4640 TRUEEMAN BLVD HILLIARD, OH 43026		
THIS DRAWING HAS BEEN PREPARED BASED ON INFORMATION PROVIDED TO ADS/STORMTECH UNDER THE DIRECTION OF THE PROJECT'S ENGINEER OF RECORD (TEOR) OR OTHER PROJECT REPRESENTATIVE. THIS DRAWING IS NOT INTENDED FOR USE IN BIDDING OR CONSTRUCTION WITHOUT THE TEOR'S PRIOR APPROVAL. EOR SHALL REVIEW THIS DRAWING PRIOR TO BIDDING AND/OR CONSTRUCTION. IT IS THE ULTIMATE RESPONSIBILITY OF THE EOR TO ENSURE THAT THE PRODUCT(S) DEPICTED AND ALL ASSOCIATED DETAILS MEET ALL APPLICABLE LAWS, REGULATIONS, AND PROJECT REQUIREMENTS.		
7 SHEET OF 8		

SC-310 TECHNICAL SPECIFICATION

NTS

NYLOPLAST DRAIN BASIN

NTS

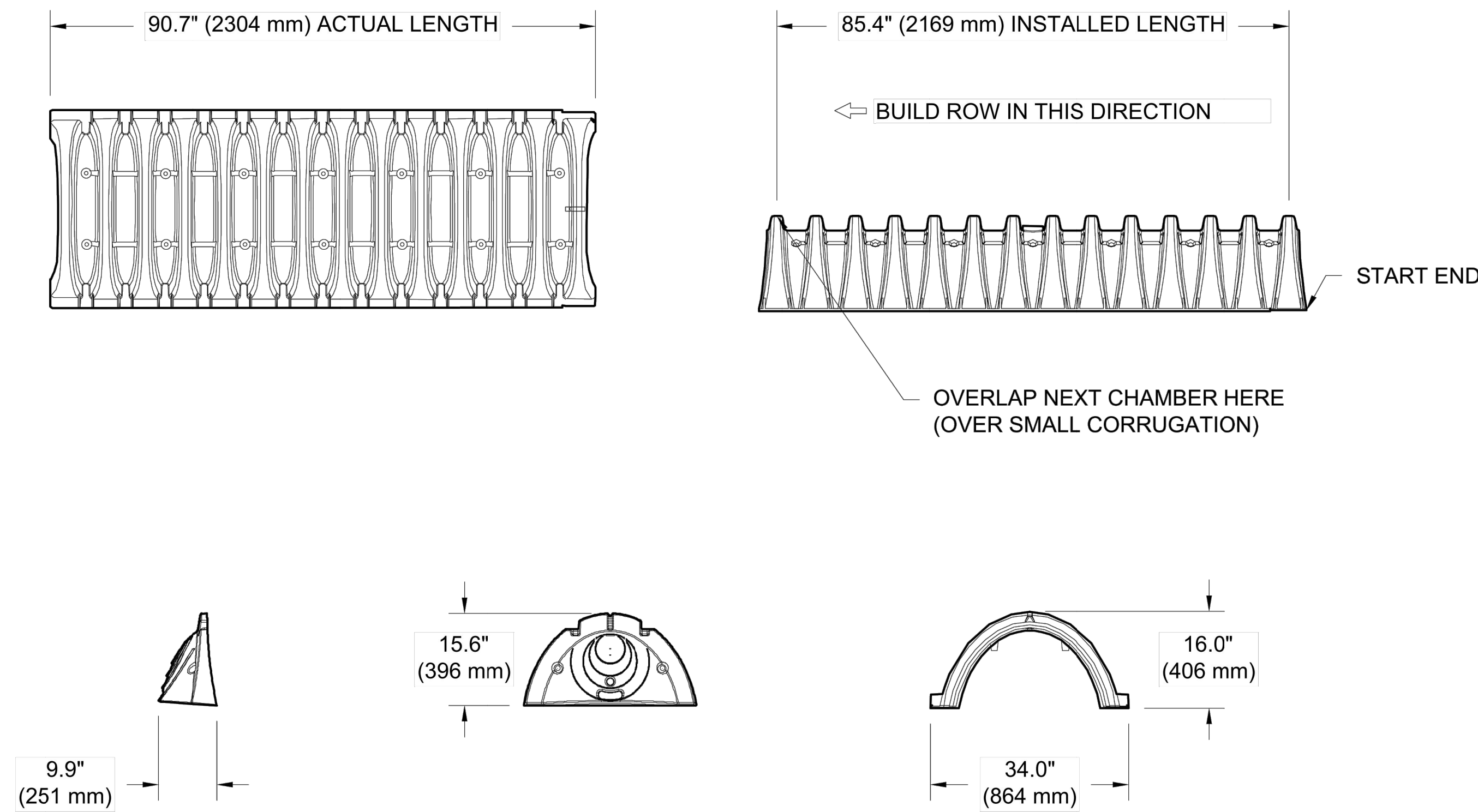

NOMINAL CHAMBER SPECIFICATIONS

SIZE (W X H X INSTALLED LENGTH)	34.0" X 16.0" X 85.4"	(864 mm X 406 mm X 2169 mm)
CHAMBER STORAGE	14.7 CUBIC FEET	(0.42 m³)
MINIMUM INSTALLED STORAGE*	31.0 CUBIC FEET	(0.88 m³)
WEIGHT	35.0 lbs.	(16.8 kg)

*ASSUMES 6" (152 mm) ABOVE, BELOW, AND BETWEEN CHAMBERS

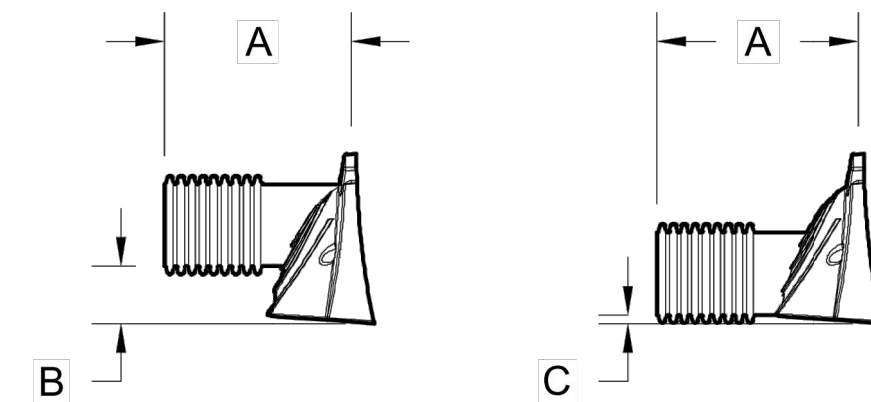

PRE-FAB STUBS AT BOTTOM OF END CAP FOR PART NUMBERS ENDING WITH "B"
 PRE-FAB STUBS AT TOP OF END CAP FOR PART NUMBERS ENDING WITH "T"
 PRE CORED END CAPS END WITH "PC"

PART #	STUB	A	B	C
SC310EPE06T / SC310EPE06TPC	6" (150 mm)	9.6" (244 mm)	5.8" (147 mm)	---
SC310EPE06B / SC310EPE06BPC			---	0.5" (13 mm)
SC310EPE08T / SC310EPE08TPC	8" (200 mm)	11.9" (302 mm)	3.5" (89 mm)	---
SC310EPE08B / SC310EPE08BPC			---	0.6" (15 mm)
SC310EPE10T / SC310EPE10TPC	10" (250 mm)	12.7" (323 mm)	1.4" (36 mm)	---
SC310EPE10B / SC310EPE10BPC			---	0.7" (18 mm)
SC310ECEZ*	12" (300 mm)	13.5" (343 mm)	---	0.9" (23 mm)

ALL STUBS, EXCEPT FOR THE SC310ECEZ ARE PLACED AT BOTTOM OF END CAP SUCH THAT THE OUTSIDE DIAMETER OF THE STUB IS FLUSH WITH THE BOTTOM OF THE END CAP. FOR ADDITIONAL INFORMATION CONTACT STORMTECH AT 1-888-892-2694.

* FOR THE SC310ECEZ THE 12" (300 mm) STUB LIES BELOW THE BOTTOM OF THE END CAP APPROXIMATELY 0.25" (6 mm). BACKFILL MATERIAL SHOULD BE REMOVED FROM BELOW THE N-12 STUB SO THAT THE FITTING SITS LEVEL.

NOTE: ALL DIMENSIONS ARE NOMINAL

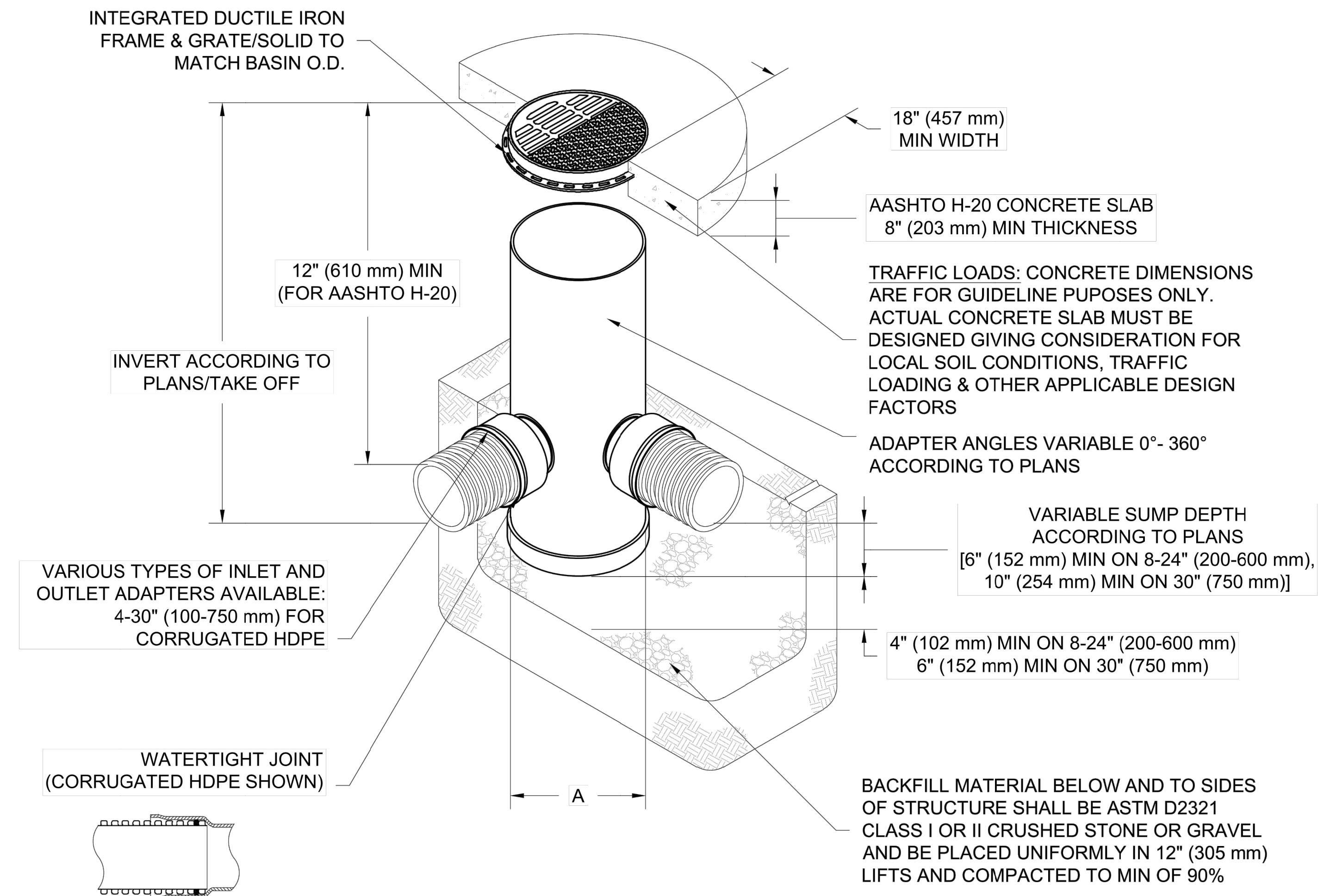

NOTES

- 8-30" (200-750 mm) GRATES/SOLID COVERS SHALL BE DUCTILE IRON PER ASTM A536 GRADE 70-50-05
- 12-30" (300-750 mm) FRAMES SHALL BE DUCTILE IRON PER ASTM A536 GRADE 70-50-05
- DRAIN BASIN TO BE CUSTOM MANUFACTURED ACCORDING TO PLAN DETAILS
- DRAINAGE CONNECTION STUB JOINT TIGHTNESS SHALL CONFORM TO ASTM D3212 FOR CORRUGATED HDPE (ADS & HANCOR DUAL WALL) & SDR 35 PVC
- FOR COMPLETE DESIGN AND PRODUCT INFORMATION: WWW.NYLOPLAST-US.COM
- TO ORDER CALL: 800-821-6710

A	PART #	GRATE/SOLID COVER OPTIONS		
8" (200 mm)	2808AG	PEDESTRIAN LIGHT DUTY	STANDARD LIGHT DUTY	SOLID LIGHT DUTY
10" (250 mm)	2810AG	PEDESTRIAN LIGHT DUTY	STANDARD LIGHT DUTY	SOLID LIGHT DUTY
12" (300 mm)	2812AG	PEDESTRIAN AASHTO H-10	STANDARD AASHTO H-20	SOLID AASHTO H-20
15" (375 mm)	2815AG	PEDESTRIAN AASHTO H-10	STANDARD AASHTO H-20	SOLID AASHTO H-20
18" (450 mm)	2818AG	PEDESTRIAN AASHTO H-10	STANDARD AASHTO H-20	SOLID AASHTO H-20
24" (600 mm)	2824AG	PEDESTRIAN AASHTO H-10	STANDARD AASHTO H-20	SOLID AASHTO H-20
30" (750 mm)	2830AG	PEDESTRIAN AASHTO H-20	STANDARD AASHTO H-20	SOLID AASHTO H-20

OAKWOOD SOUTH RETAIL SHOPPING CENTER
 HOLLYWOOD, FL

DATE: 07/02/24
 DRAWN: MPV
 PROJECT #: S420513
 CHECKED: ---

Nyloplast®
 770-932-2443 | WWW.NYLOPLAST-US.COM

4640 TRUEEMAN BLVD
 HILLIARD, OH 43026

THIS DRAWING HAS BEEN PREPARED BASED ON INFORMATION PROVIDED TO ADS/STORMTECH UNDER THE DIRECTION OF THE PROJECT'S ENGINEER OF RECORD FOR USE IN BIDDING OR CONSTRUCTION WITHOUT THE ENGINEER'S PRIOR APPROVAL. EOR SHALL REVIEW THIS DRAWING PRIOR TO BIDDING AND/OR CONSTRUCTION. IT IS THE ULTIMATE RESPONSIBILITY OF THE EOR TO ENSURE THAT THE PRODUCT(S) DEPICTED AND ALL ASSOCIATED DETAILS MEET ALL APPLICABLE LAWS, REGULATIONS, AND PROJECT REQUIREMENTS.

This document, together with the concepts and designs presented herein, is an instrument of service. It is intended only for the specific purpose and client for which it was prepared. No part of this document shall be reproduced or transmitted in any form or by any means, electronic or mechanical, including photocopying, recording, or by any information storage and retrieval system, without the prior written permission of Kimley-Horn and Associates, Inc.

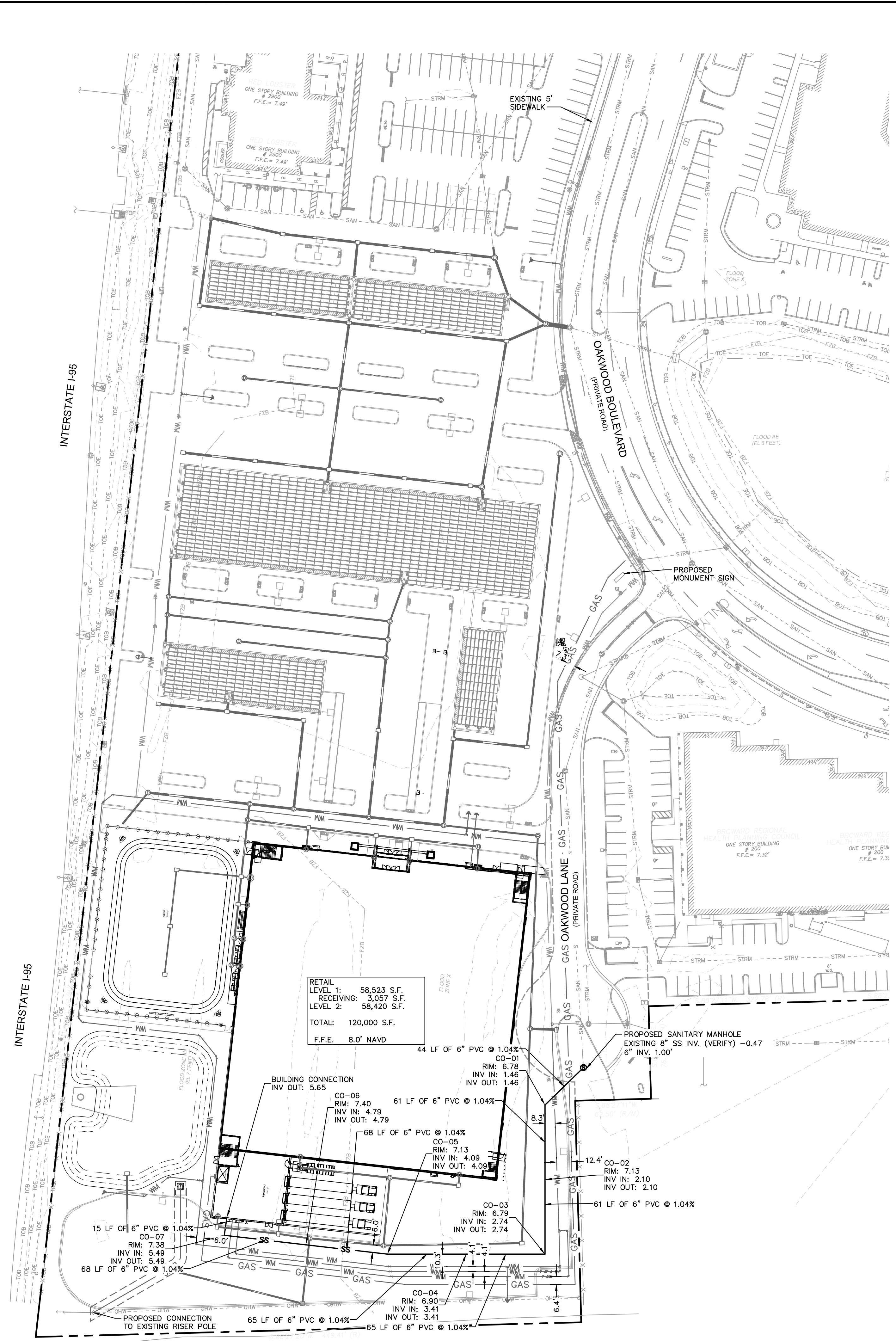

RETAIL LEVEL 1: 58,523 S.F.
RECEIVING: 3,057 S.F.
LEVEL 2: 58,420 S.F.
TOTAL: 120,000 S.F.
F.F.E. 8.0' NAVD

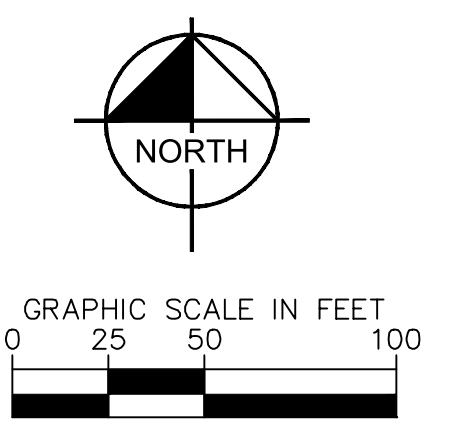

UTILITY LEGEND

---	PROPERTY LINE
---	UTILITY EASEMENT
WM	WATER MAIN (WM)
SAN	SANITARY MAIN
ELEC	ELECTRIC
GAS	GAS
---	STORM PIPE
FDG	GATE VALVE
90°	90° BEND
45°	45° BEND
22.5°	22.5° BEND
11.25°	11.25° BEND
---	TEE
---	SEWER MANHOLE
---	TRANSFORMER
---	EXISTING SEWER MANHOLE

POTABLE WATER IMPACT

Use	Calculation	Total
Existing	Regal Cinemas Movie Theater 4 GPD per seat (4 GPD/seat x 2,504 seats)	10,016 GPD
Proposed	Retail (Commercial) 120,000 SF 0.1 GPD per SF (120,000 s.f. x 0.1 GPD)	12,000 GPD
Total Existing and Proposed		(-) 1,984 GPD

SANITARY SEWER IMPACT

Use	Calculation	Total
Existing	Regal Cinemas Movie Theater 4 GPD per seat (4 GPD/seat x 2,504 seats)	10,016 GPD
Proposed	Retail (Commercial) 120,000 SF 0.1 GPD per SF (120,000 s.f. x 0.1 GPD)	12,000 GPD
Total Existing and Proposed		(-) 1,984 GPD

UTILITY NOTES

- ALL FILL MATERIAL IS TO BE IN PLACE AND COMPACTED BEFORE INSTALLATION OF PROPOSED UTILITIES.
- CONTRACTOR SHALL NOTIFY THE UTILITY AUTHORITIES INSPECTORS 72 HOURS BEFORE CONNECTING TO ANY EXISTING LINE.
- SANITARY SEWER PIPE SHALL BE AS FOLLOWS:
8" PVC SDR35 PER ASTM D 3034, FOR PIPES LESS THAN 12' DEEP
8" PVC SDR26 PER ASTM D 3034, FOR PIPES MORE THAN 12' DEEP
6" PVC SCHEDULE 40
DUCTILE IRON PIPE PER AWWA C150
- WATER LINES SHALL BE AS FOLLOWS:
6" AND LARGER, PVC C-900 PER ASTM D 2241 CLASS 200 UNDER COUNTY ROADS, OTHERWISE CLASS 150
6" AND LARGER DUCTILE IRON PIPE PER AWWA C150
SMALLER THAN 6" EITHER COPPER TUBE TYPE "L" (SOFT) PER ANSI 816.22 OR PVC, 200 P.S.I., PER ASTM D1784 AND D2241.
- MINIMUM TRENCH WIDTH SHALL BE 2 FEET.
- ALL WATER JOINTS ARE TO BE MECHANICAL JOINTS WITH THRUST BLOCKING AS CALLED OUT IN SPECIFICATIONS.
- ALL UTILITIES SHOULD BE KEPT TEN (10') APART (PARALLEL) OR WHEN CROSSING 18" VERTICAL CLEARANCE (OUTSIDE EDGE OF PIPE TO OUTSIDE EDGE OF PIPE).
- CONTRACTOR SHALL MAINTAIN A MINIMUM OF 14" COVER ON ALL WATER LINES.
- IN THE EVENT OF A VERTICAL CONFLICT BETWEEN WATER LINES, SANITARY LINES, STORM LINES AND GAS LINES (EXISTING AND PROPOSED), THE SANITARY LINE SHALL BE DUCTILE IRON PIPE WITH MECHANICAL JOINTS AT LEAST 10 FEET ON BOTH SIDES OF CROSSING. THE WATER LINE SHALL HAVE MECHANICAL JOINTS WITH APPROPRIATE THRUST BLOCKING AS REQUIRED TO PROVIDE A MINIMUM OF 18" CLEARANCE, MEETING REQUIREMENTS OF ANSI A21.10 OR ANSI 21.11 (AWWA C-151) (CLASS 50).
- UNDERGROUND LINES SHALL BE INSTALLED, INSPECTED AND APPROVED BEFORE BACKFILLING.
- TOPS OF EXISTING MANHOLES SHALL BE RAISED AS NECESSARY TO BE FLUSH WITH PROPOSED PAVEMENT ELEVATIONS WITHIN PAVED AREAS, AND TO BE ONE FOOT ABOVE FINISHED GROUND ELEVATIONS WITH WATER TIGHT LIDS WITHIN LANDSCAPED AREAS.
- ALL CONCRETE FOR ENCASEMENTS SHALL HAVE A MINIMUM 28 DAY COMPRESSION STRENGTH AT 3000 P.S.I.
- EXISTING UTILITIES SHALL BE VERIFIED IN FIELD PRIOR TO INSTALLATION OF ANY NEW LINES.
- CONTRACTOR IS RESPONSIBLE FOR COMPLYING TO THE SPECIFICATIONS OF THE LOCAL AUTHORITIES (ANY CITY) WITH REGARDS TO MATERIALS AND INSTALLATION OF THE WATER AND SEWER LINES.
- THE CONTRACTOR IS SPECIFICALLY CAUTIONED THAT THE LOCATION AND/OR ELEVATION OF EXISTING UTILITIES AS SHOWN ON THESE PLANS IS BASED ON RECORDS OF THE VARIOUS UTILITY COMPANIES, AND WHERE POSSIBLE, MEASUREMENTS TAKEN IN THE FIELD. THE INFORMATION IS NOT TO BE RELIED ON AS BEING EXACT OR COMPLETE. THE CONTRACTOR MUST CALL THE APPROPRIATE UTILITY COMPANIES AT LEAST 72 HOURS BEFORE ANY EXCAVATION TO REQUEST EXACT FIELD LOCATION OF UTILITIES. IT SHALL BE THE RESPONSIBILITY OF THE CONTRACTOR TO RELOCATE ALL EXISTING UTILITIES WHICH CONFLICT WITH THE PROPOSED IMPROVEMENTS SHOWN ON THE PLANS.
- CONTRACTOR IS RESPONSIBLE FOR ALL NECESSARY INSPECTIONS AND/OR CERTIFICATIONS REQUIRED BY CODES AND/OR UTILITY SERVICE COMPANIES. THIS AND THE FINAL CONNECTIONS OF THE SERVICE SHALL BE COMPLETED 30 DAYS PRIOR TO STORE POSSESSION.
- CONTRACTOR SHALL COORDINATE WITH ALL UTILITY COMPANIES FOR INSTALLATION REQUIREMENTS AND SPECIFICATIONS.
- REFER TO BUILDING PLANS FOR SITE LIGHTING ELECTRICAL PLAN.
- UNDERGROUND UTILITY LINES SHALL BE INSTALLED, INSPECTED AND APPROVED BEFORE BACKFILLING.
- REFER TO INTERIOR PLUMBING DRAWINGS FOR TIE-IN OF ALL UTILITIES.
- THE CONTRACTOR SHALL BE RESPONSIBLE FOR LOCATING EXISTING WATER MAINS, FORCE MAINS, SANITARY SEWER AND STORM MAINS AND MAINTAIN MINIMUM CLEARANCES BETWEEN WATER MAINS AND OTHER UTILITIES AT ALL POINTS ALONG THEIR LENGTH AS REQUIRED IN THE PLANS, DETAILS AND SPECIFICATIONS.
- CONTRACTOR IS RESPONSIBLE FOR ALL NECESSARY INSPECTIONS AND/OR CERTIFICATIONS REQUIRED BY CODES AND/OR UTILITY SERVICE COMPANIES. THIS AND THE FINAL CONNECTIONS OF THE SERVICE SHALL BE COMPLETED 30 DAYS PRIOR TO STORE POSSESSION.
- THE ENTIRE FIRE SERVICE FROM BUILDING TO CONNECTION POINT IS TO BE INSTALLED BY A LICENSED UTILITY CONTRACTOR HOLDING A "CONTRACTOR V" LICENSE IN ACCORDANCE WITH CH. 489 OF THE FLORIDA STATUTES.
- ALL UTILITY MAIN LENGTHS SHOWN ARE APPROXIMATE.

GREGORY D WILFONG
D
WILFONG

Kimley»Horn
© 2024 KIMLEY-HORN AND ASSOCIATES, INC.
445 24TH STREET, SUITE 200, VERO BEACH, FL 32960
WWW.KIMLEY-HORN.COM REGISTRY NO. 35106

DOCUMENT ARE NOT CONSIDERED SIGNED AND SEALED AND THE DIGITAL SIGNATURE MUST BE VERIFIED ON ANY ELECTRONIC COPIES.

DATE: 9/3/2024
SCALE: AS SHOWN
DESIGNED BY: SHB
DRAWN BY: SHB
CHECKED BY: GDW

GREGORY D WILFONG
LICENSE
No. 63166
STATE OF
FLORIDA
PROFESSIONAL ENGINEER

**OAKWOOD SOUTH
RETAIL SHOPPING
CENTER**
CITY OF HOLLYWOOD, FL

SEWER PLAN

SHEET NUMBER
C-400

NO.	REVISIONS	DATE	BY

This document, together with the concepts and designs presented herein, is an instrument of service, is intended only for the specific purpose and client for which it was prepared. Review of and improper reliance on this document without written authorization and adaptation by Kimley-Horn and Associates, Inc. shall be without liability to Kimley-Horn and Associates, Inc.

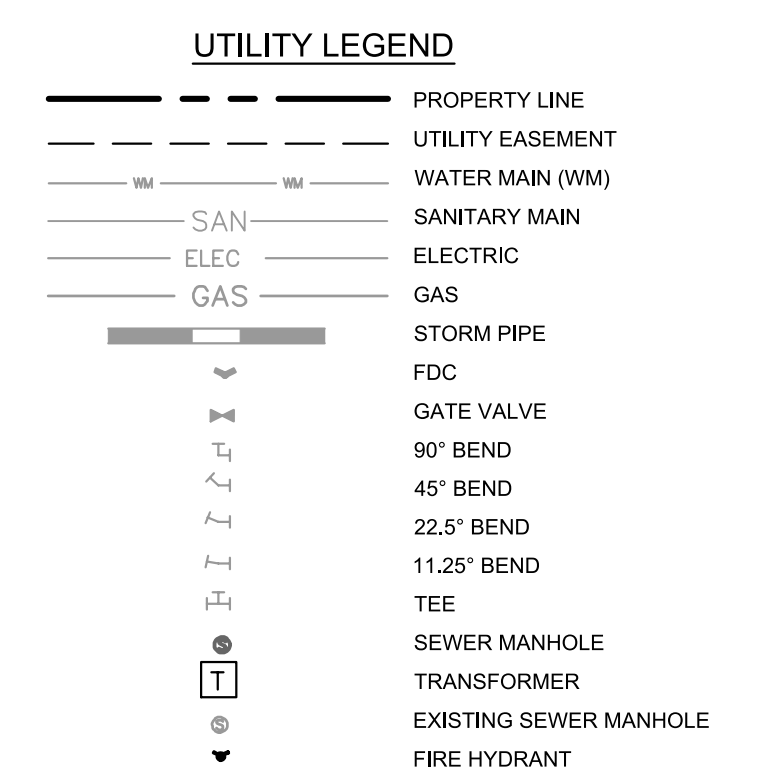
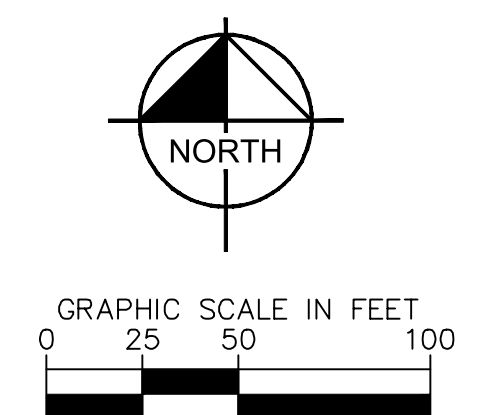
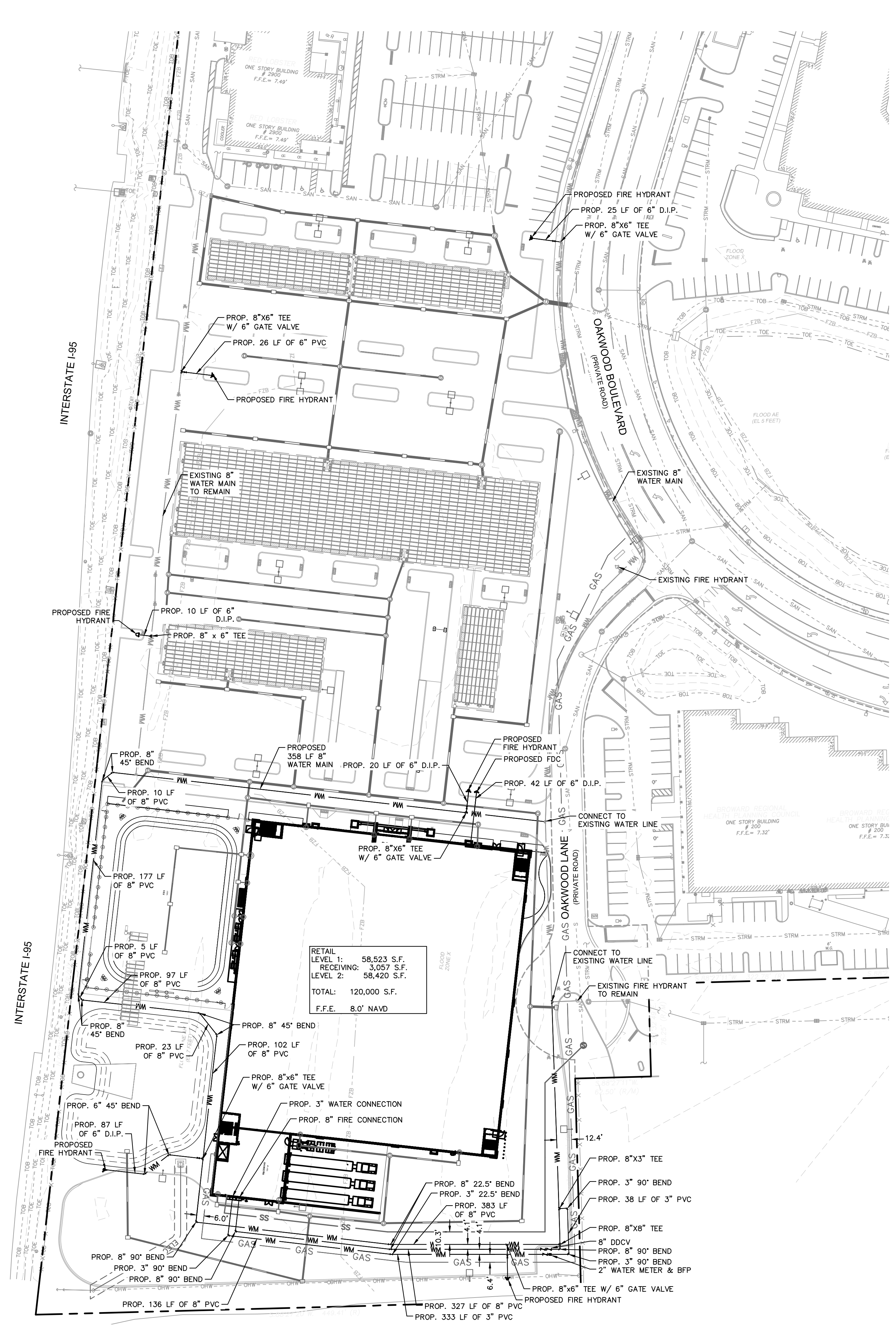

FIRE UTILITY NOTE

- ALL UNDERGROUND FIRE MAIN WORK MUST BE COMPLETED BY FIRE PROTECTION CONTRACTOR HOLDING A CLASS I, II, OR V LICENSE PER FS 633.102.
- WATER SUPPLY AND ANY NEW HYDRANTS SHALL BE IN PLACE PRIOR TO ACCUMULATION OF COMBUSTIBLE MATERIALS PER NFPA 1 (2021 ED.) SECTION 16.5.3.1.1.
- BE ADVISED THAT NFPA 1 (2021 EDITION) SECTION 11.10.2 REQUIRES THAT MINIMUM RADIO SIGNAL STRENGTH FOR FIRE DEPARTMENT COMMUNICATIONS SHALL BE MAINTAINED AT A LEVEL DETERMINED BY THE AHJ FOR ALL NEW AND EXISTING BUILDINGS. — IF AT ANY TIME (INCLUDING THE CONSTRUCTION PHASE), FIRE DEPARTMENT PERSONNEL DETERMINE THAT THE MINIMUM RADIO SIGNAL STRENGTH IS NOT BEING MET, A TWO-WAY RADIO COMMUNICATION ENHANCEMENT SYSTEM MAY BE REQUIRED TO BE INSTALLED AS DETERMINED BY THE AHJ.

- UTILITY NOTES**
- ALL FILL MATERIAL IS TO BE IN PLACE AND COMPACTED BEFORE INSTALLATION OF PROPOSED UTILITIES.
 - CONTRACTOR SHALL NOTIFY THE UTILITY AUTHORITIES INSPECTORS 72 HOURS BEFORE CONNECTING TO ANY EXISTING LINE.
 - SANITARY SEWER PIPE SHALL BE AS FOLLOWS:
8" PVC SDR35 PER ASTM D 3034, FOR PIPES LESS THAN 12' DEEP
8" PVC SDR26 PER ASTM D 3034, FOR PIPES MORE THAN 12' DEEP
6" PVC SCHEDULE 40
DUCTILE IRON PIPE PER AWWA C150
 - WATER LINES SHALL BE AS FOLLOWS:
6" AND LARGER, PVC C-900 PER ASTM D 2241 CLASS 200 UNDER COUNTY ROADS, OTHERWISE CLASS 150
6" AND LARGER DUCTILE IRON PIPE PER AWWA C150
SMALLER THAN 6" EITHER COPPER TUBE TYPE "L" (SOFT) PER ANSI 816.22 OR PVC, 200 P.S.I., PER ASTM D1784 AND D2241.
 - MINIMUM TRENCH WIDTH SHALL BE 2 FEET.
 - ALL WATER JOINTS ARE TO BE MECHANICAL JOINTS WITH THRUST BLOCKING AS CALLED OUT IN SPECIFICATIONS.
 - ALL UTILITIES SHOULD BE KEPT TEN (10') APART (PARALLEL) OR WHEN CROSSING 18" VERTICAL CLEARANCE (OUTSIDE EDGE OF PIPE TO OUTSIDE EDGE OF PIPE).
 - CONTRACTOR SHALL MAINTAIN A MINIMUM OF 4" COVER ON ALL WATER LINES.
 - IN THE EVENT OF A VERTICAL CONFLICT BETWEEN WATER LINES, SANITARY LINES, STORM LINES AND GAS LINES (EXISTING AND PROPOSED), THE SANITARY LINE SHALL BE DUCTILE IRON PIPE WITH MECHANICAL JOINTS AT LEAST 10 FEET ON BOTH SIDES OF CROSSING. THE WATER LINE SHALL HAVE MECHANICAL JOINTS WITH APPROPRIATE THRUST BLOCKING AS REQUIRED TO PROVIDE A MINIMUM OF 18" CLEARANCE, MEETING REQUIREMENTS OF ANSI A21.10 OR ANSI 21.11 (AWWA C-151) (CLASS 50).
 - UNDERGROUND LINES SHALL BE INSTALLED, INSPECTED AND APPROVED BEFORE BACKFILLING.
 - TOPS OF EXISTING MANHOLES SHALL BE RAISED AS NECESSARY TO BE FLUSH WITH PROPOSED PAVEMENT ELEVATIONS WITHIN PAVED AREAS, AND TO BE ONE FOOT ABOVE FINISHED GROUND ELEVATIONS WITH WATER TIGHT LIDS WITH LANDSCAPED AREAS.
 - ALL CONCRETE FOR ENCASEMENTS SHALL HAVE A MINIMUM 28 DAY COMPRESSION STRENGTH AT 3000 P.S.I.
 - EXISTING UTILITIES SHALL BE VERIFIED IN FIELD PRIOR TO INSTALLATION OF ANY NEW LINES.
 - CONTRACTOR IS RESPONSIBLE FOR COMPLYING TO THE SPECIFICATIONS OF THE LOCAL AUTHORITIES (ANY CITY) WITH REGARDS TO MATERIALS AND INSTALLATION OF THE WATER AND SEWER LINES.
 - THE CONTRACTOR IS SPECIFICALLY CAUTIONED THAT THE LOCATION AND/OR ELEVATION OF EXISTING UTILITIES AS SHOWN ON THESE PLANS IS BASED ON RECORDS OF THE VARIOUS UTILITY COMPANIES, AND WHERE POSSIBLE, MEASUREMENTS TAKEN IN THE FIELD. THE INFORMATION IS NOT TO BE RELIED ON AS BEING EXACT OR COMPLETE. THE CONTRACTOR MUST CALL THE APPROPRIATE UTILITY COMPANIES AT LEAST 72 HOURS BEFORE ANY EXCAVATION TO REQUEST EXACT FIELD LOCATION OF UTILITIES. IT SHALL BE THE RESPONSIBILITY OF THE CONTRACTOR TO RELOCATE ALL EXISTING UTILITIES WHICH CONFLICT WITH THE PROPOSED IMPROVEMENTS SHOWN ON THE PLANS.
 - CONTRACTOR IS RESPONSIBLE FOR ALL NECESSARY INSPECTIONS AND/OR CERTIFICATIONS REQUIRED BY CODES AND/OR UTILITY SERVICE COMPANIES. THIS AND THE FINAL CONNECTIONS OF THE SERVICE SHALL BE COMPLETED 30 DAYS PRIOR TO STORE POSSESSION.
 - CONTRACTOR SHALL COORDINATE WITH ALL UTILITY COMPANIES FOR INSTALLATION REQUIREMENTS AND SPECIFICATIONS.
 - REFER TO BUILDING PLANS FOR SITE LIGHTING ELECTRICAL PLAN.
 - UNDERGROUND UTILITY LINES SHALL BE INSTALLED, INSPECTED AND APPROVED BEFORE BACKFILLING.
 - REFER TO INTERIOR PLUMBING DRAWINGS FOR TIE-IN OF ALL UTILITIES.
 - THE CONTRACTOR SHALL BE RESPONSIBLE FOR LOCATING EXISTING WATER MAINS, FORCE MAINS, SANITARY SEWER AND STORM MAINS AND MAINTAIN MINIMUM CLEARANCES BETWEEN WATER MAINS AND OTHER UTILITIES AT ALL POINTS ALONG THEIR LENGTH AS REQUIRED IN THE PLANS, DETAILS AND SPECIFICATIONS.
 - CONTRACTOR IS RESPONSIBLE FOR ALL NECESSARY INSPECTIONS AND/OR CERTIFICATIONS REQUIRED BY CODES AND/OR UTILITY SERVICE COMPANIES. THIS AND THE FINAL CONNECTIONS OF THE SERVICE SHALL BE COMPLETED 30 DAYS PRIOR TO STORE POSSESSION.
 - THE ENTIRE FIRE SERVICE FROM BUILDING TO CONNECTION POINT IS TO BE INSTALLED BY A LICENSED UTILITY CONTRACTOR HOLDING A "CONTRACTOR V" LICENSE IN ACCORDANCE WITH CH. 489 OF THE FLORIDA STATUTES.
 - ALL UTILITY MAIN LENGTHS SHOWN ARE APPROXIMATE.

POTABLE WATER IMPACT			
Use	Calculation	Total	
Existing	Regal Cinemas Movie Theater 4 GPD per seat (4 GPD/seat x 2,504 seats)	10,016 GPD	
Proposed	Retail (Commercial) 120,000 SF 0.1 GPD per SF (120,000 s.f. x 0.1 GPD)	12,000 GPD	
Total Existing and Proposed		(-) 1,984 GPD	

SANITARY SEWER IMPACT			
Use	Calculation	Total	
Existing	Regal Cinemas Movie Theater 4 GPD per seat (4 GPD/seat x 2,504 seats)	10,016 GPD	
Proposed	Retail (Commercial) 120,000 SF 0.1 GPD per SF (120,000 s.f. x 0.1 GPD)	12,000 GPD	
Total Existing and Proposed		(-) 1,984 GPD	

RETAIL LEVEL 1: 58,523 S.F.
RECEIVING: 3,057 S.F.
LEVEL 2: 58,420 S.F.
TOTAL: 120,000 S.F.
F.F.E. 8.0' NAVD

NO.	REVISIONS	DATE	BY

Kimley»Horn
© 2024 KIMLEY-HORN AND ASSOCIATES, INC.
445 24TH STREET, SUITE 200, VERO BEACH, FL 32960
PHONE: 772-794-4100
WWW.KIMLEY-HORN.COM
REGISTRY NO. 35106

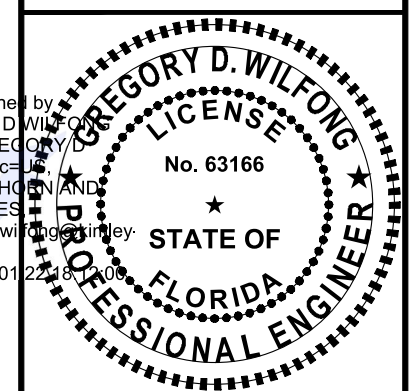

KHA PROJECT	147507151
DATE	9/3/2024
SCALE	AS SHOWN
DESIGNED BY	SHB
DRAWN BY	SHB
CHECKED BY	GDW

THIS ITEM HAS BEEN DIGITALLY SIGNED AND SEALED BY GREGORY D. WILFONG, P.E. ON THE DATE ADJACENT TO THE SEAL. PRINTED DOCUMENT ARE NOT CONSIDERED SIGNED AND SEALED. THE DIGITAL SIGNATURE MUST BE VERIFIED ON ANY ELECTRONIC COPIES.

OAKWOOD SOUTH RETAIL SHOPPING CENTER
CITY OF HOLLYWOOD, FL

SHEET NUMBER
C-401

This document, together with the concepts and designs presented herein, is an instrument of service. It is intended only for the specific purpose and client for which it was prepared. No other use or reliance on this document without written authorization and adaptation by Kimley-Horn and Associates, Inc. shall be without liability to Kimley-Horn and Associates, Inc.

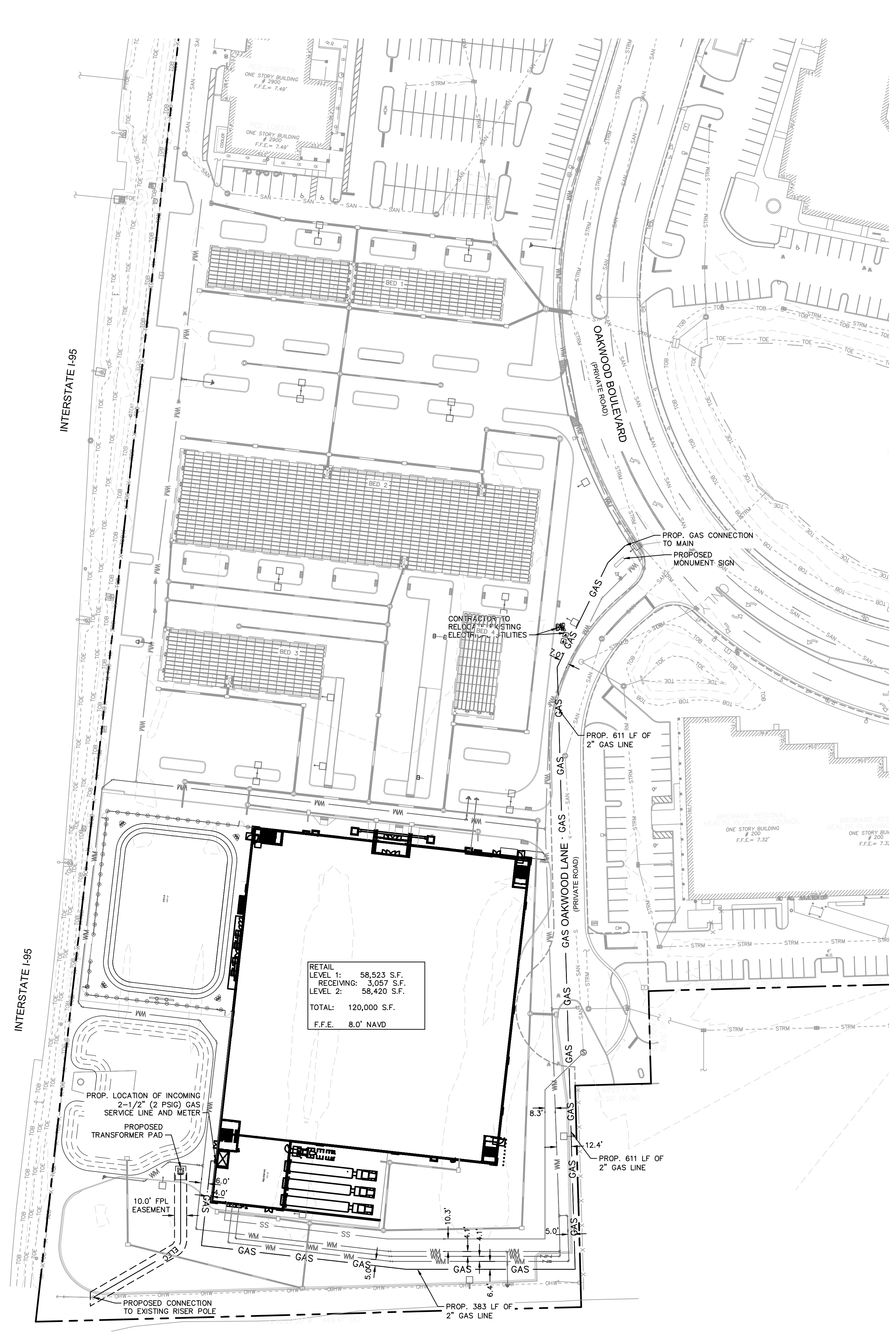

RETAIL
 LEVEL 1: 58,523 S.F.
 RECEIVING: 3,057 S.F.
 LEVEL 2: 58,420 S.F.
 TOTAL: 120,000 S.F.
 F.F.E. 8.0' NAVD

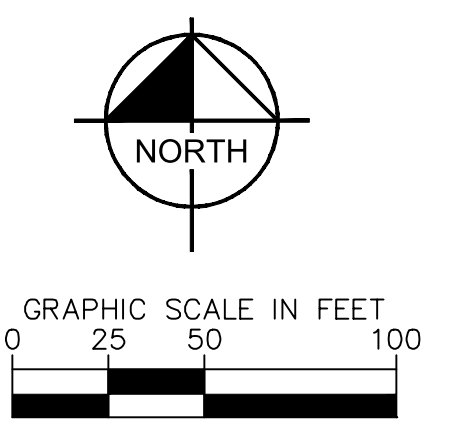

UTILITY LEGEND

---	PROPERTY LINE
---	UTILITY EASEMENT
WM	WATER MAIN (WM)
---	SANITARY MAIN
SAN	SANITARY MAIN
ELEC	ELECTRIC
GAS	GAS
---	STORM PIPE
FDG	FDG
---	GATE VALVE
---	90° BEND
---	45° BEND
---	22.5° BEND
---	11.25° BEND
---	TEE
---	SEWER MANHOLE
---	TRANSFORMER
---	EXISTING SEWER MANHOLE

UTILITY NOTES

- ALL FILL MATERIAL IS TO BE IN PLACE AND COMPACTED BEFORE INSTALLATION OF PROPOSED UTILITIES.
- CONTRACTOR SHALL NOTIFY THE UTILITY AUTHORITIES INSPECTORS 72 HOURS BEFORE CONNECTING TO ANY EXISTING LINE.
- SANITARY SEWER PIPE SHALL BE AS FOLLOWS:
 8" PVC SDR35 PER ASTM D 3034, FOR PIPES LESS THAN 12' DEEP
 8" PVC SDR35 PER ASTM D 3034, FOR PIPES MORE THAN 12' DEEP
 6" PVC SCHEDULE 40
 DUCTILE IRON PIPE PER AWWA C150
- WATER LINES SHALL BE AS FOLLOWS:
 6" AND LARGER, PVC C-900 PER ASTM D 2241 CLASS 200 UNDER COUNTY ROADS, OTHERWISE CLASS 150
 6" AND LARGER DUCTILE IRON PIPE PER AWWA C150
 SMALLER THAN 6" EITHER COPPER TUBE TYPE "L" (SOFT) PER ANSI 816.22 OR PVC, 200 P.S.I., PER ASTM D1784 AND D2241.
- MINIMUM TRENCH WIDTH SHALL BE 2 FEET.
- ALL WATER JOINTS ARE TO BE MECHANICAL JOINTS WITH THRUST BLOCKING AS CALLED OUT IN SPECIFICATIONS.
- ALL UTILITIES SHOULD BE KEPT TEN (10') APART (PARALLEL) OR WHEN CROSSING 18" VERTICAL CLEARANCE (OUTSIDE EDGE OF PIPE TO OUTSIDE EDGE OF PIPE).
- CONTRACTOR SHALL MAINTAIN A MINIMUM OF 4" COVER ON ALL WATER LINES.
- IN THE EVENT OF A VERTICAL CONFLICT BETWEEN WATER LINES, SANITARY LINES, STORM LINES AND GAS LINES (EXISTING AND PROPOSED), THE SANITARY LINE SHALL BE DUCTILE IRON PIPE WITH MECHANICAL JOINTS AT LEAST 10 FEET ON BOTH SIDES OF CROSSING. THE WATER LINE SHALL HAVE MECHANICAL JOINTS WITH APPROPRIATE THRUST BLOCKING AS REQUIRED TO PROVIDE A MINIMUM OF 18" CLEARANCE, MEETING REQUIREMENTS OF ANSI A21.10 OR ANSI 21.11 (AWWA C-151) (CLASS 50).
- UNDERGROUND LINES SHALL BE INSTALLED, INSPECTED AND APPROVED BEFORE BACKFILLING.
- TOPS OF EXISTING MANHOLES SHALL BE RAISED AS NECESSARY TO BE FLUSH WITH PROPOSED PAVEMENT ELEVATIONS WITHIN PAVED AREAS, AND TO BE ONE FOOT ABOVE FINISHED GROUND ELEVATIONS WITHIN UNPAVED AREAS.
- ALL CONCRETE FOR ENCASEMENTS SHALL HAVE A MINIMUM 28 DAY COMPRESSION STRENGTH AT 3000 P.S.I.
- EXISTING UTILITIES SHALL BE VERIFIED IN FIELD PRIOR TO INSTALLATION OF ANY NEW LINES.
- REFER TO INTERIOR PLUMBING DRAWINGS FOR TIE-IN OF ALL UTILITIES.
- CONTRACTOR IS RESPONSIBLE FOR COMPLYING TO THE SPECIFICATIONS OF THE LOCAL AUTHORITIES (ANY CITY) WITH REGARDS TO MATERIALS AND INSTALLATION OF THE WATER AND SEWER LINES.
- THE CONTRACTOR IS SPECIFICALLY CAUTIONED THAT THE LOCATION AND/OR ELEVATION OF EXISTING UTILITIES AS SHOWN ON THESE PLANS IS BASED ON RECORDS OF THE VARIOUS UTILITY COMPANIES, AND WHERE POSSIBLE, MEASUREMENTS TAKEN IN THE FIELD. THE INFORMATION IS NOT TO BE RELIED ON AS BEING EXACT OR COMPLETE. THE CONTRACTOR MUST CALL THE APPROPRIATE UTILITY COMPANIES AT LEAST 72 HOURS BEFORE ANY EXCAVATION TO REQUEST EXACT FIELD LOCATION OF UTILITIES. IT SHALL BE THE RESPONSIBILITY OF THE CONTRACTOR TO RELOCATE ALL EXISTING UTILITIES WHICH CONFLICT WITH THE PROPOSED IMPROVEMENTS SHOWN ON THE PLANS.
- CONTRACTOR IS RESPONSIBLE FOR ALL NECESSARY INSPECTIONS AND/OR CERTIFICATIONS REQUIRED BY CODES AND/OR UTILITY SERVICE COMPANIES. THIS AND THE FINAL CONNECTIONS OF THE SERVICE SHALL BE COMPLETED 30 DAYS PRIOR TO STORE POSSESSION.
- CONTRACTOR SHALL COORDINATE WITH ALL UTILITY COMPANIES FOR INSTALLATION REQUIREMENTS AND SPECIFICATIONS.
- REFER TO BUILDING PLANS FOR SITE LIGHTING ELECTRICAL PLAN.
- UNDERGROUND UTILITY LINES SHALL BE INSTALLED, INSPECTED AND APPROVED BEFORE BACKFILLING.
- REFER TO INTERIOR PLUMBING DRAWINGS FOR TIE-IN OF ALL UTILITIES.
- REFER TO INTERIOR PLUMBING DRAWINGS FOR LOCATING EXISTING WATER MAINS, FORCE MAINS, SANITARY SEWER AND STORM MAINS AND MAINTAIN MINIMUM CLEARANCES BETWEEN WATER MAINS AND OTHER UTILITIES AT ALL POINTS ALONG THEIR LENGTH AS REQUIRED IN THE PLANS, DETAILS AND SPECIFICATIONS.
- CONTRACTOR IS RESPONSIBLE FOR ALL NECESSARY INSPECTIONS AND/OR CERTIFICATIONS REQUIRED BY CODES AND/OR UTILITY SERVICE COMPANIES. THIS AND THE FINAL CONNECTIONS OF THE SERVICE SHALL BE COMPLETED 30 DAYS PRIOR TO STORE POSSESSION.
- THE ENTIRE FIRE SERVICE FROM BUILDING TO CONNECTING TO EXISTING FIRE SERVICE SHALL BE COMPLETED 30 DAYS PRIOR TO STORE POSSESSION.
- ALL UTILITY MAIN LENGTHS SHOWN ARE APPROXIMATE.

Digitally signed by
 GREGORY D WILFONG
 License No. 35166
 STATE OF
 FLORIDA
 PROFESSIONAL ENGINEER
 email=greg.wilfong@kimley-horn.com
 Date: 2025.01.22 18:05:00

Kimley»Horn

© 2024 KIMLEY-HORN AND ASSOCIATES, INC.
 445 24TH STREET, SUITE 200, VERO BEACH, FL 32960
 WWW.KIMLEY-HORN.COM REGISTRY NO. 35106

KHA PROJECT	147507151	DATE	9/3/2024	SCALE	AS SHOWN
DESIGNED BY	SHB	DRAWN BY	SHB	CHECKED BY	GDW

DRY UTILITY PLAN

**OAKWOOD SOUTH
 RETAIL SHOPPING
 CENTER**

CITY OF HOLLYWOOD

THIS ITEM HAS BEEN DIGITALLY SIGNED AND SEALED BY GREGORY D. WILFONG, P.E. ON THE DATE ADJACENT TO THE SEAL. PRINTED COPY OF THIS DOCUMENT ARE NOT CONSIDERED SIGNED AND SEALED AND THE DIGITAL SIGNATURE MUST BE VERIFIED ON ANY ELECTRONIC COPIES.

SHEET NUMBER
C-402

REVISONS	DATE

This document, together with the concepts and designs presented herein, is an instrument of service. It is intended only for the specific purpose and client for which it was prepared. Reuse of and improper reliance on this document without written authorization and adaptation by Kimley-Horn and Associates, Inc. shall be without liability to Kimley-Horn and Associates, Inc.

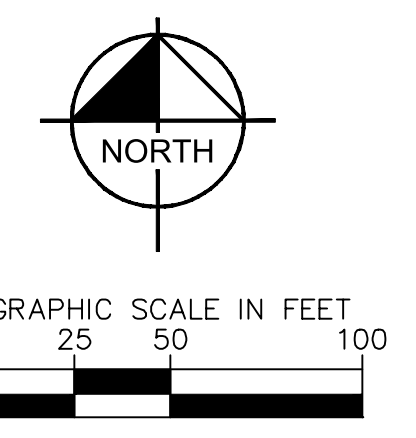
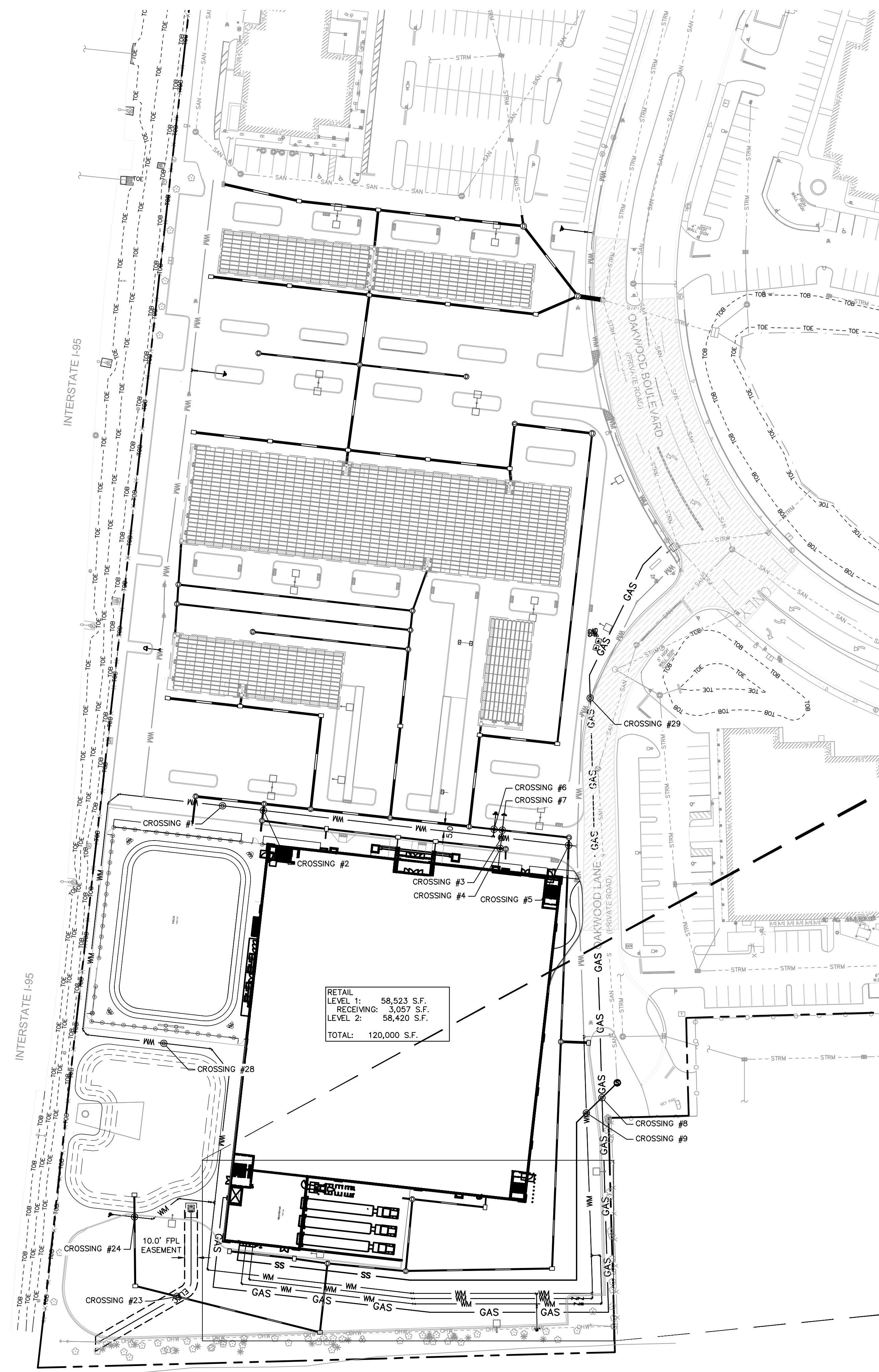

UTILITY CROSSING TABLE		
CROSSING	UTILITIES	INVERT EL.
1	12" STORM	3.48
	8" WATER	2.44
2	12" STORM	4.61
	8" WATER	3.49
3	8" WATER	3.62
	6" WATER	2.12
4	12" STORM	4.97
	6" WATER	2.62
5	12" STORM	3.98
	8" WATER	2.94
6	12" STORM	4.61
	6" WATER	3.52
7	12" STORM	4.61
	6" WATER	2.62
8	2" GAS	3.14
	6" SANITARY	1.45
9	8" WATER	2.91
	6" SANITARY	1.87
10	8" WATER	3.11
	6" WATER	2.11
11	3" WATER	3.53
	6" WATER	2.11
12	2" GAS	3.63
	6" WATER	2.11
13	6" SANITARY	4.75
	12" STORM	2.35
14	8" WATER	3.47
	12" STORM	2.35
15	8" WATER	3.39
	12" STORM	2.35

UTILITY CROSSING TABLE		
CROSSING	UTILITIES	INVERT EL.
16	3" WATER	3.73
	12" STORM	2.35
17	2" GAS	3.73
	12" STORM	2.35
18	6" SANITARY	5.37
	8" WATER	4.30
19	8" WATER	3.53
	8" WATER	2.54
20	2" GAS	5.43
	8" WATER	4.42
21	6" SANITARY	5.42
	3" WATER	4.32
22	3" WATER	4.02
	8" WATER	2.54
23	12" STORM	3.98
	ELECTRIC DUCT	2.83
24	12" STORM	3.98
	6" WATER	2.92
25	8" WATER	3.70
	12" STORM	2.70
26	3" WATER	4.11
	12" STORM	2.73
27	6" SANITARY	5.54
	12" STORM	2.75
28	12" STORM	3.48
	8" WATER	2.48
29	8" WATER	2.86*
	2" GAS	1.86

*ASSUMED DEPTH

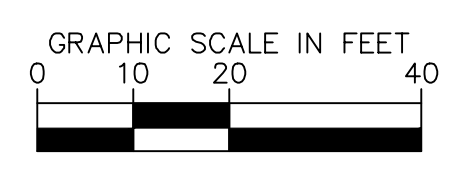
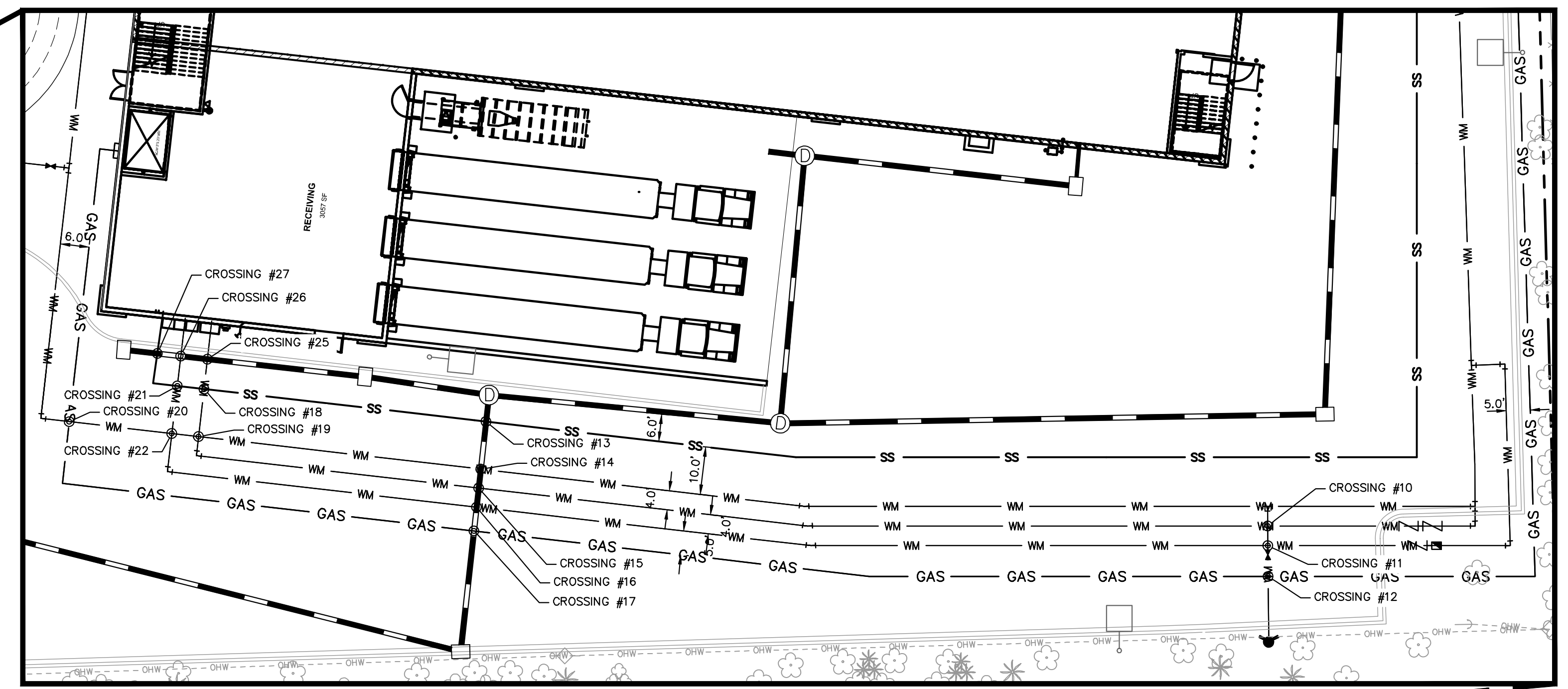

GREGORY D. WILFONG
 PROFESSIONAL ENGINEER
 No. 63166
 STATE OF FLORIDA

NO.	REVISIONS	DATE	BY

Kimley»Horn
 © 2024 KIMLEY-HORN AND ASSOCIATES, INC.
 445 24TH STREET, SUITE 200, VERO BEACH, FL 32960
 PHONE: 772-794-4100
 WWW.KIMLEY-HORN.COM
 REGISTRY NO. 35106

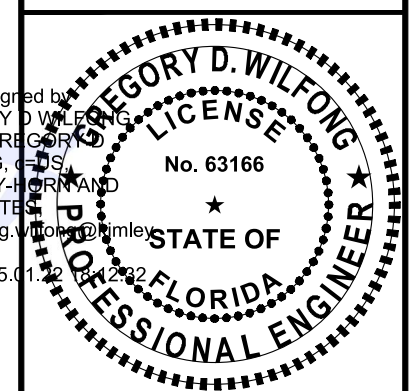

K/A PROJECT	147507151
DATE	9/3/2024
SCALE	AS SHOWN
DESIGNED BY	SHB
DRAWN BY	SHB
CHECKED BY	GDW

UTILITY CROSSING PLAN

OAKWOOD SOUTH
 RETAIL SHOPPING
 CENTER
 CITY OF HOLLYWOOD, FL

SHEET NUMBER
C-403

THIS ITEM HAS BEEN DIGITALLY SIGNED AND SEALED BY GREGORY D. WILFONG, P.E. ON THE DATE ADJACENT TO THE SEAL. PRINTED DOCUMENT ARE NOT CONSIDERED SIGNED AND SEALED AND THE DIGITAL SIGNATURE MUST BE VERIFIED ON ANY ELECTRONIC COPIES.