

TYPICAL SECTION NO. 1
 NE 14TH AVE
 STA 100+00.00 TO STA 105+90.00
 (FROM ATLANTIC SHORES BLVD TO MOFFETT ST)

TRAFFIC DATA

CURRENT YEAR = 2017 AADT = 1,800
 ESTIMATED OPENING YEAR = 2018 AADT = 1,300
 ESTIMATED DESIGN YEAR = 2038 AADT = 8,800
 K = 9.00%
 D = 54.90%
 T = 3.40% (24 HOUR)
 DESIGN HOUR T = 1.70%
 DESIGN SPEED = 30 MPH

REVISIONS				MAJHARUL ALAM, PE P.E. LICENSE NUMBER 61600 PROPEL ENGINEERING, INC. 6685 FOREST HILL BLVD., SUITE 205 GREENACRES, FL 33413 CERTIFICATE OF AUTHORIZATION 00031050	STATE OF FLORIDA DEPARTMENT OF TRANSPORTATION			SHEET NO. 2
DATE	DESCRIPTION	DATE	DESCRIPTION		ROAD NO.	COUNTY	FINANCIAL PROJECT ID	
					14TH AVE	BROWARD	434690-1-52-02	

TYPICAL SECTION (1)

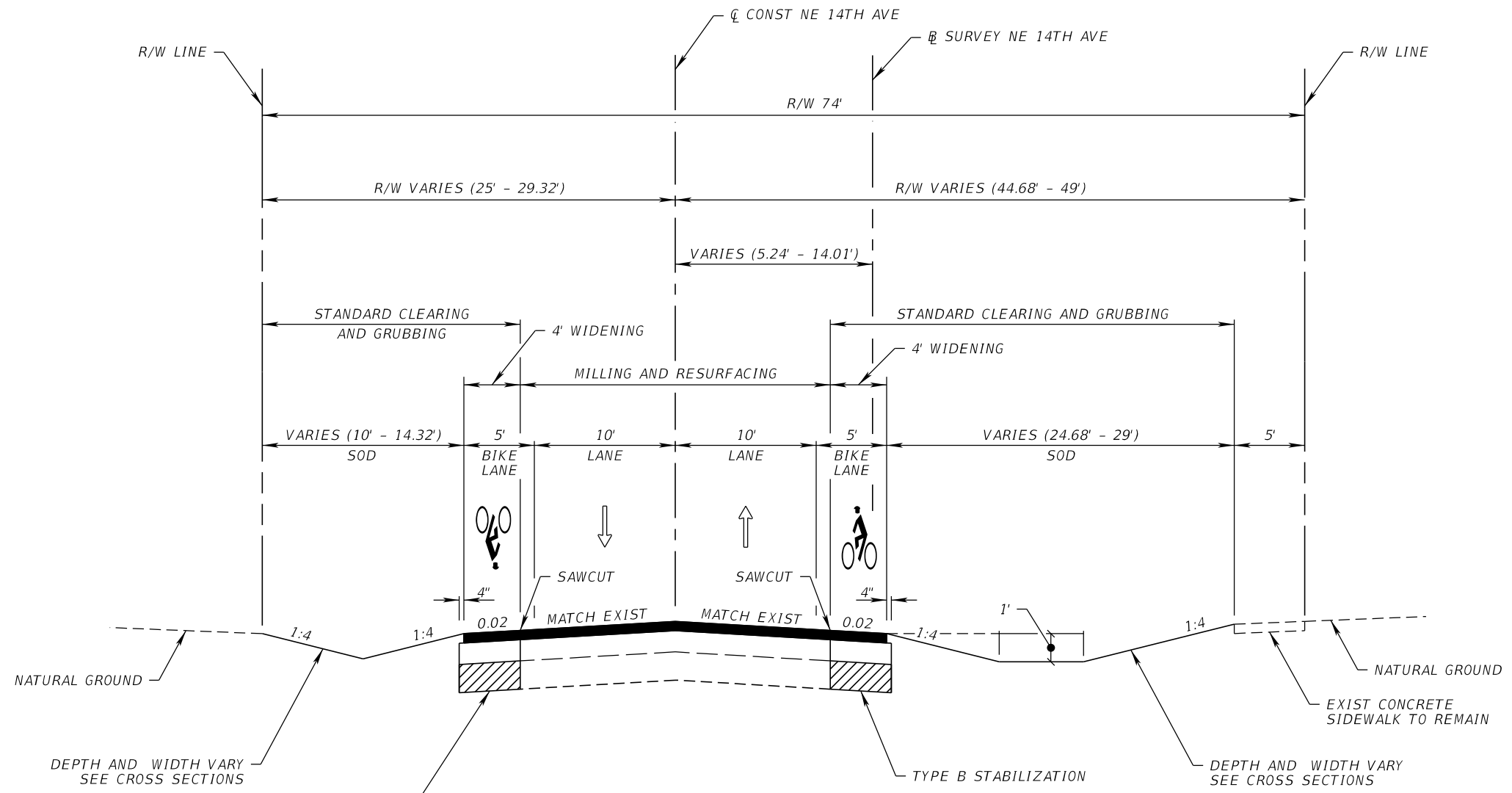

TYPICAL SECTION NO. 2
 NE 14TH AVE
 STA 105+90.00 TO 122+65.00
 (FROM MOFFETT ST TO RODMAN ST)

TRAFFIC DATA

CURRENT YEAR = 2017 AADT = 1,800
 ESTIMATED OPENING YEAR = 2018 AADT = 1,300
 ESTIMATED DESIGN YEAR = 2038 AADT = 8,800
 K = 9.00%
 D = 54.90%
 T = 3.40% (24 HOUR)
 DESIGN HOUR T = 1.70%
 DESIGN SPEED = 30 MPH

REVISIONS				MAJHARUL ALAM, PE P.E. LICENSE NUMBER 61600 PROPEL ENGINEERING, INC. 6685 FOREST HILL BLVD., SUITE 205 GREENACRES, FL 33413 CERTIFICATE OF AUTHORIZATION 00031050	STATE OF FLORIDA DEPARTMENT OF TRANSPORTATION			SHEET NO. 3
DATE	DESCRIPTION	DATE	DESCRIPTION		ROAD NO.	COUNTY	FINANCIAL PROJECT ID	
					14TH AVE	BROWARD	434690-1-52-02	

TYPICAL SECTION (2)

THE OFFICIAL RECORD OF THIS SHEET IS THE ELECTRONIC FILE DIGITALLY SIGNED AND SEALED UNDER RULE 61G15-23.004, F.A.C.

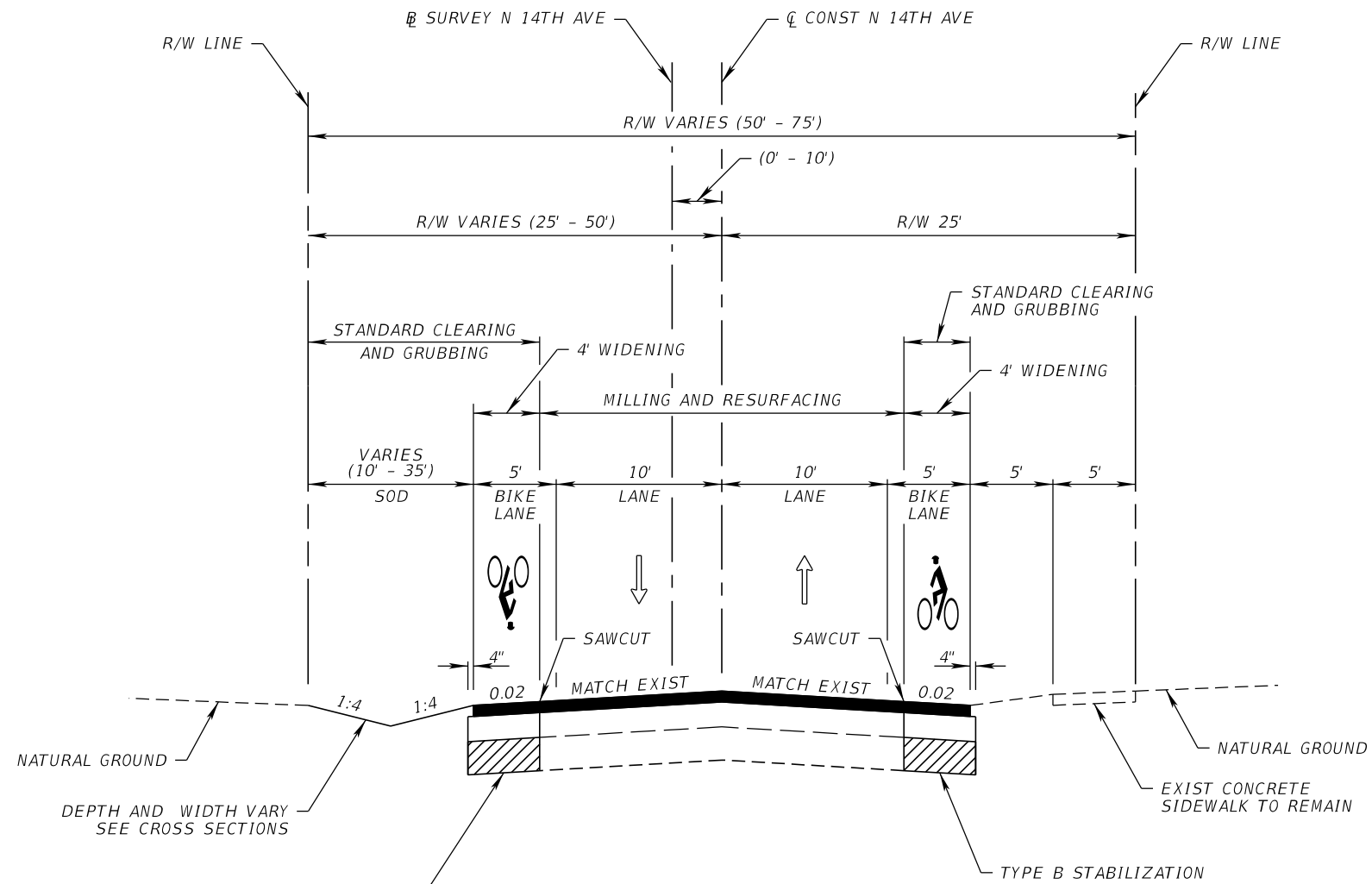

TYPICAL SECTION NO. 3
 N 14TH AVE
 STA 321+00.00 TO 340+00.00
 (FROM ARTHUR ST TO HARDING ST)

TRAFFIC DATA

CURRENT YEAR = 2017 AADT = 1,800
 ESTIMATED OPENING YEAR = 2018 AADT = 1,300
 ESTIMATED DESIGN YEAR = 2038 AADT = 8,800
 K = 9.00%
 D = 54.90%
 T = 3.40% (24 HOUR)
 DESIGN HOUR T = 1.70%
 DESIGN SPEED = 30 MPH

REVISIONS				MAJHARUL ALAM, PE P.E. LICENSE NUMBER 61600 PROPEL ENGINEERING, INC. 6685 FOREST HILL BLVD., SUITE 205 GREENACRES, FL 33413 CERTIFICATE OF AUTHORIZATION 00031050	STATE OF FLORIDA DEPARTMENT OF TRANSPORTATION			SHEET NO. 4
DATE	DESCRIPTION	DATE	DESCRIPTION		ROAD NO.	COUNTY	FINANCIAL PROJECT ID	
					14TH AVE	BROWARD	434690-1-52-02	

TYPICAL SECTION (3)

THE OFFICIAL RECORD OF THIS SHEET IS THE ELECTRONIC FILE DIGITALLY SIGNED AND SEALED UNDER RULE 61G15-23.004, F.A.C.

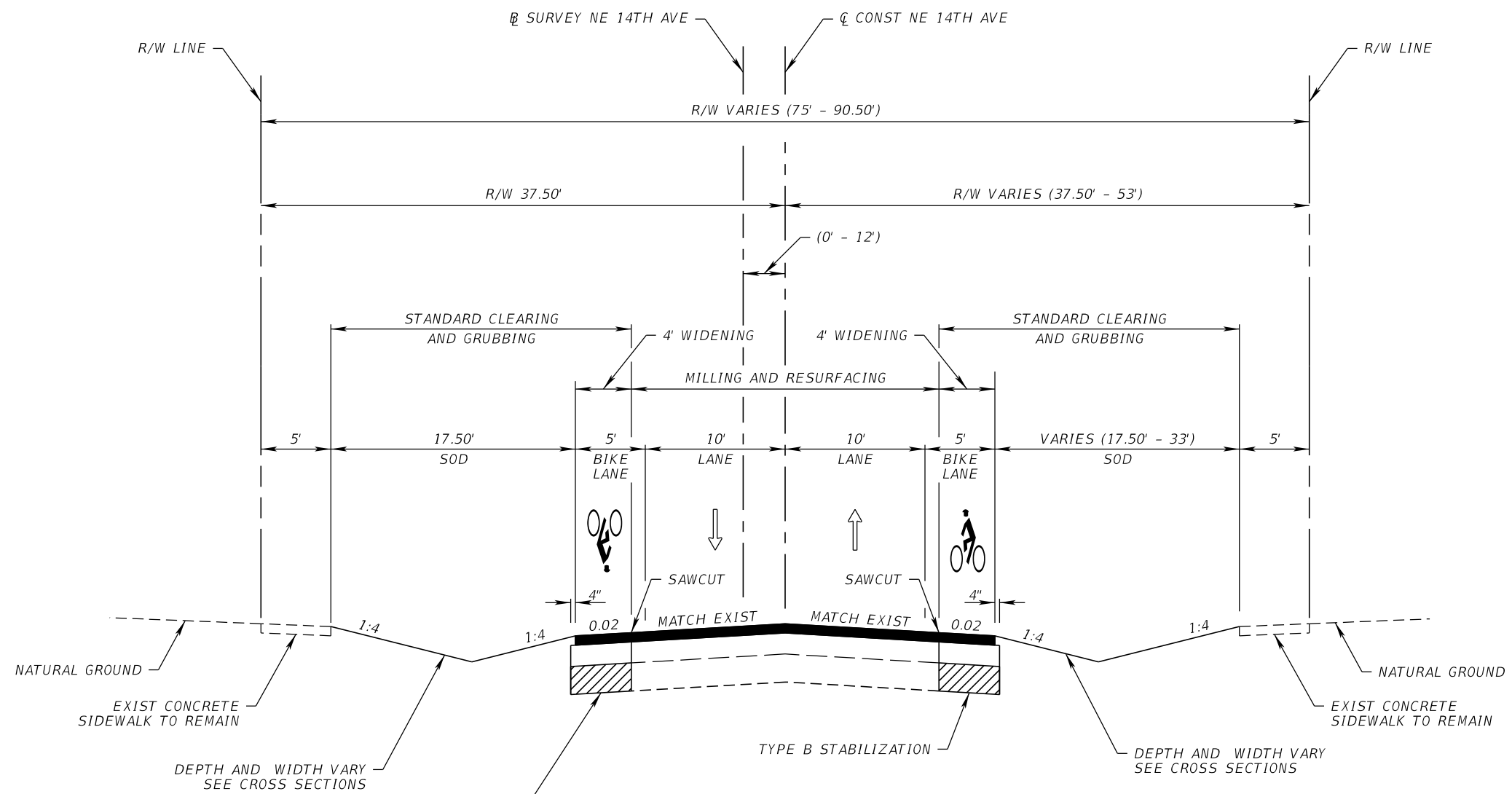

TYPICAL SECTION NO. 4
NE 14TH AVE
STA 343+29.00 TO STA 355+42.00
(FROM HARDING ST TO N. OF LEE ST)

TRAFFIC DATA

CURRENT YEAR = 2017 AADT = 1,800
 ESTIMATED OPENING YEAR = 2018 AADT = 1,300
 ESTIMATED DESIGN YEAR = AADT = 8,800
 K = 9.00%
 D = 54.90%
 T = 3.40% (24 HOUR)
 DESIGN HOUR T = 1.70%
 DESIGN SPEED = 30 MPH

REVISIONS				MAJHARUL ALAM, PE P.E. LICENSE NUMBER 61600 PROPEL ENGINEERING, INC. 6685 FOREST HILL BLVD., SUITE 205 GREENACRES, FL 33413 CERTIFICATE OF AUTHORIZATION 00031050	STATE OF FLORIDA DEPARTMENT OF TRANSPORTATION			TYPICAL SECTION (4)	SHEET NO. 5
DATE	DESCRIPTION	DATE	DESCRIPTION		ROAD NO.	COUNTY	FINANCIAL PROJECT ID		
					14TH AVE	BROWARD	434690-1-52-02		

THE OFFICIAL RECORD OF THIS SHEET IS THE ELECTRONIC FILE DIGITALLY SIGNED AND SEALED UNDER RULE 61G15-23.004, F.A.C.

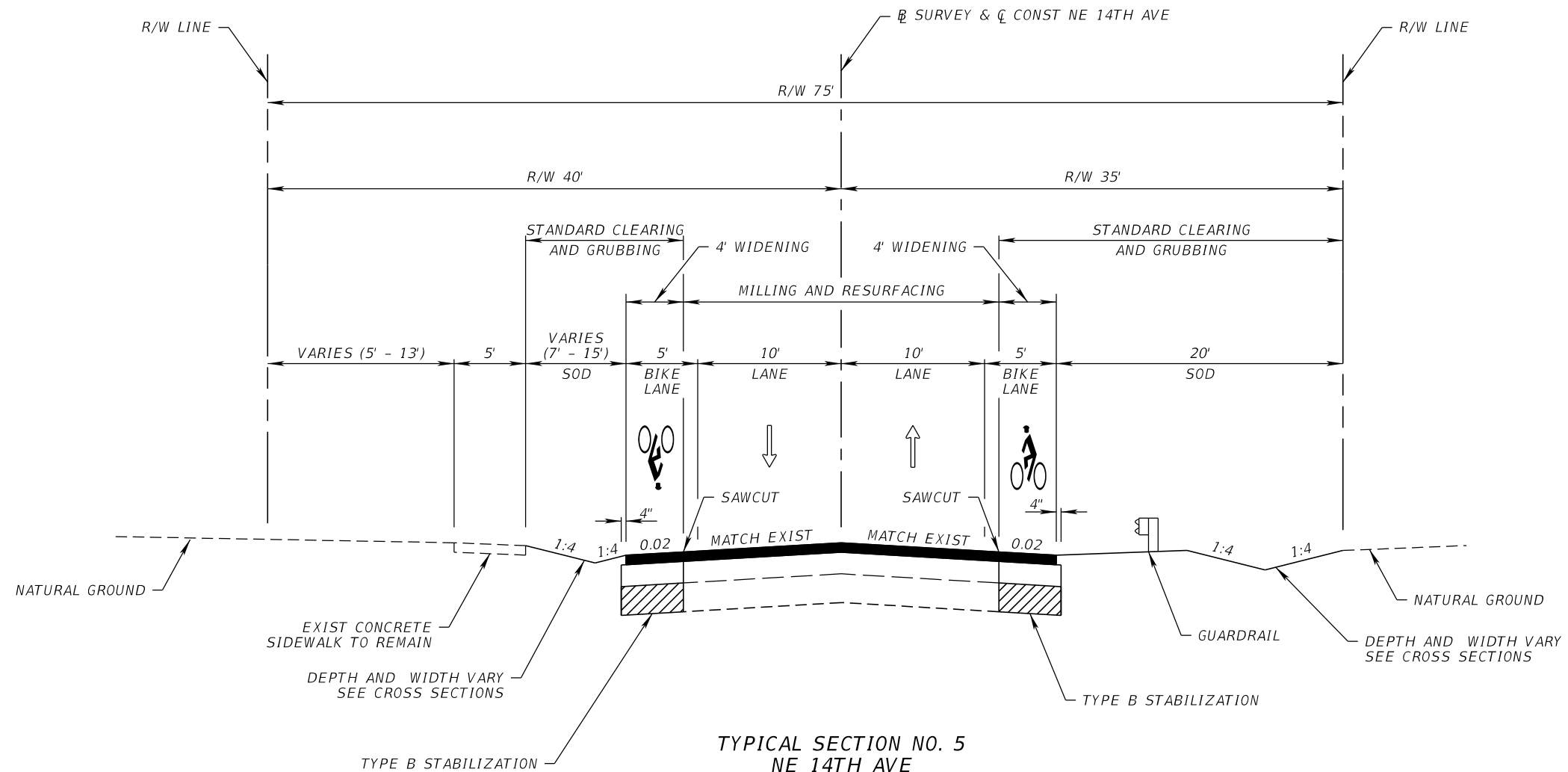

TYPICAL SECTION NO. 5
 NE 14TH AVE
 STA 355+42.00 TO STA 362+40.00
 (FROM N. OF LEE ST TO SHERIDAN ST)

TRAFFIC DATA

CURRENT YEAR = 2017 AADT = 1,800
 ESTIMATED OPENING YEAR = 2018 AADT = 1,300
 ESTIMATED DESIGN YEAR = 2038 AADT = 8,800
 K = 9.00%
 D = 54.90%
 T = 3.40% (24 HOUR)
 DESIGN HOUR T = 1.70%
 DESIGN SPEED = 30 MPH

REVISIONS				MAJHARUL ALAM, PE P.E. LICENSE NUMBER 61600 PROPEL ENGINEERING, INC. 6685 FOREST HILL BLVD., SUITE 205 GREENACRES, FL 33413 CERTIFICATE OF AUTHORIZATION 00031050	STATE OF FLORIDA DEPARTMENT OF TRANSPORTATION			SHEET NO. 6
DATE	DESCRIPTION	DATE	DESCRIPTION		ROAD NO.	COUNTY	FINANCIAL PROJECT ID	
					14TH AVE	BROWARD	434690-1-52-02	

TYPICAL SECTION (5)

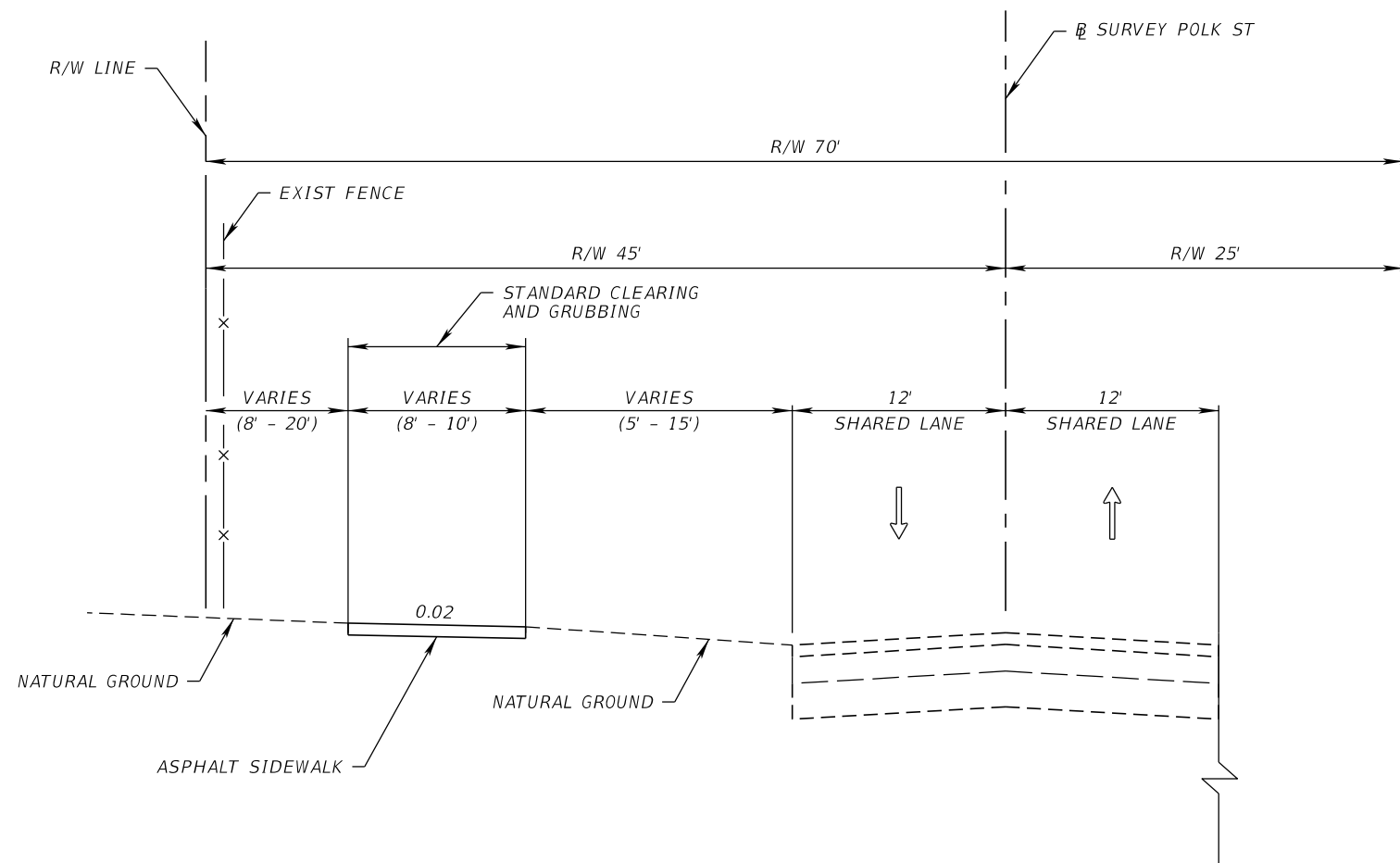

TYPICAL SECTION NO. 6
 NE 14TH AVE
 STA 80+78.00 TO STA 100+29.00
 (FROM POLK ST TO JOHNSON ST)

TRAFFIC DATA

CURRENT YEAR = 2017 AADT = 1,800
 ESTIMATED OPENING YEAR = 2018 AADT = 1,300
 ESTIMATED DESIGN YEAR = 2038 AADT = 8,800
 K = 9.00%
 D = 54.90%
 T = 3.40% (24 HOUR)
 DESIGN HOUR T = 1.70%
 DESIGN SPEED = 30 MPH

REVISIONS				MAJHARUL ALAM, PE P.E. LICENSE NUMBER 61600 PROPEL ENGINEERING, INC. 6685 FOREST HILL BLVD., SUITE 205 GREENACRES, FL 33413 CERTIFICATE OF AUTHORIZATION 00031050	STATE OF FLORIDA DEPARTMENT OF TRANSPORTATION			SHEET NO. 7
DATE	DESCRIPTION	DATE	DESCRIPTION		ROAD NO.	COUNTY	FINANCIAL PROJECT ID	
					14TH AVE	BROWARD	434690-1-52-02	

TYPICAL SECTION (6)

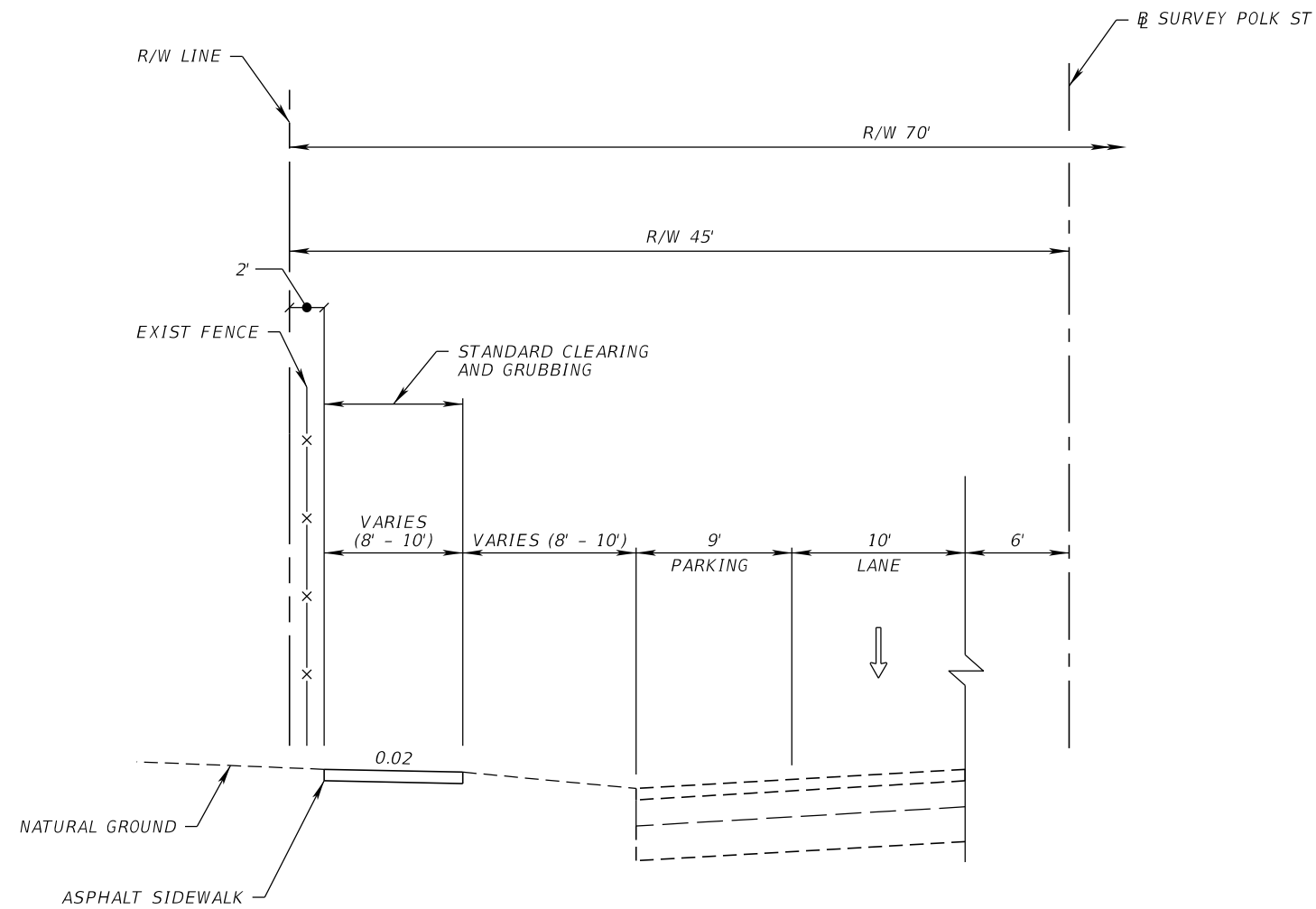

TYPICAL SECTION NO. 7
 POLK ST
 STA 9+60.00 TO STA 80+52.00
 (FROM 17TH AVE TO 14TH AVE)

REVISIONS				MAJHARUL ALAM, PE P.E. LICENSE NUMBER 61600 PROPEL ENGINEERING, INC. 6685 FOREST HILL BLVD., SUITE 205 GREENACRES, FL 33413 CERTIFICATE OF AUTHORIZATION 00031050	STATE OF FLORIDA DEPARTMENT OF TRANSPORTATION			TYPICAL SECTION (7)	SHEET NO. 8
DATE	DESCRIPTION	DATE	DESCRIPTION		ROAD NO.	COUNTY	FINANCIAL PROJECT ID		
					POLK ST	BROWARD	434690-1-52-02		