

SC-310 ISOLATOR ROW PLUS DETAIL
NTS

INSPECTION & MAINTENANCE

- STEP 1) INSPECT ISOLATOR ROW PLUS FOR SEDIMENT
- A. INSPECTION PORTS (IF PRESENT)
 - A.1. REMOVE/OPEN LID ON NYLOPLAST INLINE DRAIN
 - A.2. REMOVE AND CLEAN FLEXSTORM FILTER IF INSTALLED
 - A.3. USING A FLASHLIGHT AND STADIA ROD, MEASURE DEPTH OF SEDIMENT AND RECORD ON MAINTENANCE LOG
 - A.4. LOWER A CAMERA INTO ISOLATOR ROW PLUS FOR VISUAL INSPECTION OF SEDIMENT LEVELS (OPTIONAL)
 - A.5. IF SEDIMENT IS AT, OR ABOVE, 3" (80 mm) PROCEED TO STEP 2. IF NOT, PROCEED TO STEP 3.
 - B. ALL ISOLATOR PLUS ROWS
 - B.1. REMOVE COVER FROM STRUCTURE AT UPSTREAM END OF ISOLATOR ROW PLUS
 - B.2. USING A FLASHLIGHT, INSPECT DOWN THE ISOLATOR ROW PLUS THROUGH OUTLET PIPE
 - i) MIRRORS ON POLES OR CAMERAS MAY BE USED TO AVOID A CONFINED SPACE ENTRY
 - ii) FOLLOW OSHA REGULATIONS FOR CONFINED SPACE ENTRY IF ENTERING MANHOLE
 - B.3. IF SEDIMENT IS AT, OR ABOVE, 3" (80 mm) PROCEED TO STEP 2. IF NOT, PROCEED TO STEP 3.
- STEP 2) CLEAN OUT ISOLATOR ROW PLUS USING THE JETVAC PROCESS
- A. A FIXED CULVERT CLEANING NOZZLE WITH REAR FACING SPREAD OF 45" (1.1 m) OR MORE IS PREFERRED
 - B. APPLY MULTIPLE PASSES OF JETVAC UNTIL BACKFLUSH WATER IS CLEAN
 - C. VACUUM STRUCTURE SUMP AS REQUIRED
- STEP 3) REPLACE ALL COVERS, GRATES, FILTERS, AND LIDS; RECORD OBSERVATIONS AND ACTIONS.
- STEP 4) INSPECT AND CLEAN BASINS AND MANHOLES UPSTREAM OF THE STORMTECH SYSTEM.

NOTES

1. INSPECT EVERY 6 MONTHS DURING THE FIRST YEAR OF OPERATION. ADJUST THE INSPECTION INTERVAL BASED ON PREVIOUS OBSERVATIONS OF SEDIMENT ACCUMULATION AND HIGH WATER ELEVATIONS.
2. CONDUCT JETTING AND VACTORING ANNUALLY OR WHEN INSPECTION SHOWS THAT MAINTENANCE IS NECESSARY.

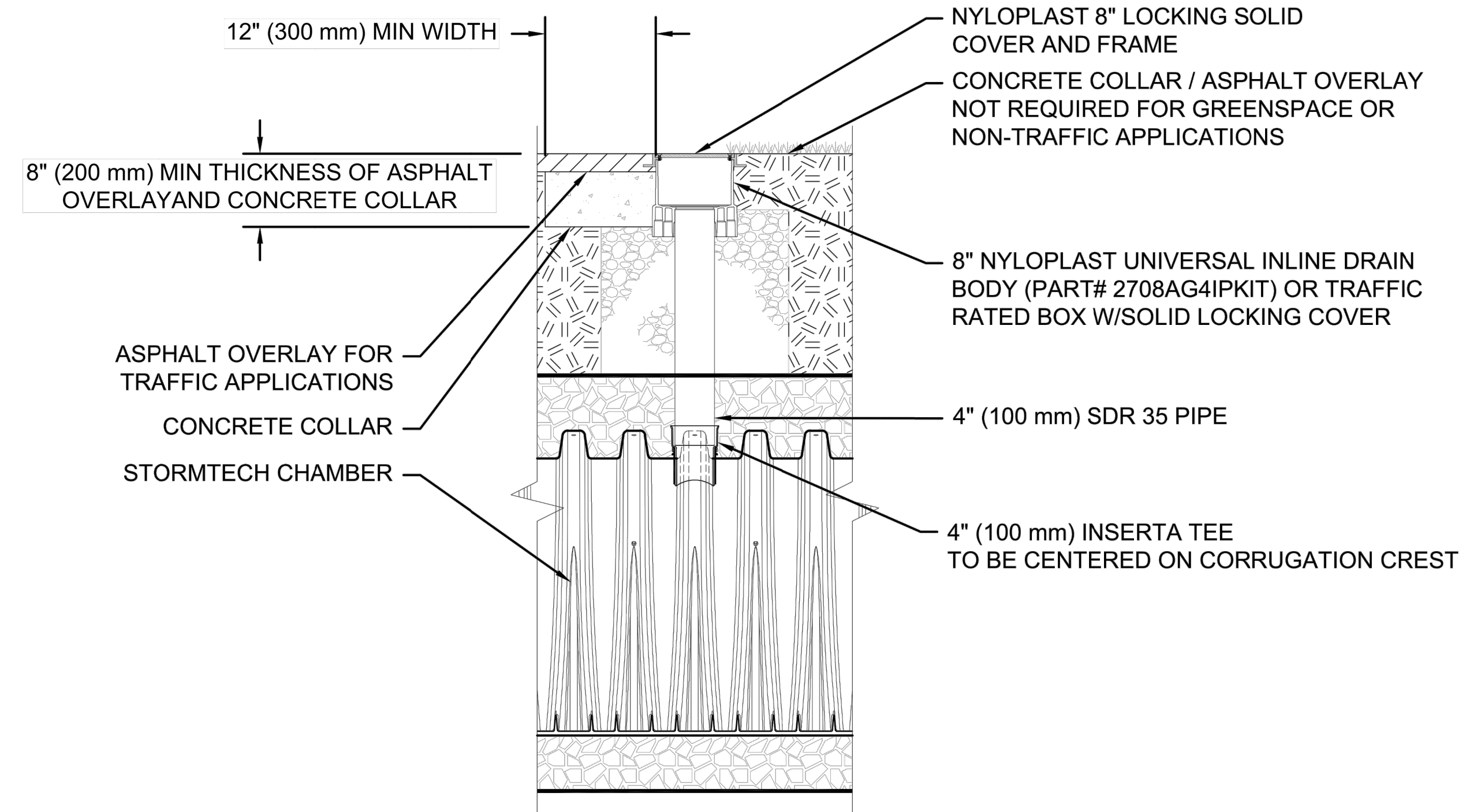

NOTE:
INSPECTION PORTS MAY BE CONNECTED THROUGH ANY CHAMBER CORRUGATION CREST.

4" PVC INSPECTION PORT DETAIL
(SC SERIES CHAMBER)
NTS

OAKWOOD SOUTH RETAIL
SHOPPING CENTER
HOLLYWOOD, FL, USA

DATE: 07/02/24
PROJECT #: S420513
DRAWN: MPV
CHECKED: -

DATE	DRW	CHK	DESCRIPTION

StormTech®
Chamber System
888-892-2694 | WWW.STORMTECH.COM

4640 TRUEMAN BLVD
HILLIARD, OH 43026
1-800-733-7473



THIS DRAWING HAS BEEN PREPARED BASED ON INFORMATION PROVIDED TO ADS UNDER THE DIRECTION OF THE SITE DESIGN ENGINEER OR OTHER PROJECT REPRESENTATIVE. THE SITE DESIGN ENGINEER SHALL REVIEW THIS DRAWING PRIOR TO CONSTRUCTION. IT IS THE ULTIMATE RESPONSIBILITY OF THE SITE DESIGN ENGINEER TO ENSURE THAT THE PRODUCT(S) DEPICTED AND ALL ASSOCIATED DETAILS MEET ALL APPLICABLE LAWS, REGULATIONS, AND PROJECT REQUIREMENTS.

SC-310 TECHNICAL SPECIFICATION

NTS

NYLOPLAST DRAIN BASIN

NTS

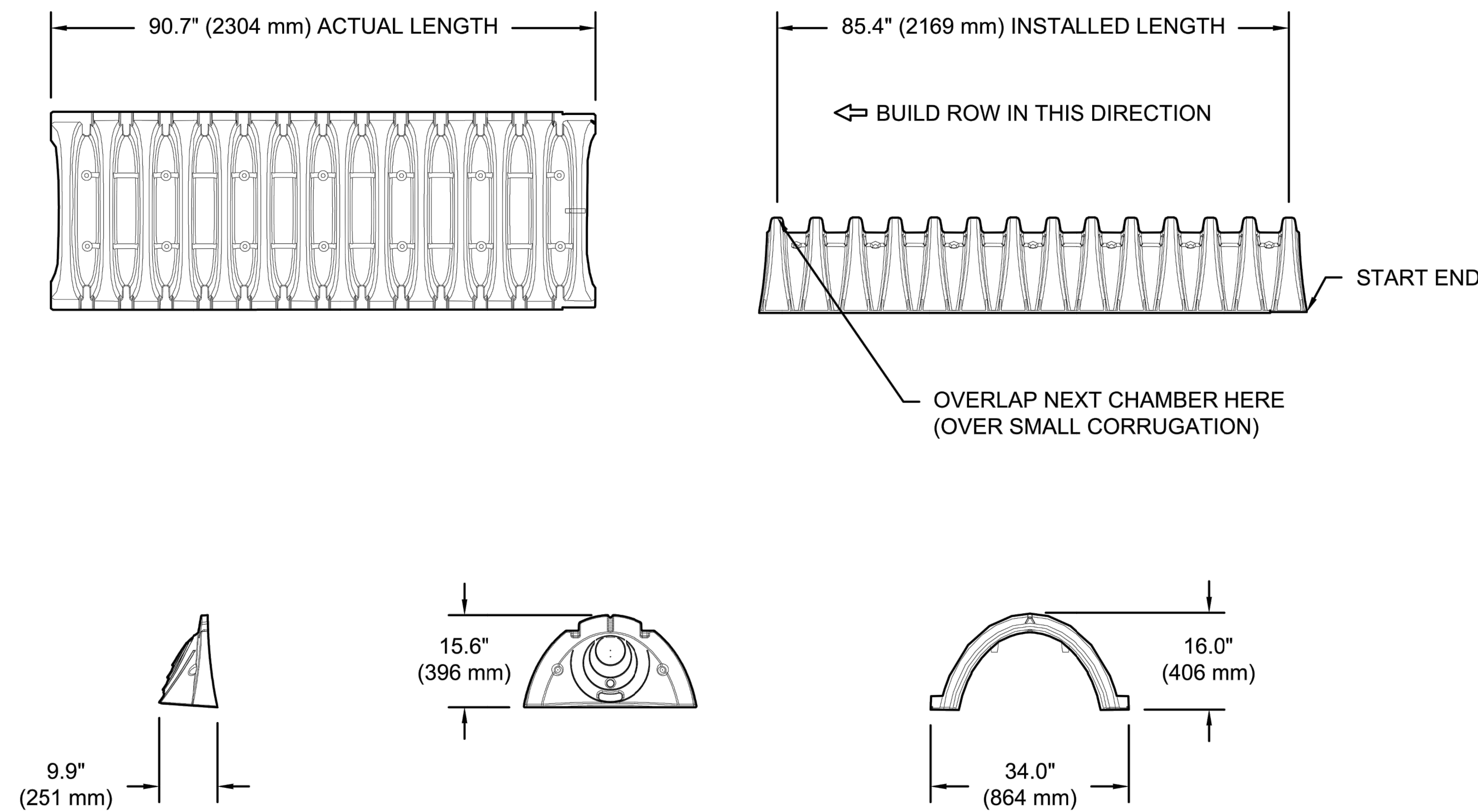

NOMINAL CHAMBER SPECIFICATIONS

SIZE (W X H X INSTALLED LENGTH)	34.0" X 16.0" X 85.4"	(864 mm X 406 mm X 2169 mm)
CHAMBER STORAGE	14.7 CUBIC FEET	(0.42 m ³)
MINIMUM INSTALLED STORAGE*	31.0 CUBIC FEET	(0.88 m ³)
WEIGHT	35.0 lbs.	(16.8 kg)

*ASSUMES 6" (152 mm) ABOVE, BELOW, AND BETWEEN CHAMBERS

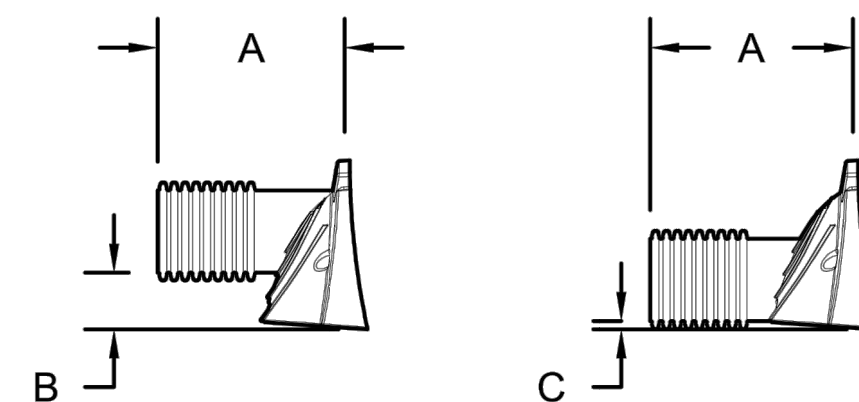

PRE-FAB STUB AT BOTTOM OF END CAP WITH FLAMP END WITH "BR"
 PRE-FAB STUBS AT BOTTOM OF END CAP FOR PART NUMBERS ENDING WITH "B"
 PRE-FAB STUBS AT TOP OF END CAP FOR PART NUMBERS ENDING WITH "T"
 PRE CORED END CAPS END WITH "PC"

PART #	STUB	A	B	C
SC310EPE06T / SC310EPE06TPC	6" (150 mm)	9.6" (244 mm)	5.8" (147 mm)	---
SC310EPE06B / SC310EPE06BPC			---	0.5" (13 mm)
SC310EPE08T / SC310EPE08TPC	8" (200 mm)	11.9" (302 mm)	3.5" (89 mm)	---
SC310EPE08B / SC310EPE08BPC			---	0.6" (15 mm)
SC310EPE10T / SC310EPE10TPC	10" (250 mm)	12.7" (323 mm)	1.4" (36 mm)	---
SC310EPE10B / SC310EPE10BPC			---	0.7" (18 mm)
SC310ECEZ*	12" (300 mm)	13.5" (343 mm)	---	0.9" (23 mm)

ALL STUBS, EXCEPT FOR THE SC310ECEZ ARE PLACED AT BOTTOM OF END CAP SUCH THAT THE OUTSIDE DIAMETER OF THE STUB IS FLUSH WITH THE BOTTOM OF THE END CAP. FOR ADDITIONAL INFORMATION CONTACT STORMTECH AT 1-888-892-2694.

* FOR THE SC310ECEZ THE 12" (300 mm) STUB LIES BELOW THE BOTTOM OF THE END CAP APPROXIMATELY 0.25" (6 mm). BACKFILL MATERIAL SHOULD BE REMOVED FROM BELOW THE N-12 STUB SO THAT THE FITTING SITS LEVEL.

NOTE: ALL DIMENSIONS ARE NOMINAL

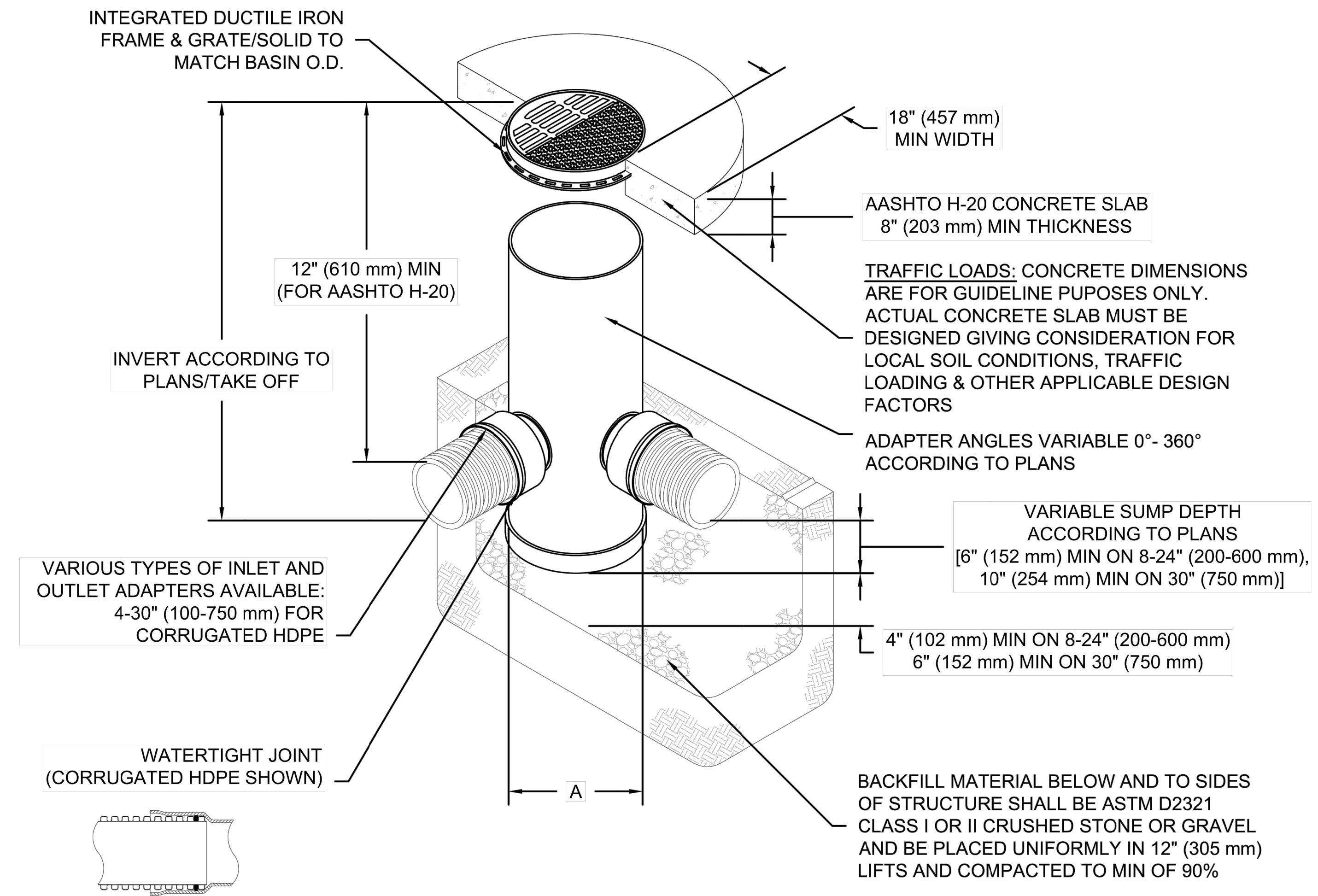

NOTES

- 8-30" (200-750 mm) GRATES/SOLID COVERS SHALL BE DUCTILE IRON PER ASTM A536 GRADE 70-50-05
- 12-30" (300-750 mm) FRAMES SHALL BE DUCTILE IRON PER ASTM A536 GRADE 70-50-05
- DRAIN BASIN TO BE CUSTOM MANUFACTURED ACCORDING TO PLAN DETAILS
- DRAINAGE CONNECTION STUB JOINT TIGHTNESS SHALL CONFORM TO ASTM D3212 FOR CORRUGATED HDPE (ADS & HANCOR DUAL WALL) & SDR 35 PVC
- FOR COMPLETE DESIGN AND PRODUCT INFORMATION: WWW.NYLOPLAST-US.COM
- TO ORDER CALL: **800-821-6710**

A	PART #	GRATE/SOLID COVER OPTIONS		
8" (200 mm)	2808AG	PEDESTRIAN LIGHT DUTY	STANDARD LIGHT DUTY	SOLID LIGHT DUTY
10" (250 mm)	2810AG	PEDESTRIAN LIGHT DUTY	STANDARD LIGHT DUTY	SOLID LIGHT DUTY
12" (300 mm)	2812AG	PEDESTRIAN AASHTO H-10	STANDARD AASHTO H-20	SOLID AASHTO H-20
15" (375 mm)	2815AG	PEDESTRIAN AASHTO H-10	STANDARD AASHTO H-20	SOLID AASHTO H-20
18" (450 mm)	2818AG	PEDESTRIAN AASHTO H-10	STANDARD AASHTO H-20	SOLID AASHTO H-20
24" (600 mm)	2824AG	PEDESTRIAN AASHTO H-10	STANDARD AASHTO H-20	SOLID AASHTO H-20
30" (750 mm)	2830AG	PEDESTRIAN AASHTO H-20	STANDARD AASHTO H-20	SOLID AASHTO H-20

OAKWOOD SOUTH RETAIL SHOPPING CENTER
 HOLLYWOOD, FL, USA

DATE: 07/02/24
 PROJECT #: S420513
 DRAWN: MPV
 CHECKED: -

DATE
 DRW
 CHK
 DESCRIPTION

DATE
 DRW
 CHK
 DESCRIPTION
 770-932-2443 | WWW.NYLOPLAST-US.COM

Nyloplast®

4640 TRUEMAN BLVD
 HILLIARD, OH 43026
 1-800-733-7473



SHEET

8 OF 8

THIS DRAWING HAS BEEN PREPARED BASED ON INFORMATION PROVIDED TO ADS UNDER THE DIRECTION OF THE SITE DESIGN ENGINEER OR OTHER PROJECT REPRESENTATIVE. THE SITE DESIGN ENGINEER SHALL REVIEW THIS DRAWING PRIOR TO CONSTRUCTION. IT IS THE ULTIMATE RESPONSIBILITY OF THE SITE DESIGN ENGINEER TO ENSURE THAT THE PRODUCT(S) DEPICTED AND ALL ASSOCIATED DETAILS MEET ALL APPLICABLE LAWS, REGULATIONS, AND PROJECT REQUIREMENTS.

Picked By: Schulz, Ryan; Sheet: Set: OAKWOOD PLAZA - Layout: C-400, SEWER PLAN - July 12, 2024 - 01:40:21pm - K:\WB_IDEA\147507131 - Dick's House of Sports\CAD\DrawSheets\C-400 SEWER PLAN.dwg
 This document, together with the concepts and designs presented herein, is an instrument of service, if intended only for the specific purpose and client for which it was prepared. Release of and improper reliance on this document without written authorization and adaptation by Kimley-Horn and Associates, Inc. shall be without liability to Kimley-Horn and Associates, Inc.

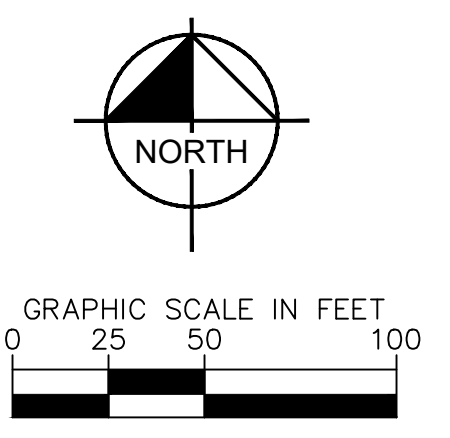
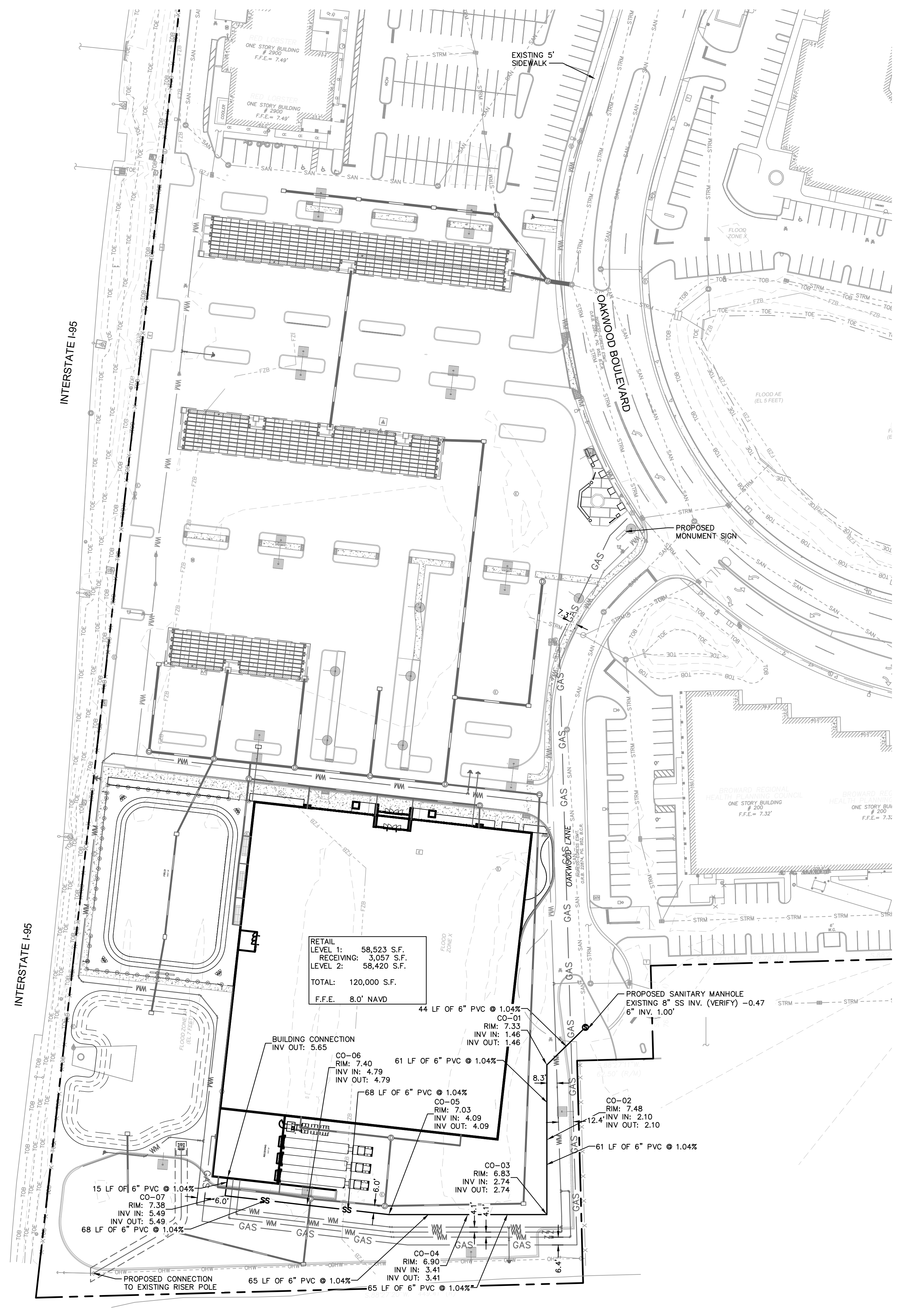

UTILITY LEGEND

---	PROPERTY LINE
---	UTILITY EASEMENT
---	WATER MAIN (WM)
---	SANITARY MAIN
---	ELECTRIC
---	GAS
---	STORM PIPE
---	FDC
---	GATE VALVE
---	90° BEND
---	45° BEND
---	22.5° BEND
---	11.25° BEND
---	TEE
---	SEWER MANHOLE
---	TRANSFORMER
---	EXISTING SEWER MANHOLE

POTABLE WATER IMPACT

Use	Calculation	Total
Existing	Regal Cinemas Movie Theater 4 GPD per seat (4 GPD/seat x 2,504 seats)	10,016 GPD
Proposed	Retail (Commercial) 120,000 SF 0.1 GPD per SF (120,000 s.f. x 0.1 GPD)	12,000 GPD
Total Existing and Proposed		(-) 1,984 GPD

SANITARY SEWER IMPACT

Use	Calculation	Total
Existing	Regal Cinemas Movie Theater 4 GPD per seat (4 GPD/seat x 2,504 seats)	10,016 GPD
Proposed	Retail (Commercial) 120,000 SF 0.1 GPD per SF (120,000 s.f. x 0.1 GPD)	12,000 GPD
Total Existing and Proposed		(-) 1,984 GPD

UTILITY NOTES

- ALL FILL MATERIAL IS TO BE IN PLACE AND COMPACTED BEFORE INSTALLATION OF PROPOSED UTILITIES.
- CONTRACTOR SHALL NOTIFY THE UTILITY AUTHORITIES INSPECTORS 72 HOURS BEFORE CONNECTING TO ANY EXISTING LINE.
- SANITARY SEWER PIPE SHALL BE AS FOLLOWS:
8" PVC SDR35 PER ASTM D 3034, FOR PIPES LESS THAN 12' DEEP
8" PVC SDR35 PER ASTM D 3034, FOR PIPES MORE THAN 12' DEEP
6" PVC SCHEDULE 40
DUCTILE IRON PIPE PER AWWA C150
- WATER LINES SHALL BE AS FOLLOWS:
6" AND LARGER, PVC C-900 PER ASTM D 2241 CLASS 200 UNDER COUNTY ROADS, OTHERWISE CLASS 150
6" AND LARGER DUCTILE IRON PIPE PER AWWA C150
SMALLER THAN 6" EITHER COPPER TUBE TYPE "L" (SOFT) PER ANSI 816.22 OR PVC, 200 P.S.I., PER ASTM D1784 AND D2241.
- MINIMUM TRENCH WIDTH SHALL BE 2 FEET.
- ALL WATER JOINTS ARE TO BE MECHANICAL JOINTS WITH THRUST BLOCKING AS CALLED OUT IN SPECIFICATIONS.
- ALL UTILITIES SHOULD BE KEPT TEN (10') APART (PARALLEL) OR WHEN CROSSING 18" VERTICAL CLEARANCE (OUTSIDE EDGE OF PIPE TO OUTSIDE EDGE OF PIPE).
- CONTRACTOR SHALL MAINTAIN A MINIMUM OF 4" COVER ON ALL WATER LINES.
- IN THE EVENT OF A VERTICAL CONFLICT BETWEEN WATER LINES, SANITARY LINES, STORM LINES AND GAS LINES (EXISTING AND PROPOSED), THE SANITARY LINE SHALL BE DUCTILE IRON PIPE WITH MECHANICAL JOINTS AT LEAST 10 FEET ON BOTH SIDES OF CROSSING. THE WATER LINE SHALL HAVE MECHANICAL JOINTS WITH APPROPRIATE THRUST BLOCKING AS REQUIRED TO PROVIDE A MINIMUM OF 18" CLEARANCE, MEETING REQUIREMENTS OF ANSI A21.10 OR ANSI 21.11 (AWWA C-151) (CLASS 50).
- UNDERGROUND LINES SHALL BE INSTALLED, INSPECTED AND APPROVED BEFORE BACKFILLING.
- TOPS OF EXISTING MANHOLES SHALL BE RAISED AS NECESSARY TO BE FLUSH WITH PROPOSED PAVEMENT ELEVATIONS WITHIN PAVED AREAS, AND TO BE ONE FOOT ABOVE FINISHED GROUND ELEVATIONS WITH WATER TIGHT LIDS WITHIN LANDSCAPED AREAS.
- ALL CONCRETE FOR ENCASEMENTS SHALL HAVE A MINIMUM 28 DAY COMPRESSION STRENGTH AT 3000 P.S.I.
- EXISTING UTILITIES SHALL BE VERIFIED IN FIELD PRIOR TO INSTALLATION OF ANY NEW LINES.
- REFER TO INTERIOR PLUMBING DRAWINGS FOR TIE-IN OF ALL UTILITIES.
- CONTRACTOR IS RESPONSIBLE FOR COMPLYING TO THE SPECIFICATIONS OF THE LOCAL AUTHORITIES (ANY CITY) WITH REGARDS TO MATERIALS AND INSTALLATION OF THE WATER AND SEWER LINES.
- THE CONTRACTOR IS SPECIFICALLY CAUTIONED THAT THE LOCATION AND/OR ELEVATION OF EXISTING UTILITIES AS SHOWN ON THESE PLANS IS BASED ON RECORDS OF THE VARIOUS UTILITY COMPANIES, AND WHERE POSSIBLE, MEASUREMENTS TAKEN IN THE FIELD. THE INFORMATION IS NOT TO BE RELIED ON AS BEING EXACT OR COMPLETE. THE CONTRACTOR MUST CALL THE APPROPRIATE UTILITY COMPANIES AT LEAST 72 HOURS BEFORE ANY EXCAVATION TO REQUEST EXACT FIELD LOCATION OF UTILITIES. IT SHALL BE THE RESPONSIBILITY OF THE CONTRACTOR TO RELOCATE ALL EXISTING UTILITIES WHICH CONFLICT WITH THE PROPOSED IMPROVEMENTS SHOWN ON THE PLANS.
- CONTRACTOR IS RESPONSIBLE FOR ALL NECESSARY INSPECTIONS AND/OR CERTIFICATIONS REQUIRED BY CODES AND/OR UTILITY SERVICE COMPANIES. THIS AND THE FINAL CONNECTIONS OF THE SERVICE SHALL BE COMPLETED 30 DAYS PRIOR TO STORE POSSESSION.
- CONTRACTOR SHALL COORDINATE WITH ALL UTILITY COMPANIES FOR INSTALLATION REQUIREMENTS AND SPECIFICATIONS.
- REFER TO BUILDING PLANS FOR SITE LIGHTING ELECTRICAL PLAN.
- UNDERGROUND UTILITY LINES SHALL BE INSTALLED, INSPECTED AND APPROVED BEFORE BACKFILLING.
- REFER TO INTERIOR PLUMBING DRAWINGS FOR TIE-IN OF ALL UTILITIES.
- THE CONTRACTOR SHALL BE RESPONSIBLE FOR LOCATING EXISTING WATER MAINS, FORCE MAINS, SANITARY SEWER AND STORM MAINS AND MAINTAIN MINIMUM CLEARANCES BETWEEN WATER MAINS AND OTHER UTILITIES AT ALL POINTS ALONG THEIR LENGTH AS REQUIRED IN THE PLANS, DETAILS AND SPECIFICATIONS.
- CONTRACTOR IS RESPONSIBLE FOR ALL NECESSARY INSPECTIONS AND/OR CERTIFICATIONS REQUIRED BY CODES AND/OR UTILITY SERVICE COMPANIES. THIS AND THE FINAL CONNECTIONS OF THE SERVICE SHALL BE COMPLETED 30 DAYS PRIOR TO STORE POSSESSION.
- THE ENTIRE FIRE SERVICE FROM BUILDING TO CONNECTION POINT IS TO BE INSTALLED BY A LICENSED UTILITY CONTRACTOR HOLDING A "CONTRACTOR V" LICENSE IN ACCORDANCE WITH CH 489 OF THE FLORIDA STATUTES.
- ALL UTILITY MAIN LENGTHS SHOWN ARE APPROXIMATE.

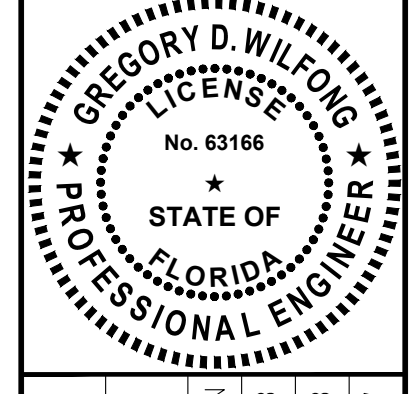
Kimley»Horn		© 2024 KIMLEY-HORN AND ASSOCIATES, INC. 445 24TH STREET, SUITE 200, VERO BEACH, FL 32960 WWW.KIMLEY-HORN.COM REGISTRY NO. 35106	
		KHA PROJECT 147507131	DATE 07/15/2024
SEWER PLAN		SCALE AS SHOWN	DESIGNED BY SHB DRAWN BY SHB CHECKED BY GDW
OAKWOOD SOUTH RETAIL SHOPPING CENTER		CITY OF HOLLYWOOD, FL	
SHEET NUMBER C-400		REVISIONS	DATE BY

THIS ITEM HAS BEEN DIGITALLY SIGNED AND SEALED BY GREGORY D. WILFONG, P.E. ON THE DATE ADJACENT TO THE SEAL. PRINTED COPIES OF THIS DOCUMENT ARE NOT CONSIDERED SIGNED AND SEALED AND THE DIGITAL SIGNATURE MUST BE VERIFIED ON ANY ELECTRONIC COPIES.

Picked By: Schulz, Ryan; Sheet: Oakwood Plaza; Layout: C-401; WATER PLAN; July 12, 2024; 01:42:37pm; K:\WB_IDEA\47507131-Dicks House of Sports\CAD\DrawSheets\C-401 WATER PLAN.dwg
 This document, together with the concepts and designs presented herein, is an instrument of service, it is intended only for the specific purpose and client for which it was prepared. Release of and improper reliance on this document without written authorization and adaptation by Kimley-Horn and Associates, Inc. shall be without liability to Kimley-Horn and Associates, Inc.

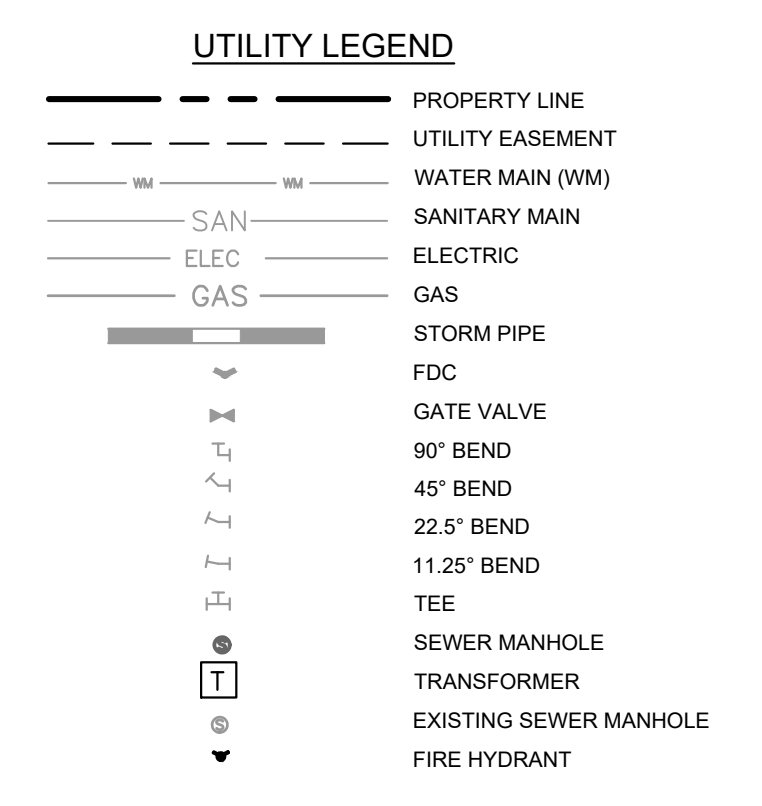
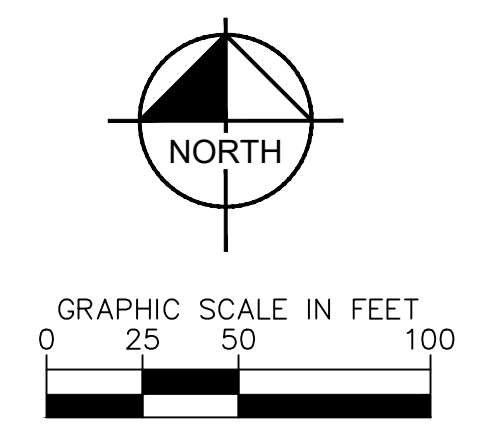
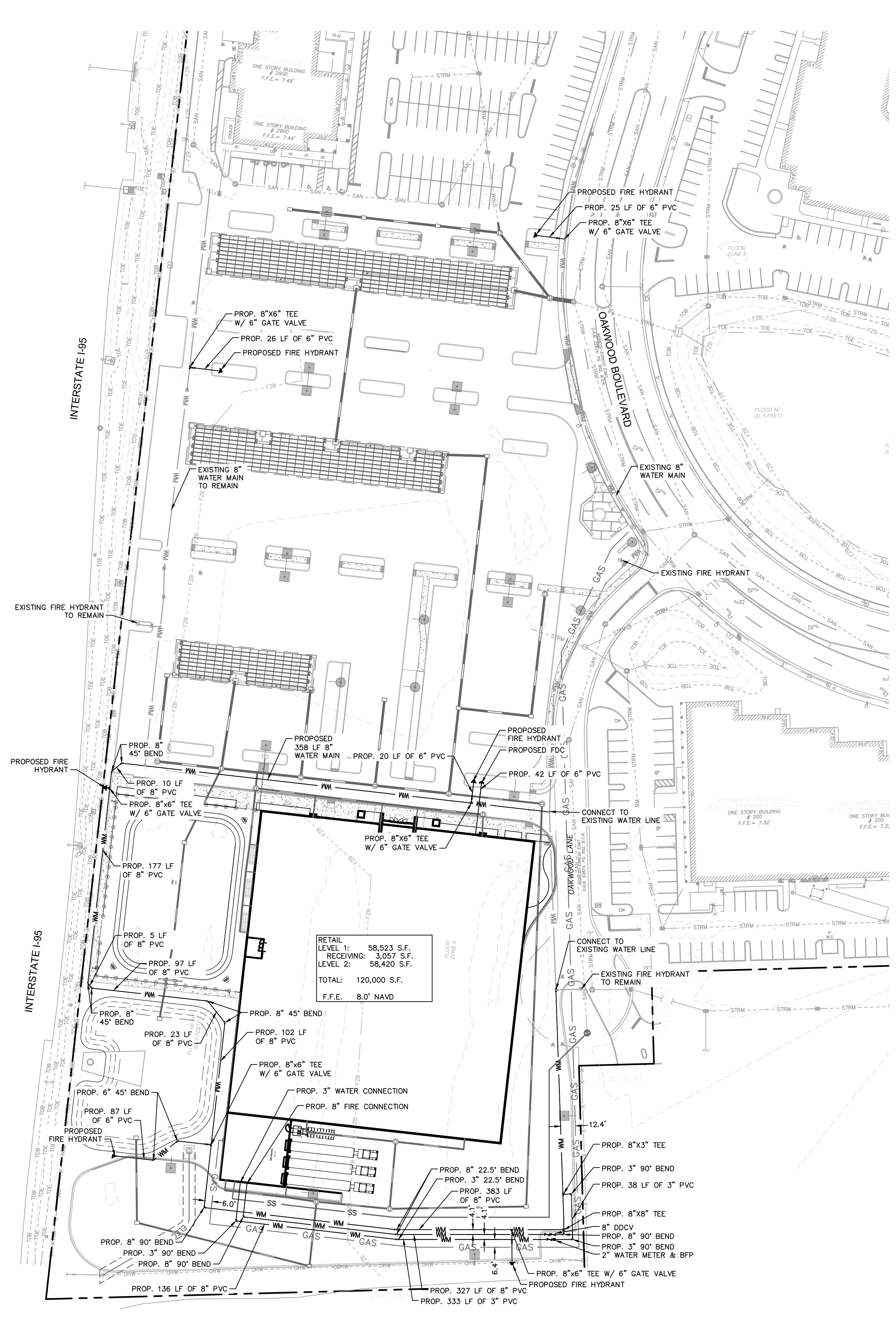

FIRE UTILITY NOTE

- ALL UNDERGROUND FIRE MAIN WORK MUST BE COMPLETED BY FIRE PROTECTION CONTRACTOR HOLDING A CLASS I, II, OR V LICENSE PER FS 633.102.
- WATER SUPPLY AND ANY NEW HYDRANTS SHALL BE IN PLACE PRIOR TO ACCUMULATION OF COMBUSTIBLE MATERIALS PER NFPA 1 (2021 ED.) SECTION 16.5.3.1.1.
- BE ADVISED THAT NFPA 1 (2021 EDITION) SECTION 11.10.2 REQUIRES THAT MINIMUM RADIO SIGNAL STRENGTH FOR FIRE DEPARTMENT COMMUNICATIONS SHALL BE MAINTAINED AT A LEVEL DETERMINED BY THE AHJ FOR ALL NEW AND EXISTING BUILDINGS. -- IF AT ANY TIME (INCLUDING THE CONSTRUCTION PHASE), FIRE DEPARTMENT PERSONNEL DETERMINE THAT THE MINIMUM RADIO SIGNAL STRENGTH IS NOT BEING MET, A TWO-WAY RADIO COMMUNICATION ENHANCEMENT SYSTEM MAY BE REQUIRED TO BE INSTALLED AS DETERMINED BY THE AHJ.

- UTILITY NOTES**
- ALL FILL MATERIAL IS TO BE IN PLACE AND COMPACTED BEFORE INSTALLATION OF PROPOSED UTILITIES.
 - CONTRACTOR SHALL NOTIFY THE UTILITY AUTHORITIES INSPECTORS 72 HOURS BEFORE CONNECTING TO ANY EXISTING LINE.
 - SANITARY SEWER PIPE SHALL BE AS FOLLOWS:
8" PVC SDR35 PER ASTM D 3034, FOR PIPES LESS THAN 12' DEEP
8" PVC SDR26 PER ASTM D 3034, FOR PIPES MORE THAN 12' DEEP
6" PVC SCHEDULE 40
DUCTILE IRON PIPE PER AWWA C150
 - WATER LINES SHALL BE AS FOLLOWS:
6" AND LARGER, PVC C-900 PER ASTM D 2241 CLASS 200 UNDER COUNTY ROADS, OTHERWISE CLASS 150
6" AND LARGER DUCTILE IRON PIPE PER AWWA C150
SMALLER THAN 6" EITHER COPPER TUBE TYPE "L" (SOFT) PER ANSI 816.22 OR PVC, 200 P.S.I., PER ASTM D1784 AND D2241.
 - MINIMUM TRENCH WIDTH SHALL BE 2 FEET.
 - ALL WATER JOINTS ARE TO BE MECHANICAL JOINTS WITH THRUST BLOCKING AS CALLED OUT IN SPECIFICATIONS.
 - ALL UTILITIES SHOULD BE KEPT TEN (10') APART (PARALLEL OR WHEN CROSSING 18" VERTICAL CLEARANCE (OUTSIDE EDGE OF PIPE TO OUTSIDE EDGE OF PIPE)).
 - CONTRACTOR SHALL MAINTAIN A MINIMUM OF 4" COVER ON ALL WATER LINES.
 - IN THE EVENT OF A VERTICAL CONFLICT BETWEEN WATER LINES, SANITARY LINES, STORM LINES AND GAS LINES (EXISTING AND PROPOSED), THE SANITARY LINE SHALL BE DUCTILE IRON PIPE WITH MECHANICAL JOINTS AT LEAST 10 FEET ON BOTH SIDES OF CROSSING. THE WATER LINE SHALL HAVE MECHANICAL JOINTS WITH APPROPRIATE THRUST BLOCKING AS REQUIRED TO PROVIDE A MINIMUM OF 18" CLEARANCE, MEETING REQUIREMENTS OF ANSI A21.10 OR ANSI 21.11 (AWWA C-151) (CLASS 50).
 - UNDERGROUND LINES SHALL BE INSTALLED, INSPECTED AND APPROVED BEFORE BACKFILLING.
 - TOPS OF EXISTING MANHOLES SHALL BE RAISED AS NECESSARY TO BE FLUSH WITH PROPOSED PAVEMENT ELEVATIONS WITHIN PAVED AREAS, AND TO BE ONE FOOT ABOVE FINISHED GROUND ELEVATIONS WITH WATER TIGHT LIDS WITHIN LANDSCAPED AREAS.
 - ALL CONCRETE FOR ENCASEMENTS SHALL HAVE A MINIMUM 28 DAY COMPRESSION STRENGTH AT 3000 P.S.I.
 - EXISTING UTILITIES SHALL BE VERIFIED IN FIELD PRIOR TO INSTALLATION OF ANY NEW LINES.
 - REFER TO INTERIOR PLUMBING DRAWINGS FOR TIE-IN OF ALL UTILITIES.
 - CONTRACTOR IS RESPONSIBLE FOR COMPLYING TO THE SPECIFICATIONS OF THE LOCAL AUTHORITIES (ANY CITY) WITH REGARDS TO MATERIALS AND INSTALLATION OF THE WATER AND SEWER LINES.
 - THE CONTRACTOR IS SPECIFICALLY CAUTIONED THAT THE LOCATION AND/OR ELEVATION OF EXISTING UTILITIES AS SHOWN ON THESE PLANS IS BASED ON RECORDS OF THE VARIOUS UTILITY COMPANIES, AND WHERE POSSIBLE, MEASUREMENTS TAKEN IN THE FIELD. THE INFORMATION IS NOT TO BE RELIED ON AS BEING EXACT OR COMPLETE. THE CONTRACTOR MUST CALL THE APPROPRIATE UTILITY COMPANIES AT LEAST 72 HOURS BEFORE ANY EXCAVATION TO REQUEST EXACT FIELD LOCATION OF UTILITIES. IT SHALL BE THE RESPONSIBILITY OF THE CONTRACTOR TO RELOCATE ALL EXISTING UTILITIES WHICH CONFLICT WITH THE PROPOSED IMPROVEMENTS SHOWN ON THE PLANS.
 - CONTRACTOR IS RESPONSIBLE FOR ALL NECESSARY INSPECTIONS AND/OR CERTIFICATIONS REQUIRED BY CODES AND/OR UTILITY SERVICE COMPANIES. THIS AND THE FINAL CONNECTIONS OF THE SERVICE SHALL BE COMPLETED 30 DAYS PRIOR TO STORE POSSESSION.
 - CONTRACTOR SHALL COORDINATE WITH ALL UTILITY COMPANIES FOR INSTALLATION REQUIREMENTS AND SPECIFICATIONS.
 - REFER TO BUILDING PLANS FOR SITE LIGHTING ELECTRICAL PLAN.
 - UNDERGROUND UTILITY LINES SHALL BE INSTALLED, INSPECTED AND APPROVED BEFORE BACKFILLING.
 - REFER TO INTERIOR PLUMBING DRAWINGS FOR TIE-IN OF ALL UTILITIES.
 - THE CONTRACTOR SHALL BE RESPONSIBLE FOR LOCATING EXISTING WATER MAINS, FORCE MAINS, SANITARY SEWER AND STORM MAINS AND MAINTAIN MINIMUM CLEARANCES BETWEEN WATER MAINS AND OTHER UTILITIES AT ALL POINTS ALONG THEIR LENGTH AS REQUIRED IN THE PLANS, DETAILS AND SPECIFICATIONS.
 - CONTRACTOR IS RESPONSIBLE FOR ALL NECESSARY INSPECTIONS AND/OR CERTIFICATIONS REQUIRED BY CODES AND/OR UTILITY SERVICE COMPANIES. THIS AND THE FINAL CONNECTIONS OF THE SERVICE SHALL BE COMPLETED 30 DAYS PRIOR TO STORE POSSESSION.
 - THE ENTIRE FIRE SERVICE FROM BUILDING TO CONNECTION POINT IS TO BE INSTALLED BY A LICENSED UTILITY CONTRACTOR HOLDING A "CONTRACTOR" V LICENSE IN ACCORDANCE WITH CH 489 OF THE FLORIDA STATUTES.
 - ALL UTILITY MAIN LENGTHS SHOWN ARE APPROXIMATE.

POTABLE WATER IMPACT			
Use	Calculation	Total	
Existing	Regal Cinemas Movie Theater 4 GPD per seat (4 GPD/seat x 2,504 seats)	10,016 GPD	
Proposed	Retail (Commercial) 120,000 SF 0.1 GPD per SF (120,000 s.f. x 0.1 GPD)	12,000 GPD	
Total Existing and Proposed		(+) 1,984 GPD	

SANITARY SEWER IMPACT			
Use	Calculation	Total	
Existing	Regal Cinemas Movie Theater 4 GPD per seat (4 GPD/seat x 2,504 seats)	10,016 GPD	
Proposed	Retail (Commercial) 120,000 SF 0.1 GPD per SF (120,000 s.f. x 0.1 GPD)	12,000 GPD	
Total Existing and Proposed		(+) 1,984 GPD	

RETAIL LEVEL 1: 58,523 S.F.
 RECEIVING: 3,057 S.F.
 LEVEL 2: 58,420 S.F.
 TOTAL: 120,000 S.F.
 F.F.E.: 8.0' NAVD

NO.	REVISIONS	DATE	BY

Kimley»Horn
 © 2024 KIMLEY-HORN AND ASSOCIATES, INC.
 445 24TH STREET, SUITE 200, VERO BEACH, FL 32960
 WWW.KIMLEY-HORN.COM
 REGISTRY NO. 35106

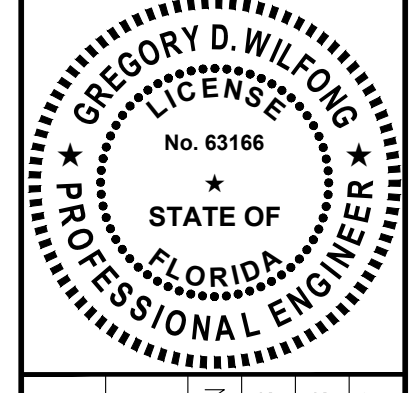

KHA PROJECT
 147507131
 DATE
 07/15/2024
 SCALE
 AS SHOWN
 DESIGNED BY
 SHB
 DRAWN BY
 SHB
 CHECKED BY
 GDW

THIS ITEM HAS BEEN DIGITALLY SIGNED AND SEALED BY GREGORY D. WILFONG, P.E. ON THE DATE ADJACENT TO THE SEAL. PRINTED COPIES OF THIS DOCUMENT ARE NOT CONSIDERED SIGNED AND SEALED. THE DIGITAL SIGNATURE MUST BE VERIFIED ON ANY ELECTRONIC COPIES.

**OAKWOOD SOUTH
 RETAIL SHOPPING
 CENTER**
 CITY OF HOLLYWOOD, FL

SHEET NUMBER
C-401

Picked By: Schulz, Ryan Sheet: Set: OAKWOOD PLAZA Layout: C-402 DRY UTILITY PLAN July 12, 2024 01:45:03pm K:\WB_IDEA\147507151-Disk House of Sports\CAD\DrawSheets\C-402 DRY UTILITY PLAN.dwg
 This document, together with the concepts and designs presented herein, is an instrument of service, if intended only for the specific purpose and client for which it was prepared. Release of and improper reliance on this document without written authorization and adaptation by Kimley-Horn and Associates, Inc. shall be without liability to Kimley-Horn and Associates, Inc.

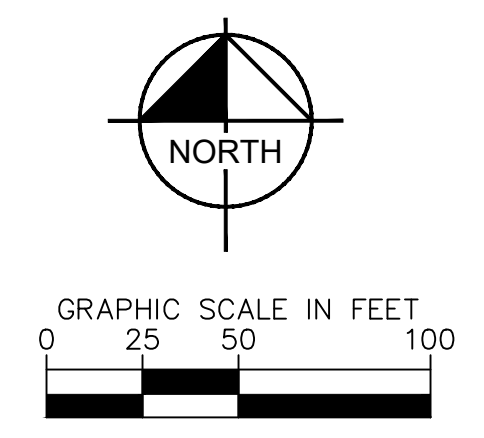
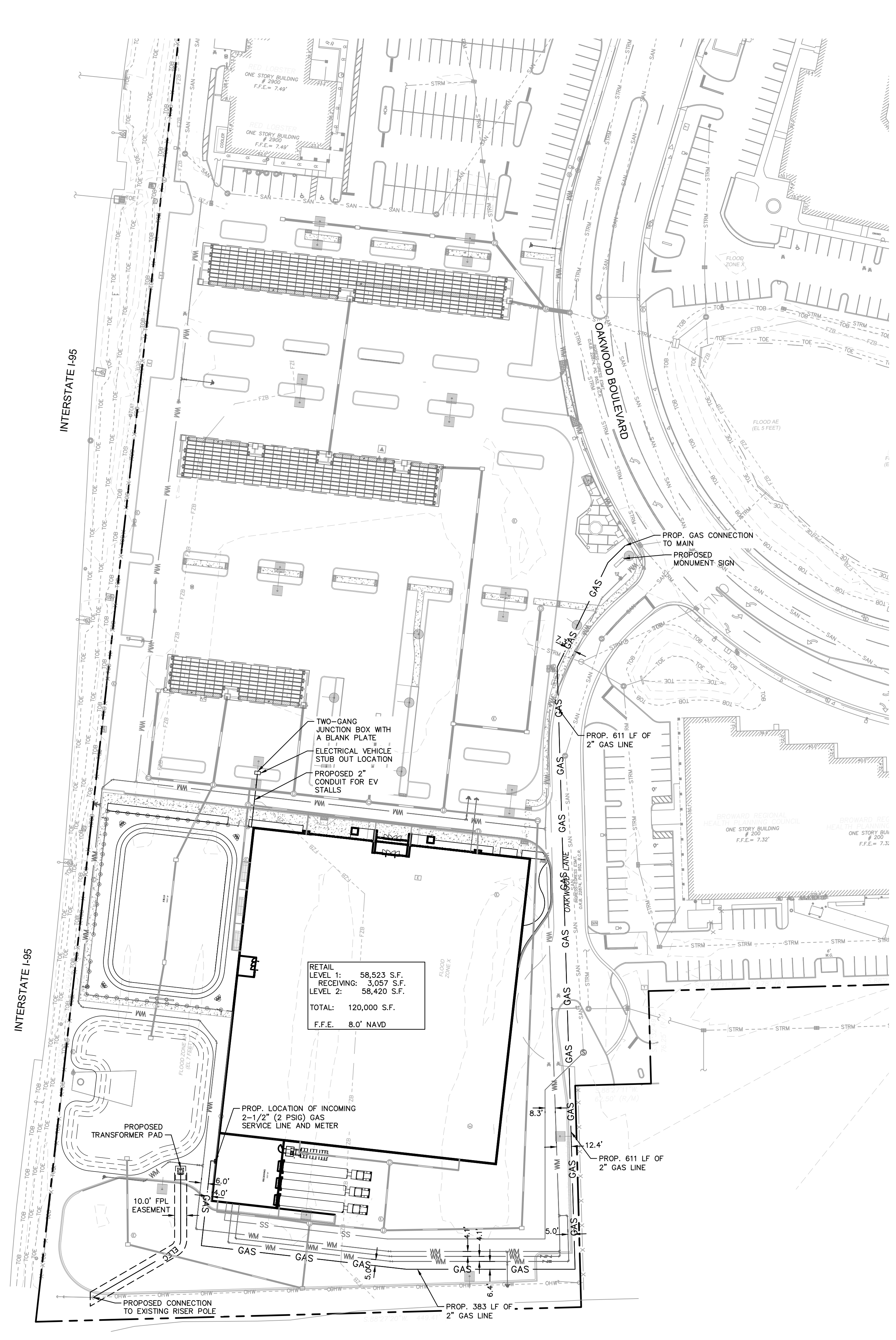

UTILITY LEGEND

	PROPERTY LINE
	UTILITY EASEMENT
	WATER MAIN (WM)
	SANITARY MAIN (SAN)
	ELECTRIC (ELEC)
	GAS
	STORM PIPE
	FDC
	GATE VALVE
	90° BEND
	45° BEND
	22.5° BEND
	11.25° BEND
	TEE
	SEWER MANHOLE
	TRANSFORMER
	EXISTING SEWER MANHOLE

- UTILITY NOTES**
- ALL FILL MATERIAL IS TO BE IN PLACE AND COMPACTED BEFORE INSTALLATION OF PROPOSED UTILITIES.
 - CONTRACTOR SHALL NOTIFY THE UTILITY AUTHORITIES INSPECTORS 72 HOURS BEFORE CONNECTING TO ANY EXISTING LINE.
 - SANITARY SEWER PIPE SHALL BE AS FOLLOWS:
 8" PVC SDR35 PER ASTM D 3034, FOR PIPES LESS THAN 12' DEEP
 8" PVC SDR35 PER ASTM D 3034, FOR PIPES MORE THAN 12' DEEP
 6" PVC SCHEDULE 40
 DUCTILE IRON PIPE PER AWWA C150
 - WATER LINES SHALL BE AS FOLLOWS:
 6" AND LARGER, PVC C-900 PER ASTM D 2241 CLASS 200 UNDER COUNTY ROADS, OTHERWISE CLASS 150
 6" AND LARGER DUCTILE IRON PIPE PER AWWA C150
 SMALLER THAN 6" EITHER COPPER TUBE TYPE "L" (SOFT) PER ANSI 816.22 OR PVC, 200 P.S.I., PER ASTM D1784 AND D2241.
 - MINIMUM TRENCH WIDTH SHALL BE 2 FEET.
 - ALL WATER JOINTS ARE TO BE MECHANICAL JOINTS WITH THRUST BLOCKING AS CALLED OUT IN SPECIFICATIONS.
 - ALL UTILITIES SHOULD BE KEPT TEN (10') APART (PARALLEL) OR WHEN CROSSING 18" VERTICAL CLEARANCE (OUTSIDE EDGE OF PIPE TO OUTSIDE EDGE OF PIPE).
 - CONTRACTOR SHALL MAINTAIN A MINIMUM OF 4" COVER ON ALL WATER LINES.
 - IN THE EVENT OF A VERTICAL CONFLICT BETWEEN WATER LINES, SANITARY LINES, STORM LINES AND GAS LINES (EXISTING AND PROPOSED), THE SANITARY LINE SHALL BE DUCTILE IRON PIPE WITH MECHANICAL JOINTS AT LEAST 10 FEET ON BOTH SIDES OF CROSSING. THE WATER LINE SHALL HAVE MECHANICAL JOINTS WITH APPROPRIATE THRUST BLOCKING AS REQUIRED TO PROVIDE A MINIMUM OF 18" CLEARANCE, MEETING REQUIREMENTS OF ANSI A21.10 OR ANSI 21.11 (AWWA C-151) (CLASS 50).
 - UNDERGROUND LINES SHALL BE INSTALLED, INSPECTED AND APPROVED BEFORE BACKFILLING.
 - TOPS OF EXISTING MANHOLES SHALL BE RAISED AS NECESSARY TO BE FLUSH WITH PROPOSED PAVEMENT ELEVATIONS WITHIN PAVED AREAS, AND TO BE ONE FOOT ABOVE FINISHED GROUND ELEVATIONS WITH WATER TIGHT LIDS WITHIN LANDSCAPED AREAS.
 - ALL CONCRETE FOR ENCASEMENTS SHALL HAVE A MINIMUM 28 DAY COMPRESSION STRENGTH AT 3000 P.S.I.
 - EXISTING UTILITIES SHALL BE VERIFIED IN FIELD PRIOR TO INSTALLATION OF ANY NEW LINES.
 - REFER TO INTERIOR PLUMBING DRAWINGS FOR TIE-IN OF ALL UTILITIES.
 - CONTRACTOR IS RESPONSIBLE FOR COMPLYING TO THE SPECIFICATIONS OF THE LOCAL AUTHORITIES (ANY CITY) WITH REGARDS TO MATERIALS AND INSTALLATION OF THE WATER AND SEWER LINES.
 - THE CONTRACTOR IS SPECIFICALLY CAUTIONED THAT THE LOCATION AND/OR ELEVATION OF EXISTING UTILITIES AS SHOWN ON THESE PLANS IS BASED ON RECORDS OF THE VARIOUS UTILITY COMPANIES, AND WHERE POSSIBLE, MEASUREMENTS TAKEN IN THE FIELD. THE INFORMATION IS NOT TO BE RELIED ON AS BEING EXACT OR COMPLETE. THE CONTRACTOR MUST CALL THE APPROPRIATE UTILITY COMPANIES AT LEAST 72 HOURS BEFORE ANY EXCAVATION TO REQUEST EXACT FIELD LOCATION OF UTILITIES. IT SHALL BE THE RESPONSIBILITY OF THE CONTRACTOR TO RELOCATE ALL EXISTING UTILITIES WHICH CONFLICT WITH THE PROPOSED IMPROVEMENTS SHOWN ON THE PLANS.
 - CONTRACTOR IS RESPONSIBLE FOR ALL NECESSARY INSPECTIONS AND/OR CERTIFICATIONS REQUIRED BY CODES AND/OR UTILITY SERVICE COMPANIES. THIS AND THE FINAL CONNECTIONS OF THE SERVICE SHALL BE COMPLETED 30 DAYS PRIOR TO STORE POSSESSION.
 - CONTRACTOR SHALL COORDINATE WITH ALL UTILITY COMPANIES FOR INSTALLATION REQUIREMENTS AND SPECIFICATIONS.
 - REFER TO BUILDING PLANS FOR SITE LIGHTING ELECTRICAL PLAN.
 - UNDERGROUND UTILITY LINES SHALL BE INSTALLED, INSPECTED AND APPROVED BEFORE BACKFILLING.
 - REFER TO INTERIOR PLUMBING DRAWINGS FOR TIE-IN OF ALL UTILITIES.
 - THE CONTRACTOR SHALL BE RESPONSIBLE FOR LOCATING EXISTING WATER MAINS, FORCE MAINS, SANITARY SEWER AND STORM MAINS AND MAINTAIN MINIMUM CLEARANCES BETWEEN WATER MAINS AND OTHER UTILITIES AT ALL POINTS ALONG THEIR LENGTH AS REQUIRED IN THE PLANS, DETAILS AND SPECIFICATIONS.
 - CONTRACTOR IS RESPONSIBLE FOR ALL NECESSARY INSPECTIONS AND/OR CERTIFICATIONS REQUIRED BY CODES AND/OR UTILITY SERVICE COMPANIES. THIS AND THE FINAL CONNECTIONS OF THE SERVICE SHALL BE COMPLETED 30 DAYS PRIOR TO STORE POSSESSION.
 - THE ENTIRE FIRE SERVICE FROM BUILDING TO CONNECTION POINT IS TO BE INSTALLED BY A LICENSED UTILITY CONTRACTOR HOLDING A "CONTRACTOR V" LICENSE IN ACCORDANCE WITH CH 489 OF THE FLORIDA STATUTES.
 - ALL UTILITY MAIN LENGTHS SHOWN ARE APPROXIMATE.

THIS ITEM HAS BEEN DIGITALLY SIGNED AND SEALED BY GREGORY D. WILFONG, P.E. ON THE DATE ADJACENT TO THE SEAL. PRINTED COPIES OF THIS DOCUMENT ARE NOT CONSIDERED SIGNED AND SEALED AND THE DIGITAL SIGNATURE MUST BE VERIFIED ON ANY ELECTRONIC COPIES.

OAKWOOD SOUTH RETAIL SHOPPING CENTER

CITY OF HOLLYWOOD, FL

SHEET NUMBER **C-402**

DRY UTILITY PLAN

KHA PROJECT: 147507151

DATE: 07/15/2024

SCALE: AS SHOWN

DESIGNED BY: SHB

DRAWN BY: SHB

CHECKED BY: GDW

Kimley»Horn

© 2024 KIMLEY-HORN AND ASSOCIATES, INC.
 445 24TH STREET, SUITE 200, VERO BEACH, FL 32960
 PHONE: 772-794-4100
 WWW.KIMLEY-HORN.COM
 REGISTRY NO. 35106

NO.	REVISIONS	DATE	BY

Plotted: By: schulz, Date: 07/12/2024, Time: 10:47:35am, Path: K:\VRB\LDEN\147207131-Dixie House of Sports\CAD\Plots\402 UTILITY CROSSING PLAN.dwg
 This document, together with the concepts and designs presented herein, is an instrument of service, it is intended only for the specific purpose and client for which it was prepared. Release of and improper reliance on this document without written authorization and adaptation by Kimley-Horn and Associates, Inc. shall be without liability to Kimley-Horn and Associates, Inc.

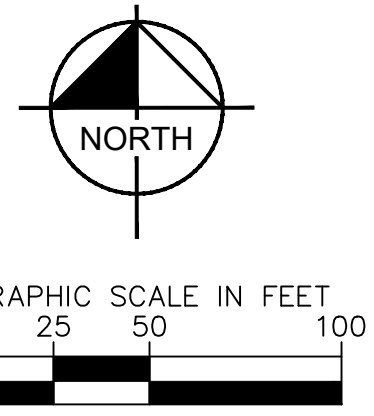
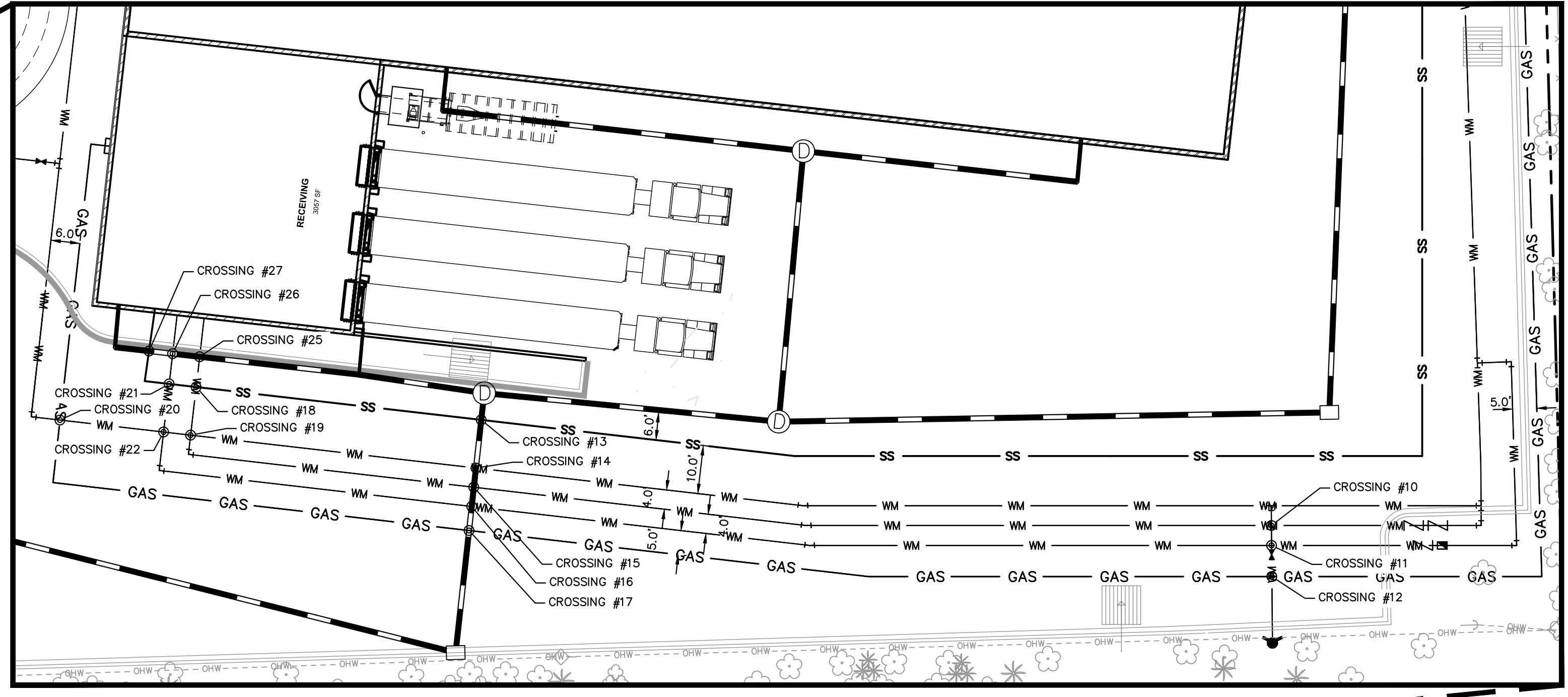
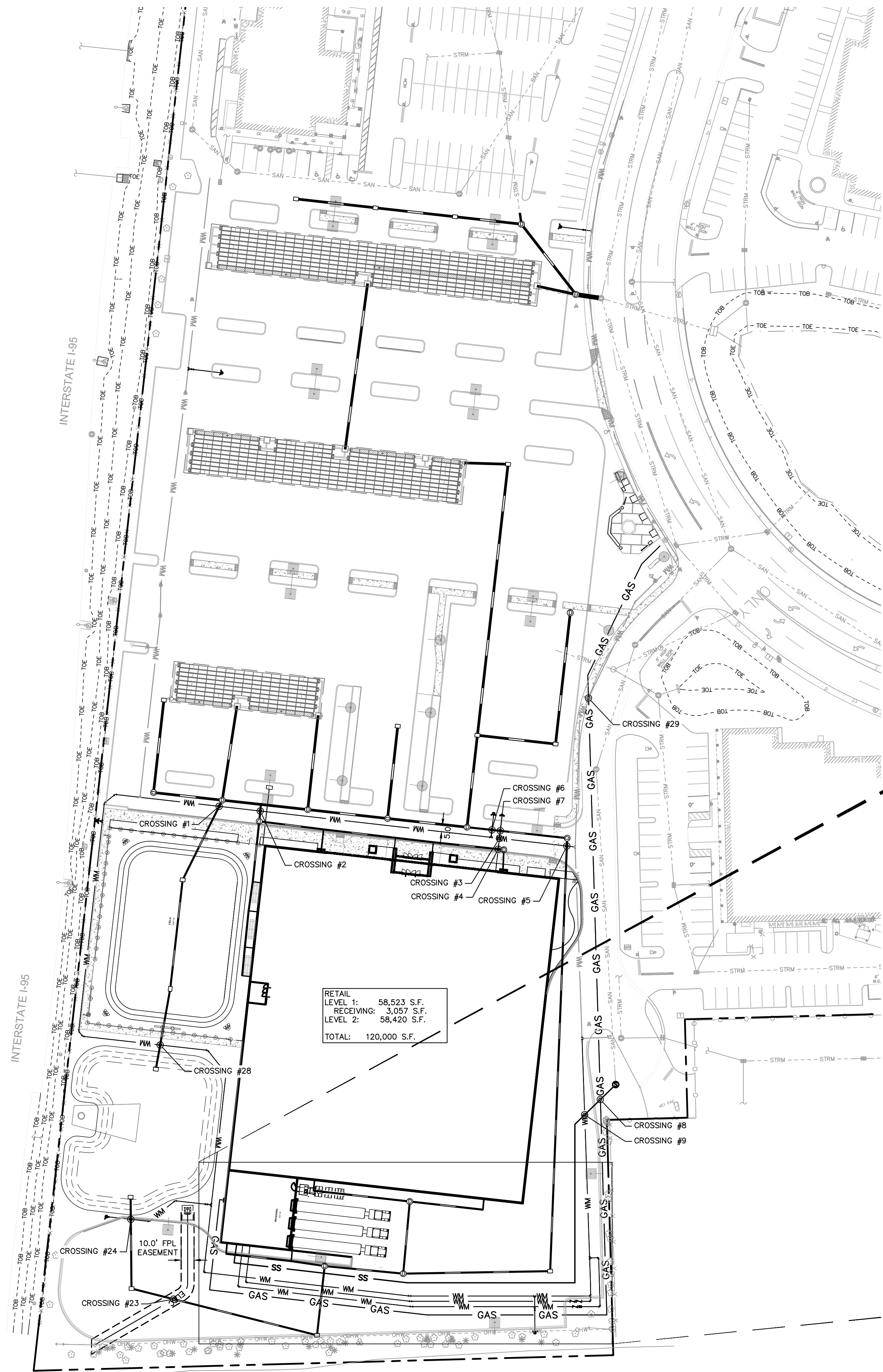

UTILITY CROSSING TABLE		
CROSSING	UTILITIES	INVERT EL.
1	12" STORM	3.48
	8" WATER	2.44
2	12" STORM	4.61
	8" WATER	3.49
3	8" WATER	3.62
	6" WATER	2.12
4	12" STORM	4.97
	6" WATER	2.62
5	12" STORM	3.98
	8" WATER	2.94
6	12" STORM	4.61
	6" WATER	3.52
7	12" STORM	4.61
	6" WATER	2.62
8	2" GAS	3.14
	6" SANITARY	1.45
9	8" WATER	2.91
	6" SANITARY	1.87
10	8" WATER	3.11
	6" WATER	2.11
11	3" WATER	3.53
	6" WATER	2.11
12	2" GAS	3.63
	6" WATER	2.11
13	6" SANITARY	4.75
	12" STORM	2.35
14	8" WATER	3.47
	12" STORM	2.35
15	8" WATER	3.39
	12" STORM	2.35

UTILITY CROSSING TABLE		
CROSSING	UTILITIES	INVERT EL.
16	3" WATER	3.73
	12" STORM	2.35
17	2" GAS	3.73
	12" STORM	2.35
18	6" SANITARY	5.37
	8" WATER	4.30
19	8" WATER	3.53
	8" WATER	2.54
20	2" GAS	5.43
	8" WATER	4.42
21	6" SANITARY	5.42
	3" WATER	4.32
22	3" WATER	4.02
	8" WATER	2.54
23	12" STORM	3.98
	ELECTRIC DUCT	2.83
24	12" STORM	3.98
	6" WATER	2.92
25	8" WATER	3.70
	12" STORM	2.70
26	3" WATER	4.11
	12" STORM	2.73
27	6" SANITARY	5.54
	12" STORM	2.75
28	12" STORM	3.48
	8" WATER	2.48
29	8" WATER	2.86*
	2" GAS	1.86

*ASSUMED DEPTH

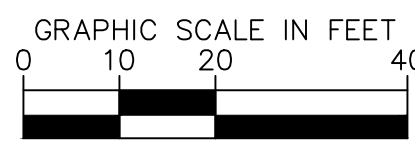

NO.	REVISIONS	DATE	BY

Kimley»Horn
 © 2024 KIMLEY-HORN AND ASSOCIATES, INC.
 445 24TH STREET, SUITE 200, VERO BEACH, FL 32960
 PHONE: 772-794-4100
 WWW.KIMLEY-HORN.COM

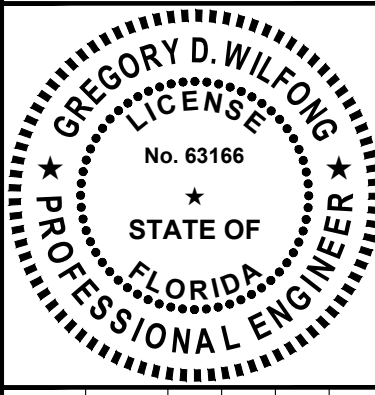

K/A PROJECT	147507131
DATE	07/15/2024
SCALE	AS SHOWN
DESIGNED BY	SHB
DRAWN BY	SHB
CHECKED BY	GDW

UTILITY CROSSING PLAN

OAKWOOD SOUTH RETAIL SHOPPING CENTER
 CITY OF HOLLYWOOD, FL

SHEET NUMBER
C-403

THIS ITEM HAS BEEN DIGITALLY SIGNED AND SEALED BY GREGORY D. WILFONG, P.E. ON THE DATE ADJACENT TO THE SEAL. PRINTED COPIES OF THIS DOCUMENT ARE NOT CONSIDERED SIGNED AND SEALED AND THE DIGITAL SIGNATURE MUST BE VERIFIED ON ANY ELECTRONIC COPIES.

Plotted By: schultz, Ryan Sheet Set: OAKWOOD PLAZA - Layout: C-403 UTILITY DETAILS July 12, 2024 01:48:53am K:\WEB_IDEVA\147507131-Dickie House of Sports\CAD\Drawings\C-403 UTILITY DETAILS.dwg
 This document, together with the concepts and designs presented herein, is an instrument of service, if intended only for the specific purpose and client for which it was prepared. Release of and inproper reliance on this document without written authorization and adaptation by Kimley-Horn and Associates, Inc. shall be without liability to Kimley-Horn and Associates, Inc.

GENERAL NOTES:

- THE INFORMATION PROVIDED IN THESE DRAWINGS IS SOLELY TO ASSIST THE CONTRACTOR IN ASSESSING THE NATURE AND EXTENT OF CONDITIONS WHICH WILL BE ENCOUNTERED DURING THE COURSE OF THE WORK. THE CONTRACTORS ARE DIRECTED, PRIOR TO BIDDING, TO CONDUCT WHATEVER INVESTIGATIONS THEY DEEM NECESSARY TO VERIFY AT THEIR OWN RISK REGARDING THE ACTUAL CONDITIONS THAT WILL BE ENCOUNTERED, AND UPON WHICH BIDS WILL BE BASED.
- ALL CONSTRUCTION AND MATERIALS SHALL CONFORM TO APPLICABLE STANDARDS AND SPECIFICATIONS OF THE CITY OF HOLLYWOOD DEPARTMENT OF PUBLIC UTILITIES, ENGINEERING AND CONSTRUCTION SERVICES DIVISION (ECS), AND ALL OTHER LOCAL, STATE AND NATIONAL CODES, WHERE APPLICABLE.
- LOCATIONS, ELEVATIONS, SIZES, MATERIALS, ALIGNMENTS, AND DIMENSIONS OF EXISTING FACILITIES, UTILITIES AND OTHER FEATURES ARE SHOWN ACCORDING TO THE BEST INFORMATION AVAILABLE AT THE TIME OF THE PREPARATION OF THESE PLANS, AND DO NOT PURPORT TO BE ABSOLUTELY CORRECT. ALSO, THERE MAY HAVE BEEN OTHER IMPROVEMENTS, UTILITIES, ETC., WITHIN THE PROJECT AREA WHICH WERE CONSTRUCTED AFTER THE PREPARATION OF THESE PLANS AND/OR THE ORIGINAL SITE SURVEY. THE CONTRACTOR SHALL VERIFY THE LOCATIONS, ELEVATIONS, AND OTHER FEATURES AFFECTING HIS/HER WORK PRIOR TO CONSTRUCTION, AND NOTIFY THE ENGINEER IMMEDIATELY WHEN CONFLICT BETWEEN DRAWINGS AND ACTUAL CONDITIONS ARE DISCOVERED. THE ENGINEER ASSUMES NO RESPONSIBILITY FOR ANY FACILITIES SHOWN OR NOT SHOWN ON THE PLANS. THE CONTRACTOR SHALL WORK AS NEEDED TO AVOID CONFLICT WITH EXISTING UTILITIES (NO ADDITIONAL COST SHALL BE PAID FOR THIS WORK). EXISTING UTILITIES SHALL BE MAINTAINED IN SERVICE DURING CONSTRUCTION UNLESS OTHERWISE APPROVED BY THE RESPECTIVE UTILITY OWNER.
- THE CONTRACTOR SHALL COORDINATE WITH ALL UTILITIES TO ARRANGE FOR THE RELOCATION AND TEMPORARY SUPPORT OF UTILITY FEATURES, ETC. AS NECESSARY TO COMPLETE THE WORK.
- IT SHALL BE THE CONTRACTOR'S RESPONSIBILITY TO LOCATE AND PROTECT ANY AND ALL EXISTING UTILITIES ON THIS PROJECT, AND TO ENSURE THAT EXISTING UTILITIES ARE MAINTAINED IN SERVICE DURING CONSTRUCTION UNLESS APPROVED OTHERWISE BY THE UTILITY OWNER.
- CONTRACTOR SHALL ADJUST ALL EXISTING UTILITY CASTINGS INCLUDING VALVE BOXES, MANHOLES, HAND-HOLES, PULL-BOXES, STORMWATER INLETS, AND SIMILAR STRUCTURES IN CONSTRUCTION AREA TO BE OVERLAID WITH ASPHALT PAVEMENT.
- THE CONTRACTOR IS REQUIRED TO OBTAIN ALL APPLICABLE CONSTRUCTION AND ENVIRONMENTAL PERMITS PRIOR TO THE START OF CONSTRUCTION.
- THE CONTRACTOR SHALL NOTIFY ECS AT LEAST 48 HOURS PRIOR TO BEGINNING CONSTRUCTION.
- PRIOR TO THE COMMENCEMENT OF CONSTRUCTION AND INSTALLATION OF THE PROPOSED IMPROVEMENTS, SHOP DRAWINGS SHALL BE SUBMITTED TO ECS IN ACCORDANCE WITH THE CONTRACT DOCUMENTS' REQUIREMENTS, FOR APPROVAL. IN ADDITION, IT IS THE CONTRACTOR'S RESPONSIBILITY TO OBTAIN ANY OTHER AGENCY SHOP DRAWING APPROVAL, IF REQUIRED.
- THE CONTRACTOR SHALL NOTIFY ECS IMMEDIATELY FOR ANY CONFLICT ARISING DURING CONSTRUCTION OF ANY IMPROVEMENTS SHOWN ON THESE DRAWINGS. THIS WORK BY THE CONTRACTOR SHALL BE CONSIDERED INCIDENTAL TO THE CONTRACT AND NO ADDITIONAL COMPENSATION SHALL BE ALLOWED.
- ELEVATIONS SHOWN ARE IN FEET AND ARE REFERENCED TO THE NORTH AMERICAN VERTICAL DATUM OF 1988 (NAVD 88).

	ISSUED: 03/01/1994	DEPARTMENT OF PUBLIC UTILITIES STANDARD DETAIL	REVISED: 06/08/2014
	DRAWN: EAM	GENERAL NOTES	DRAWING NO. G-00
	APPROVED: XXX		

GENERAL NOTES (CONTINUED):

- CITY OF HOLLYWOOD SHALL NOT PROVIDE STAGING / STORAGE AREA. CONTRACTOR SHALL SECURE STAGING / STORAGE AREA AS NECESSARY FOR CONSTRUCTION WORK.
- CONTRACTOR SHALL HAUL AWAY EXCESSIVE STOCKPILE OF SOIL FOR DISPOSAL EVERY DAY. NO STOCKPILE SOIL IS ALLOWED TO BE LEFT ON THE CONSTRUCTION SITE OVER NIGHT.
- CONTRACTOR SHALL CLEAN / SWEEP THE ROAD AT LEAST ONCE DAY OR AS REQUIRED BY THE ENGINEER.
- CONTRACTOR SHALL PROTECT CATCH BASINS WITHIN / ADJACENT TO THE CONSTRUCTION SITE AS REQUIRED BY NPDES REGULATIONS.
- THE CITY OF HOLLYWOOD HAS A NOISE ORDINANCE (CHAPTER 100) WHICH PROHIBITS EXCAVATION AND CONSTRUCTION BEFORE 8:00 A.M. AND AFTER 6:00 P.M., MONDAY THROUGH SATURDAY AND ALL DAY SUNDAY.
- SUITABLE EXCAVATED MATERIAL SHALL BE USED IN FILL AREAS. NO SEPARATE PAY ITEM FOR THIS WORK, INCLUDE COST IN OTHER ITEMS.
- ALL ROAD CROSSINGS ARE OPEN CUT AS PER THE REQUIREMENTS OF THE ECS UNLESS OTHERWISE NOTED ON THE DRAWINGS.
- THE CONTRACTOR SHALL REPLACE ALL PAVING, STABILIZING EARTH, DRIVEWAYS, PARKING LOTS, SIDEWALKS, ETC. TO SATISFY THE INSTALLATION OF THE PROPOSED IMPROVEMENTS WITH THE SAME TYPE OF MATERIAL THAT WAS REMOVED DURING CONSTRUCTION OR AS DIRECTED BY ECS FIELD ENGINEER.
- THE CONTRACTOR SHALL NOT ENCRoACH INTO PRIVATE PROPERTY WITH PERSONNEL, MATERIAL OR EQUIPMENT. IN CASE WORK ON PRIVATE PROPERTY IS NEEDED, A CITY OF HOLLYWOOD "RIGHT OF ENTRY" FORM MUST BE SIGNED BY PROPERTY OWNER AND THE DIRECTOR OF PUBLIC UTILITIES. THE CONTRACTOR IS RESPONSIBLE TO MAINTAIN ACCESS AT ALL TIMES TO PRIVATE HOMES/BUSINESSES.
- THE CONTRACTOR SHALL BE RESPONSIBLE FOR DAMAGE, REMOVAL OR MODIFICATION, CAUSED TO ANY IRRIGATION SYSTEM (PRIVATE OR PUBLIC) ACCIDENTALLY OR PURPOSELY. THE CONTRACTOR SHALL REPLACE ANY DAMAGED, REMOVED OR MODIFIED IRRIGATION PIPES, SPRINKLER HEADS OR OTHER PERTINENT APPURTENANCES TO MATCH OR EXCEED EXISTING CONDITIONS AT NO ADDITIONAL COST TO THE CITY.
- MAIL BOXES, FENCES OR OTHER PRIVATE PROPERTY DAMAGED DURING THE CONSTRUCTION OF THE PROPOSED IMPROVEMENTS SHALL BE REPLACED TO MATCH OR EXCEED EXISTING CONDITION.
- CONTRACTOR SHALL PROVIDE MAINTENANCE OF TRAFFIC IN ACCORDANCE WITH FDOT STANDARDS AND CITY OF HOLLYWOOD DEPARTMENT OF PUBLIC UTILITIES STANDARDS.
- NO TREES ARE TO BE REMOVED OR RELOCATED WITHOUT PRIOR APPROVAL FROM THE ECS FIELD ENGINEER.
- THE CONTRACTOR IS RESPONSIBLE FOR OBTAINING THE NECESSARY TREE REMOVAL OR RELOCATION PERMITS FROM THE CITY OF HOLLYWOOD DEPARTMENT OF PUBLIC UTILITIES.
- IT IS THE INTENT OF THESE PLANS TO BE IN ACCORDANCE WITH APPLICABLE CODES AND AUTHORITIES HAVING JURISDICTION. ANY DISCREPANCIES BETWEEN THESE PLANS AND APPLICABLE REGULATORY STANDARDS / REQUIREMENTS SHALL BE IMMEDIATELY BROUGHT TO THE ATTENTION OF ECS.

	ISSUED: 03/01/1994	DEPARTMENT OF PUBLIC UTILITIES STANDARD DETAIL	REVISED: 11/06/2017
	DRAWN: EAM	GENERAL NOTES (CONTINUED)	DRAWING NO. G-00.1
	APPROVED: XXX		

GENERAL NOTES (CONTINUED):

- THE CONTRACTOR SHALL BE RESPONSIBLE FOR MAINTAINING THE INTEGRITY OF AND MAKING THE REPAIRS TO EXISTING PAVEMENT, SIDEWALKS, PIPES, CONDUITS, CURBS, CABLES, ETC., WHETHER OR NOT SHOWN ON THE PLANS DAMAGED AS A RESULT OF THE CONTRACTORS OPERATIONS AND/OR THOSE OF HIS SUBCONTRACTORS, AND SHALL RESTORE THEM PROMPTLY AT NO ADDITIONAL EXPENSE TO THE OWNER. CONTRACTOR SHALL REPORT ANY DAMAGE TO SIDEWALK, DRIVEWAY, ETC., PRIOR TO BEGINNING WORK IN ANY AREA.
- WHERE NEW PAVEMENT MEETS EXISTING, CONNECTION SHALL BE MADE IN A NEAT STRAIGHT LINE AND FLUSH WITH EXISTING PAVEMENT TO MATCH EXISTING CONDITIONS.
- UNDER NO CIRCUMSTANCES SHALL THE CONTRACTOR LEAVE EXCAVATED TRENCHES, OR PARTS OF, EXPOSED OR OPENED AT THE END OF THE WORKING DAY, WEEKENDS, HOLIDAYS OR OTHER TIMES, WHEN THE CONTRACTOR IS NOT WORKING, UNLESS OTHERWISE DIRECTED. ALL TRENCHES SHALL BE COVERED, FIRMLY SECURED AND MARKED ACCORDINGLY FOR PEDESTRIAN / VEHICULAR TRAFFIC.
- ALL EXCAVATED MATERIAL REMOVED FROM THIS PROJECT SHALL BE DISPOSED OF OFF THE PROPERTY BY THE CONTRACTOR AT THE CONTRACTOR'S EXPENSE.
- ALL DUCTILE IRON PRODUCTS SHALL BE DOMESTIC MADE HEAVY DUTY CLASSIFICATION SUITABLE FOR HIGHWAY TRAFFIC LOADS, OR 20,000 LB.
- ALL GRASSED AREAS AFFECTED BY CONSTRUCTION SHALL BE RE-SODDED.
- THE CONTRACTOR SHALL BE RESPONSIBLE FOR THE PROVISION, INSTALLATION AND MAINTENANCE OF ALL TRAFFIC CONTROL AND SAFETY DEVICES, IN ACCORDANCE WITH SPECIFICATIONS OF THE LATEST REVISION OF FDOT DESIGN STANDARDS. IN ADDITION, THE CONTRACTOR IS RESPONSIBLE FOR THE RESETTING OF ALL TRAFFIC CONTROL AND INFORMATION SIGNAGE REMOVED DURING THE CONSTRUCTION PERIOD.
- EXCAVATED OR OTHER MATERIAL STORED ADJACENT TO OR PARTIALLY UPON A ROADWAY PAVEMENT SHALL BE ADEQUATELY MARKED FOR TRAFFIC SAFETY AT ALL TIMES.
- TEMPORARY PATCH MATERIAL MUST BE ON THE JOB SITE WHENEVER PAVEMENT IS CUT, OR THE CITY'S INSPECTOR WILL SHUT THE JOB DOWN.
- CONTRACTOR MUST PROVIDE FLASHER ARROW SIGNAL FOR ANY LANE THAT IS CLOSED OR DIVERTED.
- CONTRACTOR SHALL NOTIFY LAW ENFORCEMENT AND FIRE PROTECTION SERVICES TWENTY-FOUR (24) HOURS IN ADVANCE OF TRAFFIC DETOUR IN ACCORDANCE WITH SECTION 336.07 OF FLORIDA STATUTES.
- CONTRACTOR TO RESTORE PAVEMENT TO ORIGINAL CONDITION AS REQUIRED.
- CONTRACTOR SHALL BE RESPONSIBLE FOR PROVIDING DEWATERING PER SPECIFICATION SECTION 02140 DEWATERING.

	ISSUED: 03/01/1994	DEPARTMENT OF PUBLIC UTILITIES STANDARD DETAIL	REVISED: 11/06/2017
	DRAWN: EAM	GENERAL NOTES (CONTINUED)	DRAWING NO. G-00.2
	APPROVED: XXX		

GENERAL NOTES (CONTINUED):

- THE CONTRACTOR SHALL GIVE AT LEAST 48 HOURS NOTICE TO UTILITY COMPANIES TO PROVIDE FOR THE LOCATION OF EXISTING UNDERGROUND UTILITIES IN ADVANCE OF CONSTRUCTION. CONTACT UTILITIES NOTIFICATION CENTER AT 811 OR 1-800-432-4770 (SUNSHINE ONE-CALL OF FLORIDA).
- WHEN PVC PIPE IS USED, A METALLIZED MARKER TAPE SHALL BE INSTALLED CONTINUOUSLY 18" ABOVE THE PIPE. THE MARKER TAPE SHOULD BE IMPRINTED WITH A WARNING THAT THERE IS BURIED PIPE BELOW. THE TAPE SHALL BE MAGNA TEC, AS MANUFACTURED BY THOR ENTERPRISES INC. OR APPROVED EQUAL.
- ALL CONNECTIONS TO EXISTING MAINS SHALL BE THE RESPONSIBILITY OF THE CONTRACTOR. WATER CONNECTIONS SHALL BE METERED, AND THE COST OF WATER AND TEMPORARY METER SHALL BE BORNE BY THE CONTRACTOR.
- A COMPLETE AS-BUILT SURVEY SHALL BE ACCURATELY RECORDED OF THE UTILITY SYSTEM DURING CONSTRUCTION. AS-BUILT SURVEY SHALL BE SUBMITTED TO ECS SIGNED AND SEALED BY A FLORIDA REGISTERED SURVEYOR PRIOR TO FINAL INSPECTION AND ACCEPTANCE OF PROJECT. THE COST OF SIGNED AND SEALED AS-BUILTS SHALL BE COVERED IN OVERALL BID. THE AS-BUILT SURVEY SHALL INCLUDE:
 - PLAN VIEW SHOWING THE HORIZONTAL LOCATIONS OF EACH MANHOLE, INLET, VALVE, FITTING, BEND AND HORIZONTAL PIPE DEFLECTIONS WITH COORDINATES AND IN REFERENCE TO A SURVEY BASELINE OR RIGHT-OF-WAY CENTERLINE.
 - THE PLAN VIEW SHALL ALSO SHOW SPOT ELEVATIONS OF THE TOP OF THE MAIN (WATER MAIN AND FORCE MAIN) OR PIPE INVERTS (GRAVITY MAINS) AT INTERVALS NOT TO EXCEED 100 FEET AS MEASURED ALONG MAIN. THE PLAN VIEW SHALL ALSO INCLUDE SPOT ELEVATIONS AT EACH MANHOLE, INLET, VALVE, FITTING, BEND AND VERTICAL PIPE DEFLECTION.
 - THE PLAN VIEW SHALL ALSO SHOW THE HORIZONTAL SEPARATION FROM UNDERGROUND UTILITIES IMMEDIATELY ADJACENT OR PARALLEL TO THE NEW MAIN.
 - PROFILE VIEW WITH SPOT ELEVATIONS OF THE TOP OF THE MAIN (WATER MAIN AND FORCE MAIN) OR PIPE INVERT (GRAVITY MAIN) AND OF THE FINISHED GRADE OR MANHOLE RIM DIRECTLY ABOVE THE MAIN AT INTERVALS NOT TO EXCEED 100 FEET AS MEASURED ALONG THE MAIN. THE PROFILE VIEW SHALL ALSO INCLUDE SPOT ELEVATIONS AT EACH MANHOLE, INLET, VALVE, FITTING, BEND AND VERTICAL PIPE DEFLECTION.
 - THE PROFILE VIEW SHALL SHOW ALL UNDERGROUND UTILITIES CROSSING THE NEW MAIN AND THE VERTICAL SEPARATION PROVIDED BETWEEN THAT UNDERGROUND UTILITY AND THE NEW MAIN.
 - ALL CADD FILES MUST BE CREATED FOLLOWING THE CITY OF HOLLYWOOD "SURVEY / AS-BUILT CAD DRAWING STANDARDS"

	ISSUED: 03/01/1994	DEPARTMENT OF PUBLIC UTILITIES STANDARD DETAIL	REVISED: 11/06/2017
	DRAWN: EAM	GENERAL NOTES (CONTINUED)	DRAWING NO. G-00.3
	APPROVED: XXX		

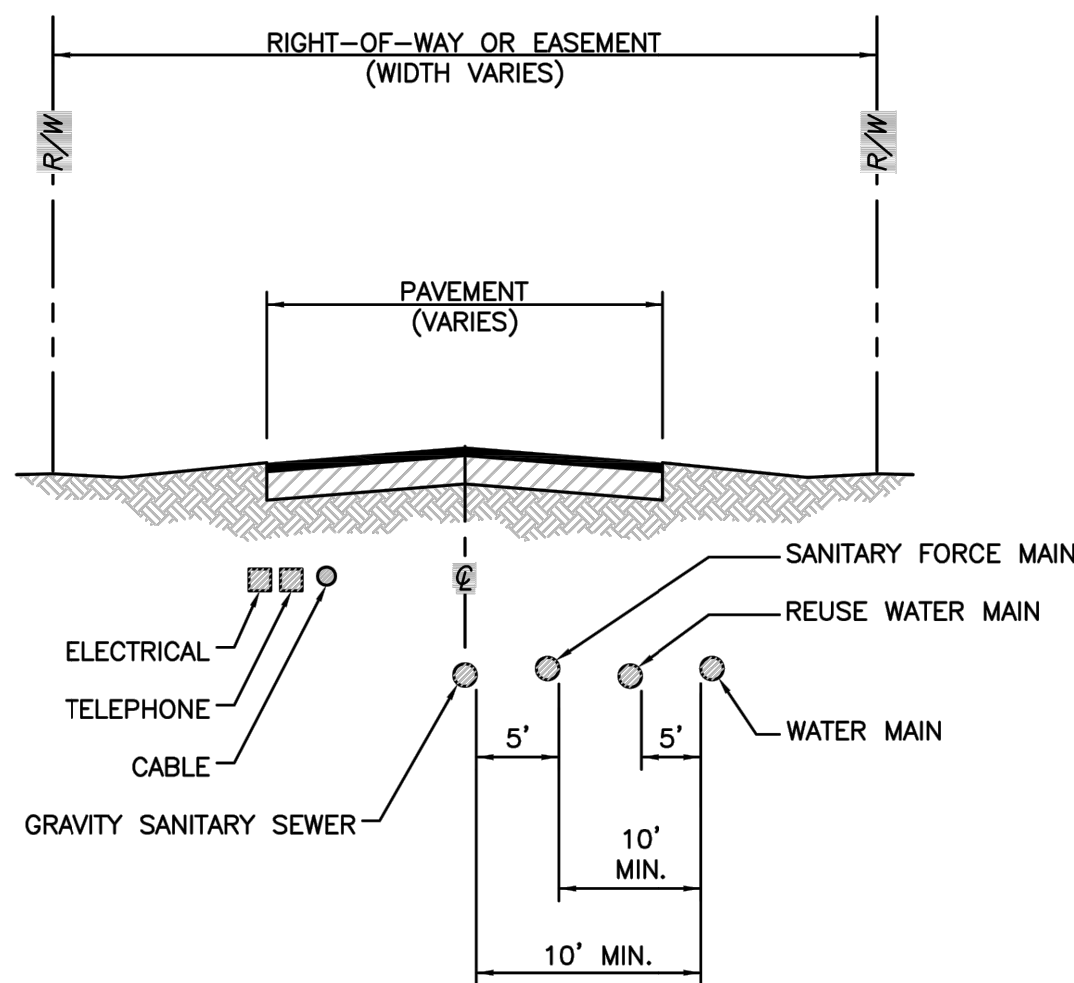

	ISSUED: 03/01/1994	DEPARTMENT OF PUBLIC UTILITIES STANDARD DETAIL	REVISED: 06/08/2014
	DRAWN: EAM	TYPICAL UTILITY ACCOMMODATION WITHIN RIGHT-OF-WAY OR EASEMENT	DRAWING NO. G-01
	APPROVED: XXX		

WATER MAIN SEPARATION IN ACCORDANCE WITH F.A.C. RULE 62-555.314

OTHER PIPE	HORIZONTAL SEPARATION	CROSSING (1), (4)	JOINT SPACING @ CROSSING (FULL JOINT CENTERED) (8)
STORM SEWER, STORM WATER FORCE MAIN, RECLAIMED WATER (2)	3 ft minimum	12 inches minimum except for storm sewer, then 6 inches is the minimum and 12 inches is preferred	Alternate 3 ft minimum
GRAVITY SANITARY SEWER, (3) SANITARY SEWER FORCE MAIN, RECLAIMED WATER	10 ft preferred 6 ft minimum	12 inches minimum except for gravity sewer, then 6 inches is the minimum and 12 inches is preferred	Alternate 6 ft minimum
ON-SITE SEWAGE TREATMENT & DISPOSAL SYSTEM	10 ft minimum		

- WATER MAIN SHOULD CROSS ABOVE OTHER PIPE, WHEN WATER MAIN MUST BE BELOW OTHER PIPE, THE MINIMUM SEPARATION IS 12 INCHES.
- RECLAIMED WATER REGULATED UNDER PART III OF CHAPTER 62-610, F.A.C.
- 3 FT. FOR GRAVITY SANITARY SEWER WHERE THE BOTTOM OF THE WATER MAIN IS LAID AT LEAST 6 INCHES ABOVE THE TOP OF THE GRAVITY SANITARY SEWER.
- 18" VERTICAL MINIMUM SEPARATION REQUIRED BY CITY OF HOLLYWOOD, UNLESS OTHERWISE APPROVED.
- A MINIMUM 6 FOOT HORIZONTAL SEPARATION SHALL BE MAINTAINED BETWEEN ANY TYPE OF SEWER AND WATER MAIN IN PARALLEL INSTALLATIONS WHENEVER POSSIBLE.
- IN CASES WHERE IT IS NOT POSSIBLE TO MAINTAIN A 10 FOOT HORIZONTAL SEPARATION, THE WATER MAIN MUST BE LAID IN A SEPARATE TRENCH OR ON AN UNDISTURBED GARTH SHELF LOCATED ON ONE SIDE OF THE SEWER OR FORCE MAIN AT SUCH AN ELEVATION THAT THE BOTTOM OF THE WATER MAIN IS AT LEAST 18 INCHES ABOVE THE TOP OF THE SEWER.
- WHERE IT IS NOT POSSIBLE TO MAINTAIN A VERTICAL DISTANCE OF 18 INCHES IN A PARALLEL INSTALLATIONS, THE WATER MAIN SHALL BE CONSTRUCTED OF DIP AND THE SANITARY SEWER OR FORCE MAIN SHALL BE CONSTRUCTED OF DIP WITH A MINIMUM VERTICAL DISTANCE OF 6 INCHES. THE WATER MAIN SHOULD ALWAYS BE ABOVE THE SEWER. JOINTS ON THE WATER MAIN SHALL BE LOCATED AS FAR APART AS POSSIBLE FROM JOINTS ON THE SEWER OR FORCE MAIN (STAGGERED JOINTS).
- ALL JOINTS ON THE WATER MAIN WITHIN 20 FEET OF THE CROSSING MUST BE MECHANICALLY RESTRAINED.

	ISSUED: 03/01/1994	DEPARTMENT OF PUBLIC UTILITIES STANDARD DETAIL	REVISED: 11/06/2017
	DRAWN: EAM	SEPARATION REQUIREMENTS OF F.D.E.P.	DRAWING NO. G-01.1
	APPROVED: XXX		

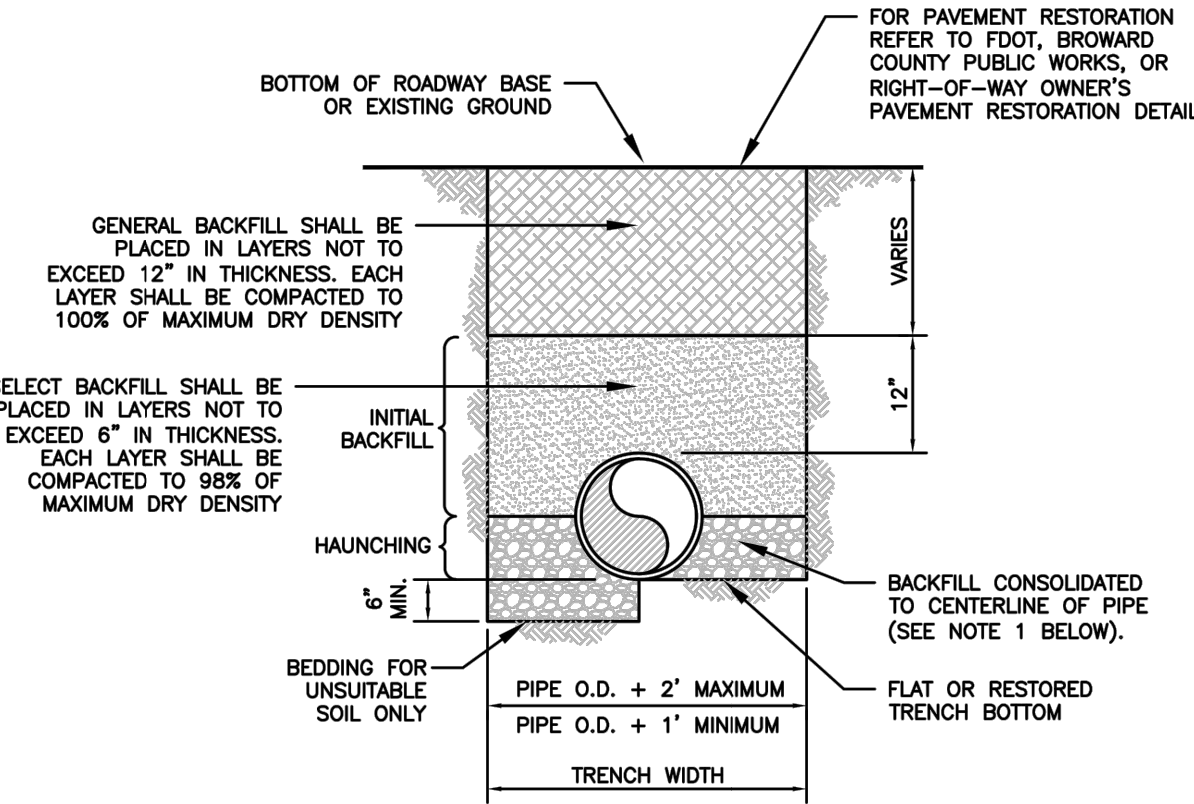

NOTES:

- WHEN PIPE INSTALLATION IS ABOVE THE GROUND WATER TABLE ELEVATION, OR WHENEVER BEDDING COPPER PIPE UNDER ANY CONDITION, BEDDING MATERIAL SHALL BE CLEAN SANDY SOIL IF AVAILABLE WITHIN THE LIMITS OF CONSTRUCTION. IMPORTED BEDDING SHALL BE WELL GRADED, WASHED CRUSHED STONE (OR DRAINFIELD LIME ROCK). CRUSHED STONE SHALL CONSIST OF HARD, DURABLE, SUB-ANGULAR PARTICLES OF PROPER SIZE AND GRADATION, AND SHALL BE FREE FROM ORGANIC MATERIAL, WOOD, TRASH, SAND, LOAM, CLAY, EXCESS FINES, AND OTHER DELTERIOUS MATERIALS.
- ALL BEDDING MATERIAL SHALL BE COMPACTED TO 95% OF MAXIMUM DENSITY BEFORE ANY PIPE IS LAID. FOR ADDITIONAL MATERIAL SPECIFICATIONS REFER TO SPECIFICATION SECTION 02222, "EXCAVATION AND BACKFILL FOR UTILITIES".
- DENSITY TESTING SHALL BE IN ACCORDANCE WITH AASHTO T-180 AND ASTM D-3017.
- BACKFILL TO COMPLY WITH FDOT DESIGN STANDARDS 125-8.

	ISSUED: 03/01/1994	DEPARTMENT OF PUBLIC UTILITIES STANDARD DETAIL	REVISED: 06/08/2014
	DRAWN: EAM	PIPE LAYING CONDITION TYPICAL SECTION (D.I.P.)	DRAWING NO. G-02
	APPROVED: XXX		

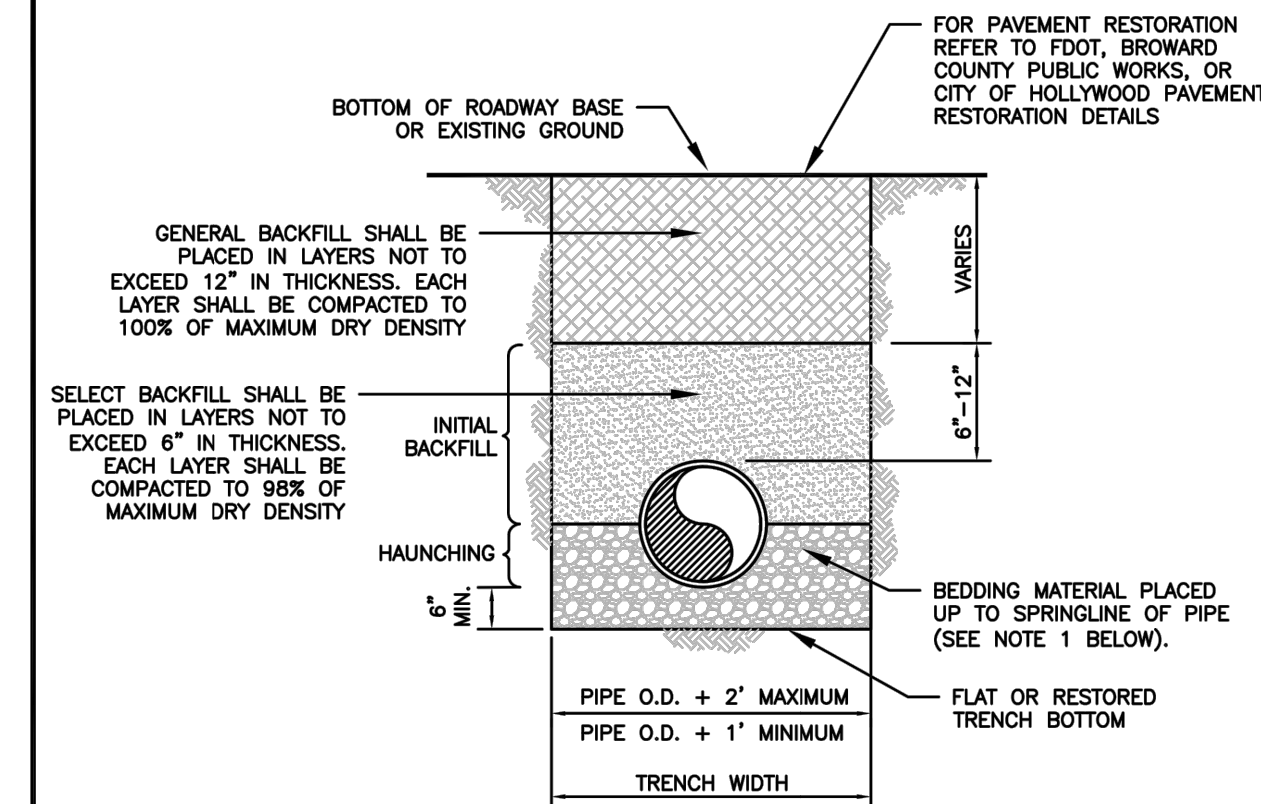

NOTES:

- WHEN PIPE INSTALLATION IS ABOVE THE GROUND WATER TABLE ELEVATION, OR WHENEVER BEDDING COPPER PIPE UNDER ANY CONDITION, BEDDING MATERIAL SHALL BE CLEAN SANDY SOIL IF AVAILABLE WITHIN THE LIMITS OF CONSTRUCTION. IMPORTED BEDDING SHALL BE WELL GRADED, WASHED CRUSHED STONE (OR DRAINFIELD LIME ROCK). CRUSHED STONE SHALL CONSIST OF HARD, DURABLE, SUB-ANGULAR PARTICLES OF PROPER SIZE AND GRADATION, AND SHALL BE FREE FROM ORGANIC MATERIAL, WOOD, TRASH, SAND, LOAM, CLAY, EXCESS FINES, AND OTHER DELTERIOUS MATERIALS.
- ALL BEDDING MATERIAL SHALL BE COMPACTED TO 95% OF MAXIMUM DENSITY BEFORE ANY PIPE IS LAID. FOR ADDITIONAL MATERIAL SPECIFICATIONS REFER TO SPECIFICATION SECTION 02222, "EXCAVATION AND BACKFILL FOR UTILITIES".
- DENSITY TESTING SHALL BE IN ACCORDANCE WITH AASHTO T-180 AND ASTM D-3017.
- BACKFILL TO COMPLY WITH FDOT DESIGN STANDARD 125-8.

	ISSUED: 03/01/1994	DEPARTMENT OF PUBLIC UTILITIES STANDARD DETAIL	REVISED: 06/08/2014
	DRAWN: EAM	PIPE LAYING CONDITION TYPICAL SECTION (P.V.C.)	DRAWING NO. G-03
	APPROVED: XXX		

NO.	REVISIONS	DATE	BY

Kimley»Horn

© 2024 KIMLEY-HORN AND ASSOCIATES, INC.
 445 24TH STREET, SUITE 200, VERO BEACH, FL 32960
 WWW.KIMLEY-HORN.COM
 REGISTRY NO. 35106

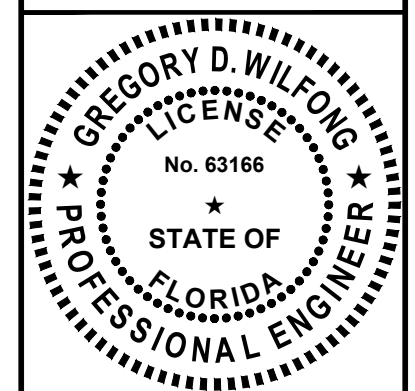

KHA PROJECT	147507131
DATE	07/15/2024
SCALE	AS SHOWN
DESIGNED BY	SHB
DRAWN BY	SHB
CHECKED BY	GDW

UTILITY DETAILS
 OAKWOOD SOUTH RETAIL SHOPPING CENTER
 CITY OF HOLLYWOOD
 SHEET NUMBER **C-404**

THIS ITEM HAS BEEN DIGITALLY SIGNED AND SEALED BY GREGORY D. WILFONG, P.E. ON THE DATE ADJACENT TO THE SEAL. PRINTED COPIES OF THIS DOCUMENT ARE NOT CONSIDERED SIGNED AND SEALED AND THE DIGITAL SIGNATURE MUST BE VERIFIED ON ANY ELECTRONIC COPIES.